



SIGN PERMIT

Community Development Department
 250 North 5th Street
 Grand Junction, CO 81501
 (970) 244-1430

Permit No. _____
 Date Submitted _____
 FEE \$ 25.00
 Tax Schedule 2701-314-01-015
 Zone ~~PA~~ I-1

BUSINESS NAME G-RASSO MASONRY, INC CONTRACTOR TH Sign Source
 STREET ADDRESS 721 Arrow West Rd. LICENSE NO. 2990515
 PROPERTY OWNER G-RASSO MASONRY, INC ADDRESS 737 N. 12th St
 OWNER ADDRESS 721 Arrow West Rd TELEPHONE NO. 257-1000

- 1. FLUSH WALL 2 Square Feet per Linear Foot of Building Facade
- Face Change Only (2,3 & 4):
- 2. ROOF 2 Square Feet per Linear Foot of Building Facade
- 3. FREE-STANDING 2 Traffic Lanes - 0.75 Square Feet x Street Frontage
4 or more Traffic Lanes - 1.5 Square Feet x Street Frontage
- 4. PROJECTING 0.5 Square Feet per each Linear Foot of Building Facade

Existing Externally or Internally Illuminated - No Change in Electrical Service Non-Illuminated

- (1 - 4) Area of Proposed Sign 24 Square Feet
- (1,2,4) Building Facade 72 Linear Feet
- (1 - 4) Street Frontage 130 Linear Feet
- (2,3,4) Height to Top of Sign _____ Feet Clearance to Grade _____ Feet

Existing Signage/Type:	Sq. Ft.
Total Existing:	<u>0</u> Sq. Ft.

● FOR OFFICE USE ONLY ●		
Signage Allowed on Parcel:		
Building	<u>144</u>	Sq. Ft.
Free-Standing	<u>97.5</u>	Sq. Ft.
Total Allowed:	<u>144</u>	Sq. Ft.

COMMENTS: _____

NOTE: No sign may exceed 300 square feet. A separate sign permit is required for each sign. Attach a sketch of proposed and existing signage including types, dimensions, lettering, abutting streets, alleys, easements, property lines, and locations. Roof signs shall be manufactured such that no guy wires, braces or supports shall be visible.

Terry D. Monte 11/5/99 Bill Nelson 11-10-99
 Applicant's Signature Date Community Development Approval Date

(White: Community Development) (Canary: Applicant) (Pink: Code Enforcement)

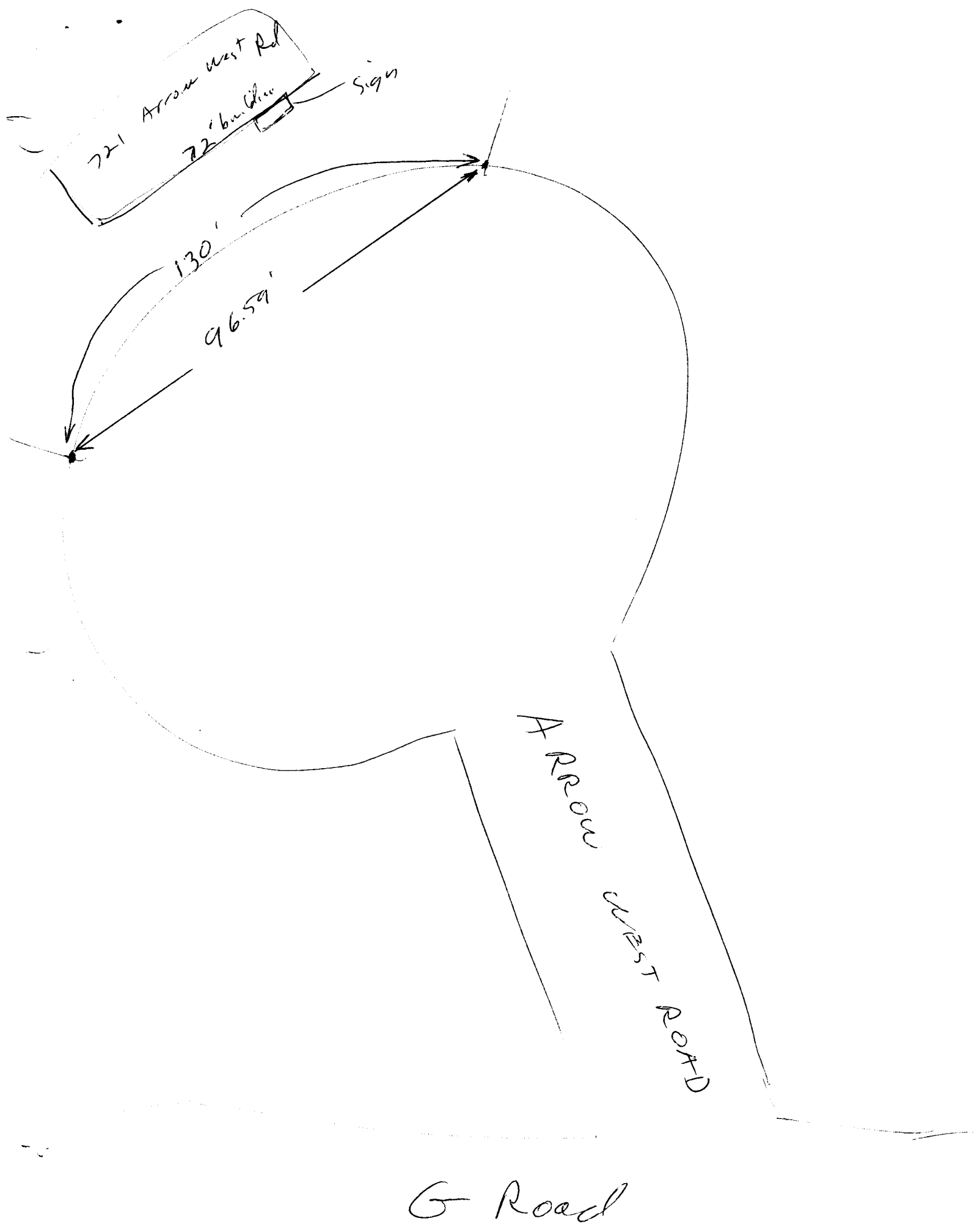

G Road

8

3'

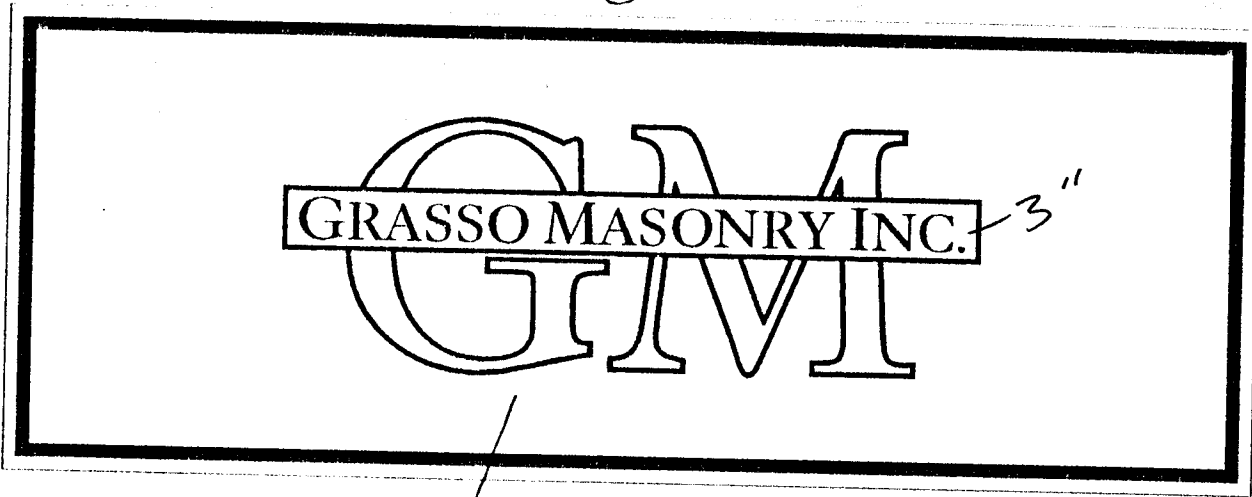

3"

20" x 53"