



SIGN PERMIT

9

Community Development Department
250 North 5th Street
Grand Junction, CO 81501
(970) 244-1430

Permit No. _____
Date Submitted 7-6-99
FEE \$ 25.00
Tax Schedule 2945-144-17-013
Zone B-3

BUSINESS NAME APPLIED EARTH SCIENCES CONTRACTOR YOUNG ELECTRIC SIGN CO
STREET ADDRESS 734 MAIN LICENSE NO. 2990588
PROPERTY OWNER BILL MAURER ADDRESS 2393 FYE ROAD
OWNER ADDRESS SAME TELEPHONE NO. 242-7880

- 1. FLUSH WALL 2 Square Feet per Linear Foot of Building Facade
- Face Change Only (2,3 & 4):
- 2. ROOF 2 Square Feet per Linear Foot of Building Facade
- 3. FREE-STANDING 2 Traffic Lanes - 0.75 Square Feet x Street Frontage
4 or more Traffic Lanes - 1.5 Square Feet x Street Frontage
- 4. PROJECTING 0.5 Square Feet per each Linear Foot of Building Facade

Existing Externally or Internally Illuminated - No Change in Electrical Service Non-Illuminated

(1-4) Area of Proposed Sign 32 Square Feet
(1,2,4) Building Facade 42 Linear Feet
(1-4) Street Frontage 72 Linear Feet
(2,3,4) Height to Top of Sign 20 Feet Clearance to Grade 16 Feet

Existing Signage/Type:	Sq. Ft.
Total Existing:	<u>A</u> Sq. Ft.

● FOR OFFICE USE ONLY ●		
Signage Allowed on Parcel:		
Building	<u>84</u>	Sq. Ft.
Free-Standing	<u>54</u>	Sq. Ft.
Total Allowed:	<u>84</u>	Sq. Ft.

COMMENTS: WE ARE CHAGING (2) 4'x8' FACES IN AN EXISTING SIGN CABINET. 64 #

NOTE: No sign may exceed 300 square feet. A separate sign permit is required for each sign. Attach a sketch of proposed and existing signage including types, dimensions, lettering, abutting streets, alleys, easements, property lines, and locations. Roof signs shall be manufactured such that no guy wires, braces or supports shall be visible.

[Signature] 7/6/99 [Signature] 7-6-99
Applicant's Signature Date Community Development Approval Date

(White: Community Development) (Canary: Applicant) (Pink: Code Enforcement)

8'



4'

Applied Earth Sciences, Inc.
PROFESSIONAL LAND SURVEYORS



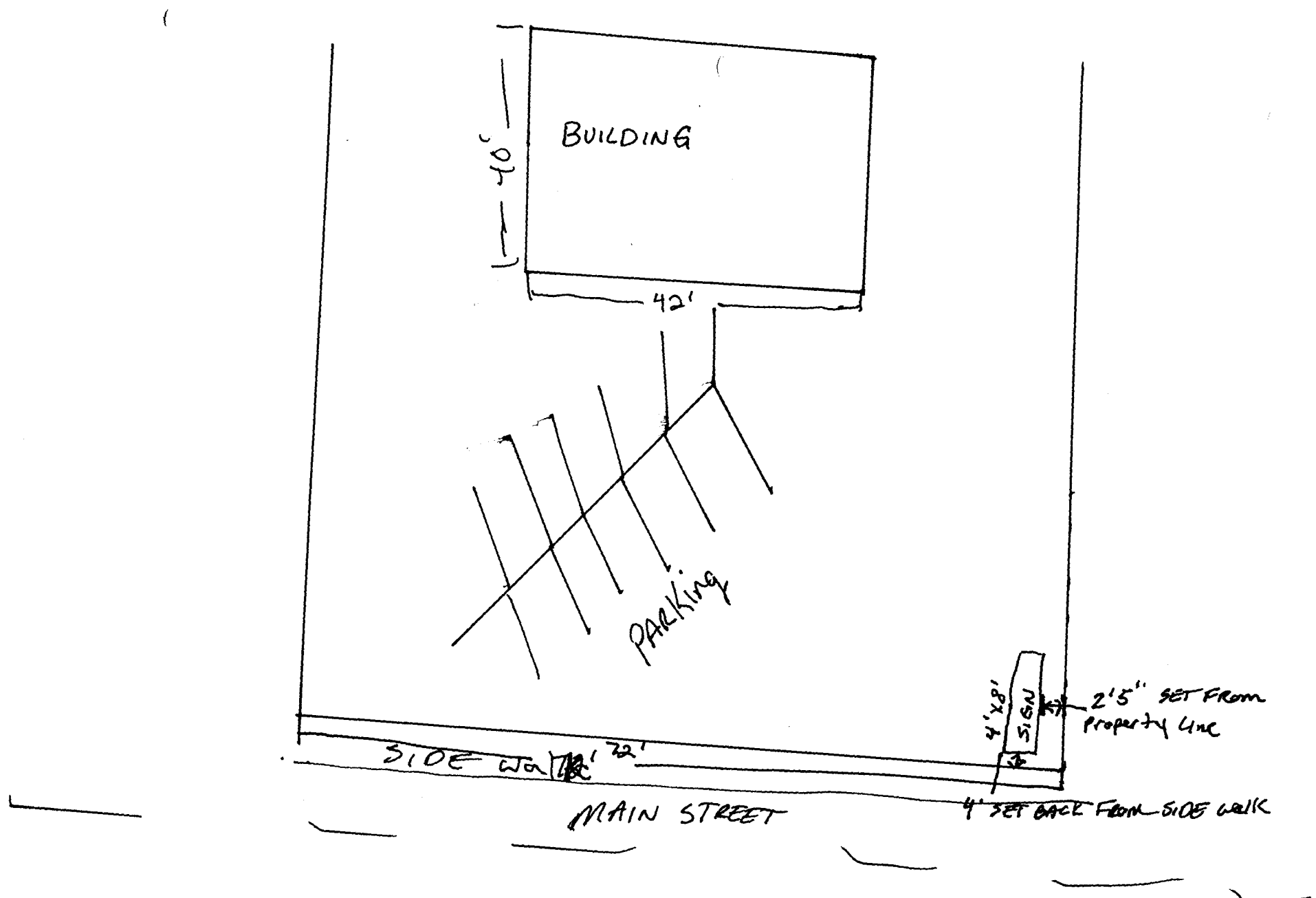

40'

BUILDING

42'

PARKING

SIDE WALK 72'

MAIN STREET

4' x 8'
SIGN

2'5" SET FROM
PROPERTY LINE

4' SET BACK FROM SIDE WALK