



# SIGN CLEARANCE

*ES*

Community Development Department  
250 North 5th Street  
Grand Junction, CO 81501  
(970) 244-1430

Clearance No. \_\_\_\_\_  
Date Submitted \_\_\_\_\_  
FEE \$ 25.00  
Tax Schedule 2945-114-23-923  
Zone ~~PZ~~ C-1

BUSINESS NAME Mesa State Titanium Arts CONTRACTOR Signs First  
STREET ADDRESS 1002 NORTH AVE. LICENSE NO. 2990359  
PROPERTY OWNER Mesa State ADDRESS 950 NORTH AVE.  
OWNER ADDRESS PO Box 3692, G.J. 81502 TELEPHONE NO. 256-1877

- 1. FLUSH WALL 2 Square Feet per Linear Foot of Building Facade
- 2. ROOF 2 Square Feet per Linear Foot of Building Facade
- 3. FREE-STANDING 2 Traffic Lanes - 0.75 Square Feet x Street Frontage  
4 or more Traffic Lanes - 1.5 Square Feet x Street Frontage
- 4. PROJECTING 0.5 Square Feet per each Linear Foot of Building Facade
- 5. OFF-PREMISE See #3 Spacing Requirements; Not > 300 Square Feet or < 15 Square Feet

Externally Illuminated       Internally Illuminated       Non-Illuminated

- 1-5 Area of Proposed Sign 36 Square Feet
- (1,2,4) Building Facade 65 Linear Feet
- (1-4) Street Frontage 65 Linear Feet
- (2,4,5) Height to Top of Sign 13' Feet Clearance to Grade 8 Feet
- (5) Distance from all Existing Off-Premise Signs within 600 Feet      Feet

Existing Signage/Type:	Sq. Ft.
<u>None</u>	
	Sq. Ft.
	Sq. Ft.
Total Existing:	Sq. Ft.

● FOR OFFICE USE ONLY ●		
Signage Allowed on Parcel:		
Building	<u>130</u>	Sq. Ft.
Free-Standing	<u>97.5</u>	Sq. Ft.
Total Allowed:	<u>130</u>	Sq. Ft.

COMMENTS: Is moving sign from 12th & North to 10th & North <sup>Houston</sup>

**NOTE:** No sign may exceed 300 square feet. A separate sign clearance is required for each sign. Attach a sketch of proposed and existing signage including types, dimensions, lettering, abutting streets, alleys, easements, property lines, and locations. **A SEPARATE PERMIT FROM THE BUILDING DEPARTMENT IS REQUIRED.**

[Signature]      11/12/99      [Signature]      11-16-99  
 Applicant's Signature      Date      Community Development Approval      Date

(White: Community Development)      (Canary: Applicant)      (Pink: Building Dept)      (Goldenrod: Code Enforcement)

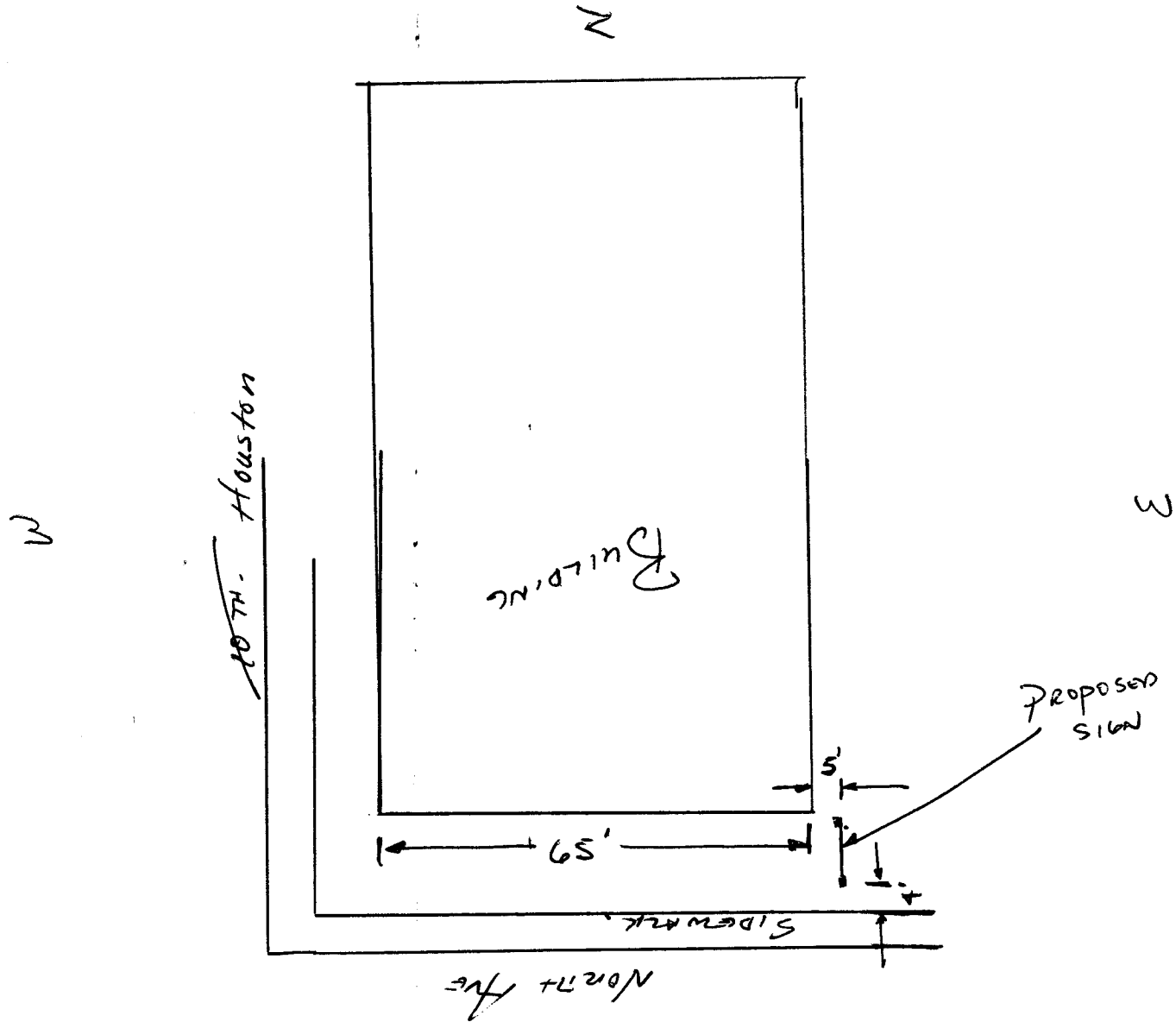

st. footage 90'?

W

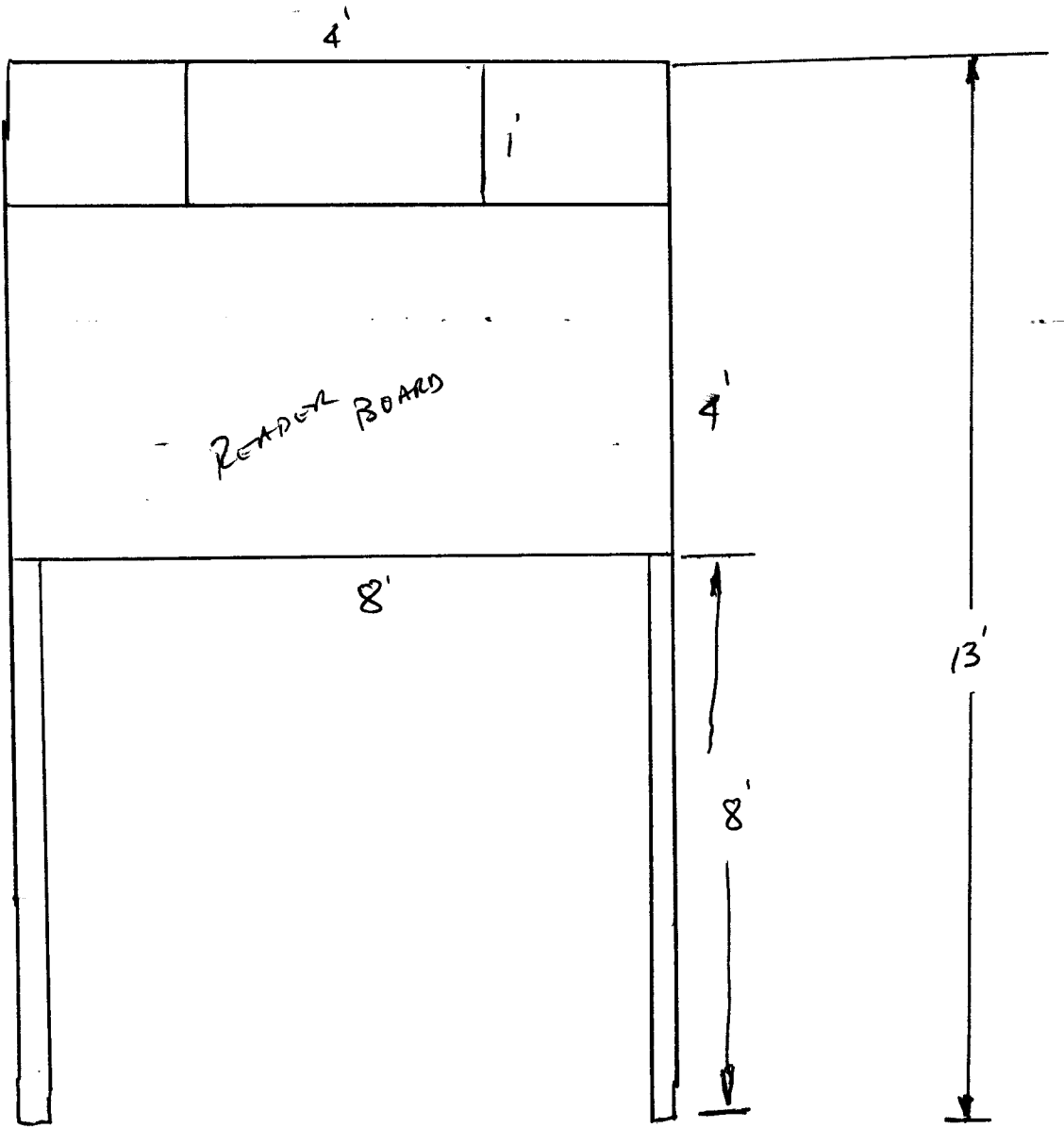

MESA STATE  
COLLEGE

INVESTMENT BANK

SEPT 30 - OCT 2

248 1604

