



SIGN PERMIT

(B)

Community Development Department
250 North 5th Street
Grand Junction, CO 81501
(970) 244-1430

Permit No. _____
Date Submitted 4/27/99
FEE \$ 500
Tax Schedule 2945-123-21-009
Zone C1

(GJ)

BUSINESS NAME Pizza Hut
STREET ADDRESS 1440 N. Ave.
PROPERTY OWNER Mc Govern Ent.
OWNER ADDRESS N/A

CONTRACTOR Bud's Signs
LICENSE NO. 2990100
ADDRESS 1055 UTE Ave.
TELEPHONE NO. 245-7700

- 1. FLUSH WALL 2 Square Feet per Linear Foot of Building Facade
- 2. ROOF 2 Square Feet per Linear Foot of Building Facade
- 3. FREE-STANDING 2 Traffic Lanes - 0.75 Square Feet x Street Frontage
- 4. PROJECTING 0.5 Square Feet per each Linear Foot of Building Facade

Face Change Only (2,3 & 4):

Existing Externally or Internally Illuminated - No Change in Electrical Service Non-Illuminated

- (1 - 4) Area of Proposed Sign 514 Square Feet
- (1,2,4) Building Facade 38 Linear Feet
- (1 - 4) Street Frontage 100 Linear Feet
- (2,3,4) Height to Top of Sign 16 Feet Clearance to Grade 12 Feet

NOTE USING NORTH AV. FACADE FRONTAGE FOR SIGN ALLOWANCE.

Existing Signage/Type:	
Free Standing	<u>488</u> Sq. Ft.
Roof Sign	<u>514</u> 688 Sq. Ft.
	Sq. Ft.
Total Existing:	<u>1002</u> Sq. Ft.

994

● FOR OFFICE USE ONLY ●	
Signage Allowed on Parcel:	
Building	<u>76</u> Sq. Ft.
Free-Standing	<u>150</u> Sq. Ft.
Total Allowed:	<u>150</u> Sq. Ft.

COMMENTS: These signs are replacing existing signs that were the same size

NOTE: No sign may exceed 300 square feet. A separate sign permit is required for each sign. Attach a sketch of proposed and existing signage including types, dimensions, lettering, abutting streets, alleys, easements, property lines, and locations. Roof signs shall be manufactured such that no guy wires, braces or supports shall be visible.

Edward A. Coney 4/27/99 Near [Signature] 4/27/99
 Applicant's Signature Date Community Development Approval Date

(White: Community Development) (Canary: Applicant) (Pink: Code Enforcement)



SIGN PERMIT

(A)

Community Development Department
250 North 5th Street
Grand Junction, CO 81501
(970) 244-1430

Permit No. _____
Date Submitted 4/27/99
FEE \$ 2500
Tax Schedule 2945-123-21-009
Zone C1

BUSINESS NAME Pizza Hut
STREET ADDRESS 1440 N. Ave
PROPERTY OWNER McGouven Ent.
OWNER ADDRESS N/A

CONTRACTOR Buds Signs
LICENSE NO. 2990100
ADDRESS 1055 UTE Ave
TELEPHONE NO. 245-7700

- 1. FLUSH WALL 2 Square Feet per Linear Foot of Building Facade
- Face Change Only (2,3 & 4):*
- 2. ROOF 2 Square Feet per Linear Foot of Building Facade
- 3. FREE-STANDING 2 Traffic Lanes - 0.75 Square Feet x Street Frontage
4 or more Traffic Lanes - 1.5 Square Feet x Street Frontage
- 4. PROJECTING 0.5 Square Feet per each Linear Foot of Building Facade

Existing Externally or Internally Illuminated - No Change in Electrical Service Non-Illuminated

(1 - 4) Area of Proposed Sign 514 ~~308~~ Square Feet
(1,2,4) Building Facade 38 Linear Feet
(1 - 4) Street Frontage 100 Linear Feet
(2,3,4) Height to Top of Sign 16 Feet Clearance to Grade 12 Feet

Existing Signage/Type:	
<u>Freestanding</u>	<u>484</u> Sq. Ft.
	Sq. Ft.
	Sq. Ft.
Total Existing:	Sq. Ft.

● FOR OFFICE USE ONLY ●	
Signage Allowed on Parcel:	
Building	<u>76'</u> Sq. Ft.
Free-Standing	<u>150</u> Sq. Ft.
Total Allowed:	<u>150</u> Sq. Ft.

COMMENTS: These signs are replacing existing signs that were the same size.

NOTE: No sign may exceed 300 square feet. A separate sign permit is required for each sign. Attach a sketch of proposed and existing signage including types, dimensions, lettering, abutting streets, alleys, easements, property lines, and locations. Roof signs shall be manufactured such that no guy-wires, braces or supports shall be visible.

Edward A. Coney 4/27/99 [Signature] 4/27/99
Applicant's Signature Date Community Development Approval Date

(White: Community Development) (Canary: Applicant) (Pink: Code Enforcement)



1440 North Ave.

PIZZA HUT

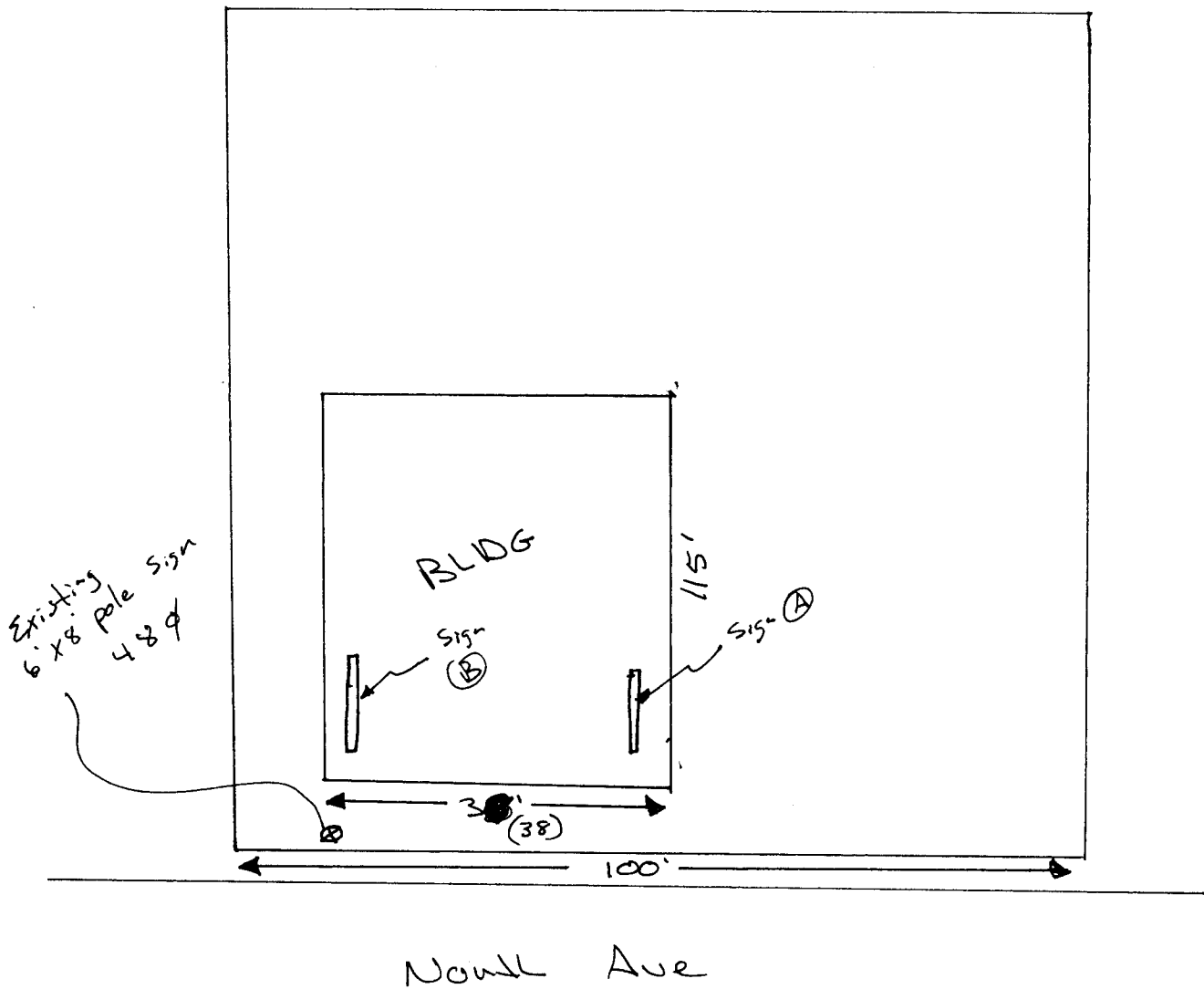

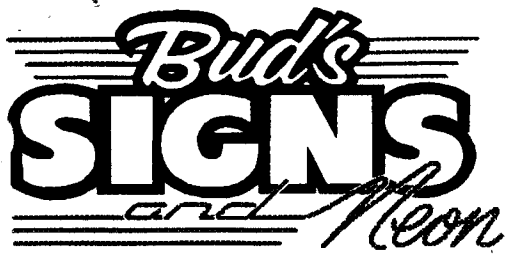

We Do Signs RIGHT!

Sign (A) → (B)

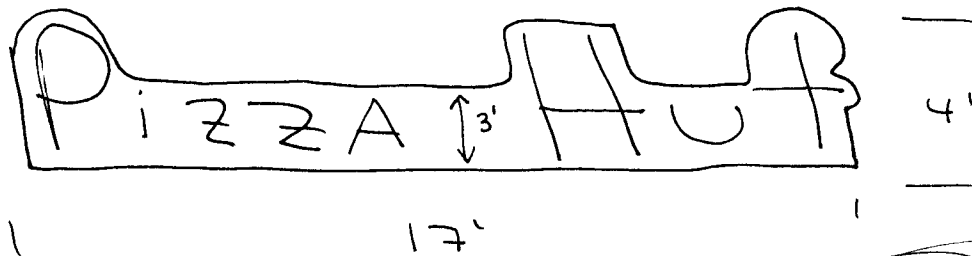

51 #

~~68 #~~