



SIGN CLEARANCE

P

#72004

Community Development Department
250 North 5th Street
Grand Junction, CO 81501
(970) 244-1430

Clearance No. _____
Date Submitted 9-17-99
FEE \$ 25
Tax Schedule 2945-123-25-014
Zone C1

BUSINESS NAME GO FER FOODS
STREET ADDRESS 1750 NTH AV.
PROPERTY OWNER Monument Oil
OWNER ADDRESS 703-23 1/2 Rd C5

CONTRACTOR Western Neon
LICENSE NO. 2990370
ADDRESS 3183 HALL AV
TELEPHONE NO. 970 523 4045

- 1. FLUSH WALL 2 Square Feet per Linear Foot of Building Facade
- 2. ROOF 2 Square Feet per Linear Foot of Building Facade
- 3. FREE-STANDING 2 Traffic Lanes - 0.75 Square Feet x Street Frontage
4 or more Traffic Lanes - 1.5 Square Feet x Street Frontage
- 4. PROJECTING 0.5 Square Feet per each Linear Foot of Building Facade
- 5. OFF-PREMISE See #3 Spacing Requirements; Not > 300 Square Feet or < 15 Square Feet

Externally Illuminated

Internally Illuminated Signs Etc

Non-Illuminated

- (1 - 5) Area of Proposed Sign 150 Square Feet
- (1,2,4) Building Facade 2646 Linear Feet
- (1 - 4) Street Frontage 150 Linear Feet 148'
- (2 - 5) Height to Top of Sign 26'6" Feet Clearance to Grade 9' Feet
- (5) Distance from all Existing Off-Premise Signs within 600 Feet _____ Feet

Existing Signage/Type:		
GO FER FOODS 1'6" x 20'	32	Sq. Ft.
2 6' CONCRETE CHIP 14 SF ETC	28	Sq. Ft.
1 5' x 8' FS GO FER TO COME DOWN	40	Sq. Ft.
Total Existing:		Sq. Ft.

● FOR OFFICE USE ONLY ●		
Signage Allowed on Parcel: <u>NORTH</u>		
Building	92	Sq. Ft.
Free-Standing	222	Sq. Ft.
Total Allowed:	222	Sq. Ft.

COMMENTS: 5'x8' GO FER TO COME DOWN - ONLY 12# REMAINING ALLOWANCE FOR SITE - NORTH AVE

NOTE: No sign may exceed 300 square feet. A separate sign clearance is required for each sign. Attach a sketch of proposed and existing signage including types, dimensions, lettering, abutting streets, alleys, easements, property lines, and locations. **A SEPARATE PERMIT FROM THE BUILDING DEPARTMENT IS REQUIRED.**

Paul Gange
Applicant's Signature

9-16-99
Date

Ruthen Lambert
Community Development Approval

9/17/99
Date

(White: Community Development)

(Canary: Applicant)

(Pink: Building Dept)

(Goldenrod: Code Enforcement)

TX 2945-123-25-014

GOFER # 18
1750 NTH AV.

590-125

Price Sign 20' AWAY
CANOPY 20' AWAY

PLEASE SKETCH IN THE SPACE BELOW:

- Proposed sign dimensions (length, width, height, depth)
- Location on parcel (dimensions from streets, structures, and property lines)
- Any other signs on parcel.

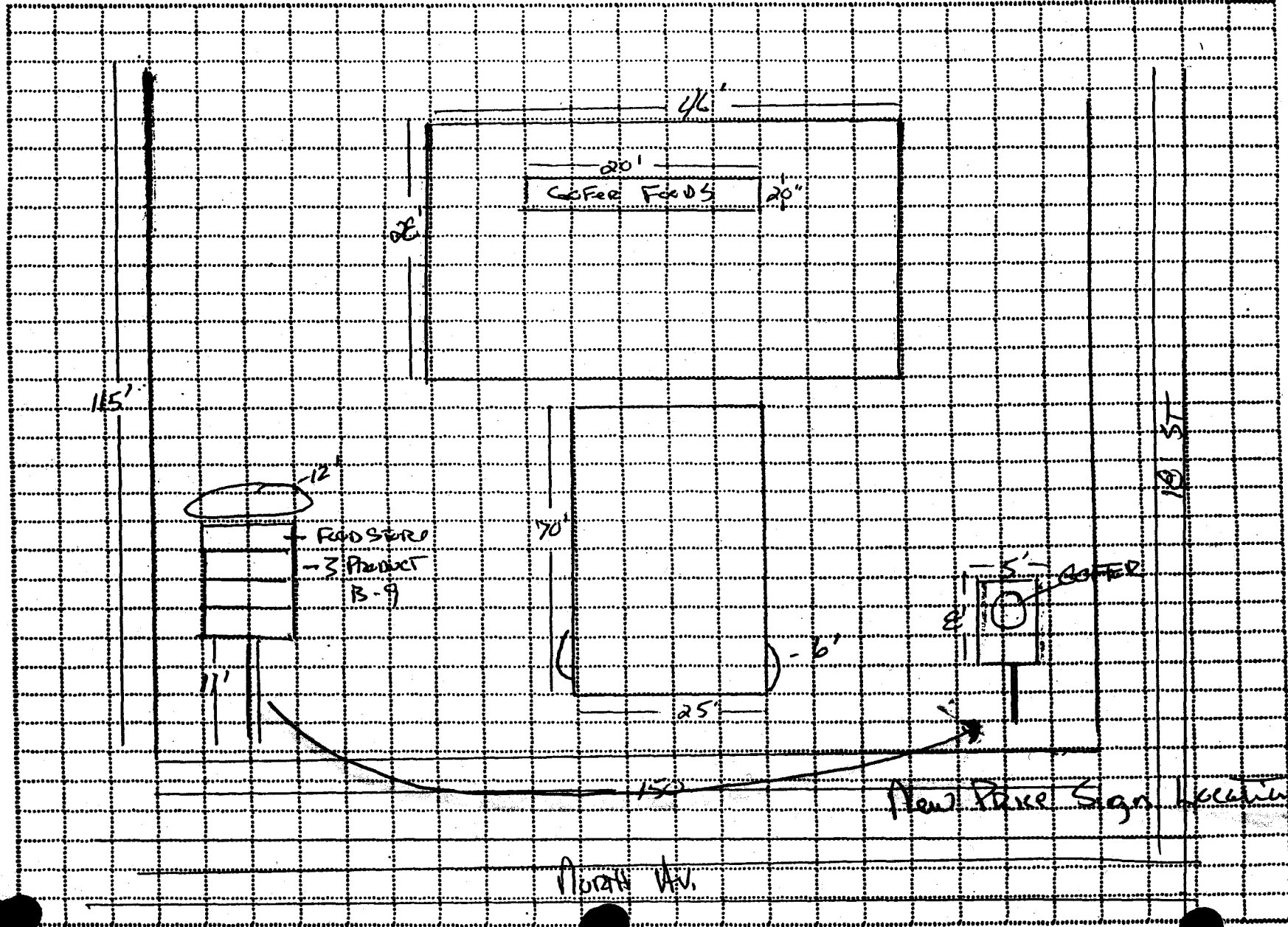

North Av.

New Price Sign Location

12 ft. dual pole system

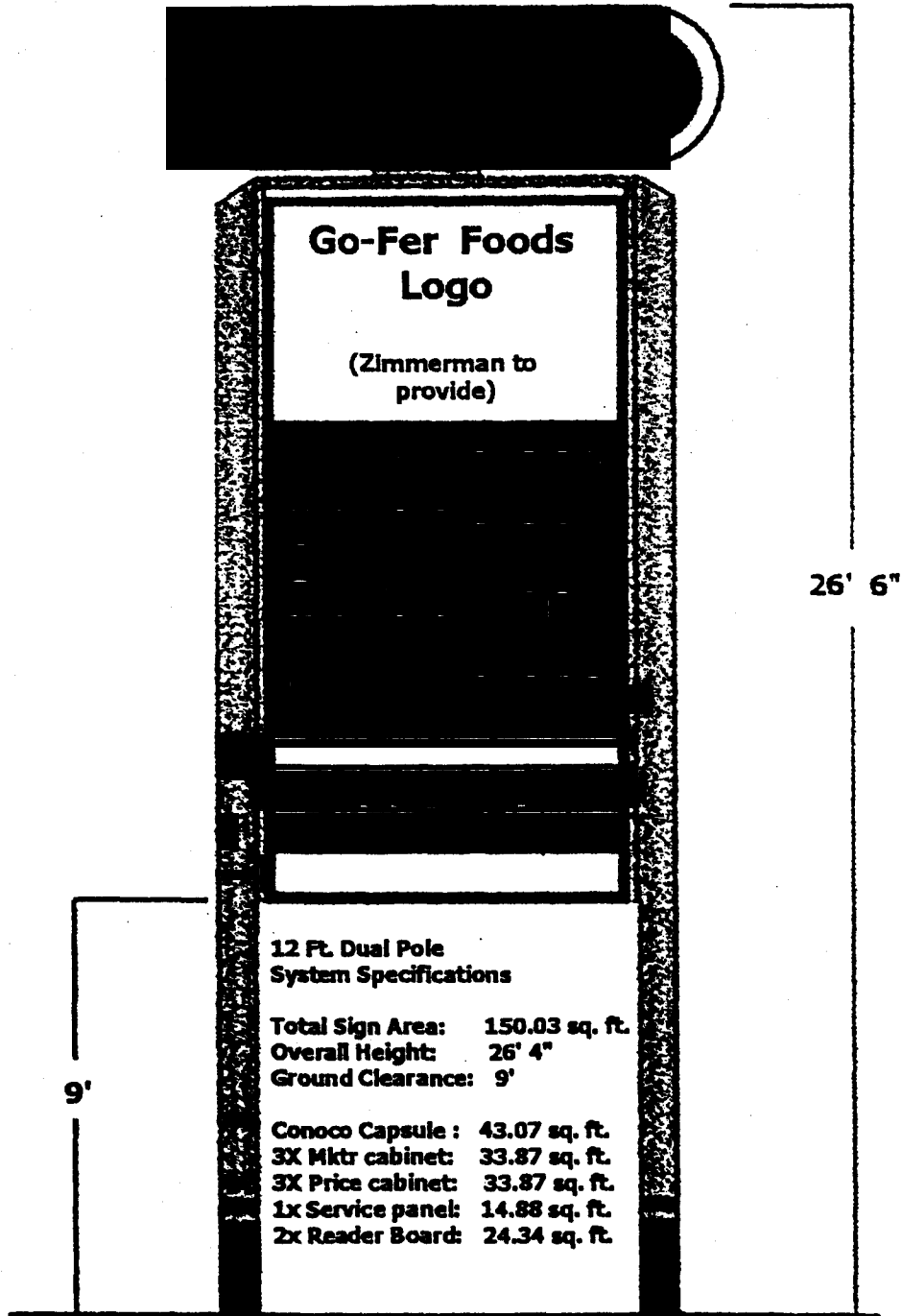

From: Nina McNally
To: Planning Techs
Date: Tuesday, November 30, 1999 10:11AM
Subject: Western Neon

Just wanted to let you know that Western Neon has a problem sign at 1750 North Ave. (Gofer Foods). The footer is about 1 ft. into right of way. I will be working on getting this fixed. I don't know if policy currently calls for a fine, but I plan to make sure they correct the problem or I will have to ticket them. Let me know if any questions. Thanks

Nina

*Rev. Permit
will not support
Go Fer Foods*