



# SIGN PERMIT

64

Community Development Department  
250 North 5th Street  
Grand Junction, CO 81501  
(970) 244-1430

Permit No. \_\_\_\_\_  
Date Submitted 12-27-99  
FEE \$ 25.00 00-958  
Tax Schedule 2945-121-31806  
Zone PD-8  
# 76-81; # 1-75; # 52-77

BUSINESS NAME Northwest Christian Church CONTRACTOR The Sign Gallery  
STREET ADDRESS 2001 Patterson LICENSE NO. 2990226  
PROPERTY OWNER same ADDRESS 1048 Independent Suite A109  
OWNER ADDRESS same TELEPHONE NO. 241-6400

- 1. FLUSH WALL 2 Square Feet per Linear Foot of Building Facade
- Face Change Only (2,3 & 4):
- 2. ROOF 2 Square Feet per Linear Foot of Building Facade
- 3. FREE-STANDING 2 Traffic Lanes - 0.75 Square Feet x Street Frontage  
4 or more Traffic Lanes - 1.5 Square Feet x Street Frontage
- 4. PROJECTING 0.5 Square Feet per each Linear Foot of Building Facade

Existing Externally or Internally Illuminated - No Change in Electrical Service  Non-Illuminated

(1 - 4) Area of Proposed Sign 23.5 Square Feet  
(1,2,4) Building Facade 260L Linear Feet  
(1 - 4) Street Frontage W 15th Linear Feet 397 (FR)  
(2,3,4) Height to Top of Sign 7'6" Feet Clearance to Grade 1' Feet

Existing Signage/Type:	
	Sq. Ft.
	Sq. Ft.
	Sq. Ft.
Total Existing:	<u>0</u> Sq. Ft.

● FOR OFFICE USE ONLY ●	
Signage Allowed on Parcel:	
Building	Sq. Ft.
Free-Standing	<u>no</u> <u>24</u> Sq. Ft.
Total Allowed:	Sq. Ft.

COMMENTS: Existing sign, changing color & adding logo  
New sign permit for wall signs may require change to Planned Development

NOTE: No sign may exceed 300 square feet. A separate sign permit is required for each sign. Attach a sketch of proposed and existing signage including types, dimensions, lettering, abutting streets, alleys, easements, property lines, and locations. Roof signs shall be manufactured such that no guy wires, braces or supports shall be visible.

Larry Z Boudier 12-27-99 Kirsten Z Andrade 12/27/99  
Applicant's Signature Date Community Development Approval Date  
Larry  
(White: Community Development) (Canary: Applicant) (Pink: Code Enforcement)

Northwest Christian Church  
2001 Patterson

Existing

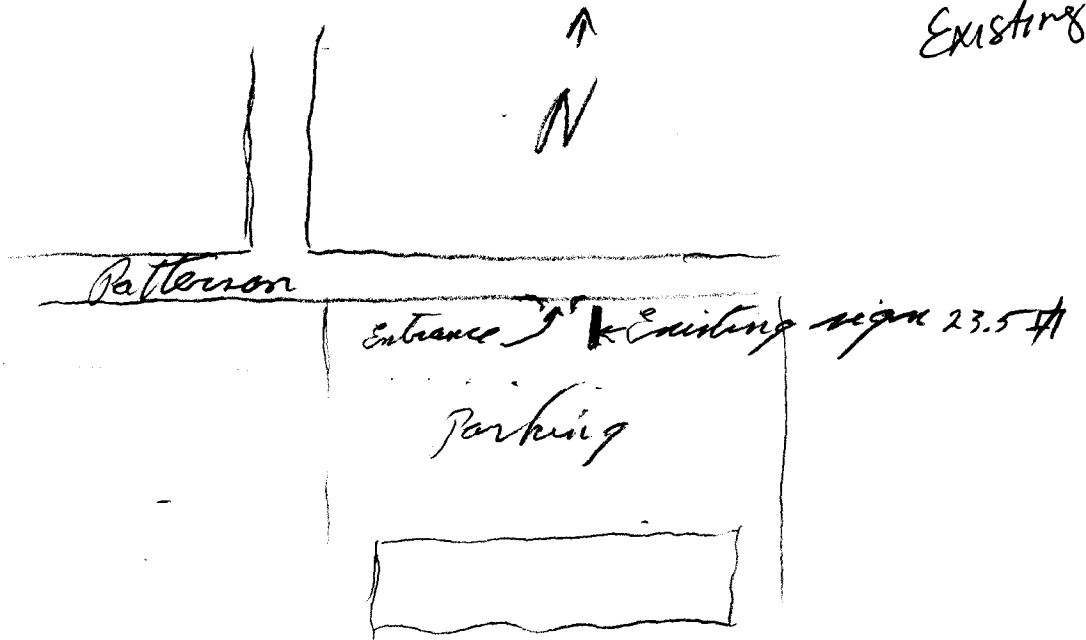

Church Office 2x3 6 #

2 - Family Life Center 2'x3', 3'x4'  
6 # 12 #

Kids of the Kingdom 3'x6' includes Castle  
18 #

do these  
count?

13387

2001 Palmon

Existing

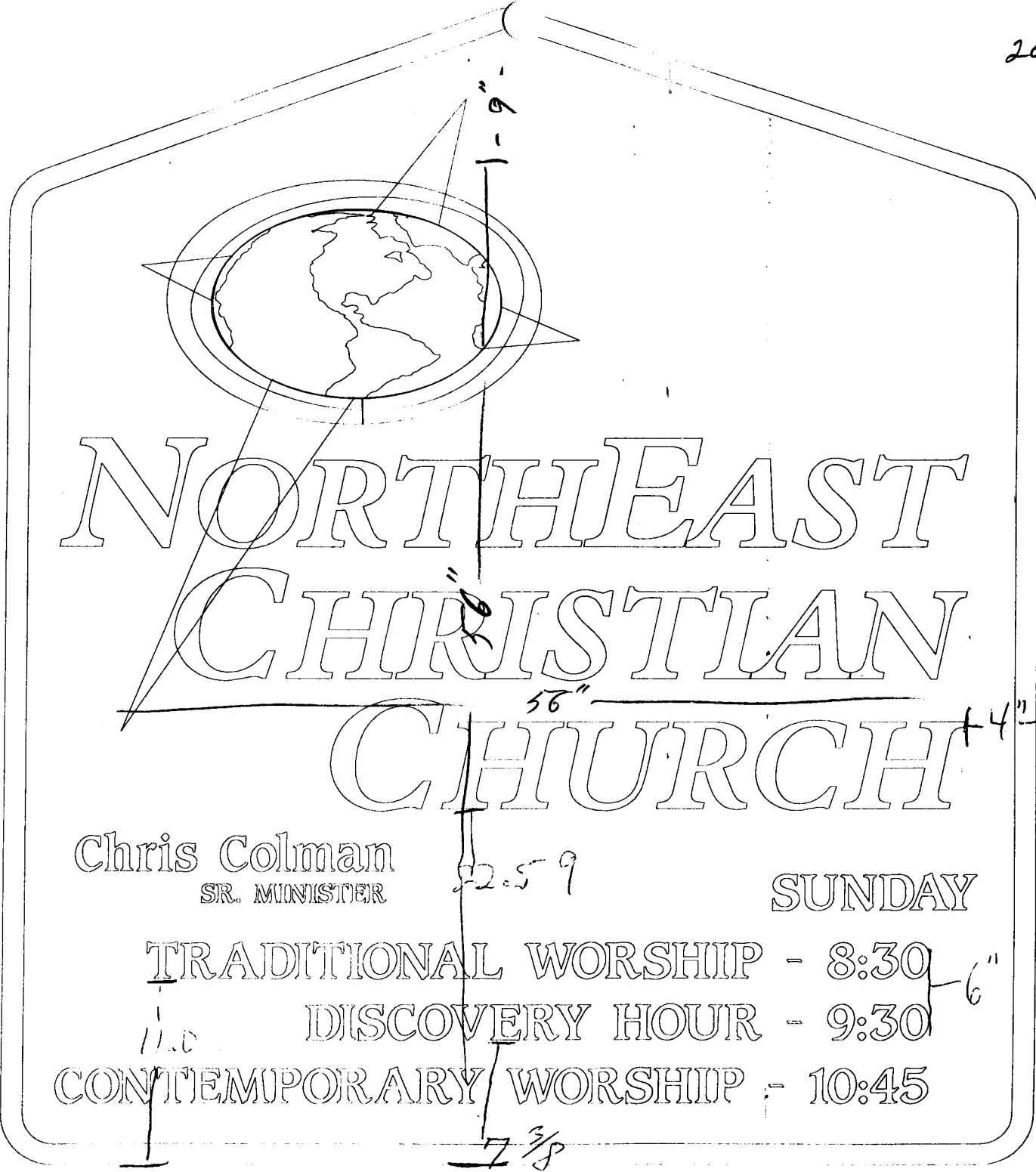

2 1/8

2.59

7 3/8

Chris Colman  
SR. MINISTER

SUNDAY

TRADITIONAL WORSHIP - 8:30

DISCOVERY HOUR - 9:30

CONTEMPORARY WORSHIP - 10:45

11.0

6"

56"

4"

9"

1"