



SIGN PERMIT

EX

Community Development Department
250 North 5th Street
Grand Junction, CO 81501
(970) 244-1430

Permit No. _____
Date Submitted OCT 27, 1999
FEE \$ 500
Tax Schedule 2945-141-11-009
Zone B-3

BUSINESS NAME Antiques & More CONTRACTOR The Sign Source
STREET ADDRESS 904 N. 7th LICENSE NO. 2990565
PROPERTY OWNER Jewellth & Orchard LLC ADDRESS 737 N. 12th
OWNER ADDRESS P.O. Box 130 TELEPHONE NO. 257-1000
Mesa, CO 81643

- 1. FLUSH WALL 2 Square Feet per Linear Foot of Building Facade
- Face Change Only (2,3 & 4):
- 2. ROOF 2 Square Feet per Linear Foot of Building Facade
- 3. FREE-STANDING 2 Traffic Lanes - 0.75 Square Feet x Street Frontage
4 or more Traffic Lanes - 1.5 Square Feet x Street Frontage
- 4. PROJECTING 0.5 Square Feet per each Linear Foot of Building Facade

Existing Externally or Internally Illuminated - No Change in Electrical Service Non-Illuminated

(1 - 4) Area of Proposed Sign 10 Square Feet
(1,2,4) Building Facade _____ Linear Feet
(1 - 4) Street Frontage _____ Linear Feet
(2,3,4) Height to Top of Sign _____ Feet Clearance to Grade _____ Feet

Existing Signage/Type:	
<u>1 flush wall sign</u>	<u>10</u> Sq. Ft.
	Sq. Ft.
	Sq. Ft.
Total Existing:	<u>10</u> Sq. Ft.

● FOR OFFICE USE ONLY ●	
Signage Allowed on Parcel:	<u>7th St.</u>
Building	<u>130</u> Sq. Ft.
Free-Standing	Sq. Ft.
Total Allowed:	<u>130</u> Sq. Ft.

COMMENTS: FACE CHANGE ONLY ON awning

NOTE: No sign may exceed 300 square feet. A separate sign permit is required for each sign. Attach a sketch of proposed and existing signage including types, dimensions, lettering, abutting streets, alleys, easements, property lines, and locations. Roof signs shall be manufactured such that no guy wires, braces or supports shall be visible.

Patty Nelson _____ L. Yernberger _____ 10/27/99
Applicant's Signature Date Community Development Approval Date

(White: Community Development) (Canary: Applicant) (Pink: Code Enforcement)



SIGN PERMIT

Community Development Department
 250 North 5th Street
 Grand Junction, CO 81501
 (970) 244-1430

Permit No. _____
 Date Submitted October 27, 1999
 FEE \$ 250
 Tax Schedule 2945-141-11-009
 Zone B-3

BUSINESS NAME ANTIQUES & MORE CONTRACTOR The Sign Source
 STREET ADDRESS 904 N. 7th LICENSE NO. 2990565
 PROPERTY OWNER TWELFTH & ORCHARD LLC ADDRESS 737 N. 12th St
 OWNER ADDRESS P.O. Box 130 TELEPHONE NO. 257-1000
MESA, CO 81643

1. FLUSH WALL 2 Square Feet per Linear Foot of Building Facade
Face Change Only (2,3 & 4):
 2. ROOF 2 Square Feet per Linear Foot of Building Facade
 3. FREE-STANDING 2 Traffic Lanes - 0.75 Square Feet x Street Frontage
 4 or more Traffic Lanes - 1.5 Square Feet x Street Frontage
 4. PROJECTING 0.5 Square Feet per each Linear Foot of Building Facade

Existing Externally or Internally Illuminated - No Change in Electrical Service Non-Illuminated

(1 - 4) Area of Proposed Sign 10 Square Feet
 (1,2,4) Building Facade _____ Linear Feet
 (1 - 4) Street Frontage _____ Linear Feet
 (2,3,4) Height to Top of Sign _____ Feet Clearance to Grade _____ Feet

Existing Signage/Type: <u>AWNING</u>	
<u>0</u> Flushwall	<u>0</u> Sq. Ft.
	Sq. Ft.
	Sq. Ft.
Total Existing:	<u>0</u> Sq. Ft.

● FOR OFFICE USE ONLY ●	
Signage Allowed on Parcel: <u>Teller Ave</u>	
Building	<u>100</u> Sq. Ft.
Free-Standing	Sq. Ft.
Total Allowed:	<u>100</u> Sq. Ft.

COMMENTS: FACE CHANGE ONLY ON AWNINGS

NOTE: No sign may exceed 300 square feet. A separate sign permit is required for each sign. Attach a sketch of proposed and existing signage including types, dimensions, lettering, abutting streets, alleys, easements, property lines, and locations. Roof signs shall be manufactured such that no guy wires, braces or supports shall be visible.

Patty Nelson 10/27/99 K. Gerstenberger 10/27/99
 Applicant's Signature Date Community Development Approval Date

(White: Community Development) (Canary: Applicant) (Pink: Code Enforcement)



SIGN PERMIT

Community Development Department
 250 North 5th Street
 Grand Junction, CO 81501
 (970) 244-1430

Permit No. _____
 Date Submitted OCT 27, 1999
 FEE \$ 5⁰⁰
 Tax Schedule 2945-141-11-009
 Zone B-3

BUSINESS NAME Antiques & More CONTRACTOR The Sign Source
 STREET ADDRESS 904 N. 7th LICENSE NO. 2990565
 PROPERTY OWNER Twelfth & Orchard LLC ADDRESS 737 N. 12th St
 OWNER ADDRESS P.O. Box 130 TELEPHONE NO. 257-1000
Mesa, CO 81643

- 1. FLUSH WALL 2 Square Feet per Linear Foot of Building Facade
- Face Change Only (2,3 & 4):**
- 2. ROOF 2 Square Feet per Linear Foot of Building Facade
- 3. FREE-STANDING 2 Traffic Lanes - 0.75 Square Feet x Street Frontage
4 or more Traffic Lanes - 1.5 Square Feet x Street Frontage
- 4. PROJECTING 0.5 Square Feet per each Linear Foot of Building Facade

Existing Externally or Internally Illuminated - No Change in Electrical Service Non-Illuminated

(1 - 4) Area of Proposed Sign 10 Square Feet
 (1,2,4) Building Facade _____ Linear Feet
 (1 - 4) Street Frontage _____ Linear Feet
 (2,3,4) Height to Top of Sign _____ Feet Clearance to Grade _____ Feet

Existing Signage/Type:	
<u>1 flush wall sign</u>	<u>10</u> Sq. Ft.
	Sq. Ft.
	Sq. Ft.
Total Existing:	<u>10</u> Sq. Ft.

● FOR OFFICE USE ONLY ●	
Signage Allowed on Parcel:	<u>7th St.</u>
Building	<u>130</u> Sq. Ft.
Free-Standing	Sq. Ft.
Total Allowed:	<u>130</u> Sq. Ft.

COMMENTS: Face Change Only on Awning

NOTE: No sign may exceed 300 square feet. A separate sign permit is required for each sign. Attach a sketch of proposed and existing signage including types, dimensions, lettering, abutting streets, alleys, easements, property lines, and locations. Roof signs shall be manufactured such that no guy wires, braces or supports shall be visible.

Patty Nelson 10/27/99 L. Yerstemberger 10/27/99
 Applicant's Signature Date Community Development Approval Date

(White: Community Development)

(Canary: Applicant)

(Pink: Code Enforcement)

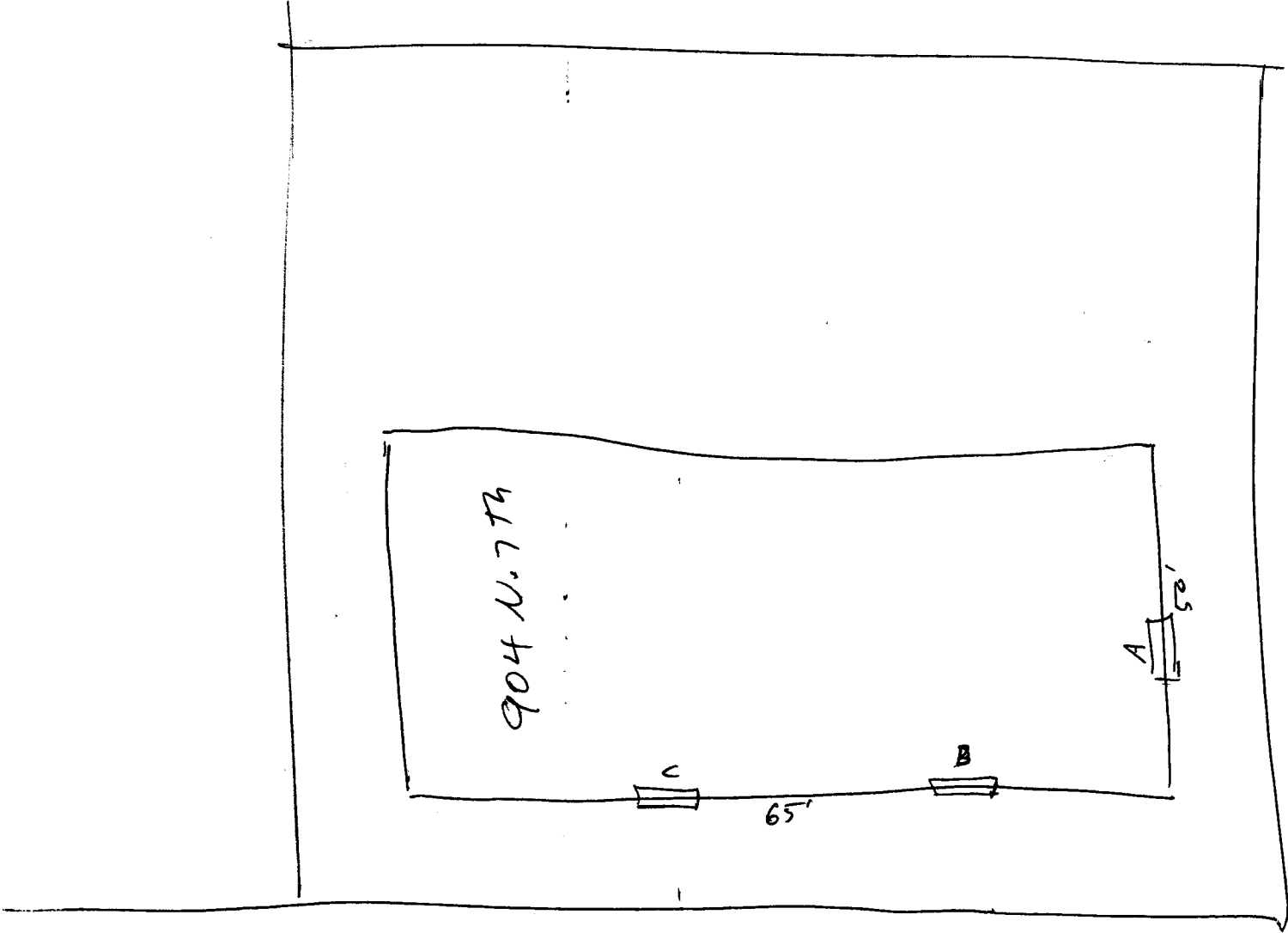

TELLER

7th street

N ↑

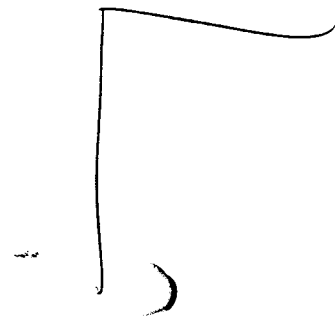

Antiquities and Monuments

22

66"

10 58 ft.