



SIGN PERMIT

Community Development Department
 250 North 5th Street
 Grand Junction, CO 81501
 (970) 244-1430

YJ

Permit No. _____
 Date Submitted 1-18-99
 FEE \$ 25.00
 Tax Schedule 2945-261-29-002
 Zone PB

BUSINESS NAME WEAVER LAUNDRY MAT CONTRACTOR ELIZABETH SIGNS
 STREET ADDRESS 2691 HWY 50 / OREH. MESA PLAZA LICENSE NO. 2990283
 PROPERTY OWNER JERRY HARRIS ADDRESS 323 FRONT ST, CUERVO
 OWNER ADDRESS 2691 HWY 50 TELEPHONE NO. 245-7446

- 1. FLUSH WALL 2 Square Feet per Linear Foot of Building Facade
- Face Change Only (2, 3 & 4):
- 2. ROOF 2 Square Feet per Linear Foot of Building Facade
- 3. FREE-STANDING 2 Traffic Lanes - 0.75 Square Feet x Street Frontage
4 or more Traffic Lanes - 1.5 Square Feet x Street Frontage
- 4. PROJECTING 0.5 Square Feet per each Linear Foot of Building Facade

Existing Externally or Internally Illuminated - No Change in Electrical Service Non-Illuminated

(1 - 4) Area of Proposed Sign 36 Square Feet
 (1,2,4) Building Facade 325 Linear Feet
 (1 - 4) Street Frontage 310 Linear Feet
 (2,4) Height to Top of Sign 10 Feet Clearance to Grade _____ Feet

Existing Signage/Type:	
	Sq. Ft.
	Sq. Ft.
	Sq. Ft.
Total Existing:	<u>36</u> Sq. Ft.

● FOR OFFICE USE ONLY ●		
Signage Allowed on Parcel: <u>Hwy 50</u>		
Building	<u>650</u>	Sq. Ft.
Free-Standing	<u>465</u> 320	Sq. Ft.
Total Allowed:		Sq. Ft.

COMMENTS: REPLACE EXISTING ILLUMINATED SIGN

NOTE: No sign may exceed 300 square feet. A separate sign permit is required for each sign. Attach a sketch of proposed and existing signage including types, dimensions, lettering, abutting streets, alleys, easements, property lines, and locations.

[Signature] 1-18-99 [Signature] 1/18/99
 Applicant's Signature Date Community Development Approval Date

(White: Community Development) (Canary: Applicant) (Pink: Code Enforcement)

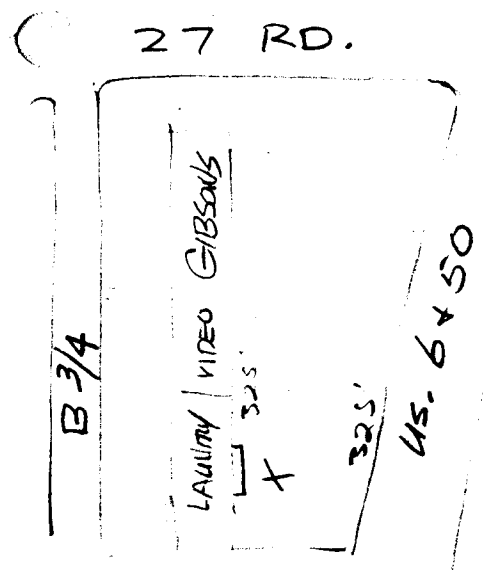

3423 FRONT ST. CLIFTON, CO. 81520
 "Electric Sign Fabricators For Over 30 Years"
 970-245-SIGN (7446) 523-NEON (6366)

