



SIGN CLEARANCE

Community Development Department
250 North 5th Street
Grand Junction, CO 81501
(970) 244-1430

Clearance No. 73775
Date Submitted 2-2-00
FEE \$ 25.00
Tax Schedule 2945-144-28-017
Zone C-2

BUSINESS NAME Grand Mesa Graphics CONTRACTOR The Sign Gallery
STREET ADDRESS 223 S. 9th Street LICENSE NO. 2990226
PROPERTY OWNER Richard Owens ADDRESS 1048 Independent Suite A109
OWNER ADDRESS 229 S 9th TELEPHONE NO. 241-6400

- 1. FLUSH WALL 2 Square Feet per Linear Foot of Building Facade
- 2. ROOF 2 Square Feet per Linear Foot of Building Facade
- 3. FREE-STANDING 2 Traffic Lanes - 0.75 Square Feet x Street Frontage
4 or more Traffic Lanes - 1.5 Square Feet x Street Frontage
- 4. PROJECTING 0.5 Square Feet per each Linear Foot of Building Facade
- 5. OFF-PREMISE See #3 Spacing Requirements; Not > 300 Square Feet or < 15 Square Feet

Externally Illuminated Internally Illuminated Non-Illuminated

- (1 - 5) Area of Proposed Sign 30 Square Feet
- (1,2,4) Building Facade 105 Linear Feet
- (1 - 4) Street Frontage 125 Linear Feet
- (2 - 5) Height to Top of Sign 13 Feet Clearance to Grade 10 Feet
- (5) Distance from all Existing Off-Premise Signs within 600 Feet _____ Feet

Existing Signage/Type:	
<u>Roof</u>	<u>98</u> Sq. Ft.
	Sq. Ft.
	Sq. Ft.
Total Existing:	<u>98</u> Sq. Ft.

● FOR OFFICE USE ONLY ●	
Signage Allowed on Parcel:	<u>98</u>
Building	<u>210</u> Sq. Ft.
Free-Standing	<u>94</u> Sq. Ft.
Total Allowed:	<u>210</u> Sq. Ft.

COMMENTS: Existing 3'x8' for Grand Mesa Graphics will be replaced with a 3'x10'

NOTE: No sign may exceed 300 square feet. A separate sign clearance is required for each sign. Attach a sketch of proposed and existing signage including types, dimensions, lettering, abutting streets, alleys, easements, property lines, and locations. **A SEPARATE PERMIT FROM THE BUILDING DEPARTMENT IS REQUIRED.**

Larry L. Bowler 2-2-2000 Kimberly L. Caldwell 2/2/2000
Applicant's Signature Date Community Development Approval Date

(White: Community Development) (Canary: Applicant) (Pink: Building Dept) (Goldenrod: Code Enforcement)

Grand Media Graphics
223 S. 9th

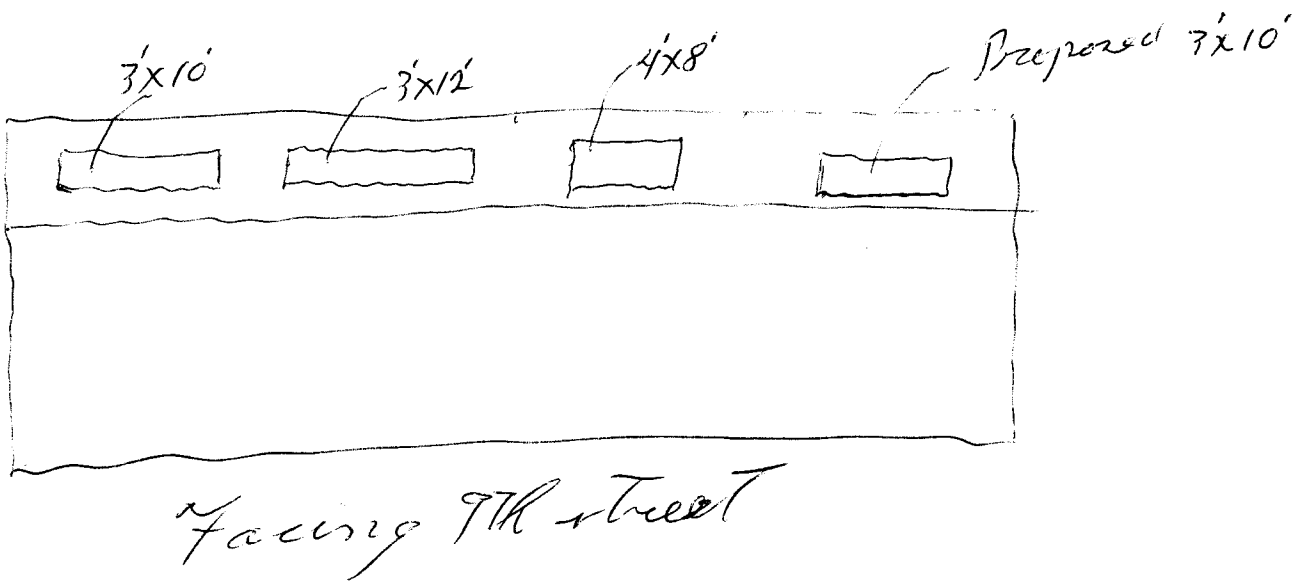
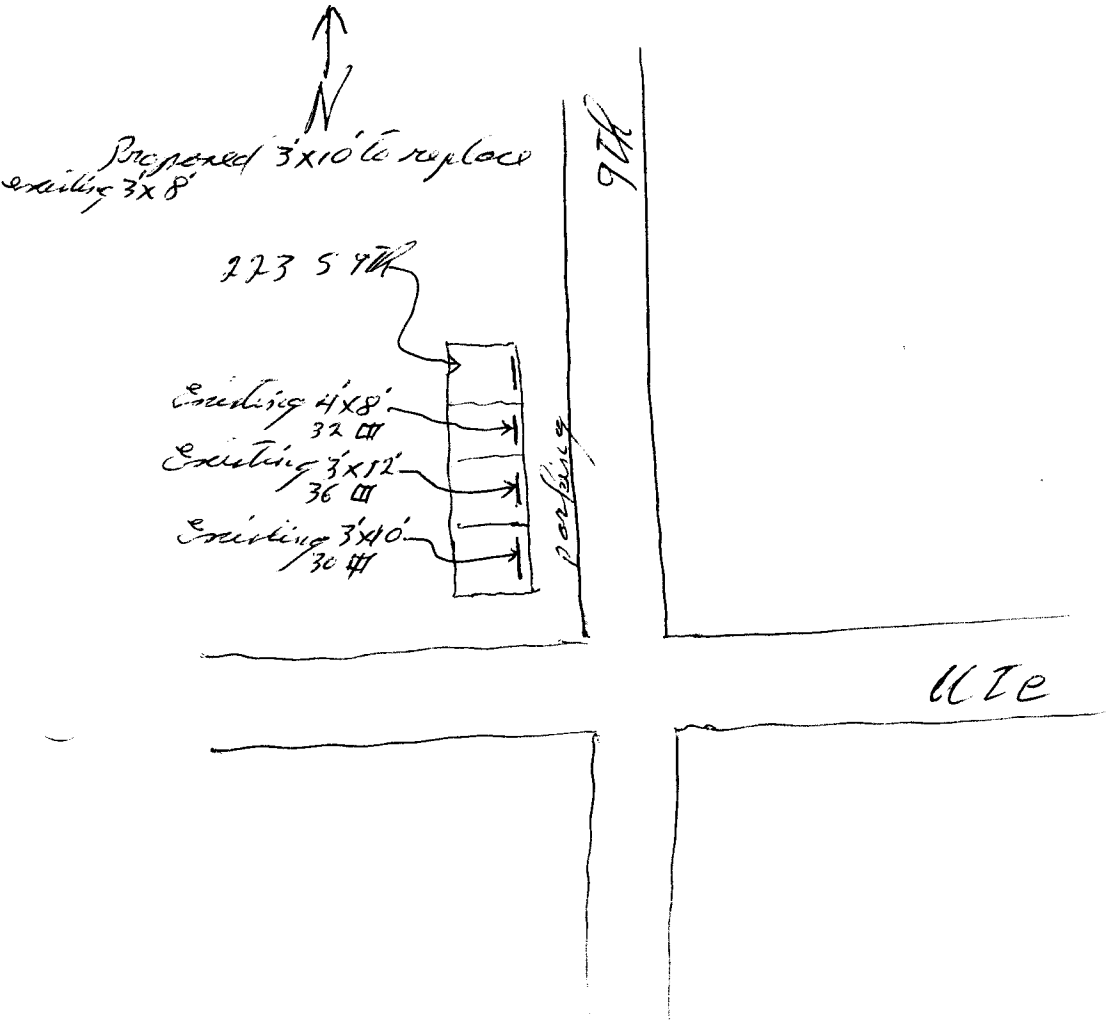

223 59th
30 #1

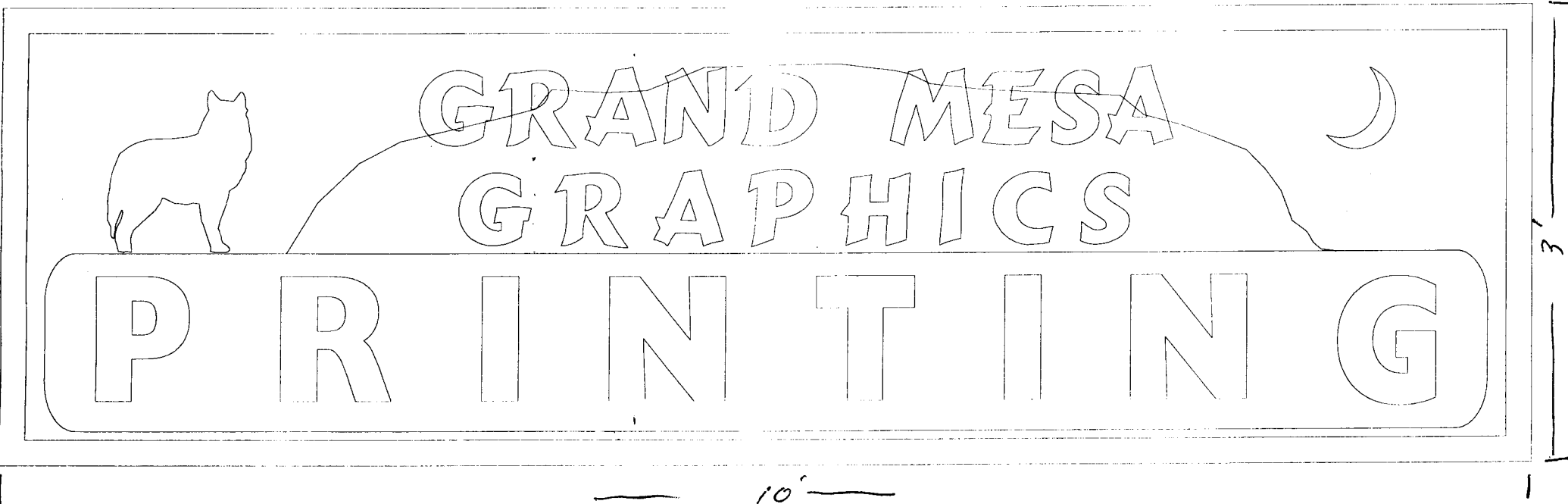

Examples of Roof Signs

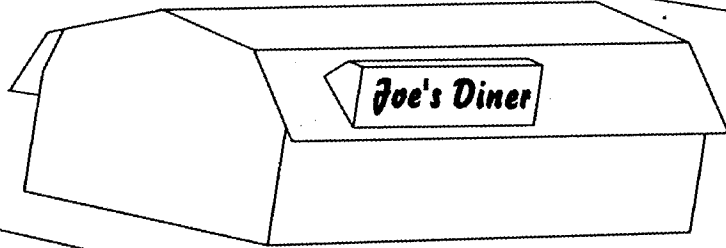
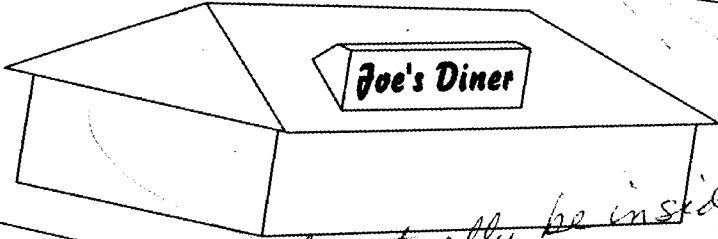
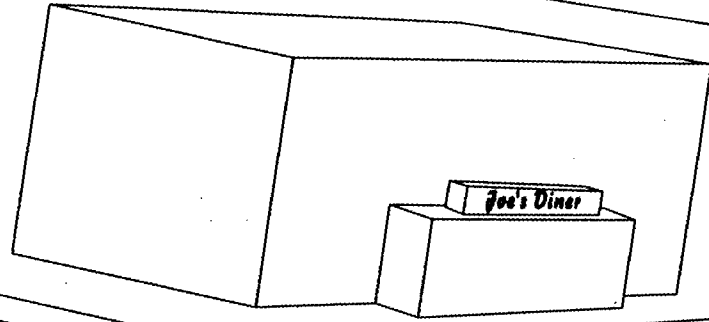
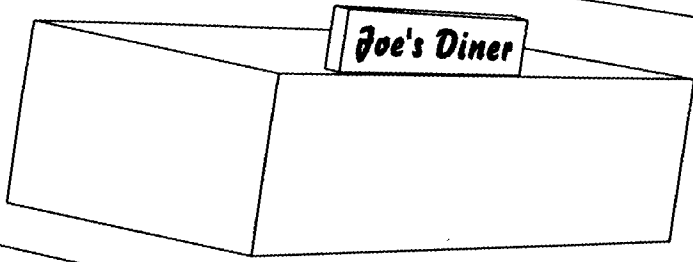

brackets will actually be inside covered

