



# SIGN PERMIT B

Community Development Department  
250 North 5th Street  
Grand Junction, CO 81501  
(970) 244-1430

Permit No. \_\_\_\_\_  
Date Submitted 10/20/00  
FEE \$ 125.00  
Tax Schedule 2945-143-49-004  
Zone B-2

BUSINESS NAME Rich D. Wagner  
STREET ADDRESS 300 Main Street  
PROPERTY OWNER unit 301  
OWNER ADDRESS Thomas Nielsen

CONTRACTOR The Sign Gallery  
LICENSE NO. 270212  
ADDRESS 1048 Independent A-109  
TELEPHONE NO. 241-6400

- 1. FLUSH WALL 2 Square Feet per Linear Foot of Building Facade
- Face Change Only (2,3 & 4):
- 2. ROOF 2 Square Feet per Linear Foot of Building Facade
- 3. FREE-STANDING 2 Traffic Lanes - 0.75 Square Feet x Street Frontage  
4 or more Traffic Lanes - 1.5 Square Feet x Street Frontage
- 4. PROJECTING 0.5 Square Feet per each Linear Foot of Building Facade

Existing Externally or Internally Illuminated - No Change in Electrical Service  Non-Illuminated

(1 - 4) Area of Proposed Sign 12 Square Feet  
(1,2,4) Building Facade 90 Linear Feet  
(1 - 4) Street Frontage 90 Linear Feet  
(2,3,4) Height to Top of Sign 18 1/2 Feet Clearance to Grade 18 1/2 Feet

Existing Signage/Type:	Sq. Ft.
	Sq. Ft.
	Sq. Ft.
	Sq. Ft.
Total Existing:	<u>0</u> Sq. Ft.

● FOR OFFICE USE ONLY ●	
Signage Allowed on Parcel:	<u>3rd St</u>
Building	<u>180</u> Sq. Ft.
Free-Standing	<u>67.5</u> Sq. Ft.
Total Allowed:	<u>180</u> Sq. Ft.

COMMENTS: Individual letters mounted on the wall.

**NOTE:** No sign may exceed 300 square feet. A separate sign permit is required for each sign. Attach a sketch of proposed and existing signage including types, dimensions, lettering, abutting streets, alleys, easements, property lines, and locations. Roof signs shall be manufactured such that no guy wires, braces or supports shall be visible.

Larry L Beaulac 10-20-00 J. Yurstenberger 10/25/00  
Applicant's Signature Date Community Development Approval Date

(White: Community Development) (Canary: Applicant) (Pink: Code Enforcement)

10/25/00

The Sign Gallery  
1048 Independent A-109  
Grand Junction, Co.

The purpose of this letter is to clarify our Department's policy on issuance of sign permits. A formal issuance of a sign permit requires the permit fee to be paid and the permit to be picked up by the sign contractor before any signs can be installed or worked on. The installation of signs without an approved permit will result in a penalty of \$100 in addition to the sign permit fee. Our staff has been instructed to collect this penalty if the proper procedure is not followed. This is your one and only official warning notice.

Please do not hesitate to contact me if you have any questions.

Sincerely,

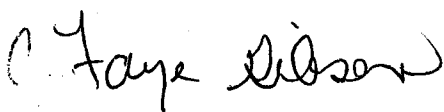
A handwritten signature in cursive script that reads "C. Faye Gibson". The signature is written in dark ink and is positioned below the word "Sincerely,".

C. Faye Gibson  
Planning Technician

300 Main

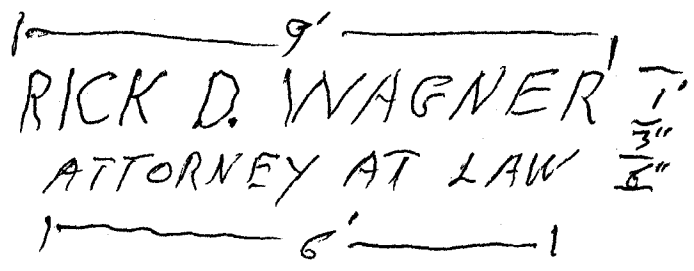
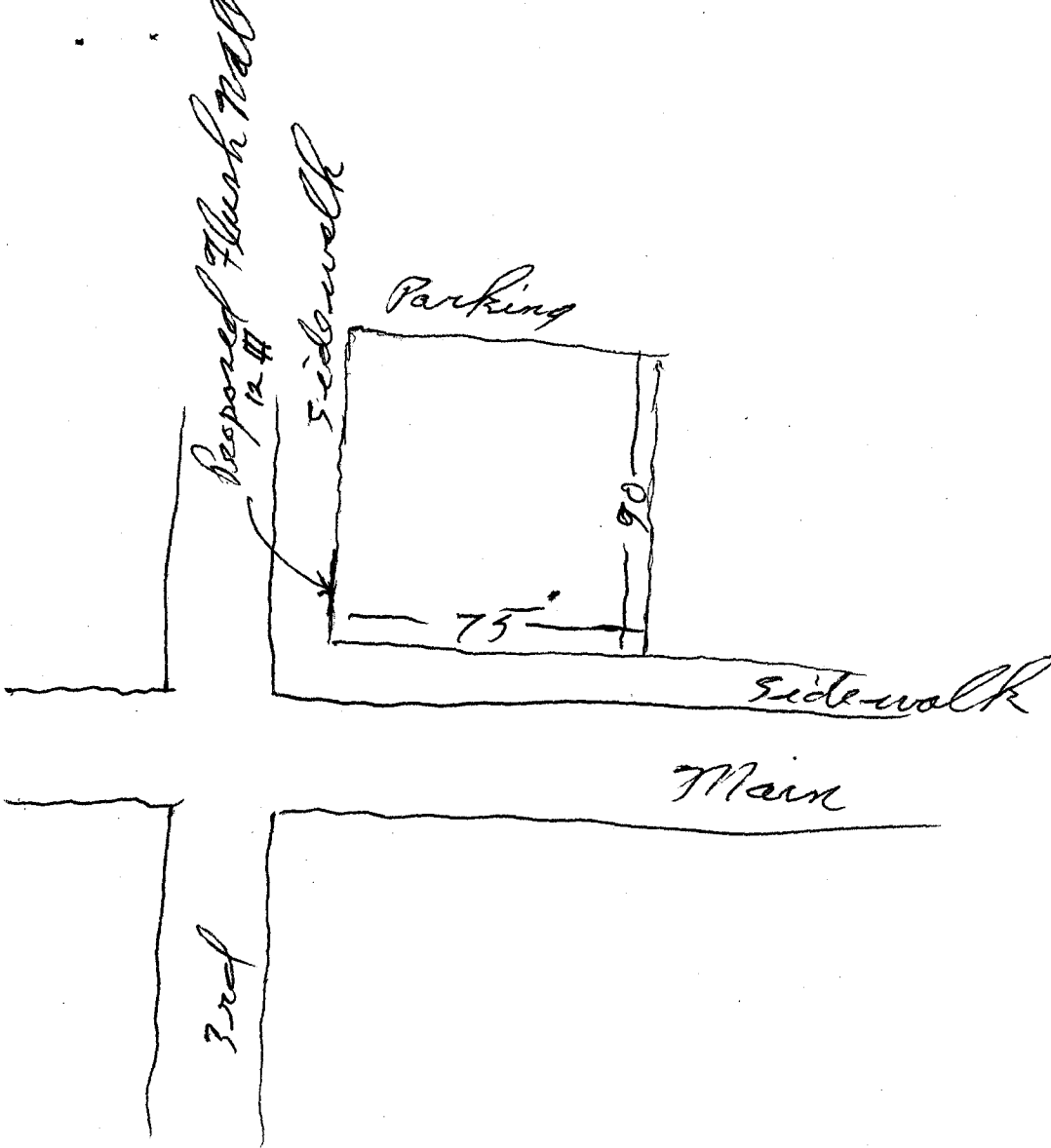

Proposed sign  
 Individual letters 12 ft

