



SIGN PERMIT



Community Development Department
 250 North 5th Street
 Grand Junction, CO 81501
 (970) 244-1430

Permit No. _____
 Date Submitted 10/24/00
 FEE \$ 25⁰⁰
 Tax Schedule 2945-143-49-201
 Zone B-2

BUSINESS NAME BURKE CONSTRUCTION
 STREET ADDRESS 300 Main St.
 PROPERTY OWNER 300 Main St. J & K
 OWNER ADDRESS 300 Main St
Sta 201

CONTRACTOR The Sign Source, Inc
 LICENSE NO. 2201095
 ADDRESS 737 N. 12th
 TELEPHONE NO. 257-1000

1. FLUSH WALL 2 Square Feet per Linear Foot of Building Facade
Face Change Only (2,3 & 4):
 2. ROOF 2 Square Feet per Linear Foot of Building Facade
 3. FREE-STANDING 2 Traffic Lanes - 0.75 Square Feet x Street Frontage
 4 or more Traffic Lanes - 1.5 Square Feet x Street Frontage
 4. PROJECTING 0.5 Square Feet per each Linear Foot of Building Facade

Existing Externally or Internally Illuminated - No Change in Electrical Service Non-Illuminated

- (1 - 4) Area of Proposed Sign 9 Square Feet
 (1,2,4) Building Facade 90 Linear Feet
 (1 - 4) Street Frontage 90 Linear Feet
 (2,4) Height to Top of Sign _____ Feet Clearance to Grade _____ Feet

Existing Signage/Type:	
<u>Flush wall (3rd street)</u>	<u>12</u> <u>10.6</u> Sq. Ft.
	Sq. Ft.
	Sq. Ft.
Total Existing:	<u>12</u> <u>10.6</u> Sq. Ft.

● FOR OFFICE USE ONLY ●		
Signage Allowed on Parcel: <u>3rd St.</u>		
Building	<u>180</u>	Sq. Ft.
Free-Standing	<u>67.5</u>	Sq. Ft.
Total Allowed:	<u>180</u>	Sq. Ft.

COMMENTS: _____

NOTE: No sign may exceed 300 square feet. A separate sign permit is required for each sign. Attach a sketch of proposed and existing signage including types, dimensions, lettering, abutting streets, alleys, easements, property lines, and locations.

Terry Martin 10/24/00 Luis V. Roman 10-25-00
 Applicant's Signature Date Community Development Approval Date

(White: Community Development)

(Canary: Applicant)

(Pink: Code Enforcement)

SLC

10.6 sq ft

8'

RICE D. WATNER
ATTORNEY AT LAW

① Existing Sign

MAIN ST

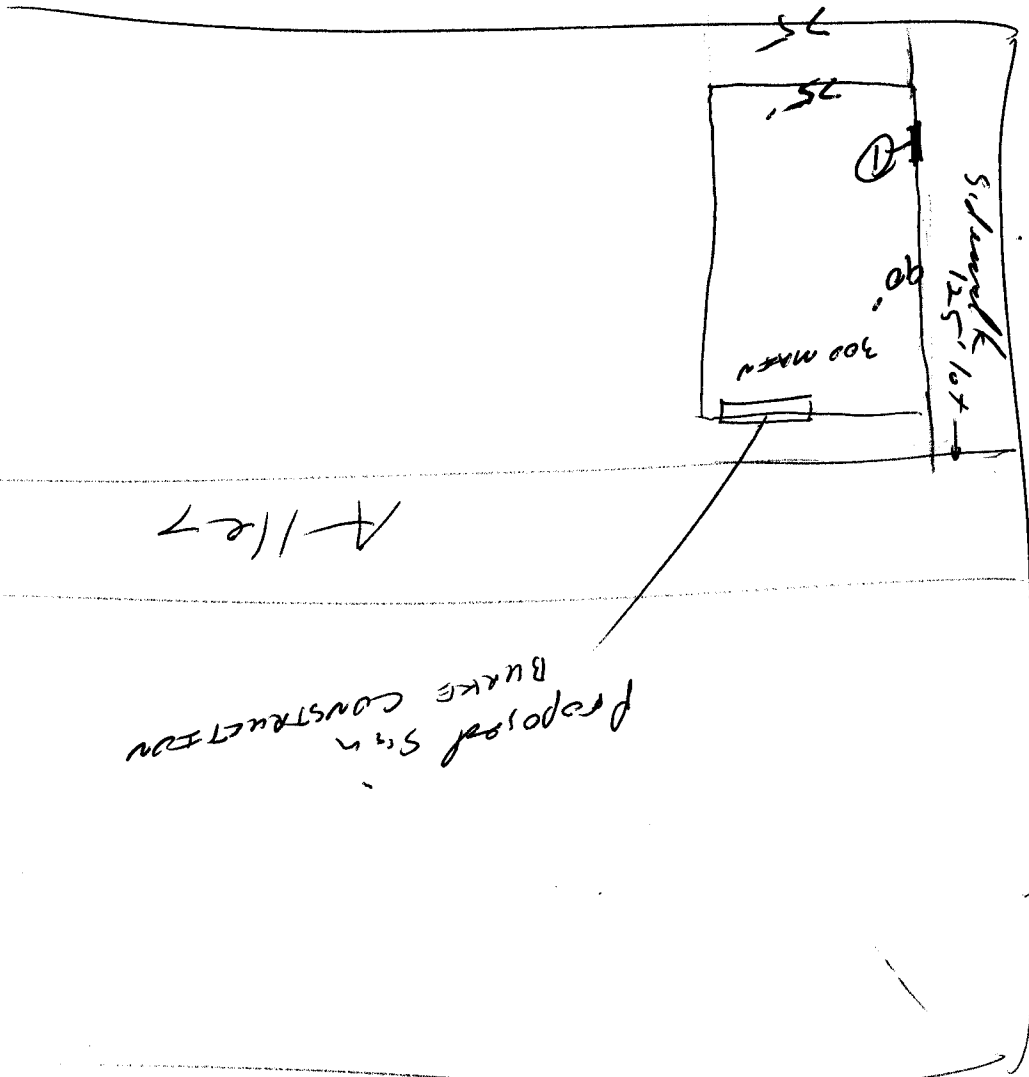

Proposed Sign
BUAKE CONSTRUCTION

3rd Street

Proposed Sign 9.53 Ft.



BURKE CONSTRUCTION