



SIGN CLEARANCE

Community Development Department
250 North 5th Street
Grand Junction, CO 81501
(970) 244-1430

Clearance No. _____
Date Submitted 3-29-00
FEE \$ 25.00
Tax Schedule 2945-073-00-211
Zone C-1

BUSINESS NAME Wells Fargo Bank CONTRACTOR Western Neon Sign Co
STREET ADDRESS 512 28 Rd. LICENSE NO. 2200 334
PROPERTY OWNER United Bank of Grand Jct. ADDRESS 3183 Hall Ave Grand Jct
OWNER ADDRESS PO Box 2798 TELEPHONE NO. 523 4045
Littleton Co. 80161-2798

- 1. FLUSH WALL 2 Square Feet per Linear Foot of Building Facade
- 2. ROOF 2 Square Feet per Linear Foot of Building Facade
- 3. FREE-STANDING 2 Traffic Lanes - 0.75 Square Feet x Street Frontage
4 or more Traffic Lanes - 1.5 Square Feet x Street Frontage
- 4. PROJECTING 0.5 Square Feet per each Linear Foot of Building Facade
- 5. OFF-PREMISE See #3 Spacing Requirements; Not > 300 Square Feet or < 15 Square Feet

Externally Illuminated Internally Illuminated Non-Illuminated

- 1 - 5) Area of Proposed Sign 27.8 Square Feet
- (1,2,4) Building Facade 84 Linear Feet
- (1 - 4) Street Frontage 168.5 Linear Feet 28th st
- (2 - 5) Height to Top of Sign 12 Feet Clearance to Grade 7'10" Feet
- (5) Distance from all Existing Off-Premise Signs within 600 Feet _____ Feet

Existing Signage/Type:	
<u>Replaced</u>	Sq. Ft.
	Sq. Ft.
	Sq. Ft.
Total Existing:	Sq. Ft.

● FOR OFFICE USE ONLY ●		
Signage Allowed on Parcel:		
Building	<u>168</u>	Sq. Ft.
Free-Standing	<u>126</u>	Sq. Ft.
Total Allowed:	<u>168</u>	Sq. Ft.

COMMENTS: _____

NOTE: No sign may exceed 300 square feet. A separate sign clearance is required for each sign. Attach a sketch of proposed and existing signage including types, dimensions, lettering, abutting streets, alleys, easements, property lines, and locations. **A SEPARATE PERMIT FROM THE BUILDING DEPARTMENT IS REQUIRED.**

Ray McManis 3/29/00 Pat Pat 3-29-00
Applicant's Signature Date Community Development Approval Date

(White: Community Development) (Canary: Applicant) (Pink: Building Dept) (Goldenrod: Code Enforcement)

K17 (800) 444-7446-213

Plasti-Line, Inc.			Purchase Order #: NCO1032		
Z3	NCO1032				
02/09/2000	Grand Junction / Auto Bank				
Erector: Western Neon	2808 North Ave				
#	Grand Junction				
Sign #	Code	Qty	Description	Install	Total
R1	CUSTOM1	1	To be handled by CPG, No Plasti-Line Responsibility	-	-
R2	M-22-5	1	22 sq.ft. illum. monument @ 5' oah	1,006	1,006
R3	CUSTOM	1	Custom Replacment Sign - See Comments Below	-	-
R4	CUSTOM	1	Custom Replacment Sign - See Comments Below	-	-
R5	CUSTOM	1	Custom Replacment Sign - See Comments Below	-	-
R6	CUSTOM1	1	To be handled by CPG, No Plasti-Line Responsibility <i>Face replacment</i>	-	-
R7	D-6 D-3	1	6 sq.ft. non-illum. directional @ 54" oah - standard	186	186
R8	D-6 D-3	1	6 sq.ft. non-illum. directional @ 54" oah - standard	186	186
R9	REG 4P	2	24" x 24" s.f. pole 'Custom Copy'	110	220
R10	D-6 D-3	1	6 sq.ft. non-illum. directional @ 54" oah - standard	186	186
R11	D-6 D-3	1	6 sq.ft. non-illum. directional @ 54" oah - standard	186	186
R12	D-6 D-3	1	6 sq.ft. non-illum. directional @ 54" oah - standard	186	186
R13	D-6 D-3	1	6 sq.ft. non-illum. directional @ 54" oah - standard	186	186
R14	n/a	-	n/a	-	-
R15	n/a	-	n/a	-	-
R16	LEAVE	1	Leave Existing Sign	-	-
R17	D-6 D-3	1	6 sq.ft. non-illum. directional @ 54" oah - standard	186	186
R18	REG 4	1	24" x 24" s.f. wall 'Custom Copy'	85	85
R19	LEAVE	-	Leave Existing Sign	-	-
R20	REG 4	2	24" x 24" s.f. wall 'Custom Copy'	85	170
R21	REG 4	2	24" x 24" s.f. wall 'Custom Copy'	85	170
R22	D-6 D-3	1	6 sq.ft. non-illum. directional @ 54" oah - standard	186	186
R23	D-6 D-3	1	6 sq.ft. non-illum. directional @ 54" oah - standard	186	186
R24	REG 4	1	24" x 24" s.f. wall 'Custom Copy'	85	85
R25	REG 4	1	24" x 24" s.f. wall 'Custom Copy'	85	85
R26	REG 1C	1	9" X 31" s.f. wall 'Custom Copy'	85	85
R27	REG 1C	1	9" X 31" s.f. wall 'Custom Copy'	85	85
R28	REG 4	1	24" x 24" s.f. wall 'Custom Copy'	85	85
R29	D-6 D-3	1	6 sq.ft. non-illum. directional @ 54" oah - standard	186	186
R30	REG 1C	1	9" X 31" s.f. wall 'Custom Copy'	85	85
R31	REG 1C	1	9" X 31" s.f. wall 'Custom Copy'	85	85
R32	REG 1C	1	9" X 31" s.f. wall 'Custom Copy'	85	85
R33	REG 4	1	24" x 24" s.f. wall 'Custom Copy'	85	85
R34	REG 4	1	24" x 24" s.f. wall 'Custom Copy'	85	85
R35	n/a	-	n/a	-	-
Electrical				-	-
Engineering				-	-
Technical Survey				-	-
Painting, Repairs, & Patching				-	-
Removals & Scrap				2,939	2,939
Travel				-	-
Permits (At Cost)				-	-
Staff Time (\$40 per documented hour required to obtain permit)				-	-
Total					\$7,300

"The Plasti-Line "Erector Guidelines" packet is a legally binding extension of this Purchase Order. Contact Plasti-Line Immediately if you do not have this publication or have any questions or concerns.

Comments:

Leave and paint existing pole for E22, E23

R26 & R27 attach to guardrail

0



Plot Plan

Facilities Survey Program

Site Name: NCO1032
 Address: Grand Junction/Auto Bank
 2808 North Avenue
 Grand Junction, CO 81501

Legend

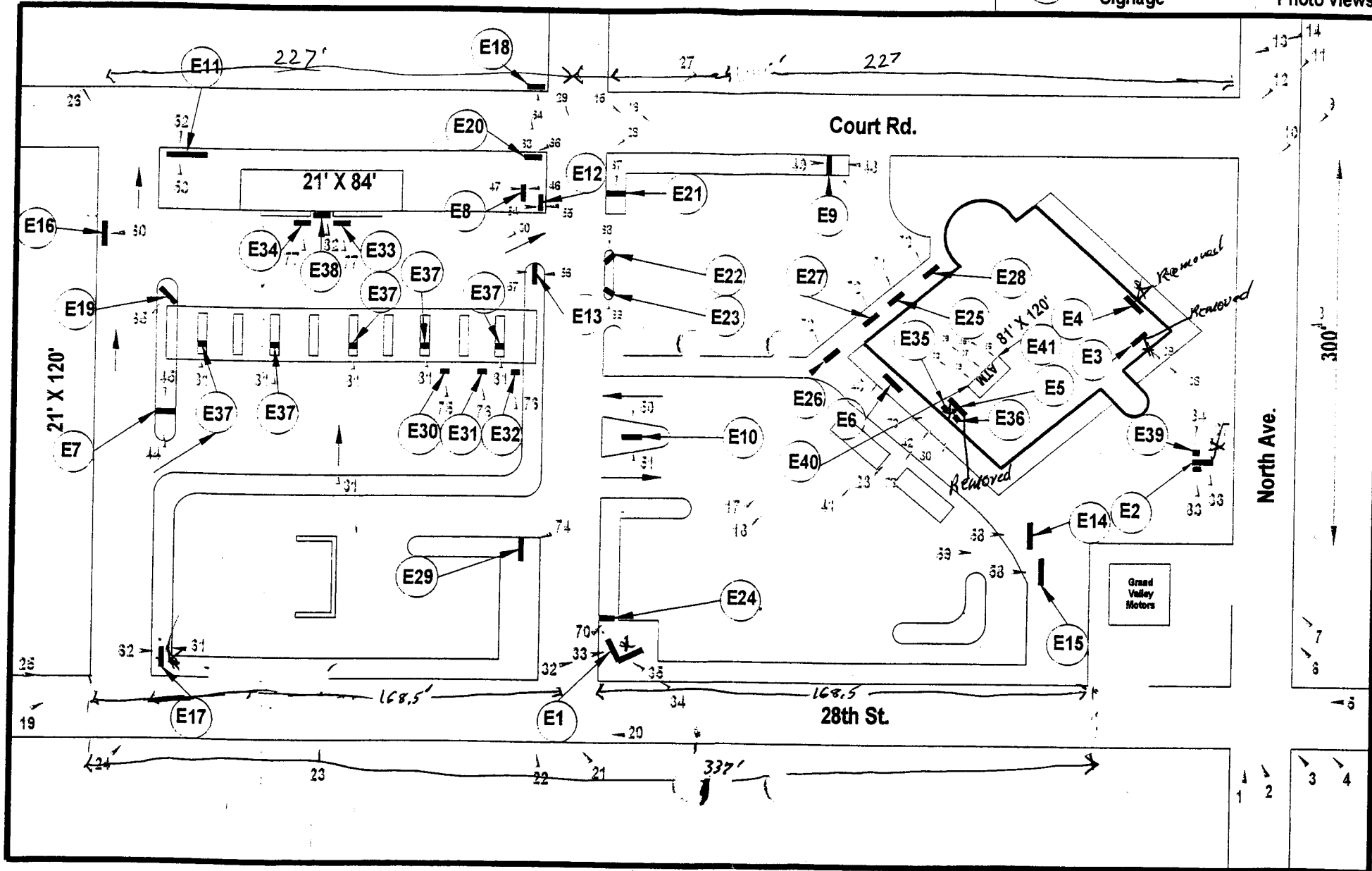
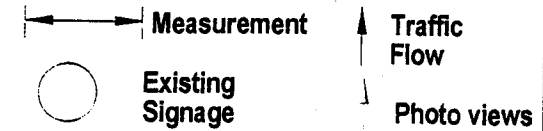

*all signs except
 E2 & E17
 will be either
 be removed or
 replaced with
 conforming signs
 E1 will be done at
 later date*

102

Exterior Sign Family Standard

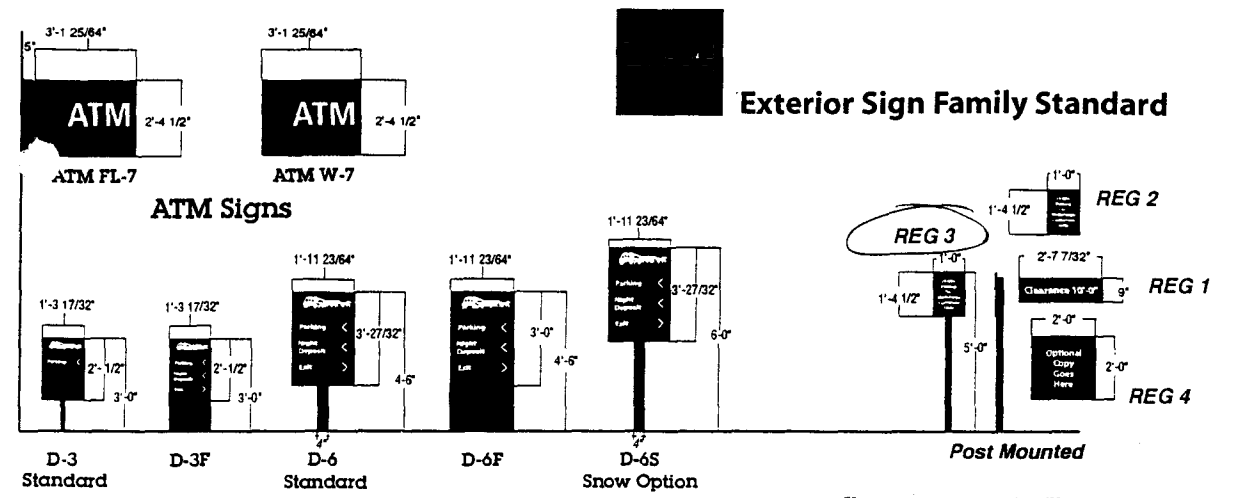
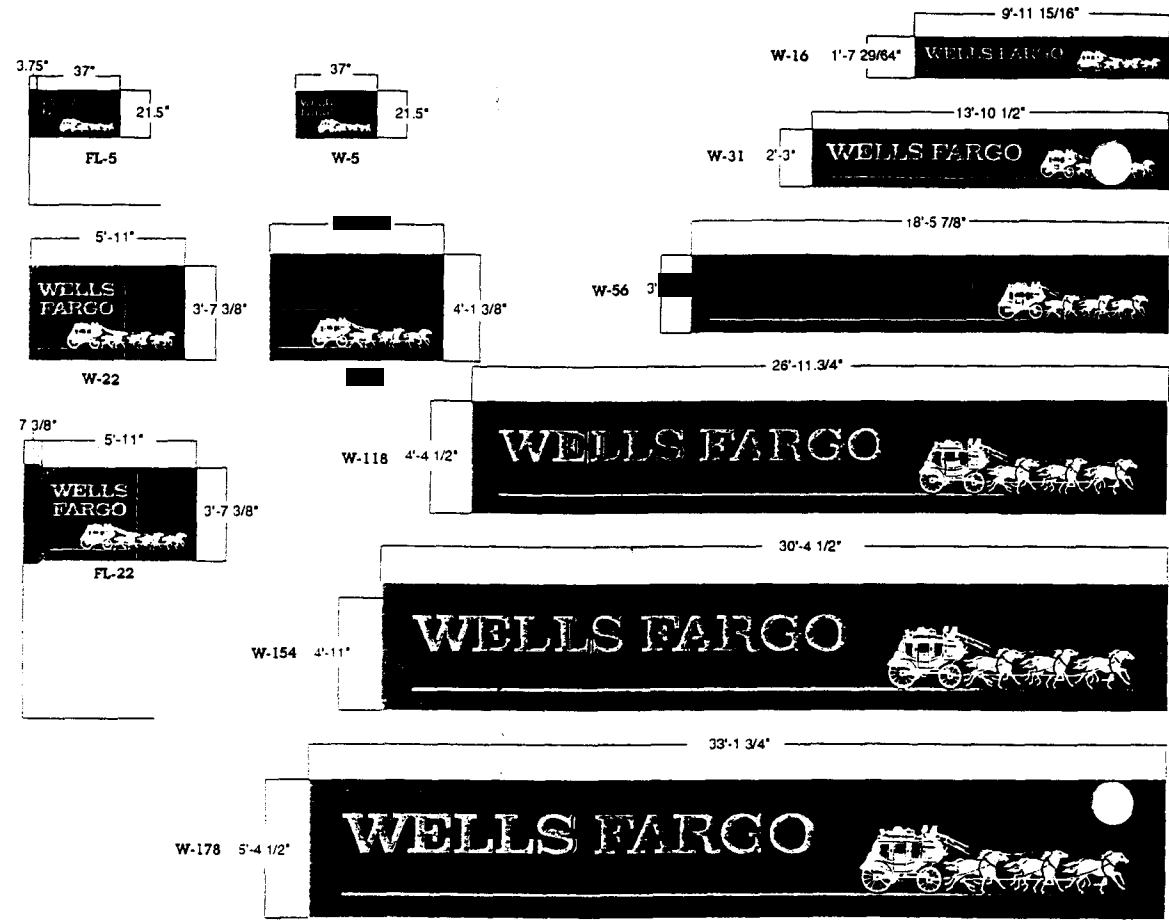

Directional Signs

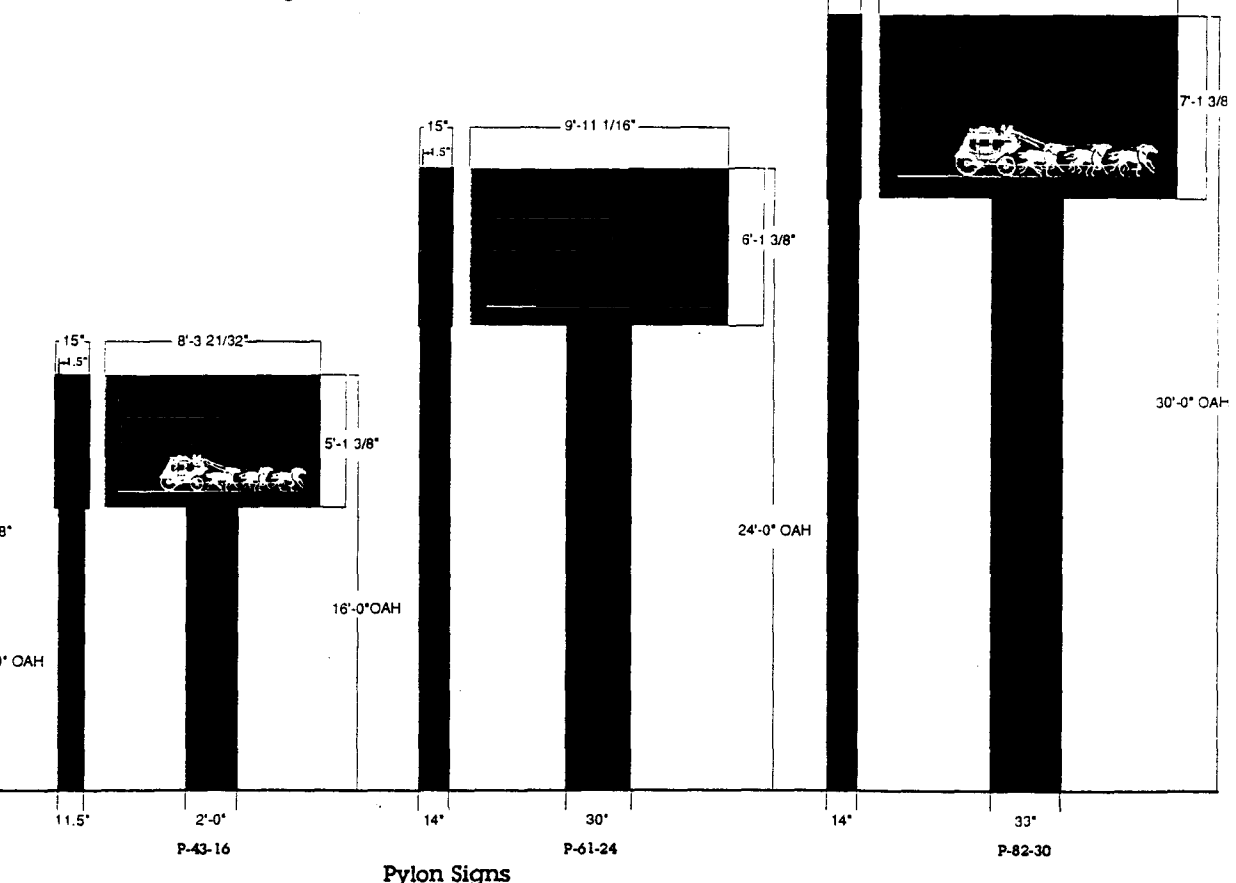

Monument Signs

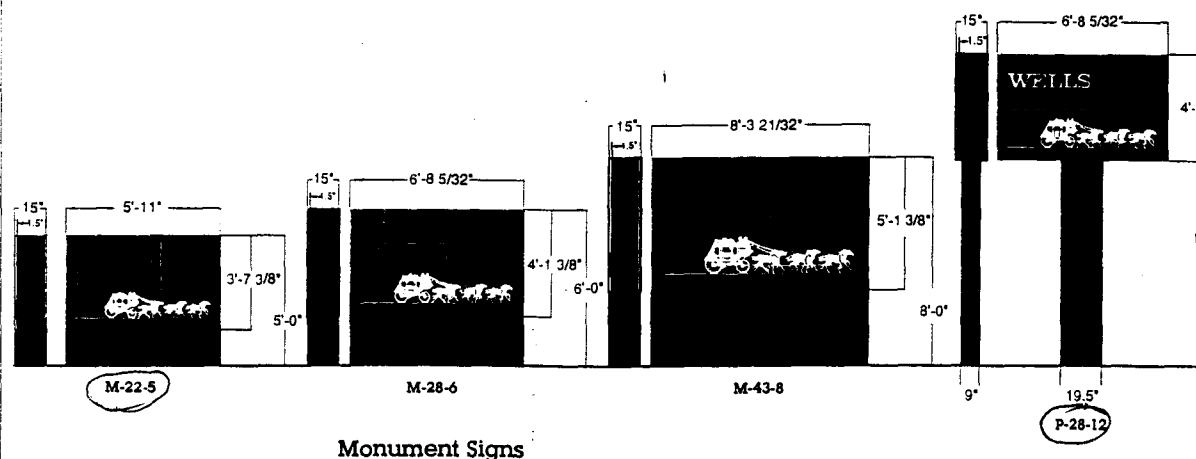

Pylon Signs