



SIGN PERMIT

A

Community Development Department
250 North 5th Street
Grand Junction, CO 81501
(970) 244-1430

Permit No. _____
Date Submitted 7/18/00
FEE \$ 25⁰⁰
Tax Schedule 2945-141-02-005
Zone C-1

BUSINESS NAME Dairy Queen
STREET ADDRESS 709 North Ave.
PROPERTY OWNER Clark Winfred
OWNER ADDRESS 709 North Ave.

CONTRACTOR Uesco
LICENSE NO. C 2200511
ADDRESS 2393 Flamingo Rd
TELEPHONE NO. 242-7880

- 1. FLUSH WALL 2 Square Feet per Linear Foot of Building Facade
- Face Change Only (2,3 & 4):*
- 2. ROOF 2 Square Feet per Linear Foot of Building Facade
- 3. FREE-STANDING 2 Traffic Lanes - 0.75 Square Feet x Street Frontage
4 or more Traffic Lanes - 1.5 Square Feet x Street Frontage
- 4. PROJECTING 0.5 Square Feet per each Linear Foot of Building Facade

Existing Externally or Internally Illuminated - No Change in Electrical Service Non-Illuminated

(1 - 4) Area of Proposed Sign 50 Square Feet
(1,2,4) Building Facade 91 Linear Feet
(1 - 4) Street Frontage 120 Linear Feet (North Ave)
(2,3,4) Height to Top of Sign 29 Feet Clearance to Grade 15 Feet

Existing Signage/Type:	
<u>518 weather board on pole</u>	<u>40</u> Sq. Ft.
	Sq. Ft.
	Sq. Ft.
Total Existing:	Sq. Ft.

● FOR OFFICE USE ONLY ●		
Signage Allowed on Parcel:		
Building	<u>182</u>	Sq. Ft.
Free-Standing	<u>210</u>	Sq. Ft.
Total Allowed:	<u>210</u>	Sq. Ft.

COMMENTS: removing existing DQ sign on top of pole and replacing with new logo.

NOTE: No sign may exceed 300 square feet. A separate sign permit is required for each sign. Attach a sketch of proposed and existing signage including types, dimensions, lettering, abutting streets, alleys, easements, property lines, and locations. Roof signs shall be manufactured such that no guy wires, braces or supports shall be visible.

Orla Griffiths 7/14/00 Bill Nuth 7-20-00
Applicant's Signature Date Community Development Approval Date

(White: Community Development) (Canary: Applicant) (Pink: Code Enforcement)

3/2

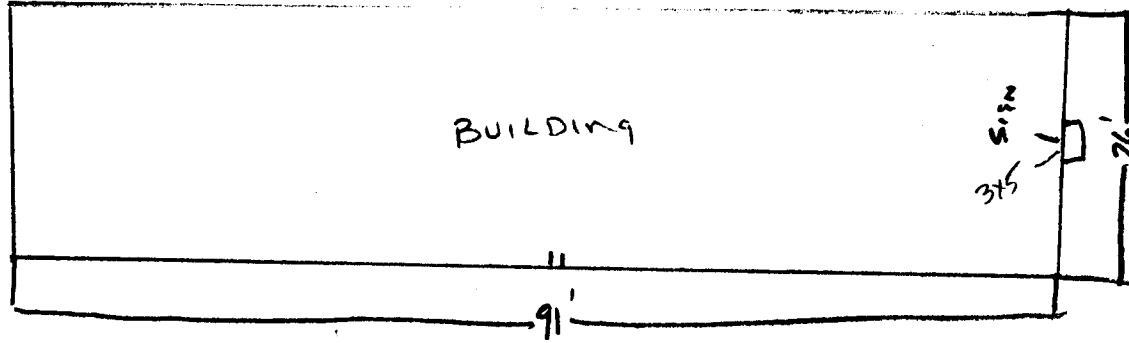

140'

7TH STREET

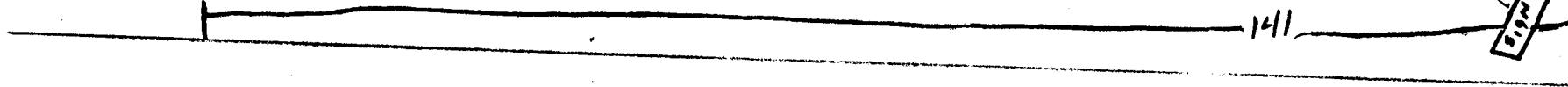

NORTH AVE

570'

STOP

Douglas Queen

11
N

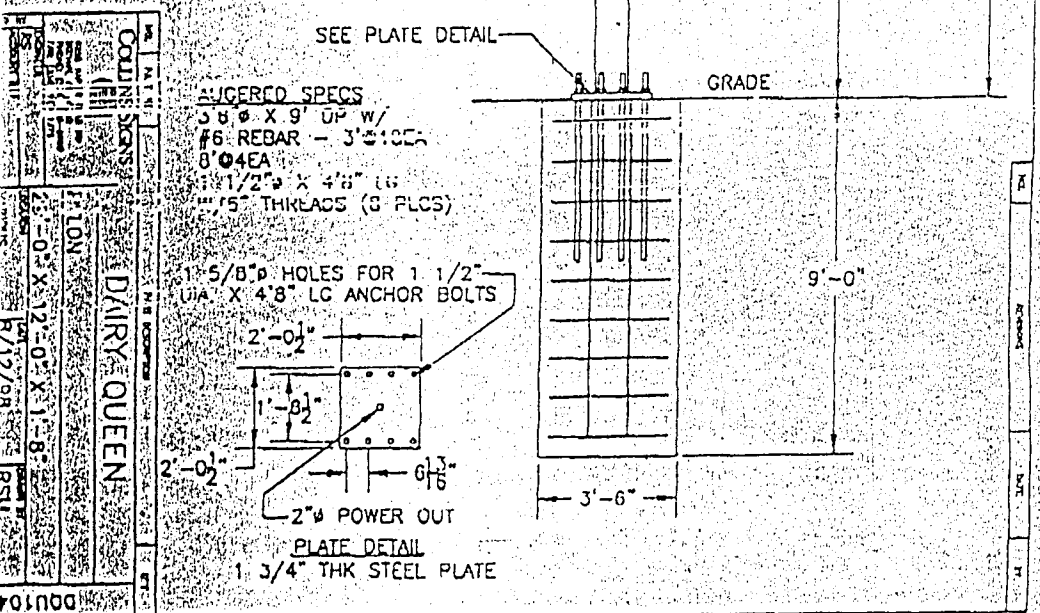
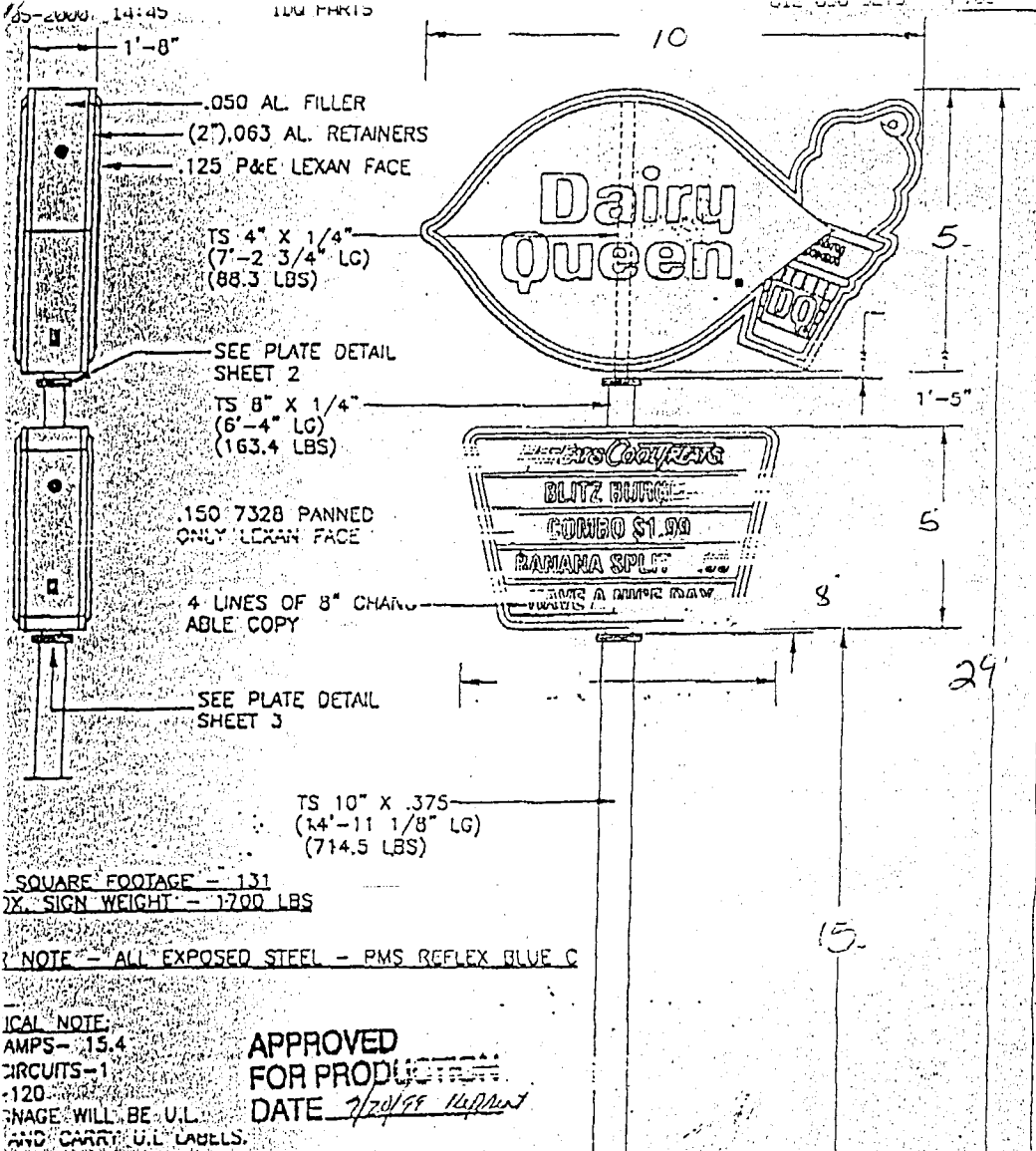

COLUMBIANS
DAIRY QUEEN
1'-0" X 12'-0" X 1'-8"
1/2" DIA X 1'-0"
1/2" DIA X 1'-0"
1/2" DIA X 1'-0"
1/2" DIA X 1'-0"
1/2" DIA X 1'-0"
1/2" DIA X 1'-0"
1/2" DIA X 1'-0"
1/2" DIA X 1'-0"
1/2" DIA X 1'-0"
1/2" DIA X 1'-0"
1/2" DIA X 1'-0"

We believe the Red, White and Blue program provides the system with the best opportunity for growth and revitalization that we have ever had. We believe the enthusiasm for this program will instill a passion for achievement within the system, creating increased pride and a momentum of teamwork that will give all of us the competitive start we need for the century.

We see your involvement as a catalyst for the participation of all stores and truly believe the enthusiasm for this program and the rewards it will bring, will carry over into everything we do as a franchise system.

We cannot do this without your involvement. Take the first steps and give us a call.

We want you to be DQ; Red, White and Blue.

American Dairy Queen Corp.

**Dairy
Queen**

