



SIGN PERMIT

(A)

Community Development Department
250 North 5th Street
Grand Junction, CO 81501
(970) 244-1430

Permit No. _____
Date Submitted 8/16/00
FEE \$ 25.00
Tax Schedule 2701-313-11-005
Zone I-1
SPR-2000-015

BUSINESS NAME El Rey Distributing CONTRACTOR The Egan Gallery
STREET ADDRESS 730 Scarlet LICENSE NO. 2200212
PROPERTY OWNER El Rey Distributing ADDRESS 1048 Independent A 109
OWNER ADDRESS 730 Scarlet TELEPHONE NO. 241-6400

- 1. FLUSH WALL 2 Square Feet per Linear Foot of Building Facade
- Face Change Only (2,3 & 4):**
- 2. ROOF 2 Square Feet per Linear Foot of Building Facade
- 3. FREE-STANDING 2 Traffic Lanes - 0.75 Square Feet x Street Frontage
4 or more Traffic Lanes - 1.5 Square Feet x Street Frontage
- 4. PROJECTING 0.5 Square Feet per each Linear Foot of Building Facade

Existing Externally or Internally Illuminated - No Change in Electrical Service Non-Illuminated

(1 - 4) Area of Proposed Sign 20 Square Feet
(1,2,4) Building Facade 75 Linear Feet
(1 - 4) Street Frontage 100? Linear Feet 153.5
(2,3,4) Height to Top of Sign 12 Feet Clearance to Grade 7 Feet

Existing Signage/Type:	
	Sq. Ft.
	Sq. Ft.
	Sq. Ft.
Total Existing:	<u>0</u> Sq. Ft.

● FOR OFFICE USE ONLY ●		
Signage Allowed on Parcel:		
Building	<u>150</u>	Sq. Ft.
Free-Standing	<u>115</u>	Sq. Ft.
Total Allowed:	<u>150</u>	Sq. Ft.

COMMENTS: _____

NOTE: No sign may exceed 300 square feet. A separate sign permit is required for each sign. Attach a sketch of proposed and existing signage including types, dimensions, lettering, abutting streets, alleys, easements, property lines, and locations. Roof signs shall be manufactured such that no guy wires, braces or supports shall be visible.

Ferry Z Bowler 8-16-00 Kristen F. Albrecht 8/16/00
Applicant's Signature Date Community Development Approval Date

(White: Community Development) (Canary: Applicant) (Pink: Code Enforcement)

A

El Rey

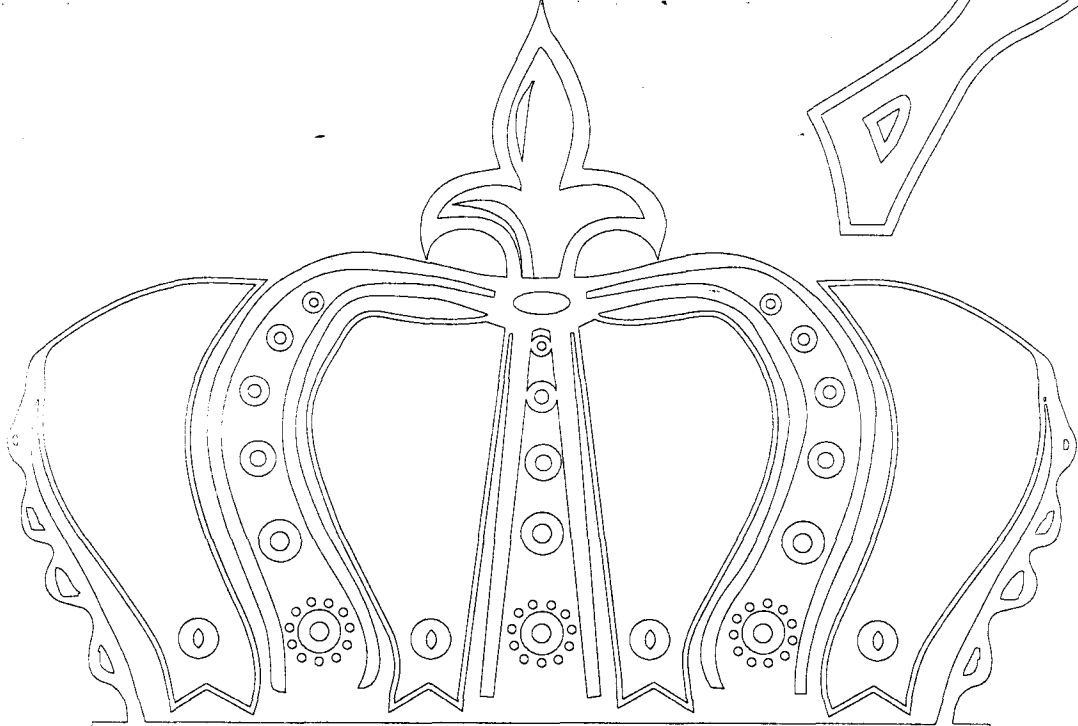

KING OF STUCCO®

DISTRIBUTING

4'

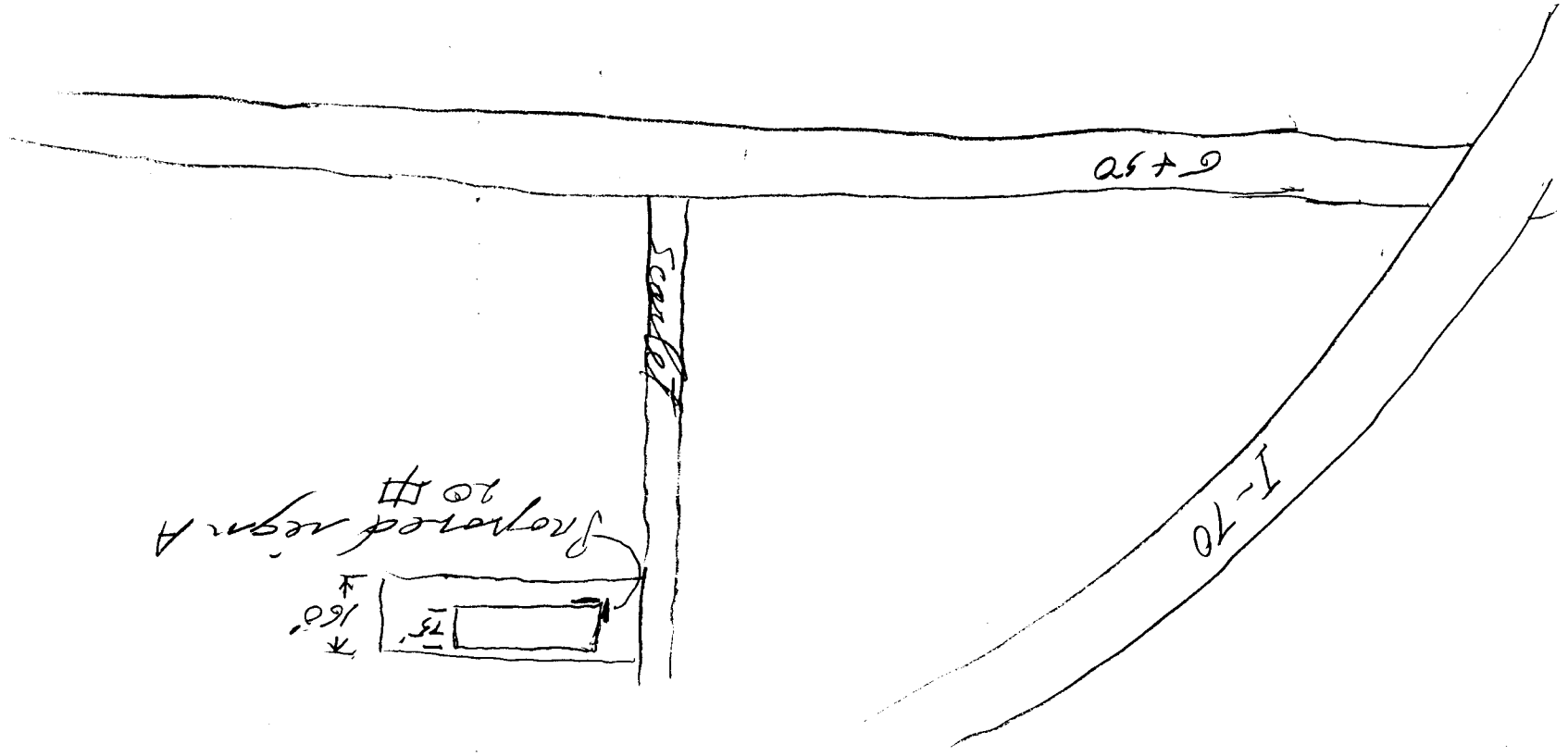

City Way Interchanging
 730 Scabel (A)