



SIGN PERMIT

@

G

Community Development Department
 250 North 5th Street
 Grand Junction, CO 81501
 (970) 244-1430

Permit No. _____
 Date Submitted 9/5/00
 FEE \$ 25⁰⁰
 Tax Schedule 2945-043-04-D11+018
 Zone C1

BUSINESS NAME Mesa Village
 STREET ADDRESS 2412 ~~Patterson~~ FRd
 PROPERTY OWNER Gordon Moore
 OWNER ADDRESS 2412 Patterson

CONTRACTOR The Sign Gallery
 LICENSE NO. 2200212
 ADDRESS 1048 Independent A 109
 TELEPHONE NO. 241-6400

- 1. FLUSH WALL 2 Square Feet per Linear Foot of Building Facade
- Face Change Only (2,3 & 4):
- 2. ROOF 2 Square Feet per Linear Foot of Building Facade
- 3. FREE-STANDING 2 Traffic Lanes - 0.75 Square Feet x Street Frontage
4 or more Traffic Lanes - 1.5 Square Feet x Street Frontage
- 4. PROJECTING 0.5 Square Feet per each Linear Foot of Building Facade

Existing Externally or Internally Illuminated - No Change in Electrical Service Non-Illuminated

(1 - 4) Area of Proposed Sign 60 Square Feet
 (1,2,4) Building Facade 193 Linear Feet
 (1 - 4) Street Frontage 390 Linear Feet
 (2,3,4) Height to Top of Sign 18 Feet Clearance to Grade 15.5 Feet

Existing Signage/Type:	
<u>Flush wall</u>	<u>266</u> Sq. Ft.
<u>Free-standing</u>	<u>24</u> Sq. Ft.
	Sq. Ft.
Total Existing:	<u>290</u> Sq. Ft.

● FOR OFFICE USE ONLY ●		
Signage Allowed on Parcel:		
Building	<u>386</u>	Sq. Ft.
Free-Standing	<u>300</u>	<u>585</u> Sq. Ft.
Total Allowed:	<u>386</u>	Sq. Ft.

COMMENTS:

NOTE: No sign may exceed 300 square feet. A separate sign permit is required for each sign. Attach a sketch of proposed and existing signage including types, dimensions, lettering, abutting streets, alleys, easements, property lines, and locations. Roof signs shall be manufactured such that no guy wires, braces or supports shall be visible.

Larry L Bowler 9-5-00 [Signature] 9/5/00
 Applicant's Signature Date Community Development Approval Date

(White: Community Development) (Canary: Applicant) (Pink: Code Enforcement)

SLC

2412 Patterson



Wall

Garthland

Patterson

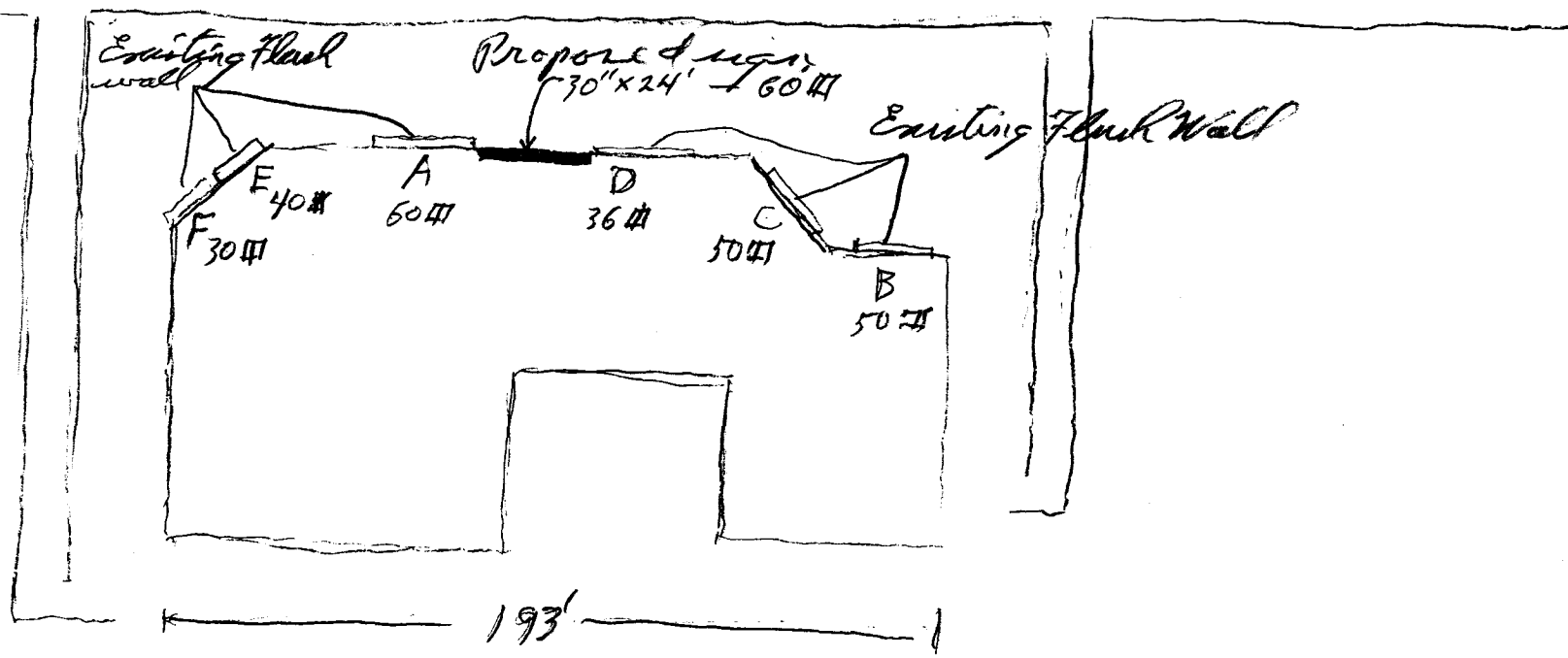

Mesa Village
2412 Patterson

