



SIGN CLEARANCE

@

A

Community Development Department
250 North 5th Street
Grand Junction, CO 81501
(970) 244-1430

Clearance No. 77424
Date Submitted 10-24-00
FEE \$ 250
Tax Schedule 2945-134-03-051
Zone _____

BUSINESS NAME The Best Radiator Service CONTRACTOR Platinum Sign
STREET ADDRESS 2460 East Main LICENSE NO. 2200696
PROPERTY OWNER David Ewart ADDRESS 2916 I-70 B
OWNER ADDRESS _____ TELEPHONE NO. 248 96 77

- 1. FLUSH WALL 2 Square Feet per Linear Foot of Building Facade
- 2. ROOF 2 Square Feet per Linear Foot of Building Facade
- 3. FREE-STANDING 2 Traffic Lanes - 0.75 Square Feet x Street Frontage
4 or more Traffic Lanes - 1.5 Square Feet x Street Frontage
- 4. PROJECTING 0.5 Square Feet per each Linear Foot of Building Facade
- 5. OFF-PREMISE See #3 Spacing Requirements; Not > 300 Square Feet or < 15 Square Feet

Externally Illuminated Internally Illuminated Non-Illuminated

- (1 - 5) Area of Proposed Sign 32 Square Feet
- (1,2,4) Building Facade 87 Linear Feet 131'
- (1 - 4) Street Frontage 105/110 Linear Feet
- (2 - 5) Height to Top of Sign 12 Feet Clearance to Grade 8 Feet
- (5) Distance from all Existing Off-Premise Signs within 600 Feet _____ Feet

Existing Signage/Type:		
<u>Pole Sign</u>	<u>27</u>	Sq. Ft.
Flush wall	<u>32</u>	Sq. Ft.
<u>Flush wall</u>	<u>24</u>	Sq. Ft.
Total Existing:	<u>83</u>	Sq. Ft.

● FOR OFFICE USE ONLY ●		
Signage Allowed on Parcel:		
Building	<u>262</u>	Sq. Ft.
Free-Standing	<u>165</u>	Sq. Ft.
Total Allowed:	<u>262</u>	Sq. Ft.

COMMENTS: This sign is on the same Pole as culligan and the Plumbing sign This sign goes on existing Pole with existing ~~the~~ signs.

NOTE: No sign may exceed 300 square feet. A separate sign clearance is required for each sign. Attach a sketch of proposed and existing signage including types, dimensions, lettering, abutting streets, alleys, easements, property lines, and locations. **A SEPARATE PERMIT FROM THE BUILDING DEPARTMENT IS REQUIRED.**

[Signature]
Applicant's Signature

Date

[Signature]
Community Development Approval

10-25-00
Date

(White: Community Development) (Canary: Applicant) (Pink: Building Dept) (Goldenrod: Code Enforcement)



SIGN PERMIT

(B)

Community Development Department
250 North 5th Street
Grand Junction, CO 81501
(970) 244-1430

Permit No. _____
Date Submitted 10-24-00
FEE \$ 2500
Tax Schedule 2945-134-03-057
Zone _____

BUSINESS NAME The Best Radiator Service CONTRACTOR Platinum Sign
STREET ADDRESS 2460 East Main LICENSE NO. 2200696
PROPERTY OWNER David Everts ADDRESS 2916 I-70 B
OWNER ADDRESS _____ TELEPHONE NO. 248 96 77

- 1. FLUSH WALL 2 Square Feet per Linear Foot of Building Facade
- Face Change Only (2,3 & 4):
- 2. ROOF 2 Square Feet per Linear Foot of Building Facade
- 3. FREE-STANDING 2 Traffic Lanes - 0.75 Square Feet x Street Frontage
4 or more Traffic Lanes - 1.5 Square Feet x Street Frontage
- 4. PROJECTING 0.5 Square Feet per each Linear Foot of Building Facade

Existing Externally or Internally Illuminated - No Change in Electrical Service Non-Illuminated

(1 - 4) Area of Proposed Sign 32 Square Feet
(1,2,4) Building Facade 81' Linear Feet 131'
(1 - 4) Street Frontage 105' Linear Feet 110'
(2,3,4) Height to Top of Sign _____ Feet Clearance to Grade _____ Feet

Existing Signage/Type:			
Pole	<u>27' x 32' + 32' x 32'</u>	<u>91</u>	Sq. Ft.
<u>Flush wall</u>		<u>24</u>	Sq. Ft.
			Sq. Ft.
Total Existing:		<u>115'</u>	Sq. Ft.

● FOR OFFICE USE ONLY ●		
Signage Allowed on Parcel:		
Building	<u>262</u>	Sq. Ft.
Free-Standing	<u>165</u>	Sq. Ft.
Total Allowed:	<u>262</u>	Sq. Ft.

COMMENTS: _____

NOTE: No sign may exceed 300 square feet. A separate sign permit is required for each sign. Attach a sketch of proposed and existing signage including types, dimensions, lettering, abutting streets, alleys, easements, property lines, and locations. Roof signs shall be manufactured such that no guy wires, braces or supports shall be visible.

Chris Lettington 10-24-00 [Signature] 10/27/00
Applicant's Signature Date Community Development Approval Date

(White: Community Development) (Canary: Applicant) (Pink: Code Enforcement)

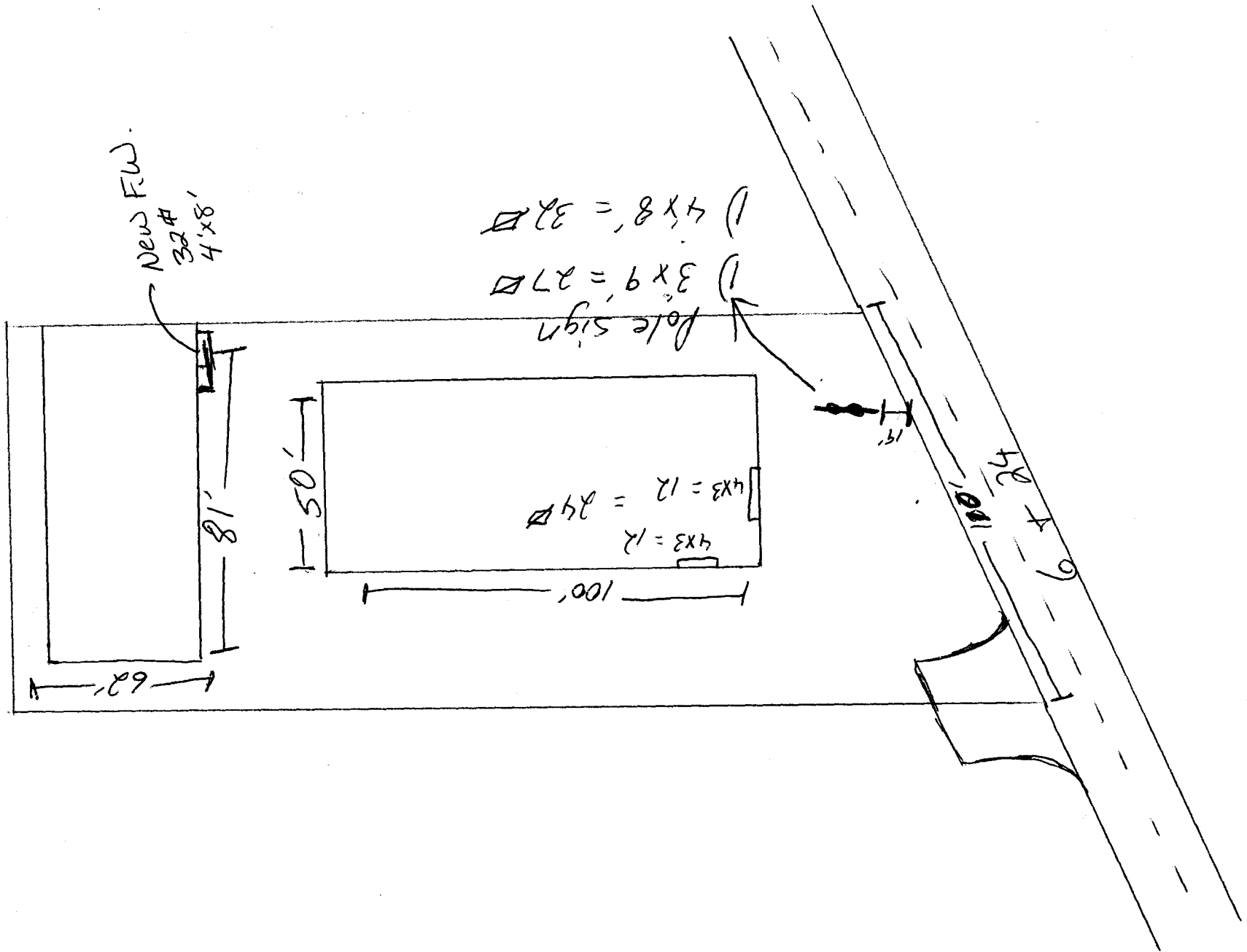

New F.W.
32#
4'x8'

1) 4'x8' = 32#
1) 3'x9' = 27#
pole sign

4x3 = 12 = 24#
4x3 = 12

62'

81'

50'

100'

15'

42' x 6' 9' 10' 11' 12' 13' 14' 15' 16' 17' 18' 19' 20' 21' 22' 23' 24' 25' 26' 27' 28' 29' 30' 31' 32' 33' 34' 35' 36' 37' 38' 39' 40' 41' 42' 43' 44' 45' 46' 47' 48' 49' 50' 51' 52' 53' 54' 55' 56' 57' 58' 59' 60' 61' 62' 63' 64' 65' 66' 67' 68' 69' 70' 71' 72' 73' 74' 75' 76' 77' 78' 79' 80' 81' 82' 83' 84' 85' 86' 87' 88' 89' 90' 91' 92' 93' 94' 95' 96' 97' 98' 99' 100' 101' 102' 103' 104' 105' 106' 107' 108' 109' 110' 111' 112' 113' 114' 115' 116' 117' 118' 119' 120' 121' 122' 123' 124' 125' 126' 127' 128' 129' 130' 131' 132' 133' 134' 135' 136' 137' 138' 139' 140' 141' 142' 143' 144' 145' 146' 147' 148' 149' 150' 151' 152' 153' 154' 155' 156' 157' 158' 159' 160' 161' 162' 163' 164' 165' 166' 167' 168' 169' 170' 171' 172' 173' 174' 175' 176' 177' 178' 179' 180' 181' 182' 183' 184' 185' 186' 187' 188' 189' 190' 191' 192' 193' 194' 195' 196' 197' 198' 199' 200' 201' 202' 203' 204' 205' 206' 207' 208' 209' 210' 211' 212' 213' 214' 215' 216' 217' 218' 219' 220' 221' 222' 223' 224' 225' 226' 227' 228' 229' 230' 231' 232' 233' 234' 235' 236' 237' 238' 239' 240' 241' 242' 243' 244' 245' 246' 247' 248' 249' 250' 251' 252' 253' 254' 255' 256' 257' 258' 259' 260' 261' 262' 263' 264' 265' 266' 267' 268' 269' 270' 271' 272' 273' 274' 275' 276' 277' 278' 279' 280' 281' 282' 283' 284' 285' 286' 287' 288' 289' 290' 291' 292' 293' 294' 295' 296' 297' 298' 299' 300' 301' 302' 303' 304' 305' 306' 307' 308' 309' 310' 311' 312' 313' 314' 315' 316' 317' 318' 319' 320' 321' 322' 323' 324' 325' 326' 327' 328' 329' 330' 331' 332' 333' 334' 335' 336' 337' 338' 339' 340' 341' 342' 343' 344' 345' 346' 347' 348' 349' 350' 351' 352' 353' 354' 355' 356' 357' 358' 359' 360' 361' 362' 363' 364' 365' 366' 367' 368' 369' 370' 371' 372' 373' 374' 375' 376' 377' 378' 379' 380' 381' 382' 383' 384' 385' 386' 387' 388' 389' 390' 391' 392' 393' 394' 395' 396' 397' 398' 399' 400' 401' 402' 403' 404' 405' 406' 407' 408' 409' 410' 411' 412' 413' 414' 415' 416' 417' 418' 419' 420' 421' 422' 423' 424' 425' 426' 427' 428' 429' 430' 431' 432' 433' 434' 435' 436' 437' 438' 439' 440' 441' 442' 443' 444' 445' 446' 447' 448' 449' 450' 451' 452' 453' 454' 455' 456' 457' 458' 459' 460' 461' 462' 463' 464' 465' 466' 467' 468' 469' 470' 471' 472' 473' 474' 475' 476' 477' 478' 479' 480' 481' 482' 483' 484' 485' 486' 487' 488' 489' 490' 491' 492' 493' 494' 495' 496' 497' 498' 499' 500' 501' 502' 503' 504' 505' 506' 507' 508' 509' 510' 511' 512' 513' 514' 515' 516' 517' 518' 519' 520' 521' 522' 523' 524' 525' 526' 527' 528' 529' 530' 531' 532' 533' 534' 535' 536' 537' 538' 539' 540' 541' 542' 543' 544' 545' 546' 547' 548' 549' 550' 551' 552' 553' 554' 555' 556' 557' 558' 559' 560' 561' 562' 563' 564' 565' 566' 567' 568' 569' 570' 571' 572' 573' 574' 575' 576' 577' 578' 579' 580' 581' 582' 583' 584' 585' 586' 587' 588' 589' 590' 591' 592' 593' 594' 595' 596' 597' 598' 599' 600' 601' 602' 603' 604' 605' 606' 607' 608' 609' 610' 611' 612' 613' 614' 615' 616' 617' 618' 619' 620' 621' 622' 623' 624' 625' 626' 627' 628' 629' 630' 631' 632' 633' 634' 635' 636' 637' 638' 639' 640' 641' 642' 643' 644' 645' 646' 647' 648' 649' 650' 651' 652' 653' 654' 655' 656' 657' 658' 659' 660' 661' 662' 663' 664' 665' 666' 667' 668' 669' 670' 671' 672' 673' 674' 675' 676' 677' 678' 679' 680' 681' 682' 683' 684' 685' 686' 687' 688' 689' 690' 691' 692' 693' 694' 695' 696' 697' 698' 699' 700' 701' 702' 703' 704' 705' 706' 707' 708' 709' 710' 711' 712' 713' 714' 715' 716' 717' 718' 719' 720' 721' 722' 723' 724' 725' 726' 727' 728' 729' 730' 731' 732' 733' 734' 735' 736' 737' 738' 739' 740' 741' 742' 743' 744' 745' 746' 747' 748' 749' 750' 751' 752' 753' 754' 755' 756' 757' 758' 759' 760' 761' 762' 763' 764' 765' 766' 767' 768' 769' 770' 771' 772' 773' 774' 775' 776' 777' 778' 779' 780' 781' 782' 783' 784' 785' 786' 787' 788' 789' 790' 791' 792' 793' 794' 795' 796' 797' 798' 799' 800' 801' 802' 803' 804' 805' 806' 807' 808' 809' 810' 811' 812' 813' 814' 815' 816' 817' 818' 819' 820' 821' 822' 823' 824' 825' 826' 827' 828' 829' 830' 831' 832' 833' 834' 835' 836' 837' 838' 839' 840' 841' 842' 843' 844' 845' 846' 847' 848' 849' 850' 851' 852' 853' 854' 855' 856' 857' 858' 859' 860' 861' 862' 863' 864' 865' 866' 867' 868' 869' 870' 871' 872' 873' 874' 875' 876' 877' 878' 879' 880' 881' 882' 883' 884' 885' 886' 887' 888' 889' 890' 891' 892' 893' 894' 895' 896' 897' 898' 899' 900' 901' 902' 903' 904' 905' 906' 907' 908' 909' 910' 911' 912' 913' 914' 915' 916' 917' 918' 919' 920' 921' 922' 923' 924' 925' 926' 927' 928' 929' 930' 931' 932' 933' 934' 935' 936' 937' 938' 939' 940' 941' 942' 943' 944' 945' 946' 947' 948' 949' 950' 951' 952' 953' 954' 955' 956' 957' 958' 959' 960' 961' 962' 963' 964' 965' 966' 967' 968' 969' 970' 971' 972' 973' 974' 975' 976' 977' 978' 979' 980' 981' 982' 983' 984' 985' 986' 987' 988' 989' 990' 991' 992' 993' 994' 995' 996' 997' 998' 999' 1000'

THE BEST



RADIATOR

SERVICE

Kayce Hoover