



SIGN PERMIT

AK

Community Development Department
250 North 5th Street
Grand Junction, CO 81501
(970) 244-1430

Permit No. N/A
Date Submitted 12/27/01
FEE \$ 25.00
Tax Schedule 2945-113-26-002
Zone C-2

BUSINESS NAME Image Designs Laboratories CONTRACTOR Bud's signs
STREET ADDRESS 403 Glenwood #407 LICENSE NO. 2010087
PROPERTY OWNER Brook Blaney ADDRESS 1055 ute
OWNER ADDRESS _____ TELEPHONE NO. 245-7700

- 1. FLUSH WALL 2 Square Feet per Linear Foot of Building Facade
- Face Change Only (2,3 & 4):**
- 2. ROOF 2 Square Feet per Linear Foot of Building Facade
- 3. FREE-STANDING 2 Traffic Lanes - 0.75 Square Feet x Street Frontage
4 or more Traffic Lanes - 1.5 Square Feet x Street Frontage
- 4. PROJECTING 0.5 Square Feet per each Linear Foot of Building Facade

Existing Externally or Internally Illuminated - No Change in Electrical Service Non-Illuminated

(1 - 4) Area of Proposed Sign 18 Square Feet
(1,2,4) Building Facade 65 Linear Feet
(1 - 4) Street Frontage 135 Linear Feet
(2,3,4) Height to Top of Sign 7 Feet Clearance to Grade 4 Feet

| Existing Signage/Type: | |
|------------------------|------------|
| Flushwall | 18 Sq. Ft. |
| | Sq. Ft. |
| | Sq. Ft. |
| Total Existing: | 18 Sq. Ft. |

| ● FOR OFFICE USE ONLY ● | |
|----------------------------|----------------|
| Signage Allowed on Parcel: | |
| Building | 130 Sq. Ft. |
| Free-Standing | 101.25 Sq. Ft. |
| Total Allowed: | 130 Sq. Ft. |

COMMENTS: _____

NOTE: No sign may exceed 300 square feet. A separate sign permit is required for each sign. Attach a sketch of proposed and existing signage including types, dimensions, lettering, abutting streets, alleys, easements, property lines, and locations. Roof signs shall be manufactured such that no guy wires, braces or supports shall be visible.

Eric Bennett 12-27-01 *C. J. Taylor* 12/28/01
Applicant's Signature Date Community Development Approval Date

(White: Community Development) (Canary: Applicant) (Pink: Code Enforcement)

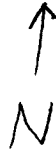

Elmwood

4TH

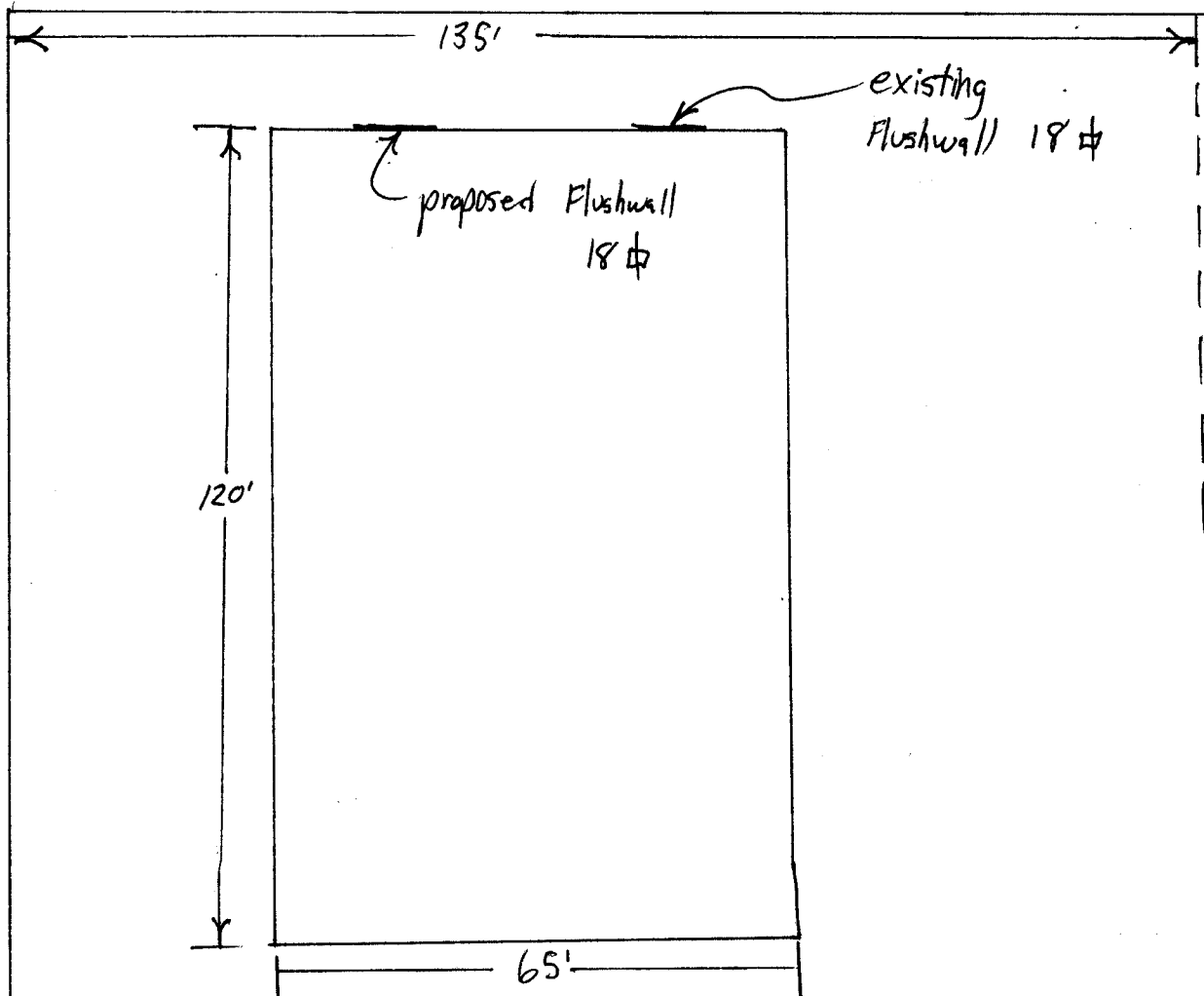

1055 Ute Avenue • Grand Junction, Colorado 81501 • 970-245-7700

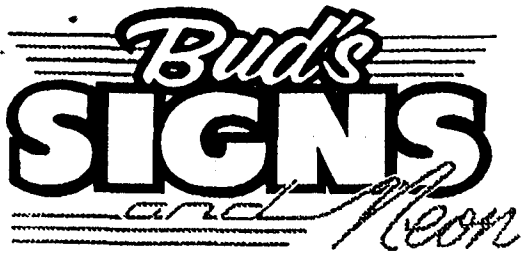

We Do Signs RIGHT!

