



# SIGN Permit

Community Development Department  
250 North 5<sup>th</sup> Street  
Grand Junction CO 81501  
Phone: (970) 244-1430 FAX (970) 256-4031

Permit No. \_\_\_\_\_  
Date Submitted 3-28-01  
Fee \$ 25.00  
Zone C-1

TAX SCHEDULE 2945-151-00-042 CONTRACTOR Platinum Sign Co  
BUSINESS NAME Hightower Supply LICENSE NO. 2010577  
STREET ADDRESS 537 N. 1st St. ADDRESS 2916 I-70B  
PROPERTY OWNER Arnon Hightower TELEPHONE NO. 970-248-9677  
OWNER ADDRESS Same CONTACT PERSON Mike Blackwelder

- 1. FLUSH WALL 2 Square Feet per Linear Foot of Building Façade  
Face change only on items 2, 3 & 4
- 2. ROOF 2 Square Feet per Linear Foot of Building Façade
- 3. FREE-STANDING 2 Traffic Lanes - 0.75 Square Feet x Street Frontage  
4 or more Traffic Lanes - 1.5 Square Feet x Street Frontage
- 4. PROJECTING 0.5 Square Feet per each Linear Foot of Building Façade

Existing Externally or Internally Illuminated - No Change in Electrical Service  Non-Illuminated

(1 - 4) Area of Proposed Sign: 24.25 Square Feet  
(1,2,4) Building Façade: 30 Linear Feet  
(1 - 4) Street Frontage: 50 Linear Feet  
(2 - 4) Height to Top of Sign: \_\_\_\_\_ Feet Clearance to Grade: \_\_\_\_\_ Feet

EXISTING SIGNAGE/TYPE:  
\_\_\_\_\_  
\_\_\_\_\_  
\_\_\_\_\_  
Total Existing: \_\_\_\_\_ Sq. Ft.

● FOR OFFICE USE ONLY ●  
Signage Allowed on Parcel:  
Building 60 Sq. Ft.  
Free-Standing 75 Sq. Ft.  
Total Allowed: 75 Sq. Ft.

COMMENTS: Lettering on existing awning.

NOTE: No sign may exceed 300 square feet. A separate sign permit is required for each sign. Attach a sketch, to scale, of proposed and existing signage including types, dimensions and lettering. Attach a plot plan, to scale, showing: abutting streets, alleys, easements, driveways, encroachments, property lines, distances from existing buildings to proposed signs and required setbacks. Roof signs shall be manufactured such that no guy wires, braces or supports shall be visible.

I hereby attest that the information on this form and the attached sketches are true and accurate.

[Signature] 3-28-01 [Signature] 3-28-01  
Applicant's Signature Date Community Development Approval Date

(White: Community Development) (Canary: Applicant) (Pink: Code Enforcement)

537 50' 1st Street

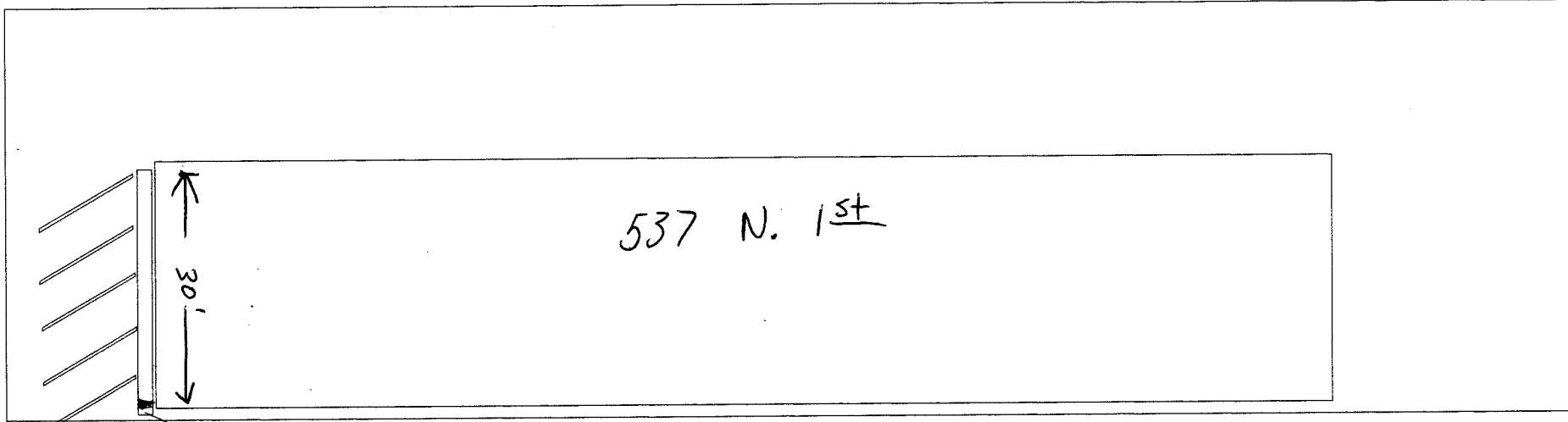

537 N. 1st

PROPOSED SIGNAGE

Flushwall

27.83'

334."

Awning Length

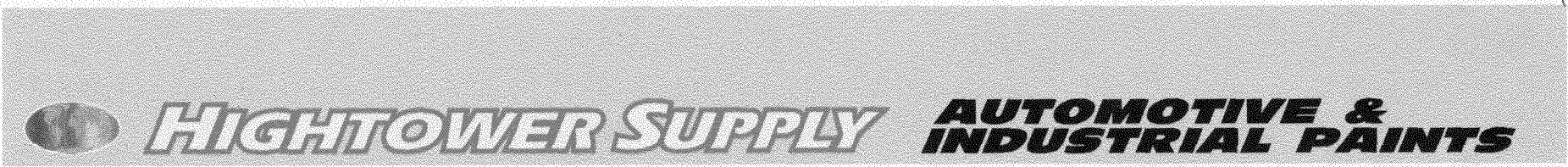

↑  
1.75  
∅

↑  
13.25  
∅

↑  
9.25  
∅

24.25 Total ∅