



# SIGN Permit

(B)

Community Development Department  
250 North 5<sup>th</sup> Street  
Grand Junction CO 81501  
Phone: (970) 244-1430 FAX (970) 256-4031

Permit No.	_____
Date Submitted	<del>5-00</del> 5/25/01
Fee \$	5.00
Zone	C-1

TAX SCHEDULE	2946-114-18-010	CONTRACTOR	Bud's Signs
BUSINESS NAME	Russ Vacuum	LICENSE NO.	2010087
STREET ADDRESS	768 North Ave	ADDRESS	1055 UTE
PROPERTY OWNER	Rankin & company	TELEPHONE NO.	245-7700
OWNER ADDRESS	_____	CONTACT PERSON	Eric Bennett

<input type="checkbox"/> 1. FLUSH WALL	2 Square Feet per Linear Foot of Building Façade
<b>Face change only on items 2, 3 &amp; 4</b>	
<input type="checkbox"/> 2. ROOF	2 Square Feet per Linear Foot of Building Façade
<input checked="" type="checkbox"/> 3. FREE-STANDING	2 Traffic Lanes - 0.75 Square Feet x Street Frontage 4 or more Traffic Lanes - 1.5 Square Feet x Street Frontage
<input type="checkbox"/> 4. PROJECTING	0.5 Square Feet per each Linear Foot of Building Façade

Existing Externally or Internally Illuminated - No Change in Electrical Service       Non-Illuminated

(1 - 4) Area of Proposed Sign: 35 Square Feet

(1,2,4) Building Façade: 24 Linear Feet

(1 - 4) Street Frontage: 50 Linear Feet

(2 - 4) Height to Top of Sign: 16 Feet      Clearance to Grade: 6 Feet

**EXISTING SIGNAGE/TYPE:**

<u>A-FS</u>	<u>40</u>	Sq. Ft.
_____	_____	Sq. Ft.
_____	_____	Sq. Ft.
Total Existing:	<u>40</u>	Sq. Ft.

**● FOR OFFICE USE ONLY ●**

Signage Allowed on Parcel:

Building	<u>48</u>	Sq. Ft.
Free-Standing	<u>75</u>	Sq. Ft.
Total Allowed:	<u>75</u>	Sq. Ft.

COMMENTS: \_\_\_\_\_

**NOTE:** No sign may exceed 300 square feet. A separate sign permit is required for each sign. Attach a sketch, to scale, of proposed and existing signage including types, dimensions and lettering. Attach a plot plan, to scale, showing: abutting streets, alleys, easements, driveways, encroachments, property lines, distances from existing buildings to proposed signs and required setbacks. Roof signs shall be manufactured such that no guy wires, braces or supports shall be visible.

I hereby attest that the information on this form and the attached sketches are true and accurate.

<u>Eric Bennett</u>	_____	<u>Bill N...</u>	<u>5.25.01</u>
Applicant's Signature	Date	Community Development Approval	Date

(White: Community Development)

(Canary: Applicant)

(Pink: Code Enforcement)

501b. vacuum cleaner  
mounted on top of  
sign. 6 #

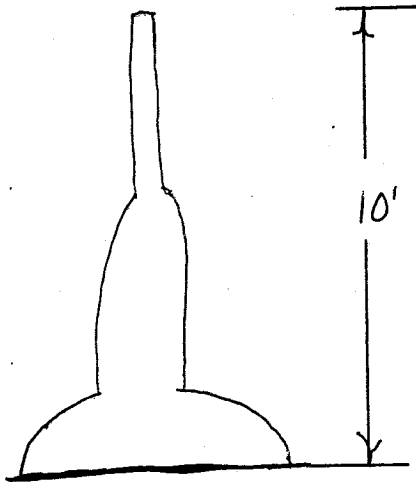

Front view

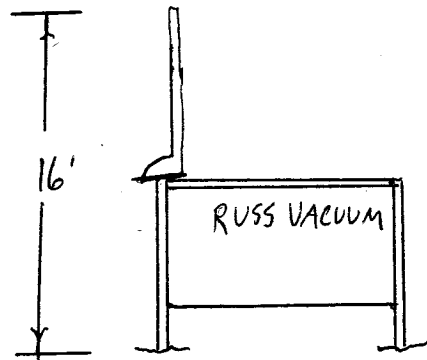

side view

10'

(A)

**RUSS VACUUM**  
The  
**VACUUM**  
**Doctor**  
**SALES • SERVICE • REPAIR**

4'

↑  
N

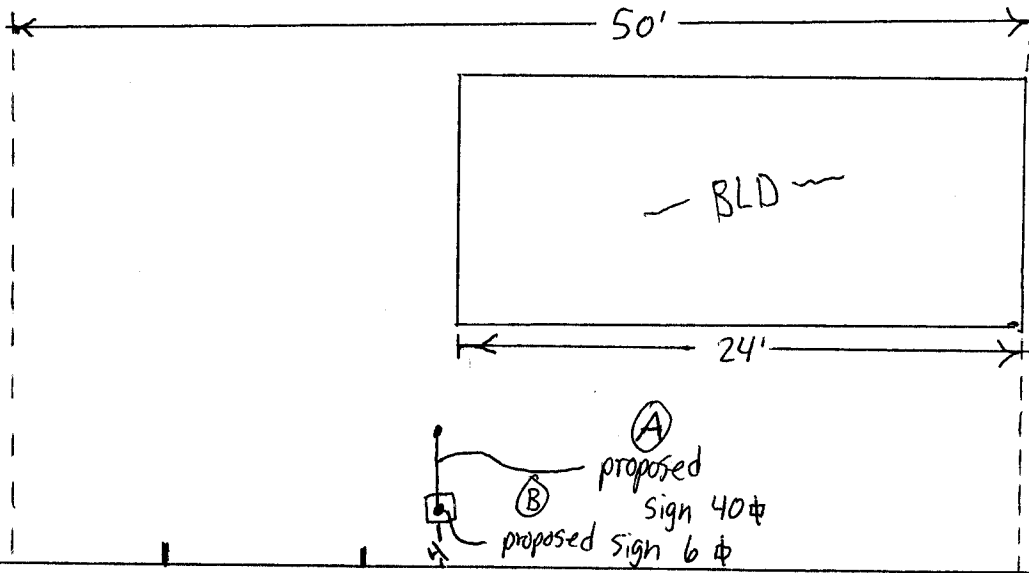

North Ave

