



SIGN CLEARANCE

Ⓢ

Community Development Department
250 North 5th Street
Grand Junction, CO 81501
(970) 244-1430

Clearance No. No Permit requ.
Date Submitted 4-16-01
FEE \$ 25.00
Tax Schedule 2701-311-22-022
Zone C-1

BUSINESS NAME Capitol Business CONTRACTOR Buds Signs
STREET ADDRESS 2777 Crossroads Blvd. F&G LICENSE NO. 2010087
PROPERTY OWNER K&N Investors ADDRESS 1055 ute
OWNER ADDRESS _____ TELEPHONE NO. 245-7700

- 1. FLUSH WALL 2 Square Feet per Linear Foot of Building Facade
- 2. ROOF 2 Square Feet per Linear Foot of Building Facade
- 3. FREE-STANDING 2 Traffic Lanes - 0.75 Square Feet x Street Frontage
4 or more Traffic Lanes - 1.5 Square Feet x Street Frontage
- 4. PROJECTING 0.5 Square Feet per each Linear Foot of Building Facade
- 5. OFF-PREMISE See #3 Spacing Requirements; Not > 300 Square Feet or < 15 Square Feet

Externally Illuminated Internally Illuminated Non-Illuminated

- (1 - 5) Area of Proposed Sign 25 Square Feet
- (1,2,4) Building Facade ~~60.325~~ Linear Feet
- (1 - 4) Street Frontage 210 Linear Feet
- (2 - 5) Height to Top of Sign 12 Feet Clearance to Grade 9'6" Feet
- (5) Distance from all Existing Off-Premise Signs within 600 Feet _____ Feet

Existing Signage/Type:	<u>FW -</u>	<u>15</u>	
<u>— Flushwall</u>		<u>75</u>	Sq. Ft.
<u>Freestanding</u>		<u>18</u>	Sq. Ft.
<u>Freestanding</u>		<u>63</u>	Sq. Ft.
Total Existing:		<u>171</u>	Sq. Ft.

● FOR OFFICE USE ONLY ●	
Signage Allowed on Parcel:	<u>Crossroads</u>
Building	157 <u>650</u> Sq. Ft.
Free-Standing	<u>157</u> Sq. Ft.
Total Allowed:	157 <u>650</u> Sq. Ft.

COMMENTS: _____

NOTE: No sign may exceed 300 square feet. A separate sign clearance is required for each sign. Attach a sketch of proposed and existing signage including types, dimensions, lettering, abutting streets, alleys, easements, property lines, and locations. A SEPARATE PERMIT FROM THE BUILDING DEPARTMENT IS REQUIRED.

Car Bennett 4-16-01 Pat Carl 4/18/01
Applicant's Signature Date Community Development Approval Date

(White: Community Development) (Canary: Applicant) (Pink: Building Dept) (Goldenrod: Code Enforcement)

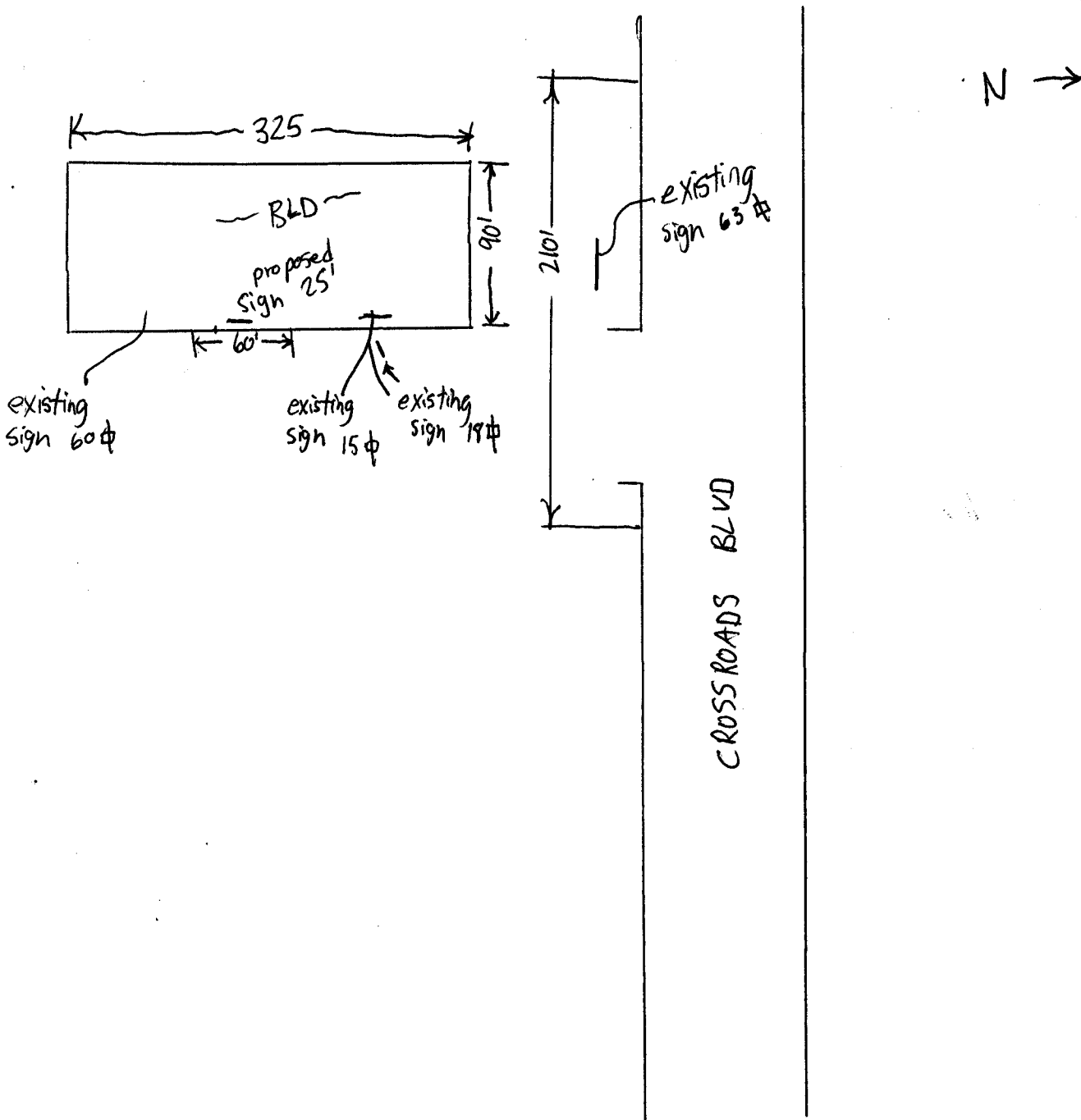

10'

CAPITAL
CAPITAL

BUSINESS SYSTEMS, INC.

30"