



SIGN Permit

AC

Community Development Department
250 North 5th Street
Grand Junction CO 81501
Phone: (970) 244-1430 FAX (970) 256-4031

Permit No. _____
Date Submitted _____
Fee \$ 920
Zone C-1 / C-2

6

TAX SCHEDULE 2943-181-15-001
BUSINESS NAME Wal-Mart Supercenter
STREET ADDRESS 2881 North Avenue
PROPERTY OWNER Wal-Mart Stores, Inc.
OWNER ADDRESS 2001 SE 10th St, Bentonville, AR

CONTRACTOR Advertising Concepts, Inc.
LICENSE NO. 2200571
ADDRESS 3725 Canal Dr, Ft Collins, CO 80524
TELEPHONE NO. 970-484-3637
CONTACT PERSON Marie Locke

- 1. FLUSH WALL 2 Square Feet per Linear Foot of Building Façade
Face change only on items 2, 3 & 4
- 2. ROOF 2 Square Feet per Linear Foot of Building Façade
- 3. FREE-STANDING 2 Traffic Lanes - 0.75 Square Feet x Street Frontage
4 or more Traffic Lanes - 1.5 Square Feet x Street Frontage
- 4. PROJECTING 0.5 Square Feet per each Linear Foot of Building Façade

Existing Externally or Internally Illuminated - No Change in Electrical Service Non-Illuminated

(1 - 4) Area of Proposed Sign: 121.89 Square Feet
(1,2,4) Building Façade: 690 Linear Feet
(1 - 4) Street Frontage: 825 Linear Feet
(2 - 4) Height to Top of Sign: 15' Feet

Clearance to Grade: 9' Feet
"Tire & Lube Express"
"1 Hr Photo"
"Pharmacy"
"Optical"

ALL EXISTING REMOVED

EXISTING SIGNAGE/TYPE:		
<u>1 - FS</u>	<u>160.34</u>	
<u>2 - FW (2 SIGNS)</u>	<u>479.9</u>	Sq. Ft.
<u>3 - FW (2 SIGNS)</u>	<u>196.47</u>	
<u>4 - FW (2 SIGNS)</u>	<u>190.38</u>	Sq. Ft.
<u>5 - FW (5 SIGNS)</u>	<u>102.47</u>	Sq. Ft.
Total Existing:	<u>1129.56</u>	Sq. Ft.

● FOR OFFICE USE ONLY ●

NORTH AVE
Signage Allowed on Parcel:

Building	<u>1380</u>	Sq. Ft.
Free-Standing	<u>300</u>	Sq. Ft.
Total Allowed:	<u>1380</u>	Sq. Ft.

COMMENTS: Four (4) signs on this application

NOTE: No sign may exceed 300 square feet. A separate sign permit is required for each sign. Attach a sketch, to scale, of proposed and existing signage including types, dimensions and lettering. Attach a plot plan, to scale, showing: abutting streets, alleys, easements, driveways, encroachments, property lines, distances from existing buildings to proposed signs and required setbacks. Roof signs shall be manufactured such that no guy wires, braces or supports shall be visible.

I hereby attest that the information on this form and the attached sketches are true and accurate.

Marie Locke 07-11-01 Bill Nuth 7-18-01
Applicant's Signature Date Community Development Approval Date

(White: Community Development)

(Canary: Applicant)

(Pink: Code Enforcement)

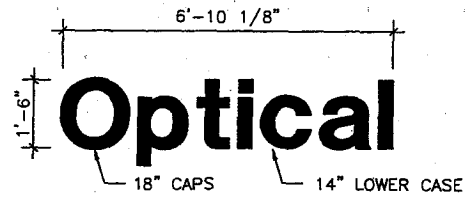

HELVETICA MEDIUM STUD MOUNT PLASTIC LETTERS
 ① 18" OPTICAL SIGN N.T.S.
 10.25 SQ. FT.

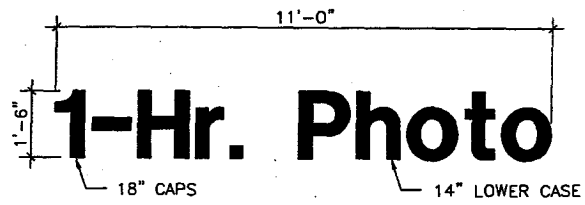

③ 18" 1-HR. PHOTO SIGN N.T.S.
 16.5 SQ. FT.

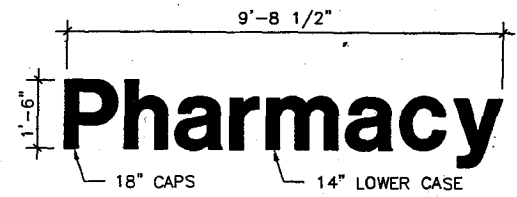

HELVETICA MEDIUM STUD MOUNT PLASTIC LETTERS
 ⑤ 18" PHARMACY SIGN N.T.S.
 14.56 SQ. FT.

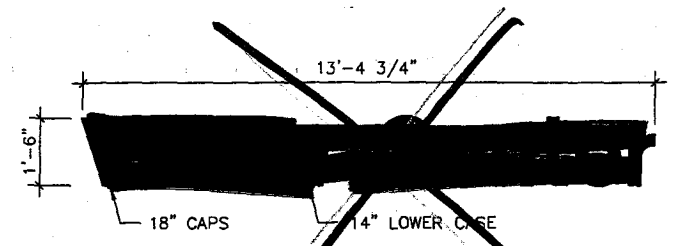

HELVETICA MEDIUM STUD MOUNT PLASTIC LETTERS
 ② 18" VISION CENTER SIGN N.T.S.
 20.10 SQ. FT.

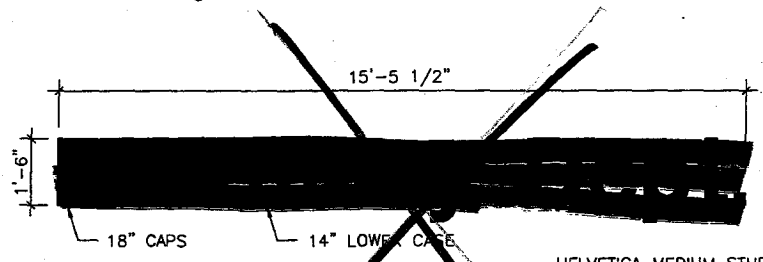

HELVETICA MEDIUM STUD MOUNT PLASTIC LETTERS
 ④ 18" PHARMACY DEPT. SIGN N.T.S.
 23.19 SQ. FT.

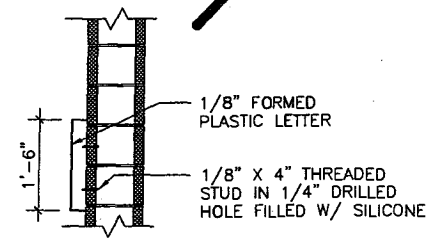

LETTERS ON SPLIT-FACE
 ⑥ SIGNAGE SECTION N.T.S.

NOTE: DRAWINGS ON SHEET NOT TO SCALE.

ANCILLARY SIGNING	
WAL*MART	
REVISION DATE: 09-15-00	
D-1	

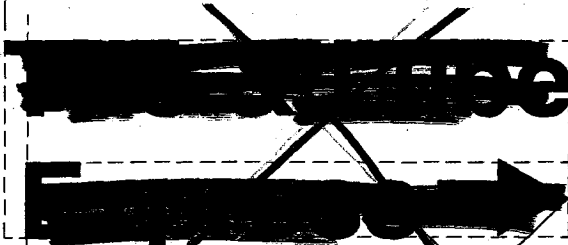

LEFT SIDE
TILE STOREFRONT

THE ARROW LINES UP WITH
THE END OF THE LETTER
"e"

THE ARROW LINES UP WITH
THE TOP AND BOTTOM OF
OF LETTER "E"

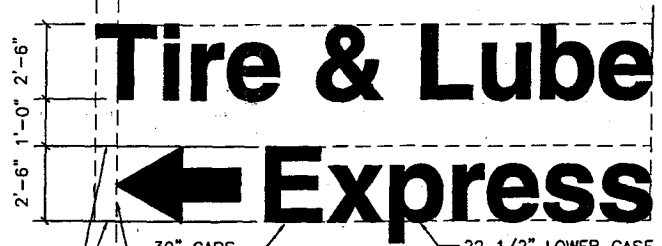

Tire & Lube (47.7 SQ. FT.)

← Express (32.88 SQ. FT.)

30" CAPS

22 1/2" LOWER CASE

THE ARROW LINES UP
WITH THE STEM OF THE
LETTER "T"

RIGHT SIDE
TILE STOREFRONT

1 FRONT ELEVATION

N.T.S.

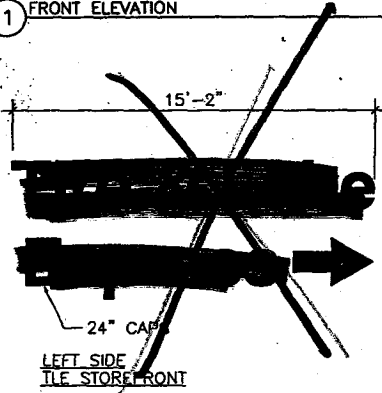

LEFT SIDE
TILE STOREFRONT

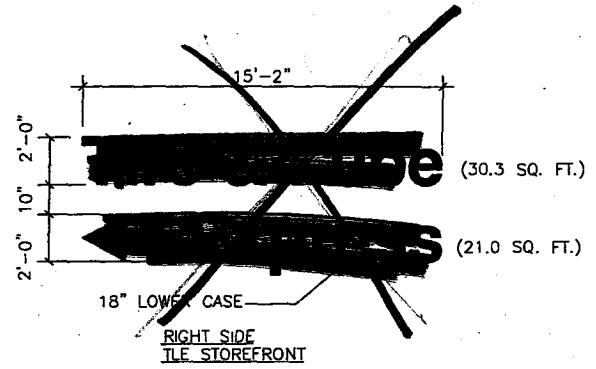

RIGHT SIDE
TILE STOREFRONT

(30.3 SQ. FT.)

(21.0 SQ. FT.)

2 FRONT ELEVATION

N.T.S.

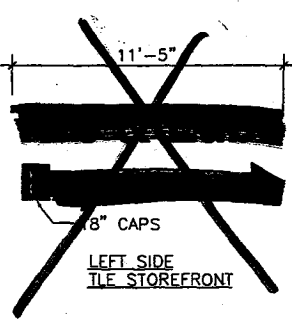

LEFT SIDE
TILE STOREFRONT

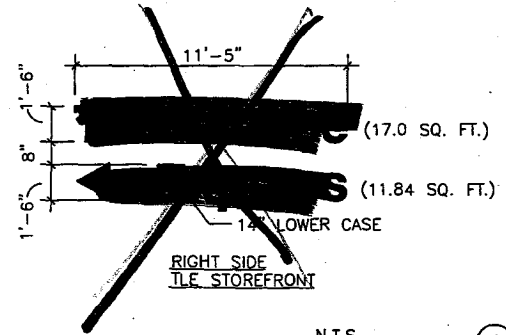

RIGHT SIDE
TILE STOREFRONT

(17.0 SQ. FT.)

(11.84 SQ. FT.)

3 FRONT ELEVATION

N.T.S.

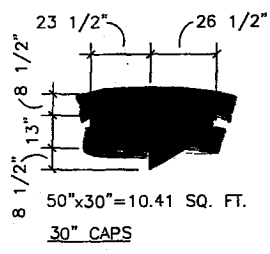

50"x30"=10.41 SQ. FT.

30" CAPS

4 ARROW DIMENSIONS

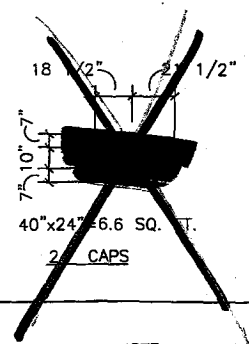

40"x24"=6.6 SQ. FT.

24" CAPS

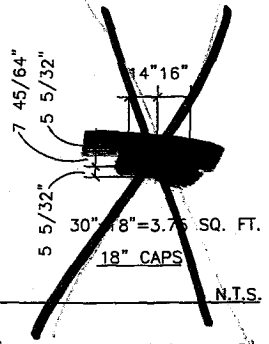

30"x18"=3.75 SQ. FT.

18" CAPS

N.T.S.

NOTE: DRAWINGS ON SHEET NOT TO SCALE.

T.L.E. SIGNING	
WAL★MART	
REVISION DATE: 09-15-00	
E-1	