



SIGN PERMIT

[Handwritten signature]

Community Development Department
250 North 5th Street
Grand Junction, CO 81501
(970) 244-1430

Permit No. N/A
Date Submitted 4/24/02
FEE \$ 25.00
Tax Schedule 2945-142-02-002
Zone C-1

BUSINESS NAME HALEY'S AUTO
STREET ADDRESS 261 NORTH AVE
PROPERTY OWNER JOHN HALEY
OWNER ADDRESS 261 NORTH AVE

CONTRACTOR SIGNS FIRST
LICENSE NO. 202 0958
ADDRESS 950 NORTH AVE
TELEPHONE NO. 256-1877

- 1. FLUSH WALL 2 Square Feet per Linear Foot of Building Facade
- Face Change Only (2,3 & 4):
- 2. ROOF 2 Square Feet per Linear Foot of Building Facade
- 3. FREE-STANDING 2 Traffic Lanes - 0.75 Square Feet x Street Frontage
4 or more Traffic Lanes - 1.5 Square Feet x Street Frontage
- 4. PROJECTING 0.5 Square Feet per each Linear Foot of Building Facade

Existing Externally or Internally Illuminated - No Change in Electrical Service Non-Illuminated

(1 - 4) Area of Proposed Sign 56 1/4 Square Feet
(1,2,4) Building Facade 61'4" Linear Feet NORTH AVE 20' 3rd ST.
(1 - 4) Street Frontage 100 Linear Feet NORTH AVE
(2,3,4) Height to Top of Sign 21' Feet Clearance to Grade 13 1/2' Feet

Existing Signage/Type:	Sq. Ft.
	Sq. Ft.
	Sq. Ft.
	Sq. Ft.
Total Existing:	Sq. Ft.

● FOR OFFICE USE ONLY ●	
Signage Allowed on Parcel:	<u>North Ave</u>
Building	<u>122.8</u> Sq. Ft.
Free-Standing	<u>150</u> Sq. Ft.
Total Allowed:	<u>150</u> Sq. Ft.

COMMENTS: RE - FREE EXISTING FREE STANDING SIGN.

NOTE: No sign may exceed 300 square feet. A separate sign permit is required for each sign. Attach a sketch of proposed and existing signage including types, dimensions, lettering, abutting streets, alleys, easements, property lines, and locations. Roof signs shall be manufactured such that no guy wires, braces or supports shall be visible.

Applicant's Signature [Signature] Date 4/23/02 Community Development Approval C. Gayer Johnson Date 4/25/02

(White: Community Development) (Canary: Applicant) (Pink: Code Enforcement)

261 North Ave.
PLOT PLAN

North Ave

100'

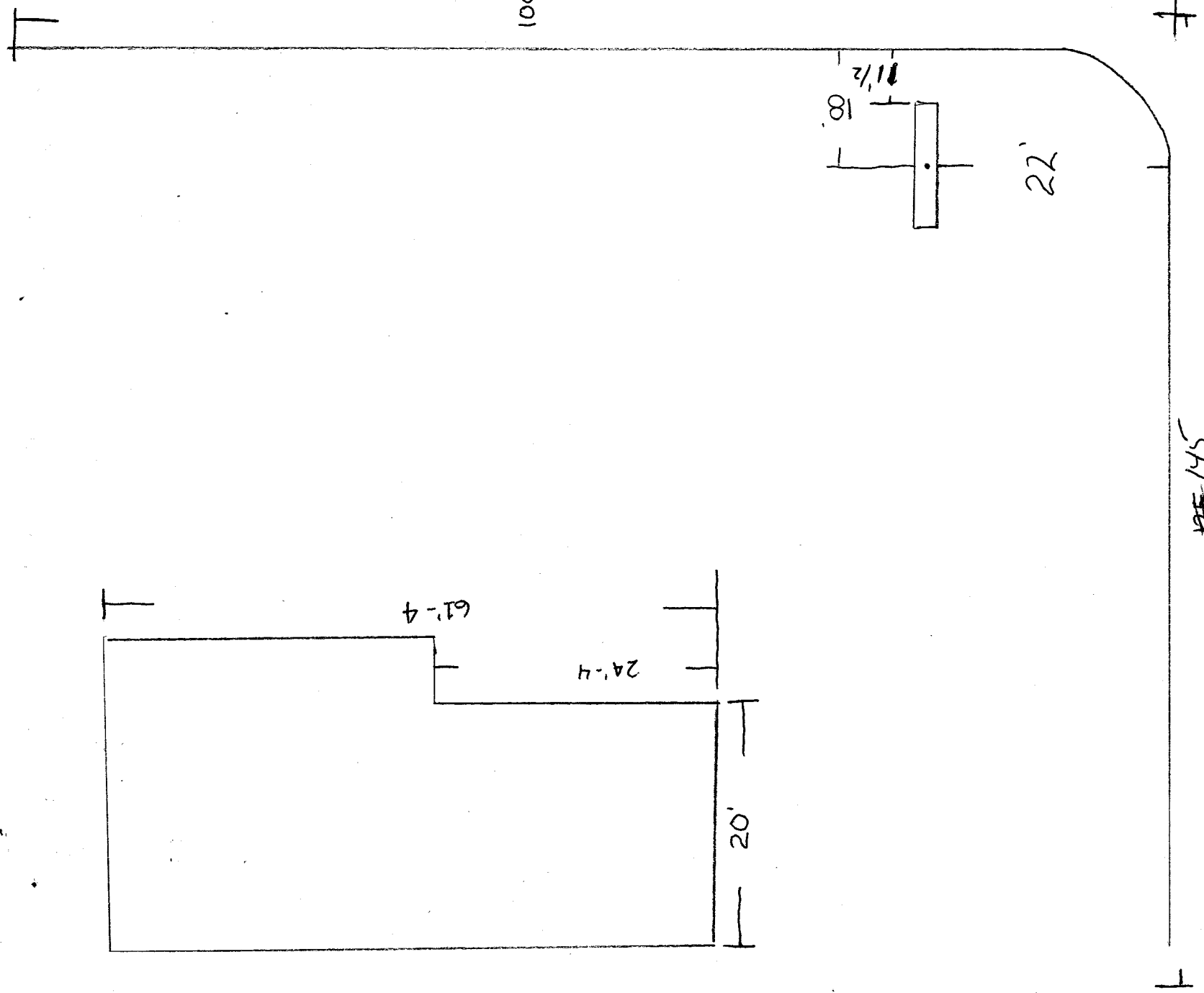

22'

18'

11 1/2'

~~54' 1/2~~
3rd St.

20'

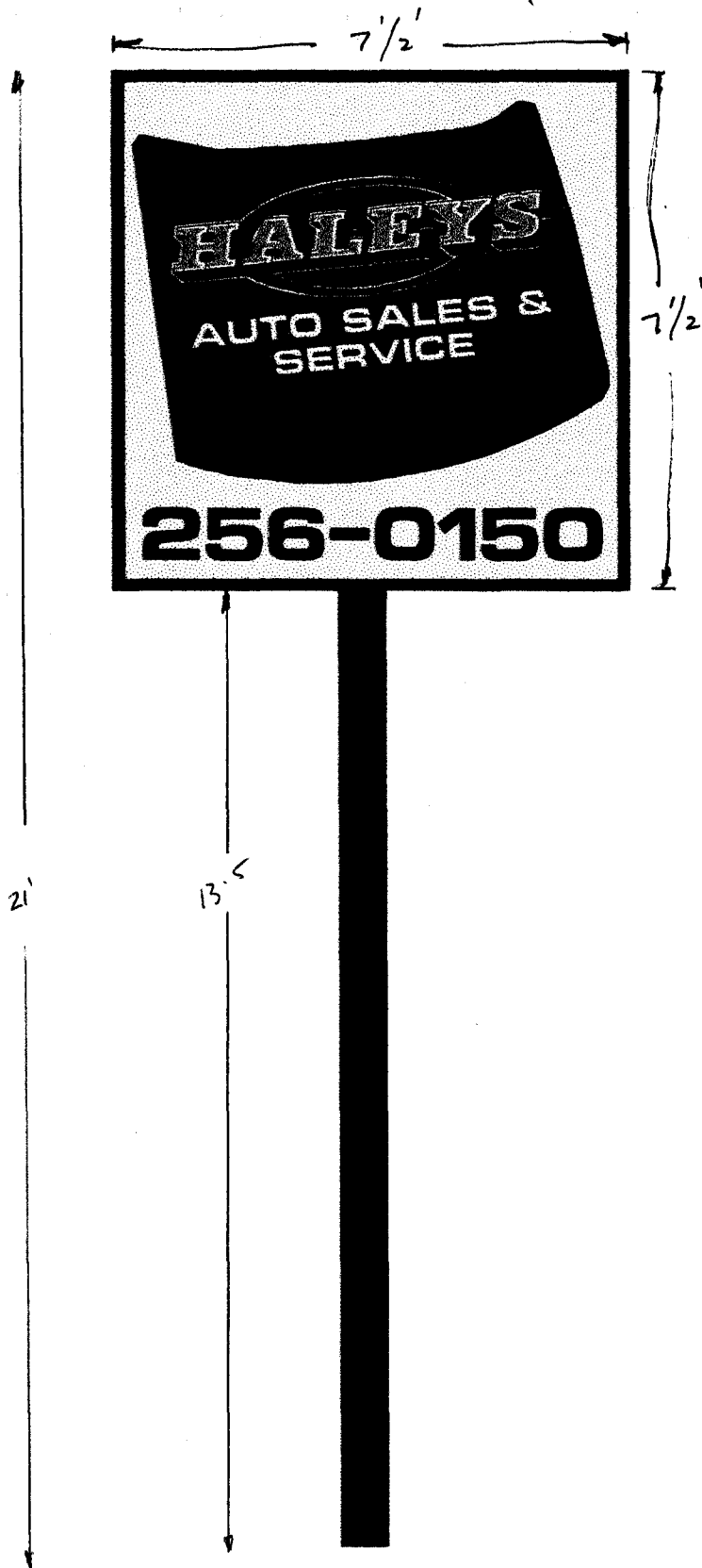

261 NORTH AVE