



SIGN PERMIT

①

Community Development Department
250 North 5th Street
Grand Junction, CO 81501
(970) 244-1430

Permit No. _____
Date Submitted 6/18/02
FEE \$ 25.00
Tax Schedule 2945-141-01-001
Zone C-1

BUSINESS NAME Harbor Discount
STREET ADDRESS 657 North Ave
PROPERTY OWNER James Cook
OWNER ADDRESS 406 Ridgeway Dr.

CONTRACTOR Platinum Sign Co
LICENSE NO. 2020812
ADDRESS 2916 I-70B
TELEPHONE NO. 248-9677 Mike

- 1. FLUSH WALL 2 Square Feet per Linear Foot of Building Facade
- Face Change Only (2,3 & 4):*
- 2. ROOF 2 Square Feet per Linear Foot of Building Facade
- 3. FREE-STANDING 2 Traffic Lanes - 0.75 Square Feet x Street Frontage
4 or more Traffic Lanes - 1.5 Square Feet x Street Frontage
- 4. PROJECTING 0.5 Square Feet per each Linear Foot of Building Facade

Existing Externally or Internally Illuminated - No Change in Electrical Service Non-Illuminated

(1 - 4) Area of Proposed Sign 24 Square Feet
(1,2,4) Building Facade 57 Linear Feet
(1 - 4) Street Frontage 135 Linear Feet
(2,3,4) Height to Top of Sign 20 Feet Clearance to Grade 10 Feet

Existing Signage/Type:	
Freestanding 4'x5 Marquee	20 Sq. Ft.
	Sq. Ft.
	Sq. Ft.
Total Existing:	Sq. Ft.

● FOR OFFICE USE ONLY ●	
Signage Allowed on Parcel:	
Building	114 Sq. Ft.
Free-Standing	199.5 Sq. Ft.
Total Allowed:	199.5 Sq. Ft.

COMMENTS: we are changing faces in existing sign.

NOTE: No sign may exceed 300 square feet. A separate sign permit is required for each sign. Attach a sketch of proposed and existing signage including types, dimensions, lettering, abutting streets, alleys, easements, property lines, and locations. Roof signs shall be manufactured such that no guy wires, braces or supports shall be visible.

[Signature] 6-18-02 C. Toney Gibson 6/18/02
Applicant's Signature Date Community Development Approval Date

(White: Community Development) (Canary: Applicant) (Pink: Code Enforcement)

N
7th

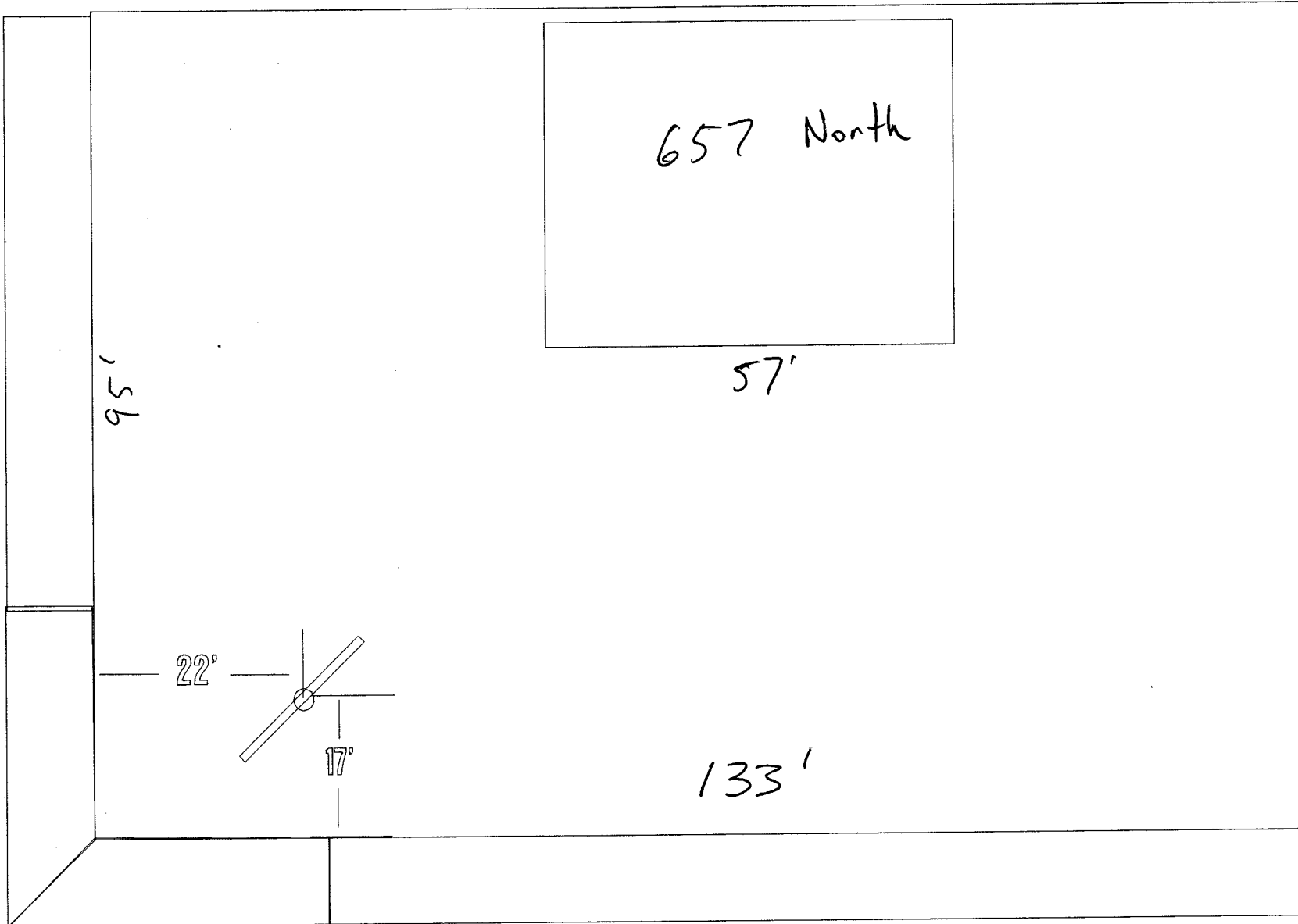

North Ave

6'

**Harbor
Discount
Tools**

A silhouette of a water tower is positioned to the right of the word 'Tools' within the sign's border. The sign itself is a rectangular graphic with a double-line border. The text 'Harbor Discount Tools' is arranged in three lines, slanted upwards from left to right. The word 'Tools' is the largest and is rendered in a bold, outlined font. The water tower silhouette is a simple black shape with a lattice tower and a cylindrical tank on top.

4'