



SIGN PERMIT

@

Community Development Department
250 North 5th Street
Grand Junction, CO 81501
(970) 244-1430

Permit No. None
Date Submitted 1/10/02
FEE \$ 25.00
Tax Schedule 2945-144-17-013
Zone B-2

BUSINESS NAME The Nail Nook CONTRACTOR Platinum Sign Co
STREET ADDRESS 734 Main St LICENSE NO. 2010577
PROPERTY OWNER Rodney Whitray Long Valley LLC ADDRESS 2916 E-70B
OWNER ADDRESS Same TELEPHONE NO. 248-9677 Mike

- 1. FLUSH WALL 2 Square Feet per Linear Foot of Building Facade
- Face Change Only (2,3 & 4):**
- 2. ROOF 2 Square Feet per Linear Foot of Building Facade
- 3. FREE-STANDING 2 Traffic Lanes - 0.75 Square Feet x Street Frontage
4 or more Traffic Lanes - 1.5 Square Feet x Street Frontage
- 4. PROJECTING 0.5 Square Feet per each Linear Foot of Building Facade

Existing Externally or Internally Illuminated - No Change in Electrical Service Non-Illuminated

(1 - 4) Area of Proposed Sign 4 Square Feet
(1,2,4) Building Facade 40 Linear Feet
(1 - 4) Street Frontage 72 Linear Feet
(2,3,4) Height to Top of Sign 20 Feet Clearance to Grade 6 Feet

Existing Signage/Type:	
4'x8' Freestanding	32 Sq. Ft.
2'x30" Freestanding	5 Sq. Ft.
2'x5'6" Freestanding	11 Sq. Ft.
Total Existing:	48 Sq. Ft.

● FOR OFFICE USE ONLY ●	
Signage Allowed on Parcel:	
Building	80 Sq. Ft.
Free-Standing	54 Sq. Ft.
Total Allowed:	80 Sq. Ft.

COMMENTS: Sign is existing and they where
fickited. We did not install

NOTE: No sign may exceed 300 square feet. A separate sign permit is required for each sign. Attach a sketch of proposed and existing signage including types, dimensions, lettering, abutting streets, alleys, easements, property lines, and locations. Roof signs shall be manufactured such that no guy wires, braces or supports shall be visible.

[Signature] 2-10-03 [Signature] 1/10/02
Applicant's Signature Date Community Development Approval Date

(White: Community Development) (Canary: Applicant) (Pink: Code Enforcement)

4' x 8'
existing

24" x 30"
existing

2' x 5' 6"
existing

2' x 2'
Proposed

20'

6'

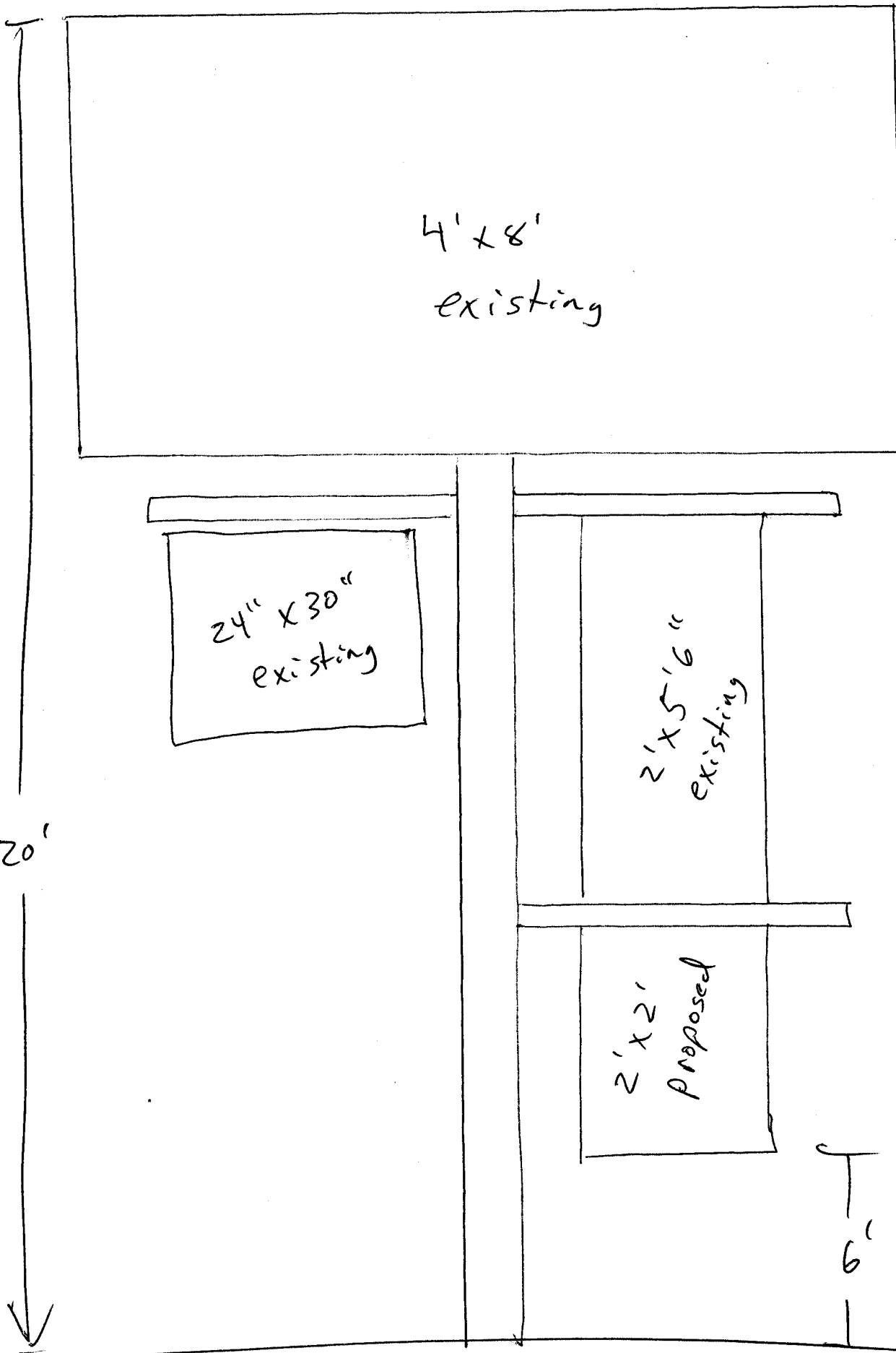

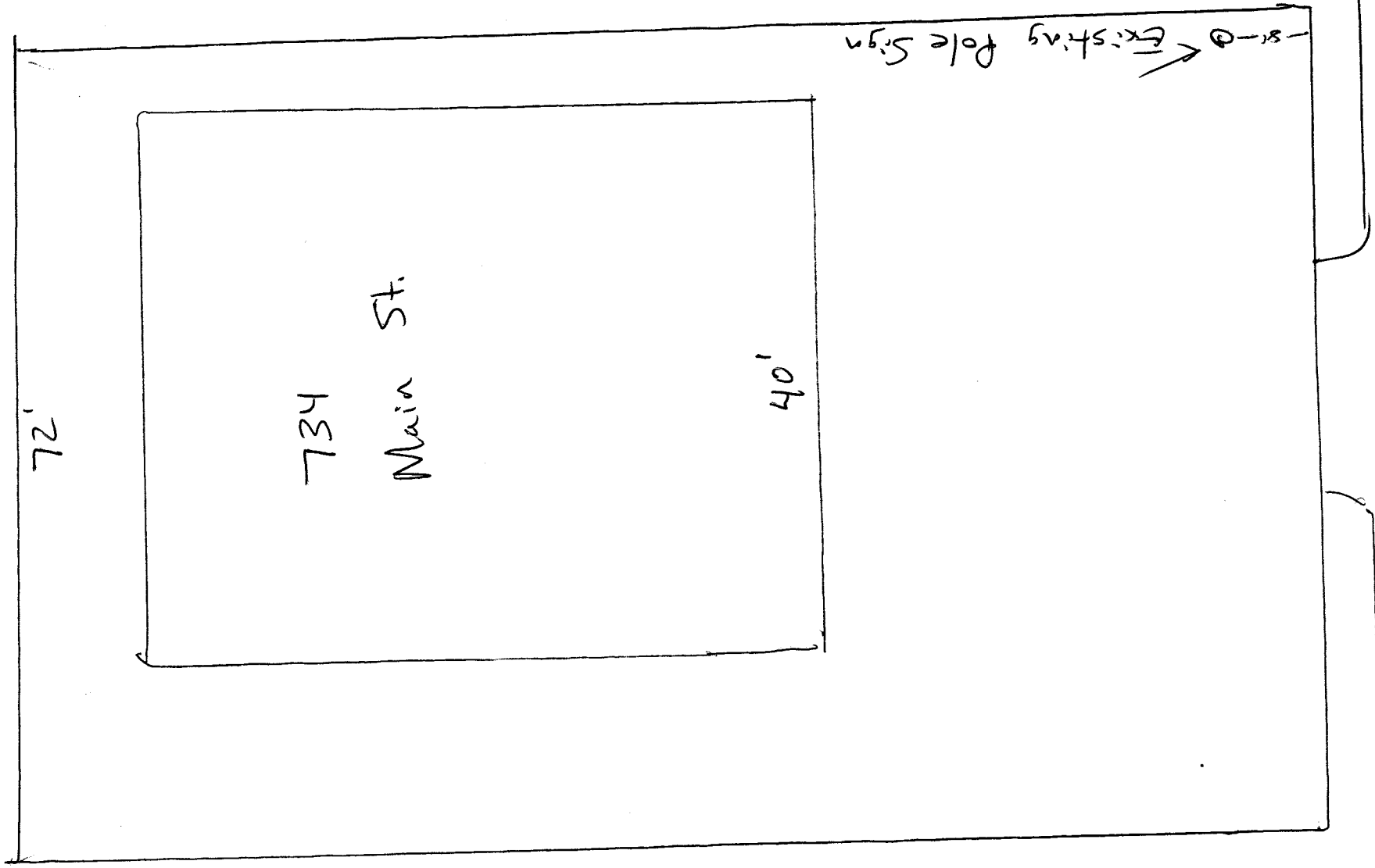

(2) →