



SIGN CLEARANCE

2

Community Development Department
250 North 5th Street
Grand Junction, CO 81501
(970) 244-1430

Clearance No. 87454
Date Submitted 12-6-02
FEE \$ 25.00
Tax Schedule 2945 123 00 087
Zone C-1

BUSINESS NAME Sinclair oil/stadium
STREET ADDRESS 1210 No Ave
PROPERTY OWNER Ollin wineland est
OWNER ADDRESS po box 810496
Dallas Tex 75381

CONTRACTOR western neon sign co
LICENSE NO. 2021111
ADDRESS 3183 Hall Ave
TELEPHONE NO. 523 4045

- 1. FLUSH WALL 2 Square Feet per Linear Foot of Building Facade
- 2. ROOF 2 Square Feet per Linear Foot of Building Facade
- 3. FREE-STANDING 2 Traffic Lanes - 0.75 Square Feet x Street Frontage
4 or more Traffic Lanes - 1.5 Square Feet x Street Frontage
- 4. PROJECTING 0.5 Square Feet per each Linear Foot of Building Facade
- 5. OFF-PREMISE See #3 Spacing Requirements; Not > 300 Square Feet or < 15 Square Feet

Externally Illuminated Internally Illuminated Non-Illuminated

- (1 - 5) Area of Proposed Sign 35 Square Feet
- (1,2,4) Building Facade 42 Linear Feet
- (1 - 4) Street Frontage 127 Linear Feet
- (2 - 5) Height to Top of Sign 23.5 Feet Clearance to Grade 18.5 Feet
- (5) Distance from all Existing Off-Premise Signs within 600 Feet _____ Feet

Existing Signage/Type:	
<u>1 4'6" x 6'4" Price sign</u>	<u>28.8</u> Sq. Ft.
	Sq. Ft.
	Sq. Ft.
Total Existing:	Sq. Ft.

● FOR OFFICE USE ONLY ●		
Signage Allowed on Parcel: <u>12th Street</u>		
Building	<u>84</u>	Sq. Ft.
Free-Standing	<u>190</u>	Sq. Ft.
Total Allowed:	<u>190</u>	Sq. Ft.

COMMENTS: _____

NOTE: No sign may exceed 300 square feet. A separate sign clearance is required for each sign. Attach a sketch of proposed and existing signage including types, dimensions, lettering, abutting streets, alleys, easements, property lines, and locations. **A SEPARATE PERMIT FROM THE BUILDING DEPARTMENT IS REQUIRED.**

Ray McManis 12/6/02 Mishi Aragon 12/9/02
 Applicant's Signature Date Community Development Approval Date

(White: Community Development) (Canary: Applicant) (Pink: Building Dept) (Goldenrod: Code Enforcement)

Sinclair stadium station
1210 No Ave

12 st 4 lanes

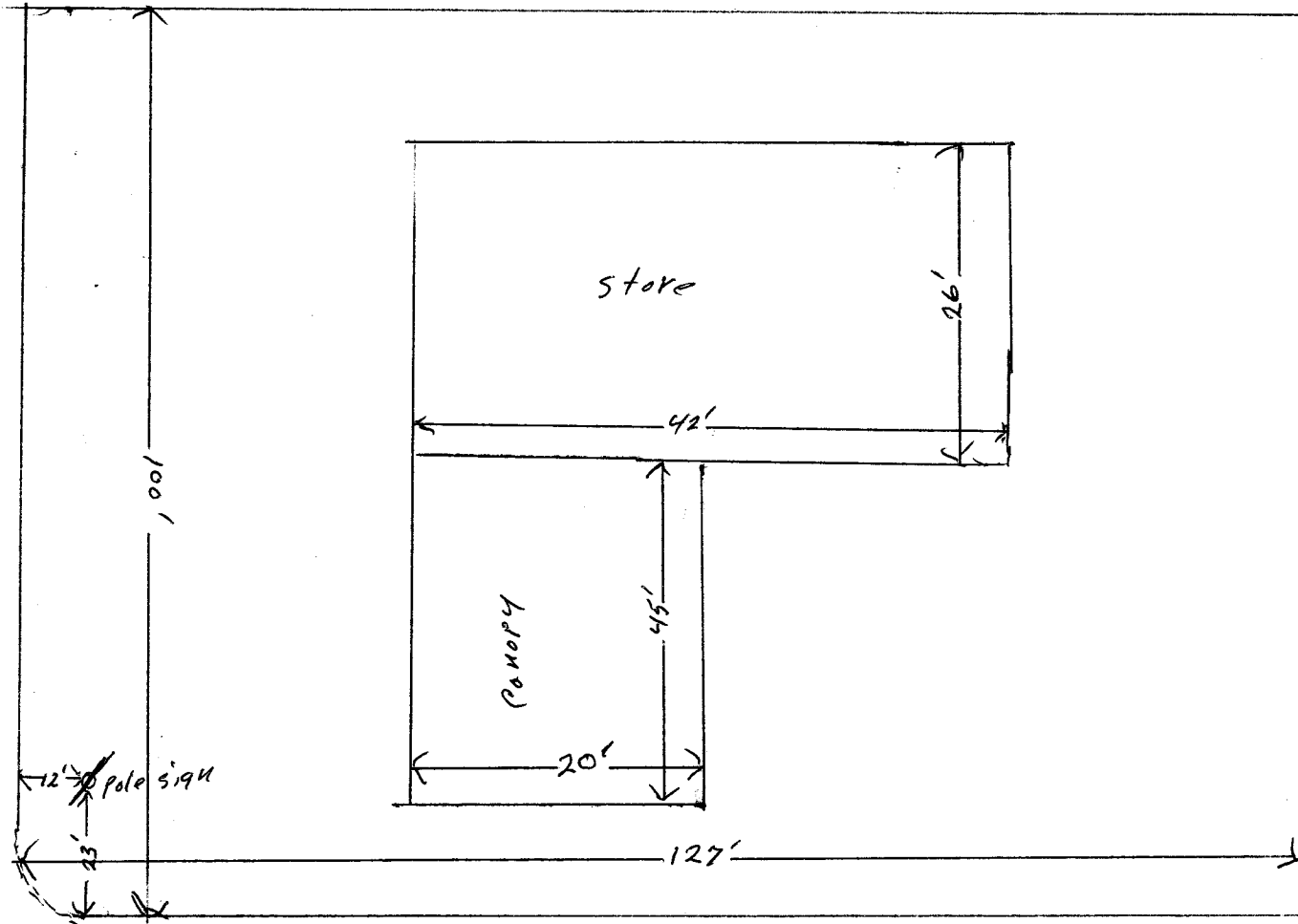

MacDonald's

No Ave 4 lanes

