



# SIGN PERMIT

②

• **Community Development Department**  
 250 North 5th Street  
 Grand Junction, CO 81501  
 (970) 244-1430

Permit No. \_\_\_\_\_  
 Date Submitted 11-14-02  
 FEE \$ 25.00  
 Tax Schedule 2945-111-33-001  
 Zone R0

BUSINESS NAME Katy Rieves, M.D.  
 STREET ADDRESS 2139 N. 12th  
 PROPERTY OWNER Pete Miller  
 OWNER ADDRESS \_\_\_\_\_

CONTRACTOR Bud's signs  
 LICENSE NO. 2020157  
 ADDRESS 1055 vte  
 TELEPHONE NO. 245-7700

1. **FLUSH WALL** 2 Square Feet per Linear Foot of Building Facade  
**Face Change Only (2,3 & 4):**  
 2. **ROOF** 2 Square Feet per Linear Foot of Building Facade  
 3. **FREE-STANDING** 2 Traffic Lanes - 0.75 Square Feet x Street Frontage  
 4 or more Traffic Lanes - 1.5 Square Feet x Street Frontage  
 4. **PROJECTING** 0.5 Square Feet per each Linear Foot of Building Facade

Existing Externally or Internally Illuminated - No Change in Electrical Service  Non-Illuminated

(1 - 4) Area of Proposed Sign 15 Square Feet  
 (1,2,4) Building Facade 120 Linear Feet  
 (1 - 4) Street Frontage 345 Linear Feet  
 (2,3,4) Height to Top of Sign 12 Feet Clearance to Grade 10 Feet

Existing Signage/Type:	
Free-standing	<u>25</u> Sq. Ft.
Flush wall <u>3 @ 15</u>	<u>45</u> Sq. Ft.
Flush wall	<u>26</u> Sq. Ft.
Total Existing:	<u>96</u> Sq. Ft.

● FOR OFFICE USE ONLY ●	
Signage Allowed on Parcel: <u>N 12th St</u>	
Building	<u>240</u> Sq. Ft.
Free-Standing	<u>517.5</u> Sq. Ft.
Total Allowed:	<u>300</u> Sq. Ft.

COMMENTS: See file # PP-2007-029 per approved plan

**NOTE:** No sign may exceed 300 square feet. A separate sign permit is required for each sign. Attach a sketch of proposed and existing signage including types, dimensions, lettering, abutting streets, alleys, easements, property lines, and locations. Roof signs shall be manufactured such that no guy wires, braces or supports shall be visible.

Eric Bennett 11-14-02 Michelle Magoo 11-14-02  
 Applicant's Signature Date Community Development Approval Date

(White: Community Development) (Canary: Applicant) (Pink: Code Enforcement)

# SIGNS

and *Leon*

12<sup>TH</sup> Street Plaza

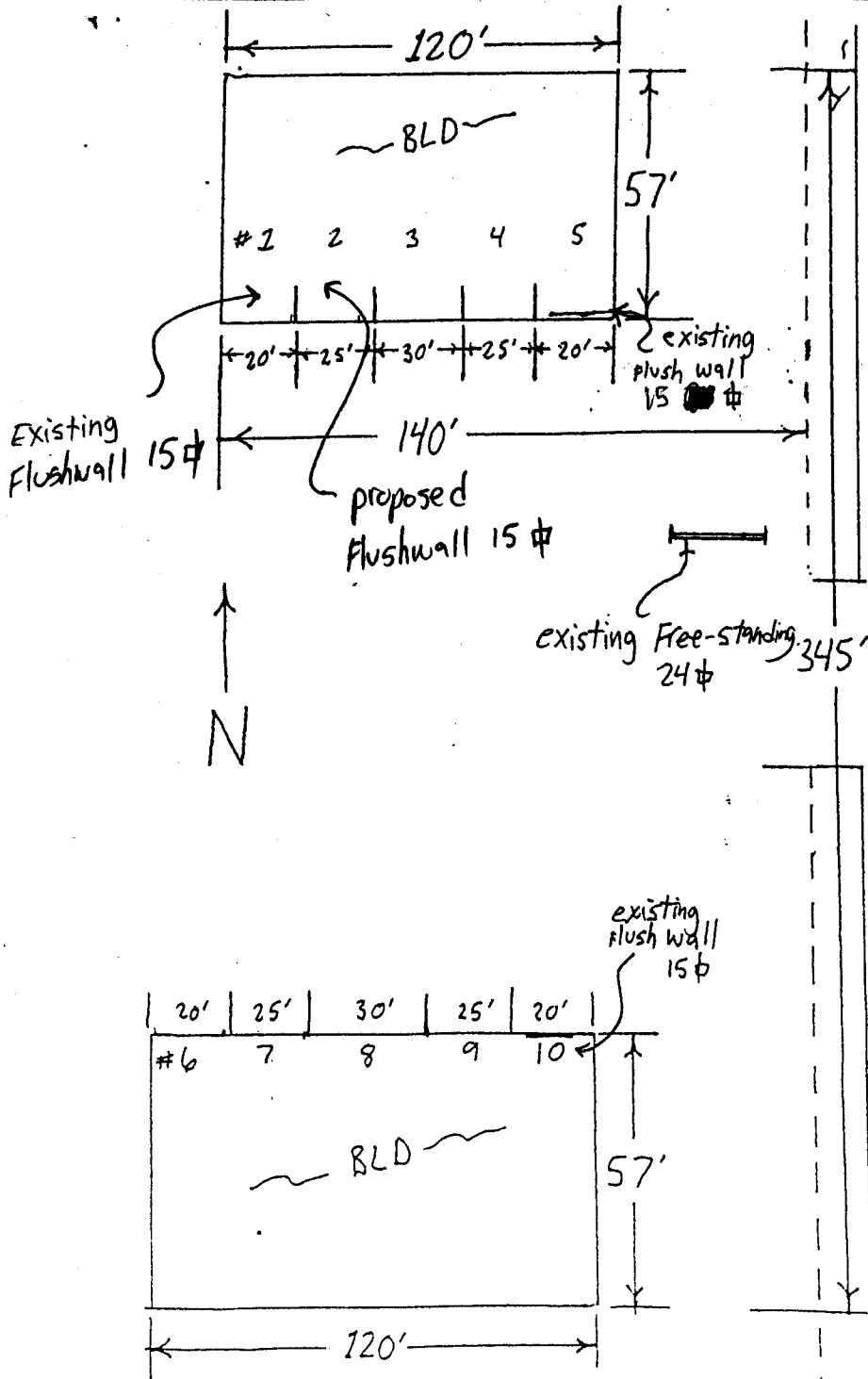

2139 N 12<sup>TH</sup>

1055 UTE AVE. GRAND JUNCTION COLORADO 81501 970-2

15 ♣

**KATY RIEVES, M.D.**

---

**ADOLESCENT AND ADULT HEALTH CARE**