



SIGN PERMIT

2

Community Development Department
250 North 5th Street
Grand Junction, CO 81501
(970) 244-1430

Permit No. _____
Date Submitted 10-17-02
FEE \$ 25.00
Tax Schedule 2943-182-04-001
Zone I-1

BUSINESS NAME Rocky Mt. Supply Co. Inc. CONTRACTOR Sourdough Signs
STREET ADDRESS 2850 Chipeta Ave #C LICENSE NO. 2020973
PROPERTY OWNER Mike McGinnis ADDRESS 2223 H Rd
OWNER ADDRESS _____ TELEPHONE NO. 243-1383

- 1. FLUSH WALL 2 Square Feet per Linear Foot of Building Facade
- Face Change Only (2,3 & 4):**
- 2. ROOF 2 Square Feet per Linear Foot of Building Facade
- 3. FREE-STANDING 2 Traffic Lanes - 0.75 Square Feet x Street Frontage
4 or more Traffic Lanes - 1.5 Square Feet x Street Frontage
- 4. PROJECTING 0.5 Square Feet per each Linear Foot of Building Facade

Existing Externally or Internally Illuminated - No Change in Electrical Service Non-Illuminated

(1 - 4) Area of Proposed Sign 16 Square Feet
(1,2,4) Building Facade 100 Linear Feet
(1 - 4) Street Frontage 120 Linear Feet
(2,3,4) Height to Top of Sign _____ Feet Clearance to Grade _____ Feet

Existing Signage/Type:	
Freestanding - <u>247 on 28 1/2 Rd</u> <u>247 on chipeta</u>	<u>48</u> Sq. Ft.
Flush mt. - <u>chipeta frontage</u>	<u>32.5</u> Sq. Ft.
Total Existing:	<u>80.5</u> Sq. Ft.

● FOR OFFICE USE ONLY ●		
Signage Allowed on Parcel: <u>Chipeta Ave</u>		
Building	<u>200</u>	Sq. Ft.
Free-Standing	<u>90</u>	Sq. Ft.
Total Allowed:	<u>200</u>	Sq. Ft.

COMMENTS:

NOTE: No sign may exceed 300 square feet. A separate sign permit is required for each sign. Attach a sketch of proposed and existing signage including types, dimensions, lettering, abutting streets, alleys, easements, property lines, and locations. Roof signs shall be manufactured such that no guy wires, braces or supports shall be visible.

Sarah H. Helberg 10/17/02 Mike Magan 10/18/02
Applicant's Signature Date Community Development Approval Date

(White: Community Development) (Canary: Applicant) (Pink: Code Enforcement)

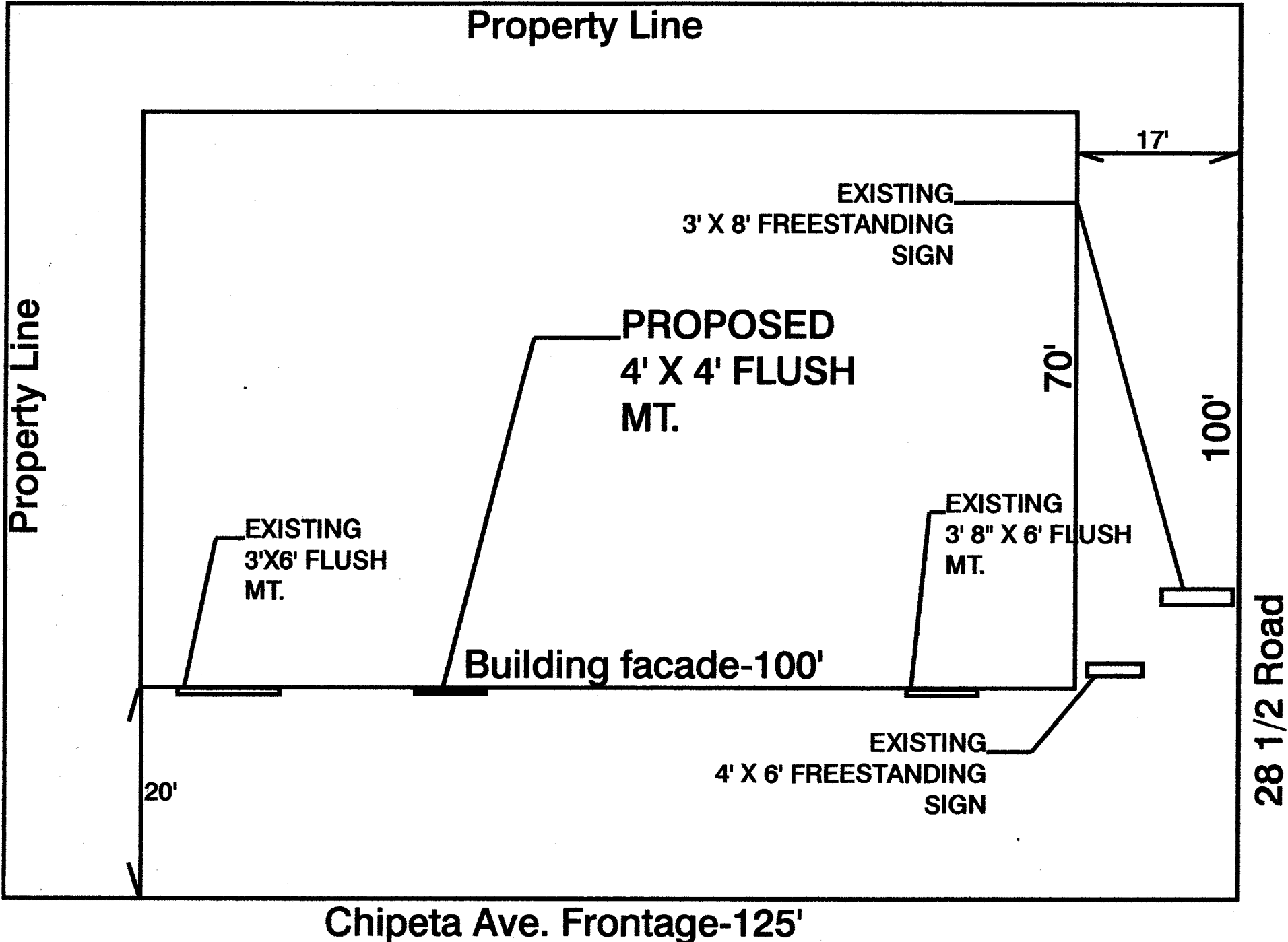

2850 Chipeta Ave.-Unit C

4'-0"

4'-0"

**ROCKY
MOUNTAIN**

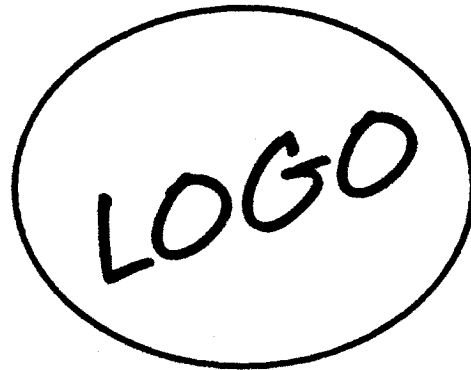

SUPPLY CO. INC.