



# SIGN PERMIT

A@

Community Development Department  
250 North 5th Street  
Grand Junction, CO 81501  
(970) 244-1430

Permit No. \_\_\_\_\_  
Date Submitted 3/24/03  
FEE \$ 25.00  
Tax Schedule 2945-143-16-011  
Zone B-2

BUSINESS NAME Grand Junction Free Press  
STREET ADDRESS 428 Main  
PROPERTY OWNER \_\_\_\_\_  
OWNER ADDRESS \_\_\_\_\_

CONTRACTOR Bud's Signs  
LICENSE NO. 2030106  
ADDRESS 1055 ute  
TELEPHONE NO. 245-7700

- 1. FLUSH WALL 2 Square Feet per Linear Foot of Building Facade
- Face Change Only (2,3 & 4):
- 2. ROOF 2 Square Feet per Linear Foot of Building Facade
- 3. FREE-STANDING 2 Traffic Lanes - 0.75 Square Feet x Street Frontage  
4 or more Traffic Lanes - 1.5 Square Feet x Street Frontage
- 4. PROJECTING 0.5 Square Feet per each Linear Foot of Building Facade

Existing Externally or Internally Illuminated - No Change in Electrical Service  Non-Illuminated

- (1 - 4) Area of Proposed Sign 12 Square Feet
- (1,2,4) Building Facade 22 Linear Feet
- (1 - 4) Street Frontage 25 Linear Feet
- (2,3,4) Height to Top of Sign 20 Feet Clearance to Grade 14 Feet

Existing Signage/Type:	
	0 Sq. Ft.
	Sq. Ft.
	Sq. Ft.
Total Existing:	0 Sq. Ft.

● FOR OFFICE USE ONLY ●	
Signage Allowed on Parcel:	<u>Flush wall</u>
Building	<del>44</del> Sq. Ft.
Free-Standing	Sq. Ft.
Total Allowed:	<u>44</u> Sq. Ft.

COMMENTS: \_\_\_\_\_

**NOTE:** No sign may exceed 300 square feet. A separate sign permit is required for each sign. Attach a sketch of proposed and existing signage including types, dimensions, lettering, abutting streets, alleys, easements, property lines, and locations. Roof signs shall be manufactured such that no guy wires, braces or supports shall be visible.

Eui Bemsta      3-21-03      C. Faye Wilson      3/26/03  
 Applicant's Signature      Date      Community Development Approval      Date

(White: Community Development)      (Canary: Applicant)      (Pink: Code Enforcement)



# SIGN PERMIT

(B)

Community Development Department  
250 North 5th Street  
Grand Junction, CO 81501  
(970) 244-1430

Permit No. \_\_\_\_\_  
Date Submitted 3/24/03  
FEE \$ 5.00  
Tax Schedule 2945-143-16-011  
Zone B-2

BUSINESS NAME Grand Junction Free Press  
STREET ADDRESS 428 Main  
PROPERTY OWNER \_\_\_\_\_  
OWNER ADDRESS \_\_\_\_\_

CONTRACTOR Bud's Signs  
LICENSE NO. 2030106  
ADDRESS 1055 ute  
TELEPHONE NO. 245-7700

- 1. FLUSH WALL 2 Square Feet per Linear Foot of Building Facade
- Face Change Only (2,3 & 4):*
- 2. ROOF 2 Square Feet per Linear Foot of Building Facade
- 3. FREE-STANDING 2 Traffic Lanes - 0.75 Square Feet x Street Frontage  
4 or more Traffic Lanes - 1.5 Square Feet x Street Frontage
- 4. PROJECTING 0.5 Square Feet per each Linear Foot of Building Facade

Existing Externally or Internally Illuminated - No Change in Electrical Service  Non-Illuminated

(1 - 4) Area of Proposed Sign 3 Square Feet  
(1,2,4) Building Facade 22 Linear Feet  
(1 - 4) Street Frontage 25 Linear Feet  
(2,3,4) Height to Top of Sign 9 Feet Clearance to Grade 8 Feet

Existing Signage/Type:	
<u>Flush Wall</u>	<u>12</u> Sq. Ft.
	Sq. Ft.
	Sq. Ft.
Total Existing:	<u>12</u> Sq. Ft.

● FOR OFFICE USE ONLY ●	
Signage Allowed on Parcel:	
Building	<u>11</u> Sq. Ft.
Free-Standing	Sq. Ft.
Total Allowed:	<u>11</u> Sq. Ft.

COMMENTS: \_\_\_\_\_

**NOTE:** No sign may exceed 300 square feet. A separate sign permit is required for each sign. Attach a sketch of proposed and existing signage including types, dimensions, lettering, abutting streets, alleys, easements, property lines, and locations. Roof signs shall be manufactured such that no guy wires, braces or supports shall be visible.

Eric Bernick 3-21-03 C. Fay Gibson 3/26/03  
Applicant's Signature Date Community Development Approval Date

(White: Community Development) (Canary: Applicant) (Pink: Code Enforcement)

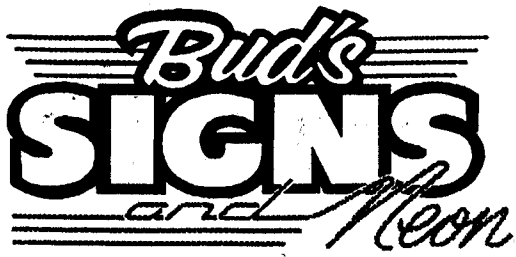

We Do Signs RIGHT!

---

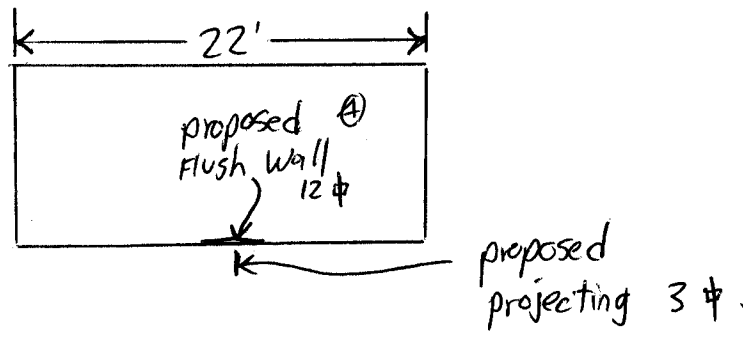

---

428 Main St.

---

(A) & (B)  
12¢ 3¢

**grand junction**



**Free Press**

**A Community Daily Serving The Grand Valley**