



SIGN PERMIT

@

Community Development Department
250 North 5th Street
Grand Junction, CO 81501
(970) 244-1430

Permit No. _____
Date Submitted 4-28-03
FEE \$ 5.00
Tax Schedule 2945-242-12-030
Zone I-2

BUSINESS NAME Boise
STREET ADDRESS 615 S 15th st
PROPERTY OWNER Boise cascade corp
OWNER ADDRESS PO Box 50 Boise Idaho
83728

CONTRACTOR Western Neon Sign Co
LICENSE NO. 2030815
ADDRESS 3183 Hall Ave Grand jct
TELEPHONE NO. 523 4045

- 1. FLUSH WALL 2 Square Feet per Linear Foot of Building Facade
- 2. ROOF 2 Square Feet per Linear Foot of Building Facade
- 3. FREE-STANDING 2 Traffic Lanes - 0.75 Square Feet x Street Frontage
4 or more Traffic Lanes - 1.5 Square Feet x Street Frontage
- 4. PROJECTING 0.5 Square Feet per each Linear Foot of Building Facade

Existing Externally or Internally Illuminated - No Change in Electrical Service Non-Illuminated

(1 - 4) Area of Proposed Sign 32 Square Feet
(1,2,4) Building Facade 202 Linear Feet
(1 - 4) Street Frontage 202 Linear Feet
(2,3,4) Height to Top of Sign 8 Feet Clearance to Grade 4 Feet

Existing Signage/Type:	
<u>Banner</u>	Sq. Ft.
<u>FW metal sign</u>	<u>9</u> Sq. Ft.
	Sq. Ft.
Total Existing:	Sq. Ft.

● FOR OFFICE USE ONLY ●	
Signage Allowed on Parcel:	<u>S 15th st</u>
Building	<u>404</u> 300 Sq. Ft.
Free-Standing	<u>151</u> Sq. Ft.
Total Allowed:	<u>404</u> 300 Ft.

COMMENTS: Remove Existing F.S. Sign Replace with new
4'x8' double pole sign

NOTE: No sign may exceed 300 square feet. A separate sign permit is required for each sign. Attach a sketch of proposed and existing signage including types, dimensions, lettering, abutting streets, alleys, easements, property lines, and locations. Roof signs shall be manufactured such that no guy wires, braces or supports shall be visible.

Roy J. [Signature] 4/28/03 Ashli [Signature] 4/28/03
Applicant's Signature Date Community Development Approval Date

(White: Community Development) (Canary: Applicant) (Pink: Code Enforcement)



SIGN PERMIT

Community Development Department
 250 North 5th Street
 Grand Junction, CO 81501
 (970) 244-1430

Permit No. _____
 Date Submitted 4-28-03
 FEE \$ 25.00
 Tax Schedule 2945-242-12-030
 Zone I-2

BUSINESS NAME Boise
 STREET ADDRESS 615 S 15th st
 PROPERTY OWNER Boise cascade corp
 OWNER ADDRESS PO Box 50 Boise Idaho
83728

CONTRACTOR Western Neon Sign Co
 LICENSE NO. 2030815
 ADDRESS 3183 Hall Ave Grand Jet
 TELEPHONE NO. 523 4045

1. FLUSH WALL 2 Square Feet per Linear Foot of Building Facade
Face Change Only (2,3 & 4):
 2. ROOF 2 Square Feet per Linear Foot of Building Facade
 3. FREE-STANDING 2 Traffic Lanes - 0.75 Square Feet x Street Frontage
 4 or more Traffic Lanes - 1.5 Square Feet x Street Frontage
 4. PROJECTING 0.5 Square Feet per each Linear Foot of Building Facade

Existing Externally or Internally Illuminated - No Change in Electrical Service Non-Illuminated

- (1 - 4) Area of Proposed Sign 9 Square Feet
 (1,2,4) Building Facade 202 Linear Feet
 (1 - 4) Street Frontage 202 Linear Feet
 (2,3,4) Height to Top of Sign 8' Feet Clearance to Grade 5 Feet

Existing Signage/Type:	
<u>F.S. sign</u>	<u>32</u> Sq. Ft.
<u>Banner 4'x8'</u>	<u>32</u> Sq. Ft.
	Sq. Ft.
Total Existing:	<u>64</u> Sq. Ft.

● FOR OFFICE USE ONLY ●	
Signage Allowed on Parcel:	<u>S 15th St</u>
Building	<u>404</u> 300 Sq. Ft.
Free-Standing	<u>151</u> Sq. Ft.
Total Allowed:	<u>404</u> 300 Sq. Ft.

COMMENTS: _____

NOTE: No sign may exceed 300 square feet. A separate sign permit is required for each sign. Attach a sketch of proposed and existing signage including types, dimensions, lettering, abutting streets, alleys, easements, property lines, and locations. Roof signs shall be manufactured such that no guy wires, braces or supports shall be visible.

Ray McMane 4/28/03 Misha Aragon 4/28/03
 Applicant's Signature Date Community Development Approval Date

(White: Community Development) (Canary: Applicant) (Pink: Code Enforcement)

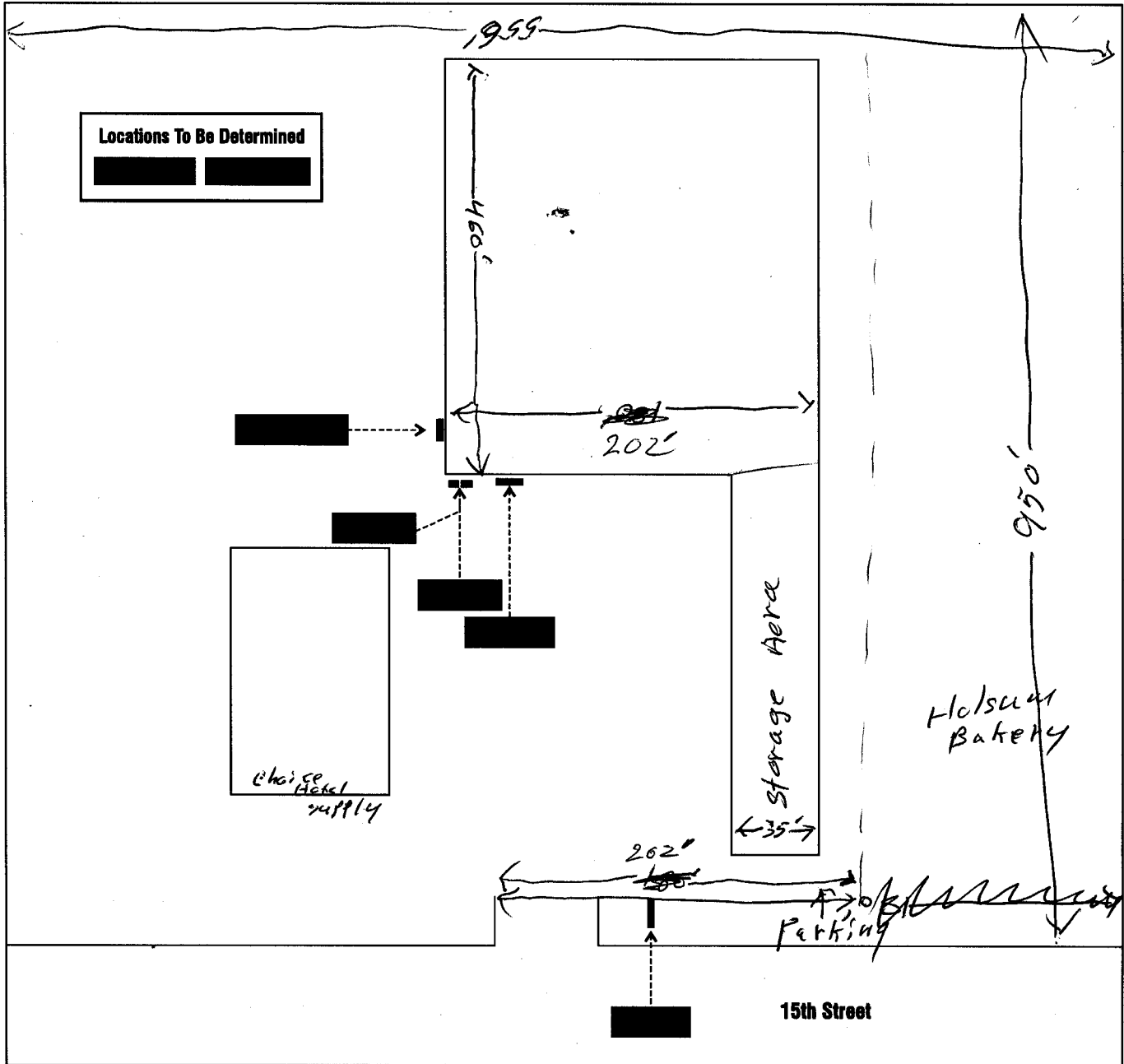

EXTERIOR SITE PLAN

BOISESM

Location HBC0026 - Boise Building Solutions, Distribution

615 South 15th Street
Grand Junction, Colorado
E2000197



Heath Sign Company • Signs Nationwide

04/10/03 - MH
E2000197R1

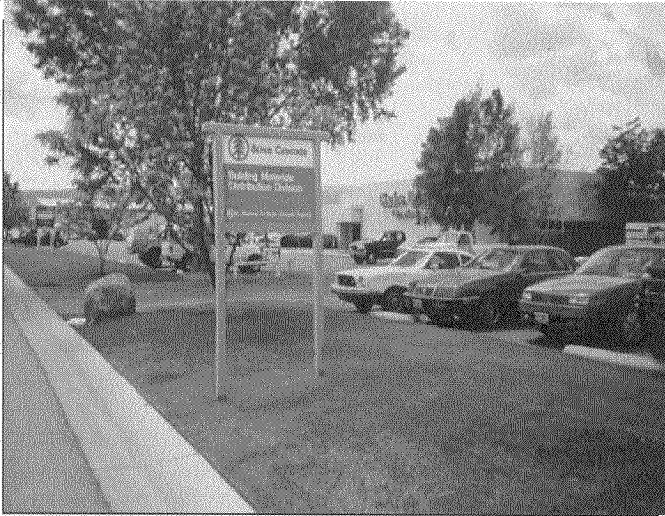

Existing - Remove existing structure

Proposed Signage

B-32-EFS-DF

*P-1

STANDARD BOISE COLORS

BOISE GREEN:

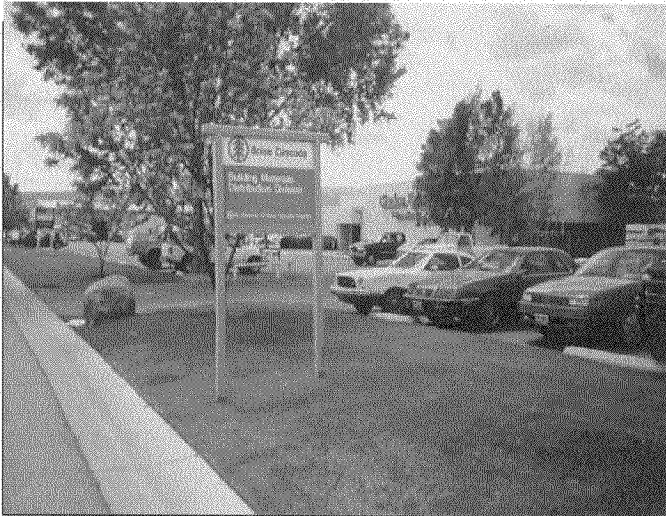

Existing - Remove existing structure

Proposed Signage

B-32-EFS-DF

*P-1

STANDARD BOISE COLORS	
	BOISE GREEN: PAINT - #MS-342 GREEN VINYL - #66 DARK GREEN
	BOISE ORANGE: PAINT - #MS-144 ORANGE VINYL - #64 LIGHT ORANGE
	BOISE WHITE: PAINT - WHITE VINYL - #10 WHITE

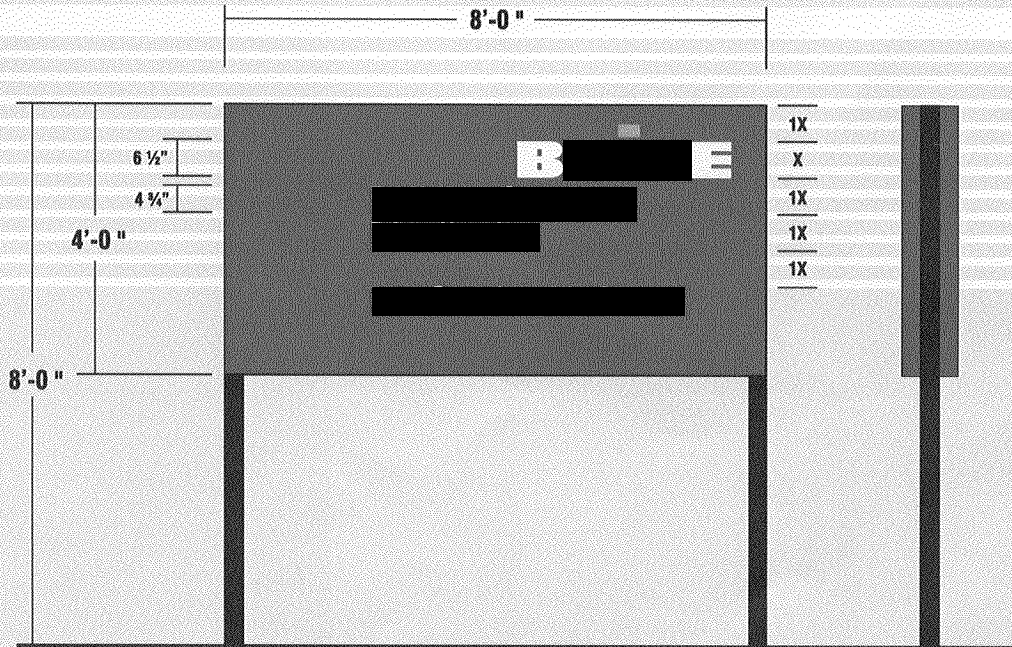

Scale: 3/8" = 1'-0"

B-32-EFS 32 S.F. (4' x 8'@8' O.A.H.)
Install New Standard D/F Sign Structure.

*P-1

BOISESM

Location HBC0026 - Boise Building Solutions, Distribution

615 South 15th Street
Grand Junction, Colorado
E2000197



Heath Sign Company • Signs Nationwide

04/10/03 - MH
E2000197R1

E-2

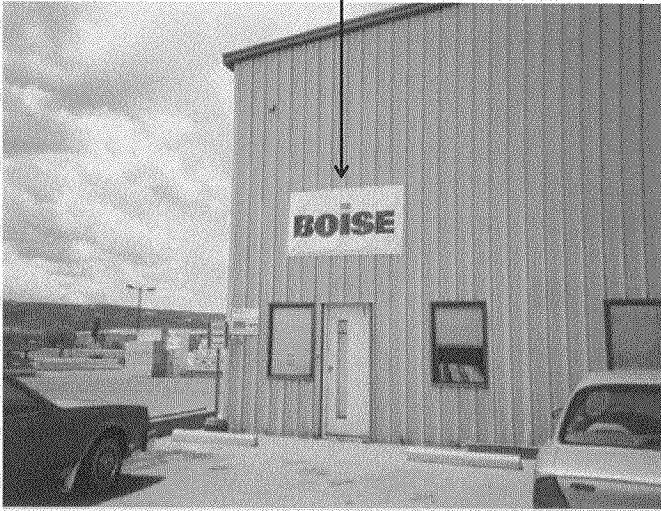

Existing - No change to existing banner

***E-2**

BOISESM

Location HBC0026 - Boise Building Solutions, Distribution

615 South 15th Street
Grand Junction, Colorado
E2000197



Heath Sign Company • Signs Nationwide

04/10/03 - MH
E2000197R1

E-3

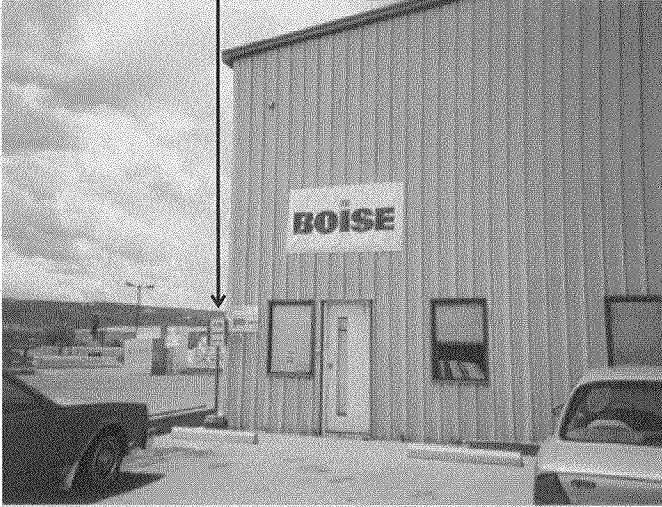

Existing - No change to existing sign

***E-3**

BOISESM

Location HBC0026 - Boise Building Solutions, Distribution

615 South 15th Street
Grand Junction, Colorado
E2000197



Heath Sign Company • Signs Nationwide

04/10/03 - MH
E2000197R1

E-4

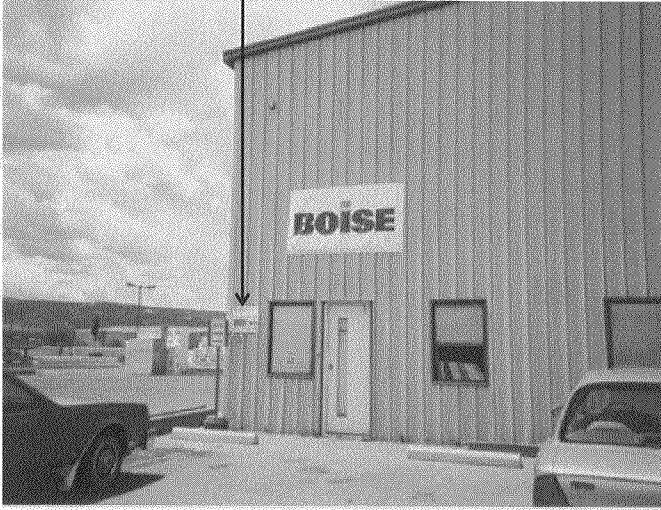

Existing - No change to existing sign

***E-4**



Existing

Proposed Signage

Custom Flat Panel Wall Sign

*P-5

STANDARD BOISE COLORS

BOISE GREEN:
PAINT - PMS 342 GREEN
VINYL - #98 DARK GREEN

BOISE ORANGE:
PAINT - PMS 114 ORANGE
VINYL - #64 LIGHT ORANGE

BOISE WHITE:
PAINT - WHITE
VINYL - #10 WHITE

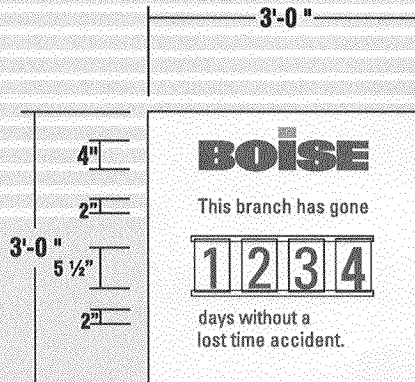

■ Custom Safety Days Wall Sign 9 S.F. (36" x 36")

Install new custom layout wall sign.

Sign utilizes zip change track & letters.

*P-5



Location HBC0026 - Boise Building Solutions, Distribution

615 South 15th Street
Grand Junction, Colorado
E2000197



Heath Sign Company • Signs Nationwide

04/10/03 - MH
E2000197R1

**INSTALL LOCATION PHOTOS UNAVAILABLE.
EXACT INSTALL LOCATIONS ARE T.B.D. BY BOISE.
BOISE ARE TO INSTALL SIGNS.**

STANDARD BOISE COLORS	
	BOISE GREEN: PAINT - #MS-348 BREEN VINYL - #54 DARK GREEN
	BOISE ORANGE: PAINT - #MS-744 ORANGE VINYL - #54 LIGHT ORANGE
	BOISE WHITE: PAINT - WHITE VINYL - #10 WHITE

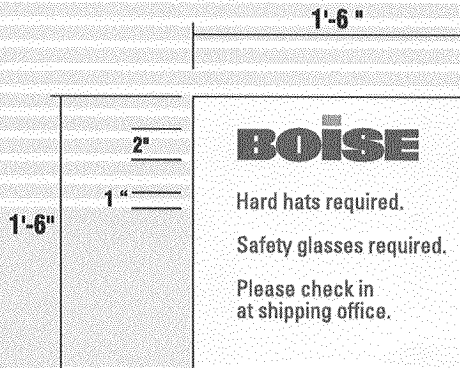

Scale: 1"=1'-0"

**■ B-18-EIWS-F(D) 2.25 S.F. (18" x 18")
(3) Three signs required.
Boise To Install Signs.**

- *P-6
- *P-7
- *P-8

BOISESM

Location HBC0026 - Boise Building Solutions, Distribution

615 South 15th Street
Grand Junction, Colorado
E2000197



Heath Sign Company • Signs Nationwide

04/10/03 - MH
E2000197R1

**INSTALL LOCATION PHOTOS UNAVAILABLE.
EXACT INSTALL LOCATION IS T.B.D. BY BOISE.
BOISE ARE TO INSTALL SIGN.**

STANDARD BOISE COLORS	
	BOISE GREEN: PAINT - #185-342 GREEN VINYL - #55 DARK GREEN
	BOISE ORANGE: PAINT - #100-744 ORANGE VINYL - #54 LIGHT ORANGE
	BOISE WHITE: PAINT - WHITE VINYL - #10 WHITE

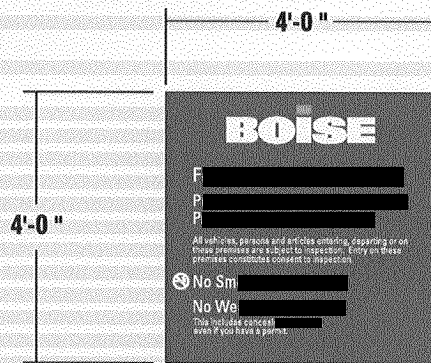

Scale: 3/8" = 1'-0"

B-48-EDWS-W 16 S.F. (48" X 48")
Exact install location to be determined by Boise.
Boise to install sign.

*P-9