



SIGN PERMIT

(A)

Community Development Department
250 North 5th Street
Grand Junction, CO 81501
(970) 244-1430

Permit No. _____
Date Submitted 2-10-03
FEE \$ 25.00
Tax Schedule 2945-111-20-007
Zone B-1

ⓐ

BUSINESS NAME Western Rockies Optical CONTRACTOR Southern Signs
STREET ADDRESS 1000 Wellington Ave. LICENSE NO. 2030719
PROPERTY OWNER Western Rockies Investment GRP. ADDRESS 2223 H. Rd
OWNER ADDRESS _____ TELEPHONE NO. 243-1383

- 1. FLUSH WALL 2 Square Feet per Linear Foot of Building Facade
 - Face Change Only (2,3 & 4):**
 - 2. ROOF 2 Square Feet per Linear Foot of Building Facade
 - 3. FREE-STANDING 2 Traffic Lanes - 0.75 Square Feet x Street Frontage
4 or more Traffic Lanes - 1.5 Square Feet x Street Frontage
 - 4. PROJECTING 0.5 Square Feet per each Linear Foot of Building Facade
- Existing Externally or Internally Illuminated - No Change in Electrical Service Non-Illuminated

(1 - 4) Area of Proposed Sign 6 Square Feet
(1,2,4) Building Facade 160 Linear Feet Wellington
(1 - 4) Street Frontage 300 Linear Feet
(2,3,4) Height to Top of Sign _____ Feet Clearance to Grade _____ Feet

Existing Signage/Type:	
<u>Individual Flush Mt Letters</u>	<u>160.75</u> Sq. Ft.
<u>Free-standing</u>	<u>24</u> Sq. Ft.
	Sq. Ft.
Total Existing:	<u>180.75</u> Sq. Ft.

● FOR OFFICE USE ONLY ●	
Signage Allowed on Parcel: <u>Wellington</u>	
Building	<u>300</u> <u>300</u> Sq. Ft.
Free-Standing	<u>225</u> Sq. Ft.
Total Allowed:	<u>300</u> Sq. Ft.

COMMENTS: _____

NOTE: No sign may exceed 300 square feet. A separate sign permit is required for each sign. Attach a sketch of proposed and existing signage including types, dimensions, lettering, abutting streets, alleys, easements, property lines, and locations. Roof signs shall be manufactured such that no guy wires, braces or supports shall be visible.

Sandra McElroy 2/10/03 Ashu Pragon 2/11/03
Applicant's Signature Date Community Development Approval Date

(White: Community Development) (Canary: Applicant) (Pink: Code Enforcement)

(B)



SIGN PERMIT

Community Development Department
250 North 5th Street
Grand Junction, CO 81501
(970) 244-1430

Permit No. _____
Date Submitted 2-10-03
FEE \$ 5.00
Tax Schedule 2945-111-20-007
Zone B-1

BUSINESS NAME Western Rockies Optical CONTRACTOR Somdough Signs
STREET ADDRESS 1000 Wellington Ave. LICENSE NO. 2030719
PROPERTY OWNER Western Rockies Investment Corp. ADDRESS 2223 HRd
OWNER ADDRESS _____ TELEPHONE NO. 243-1383

- 1. FLUSH WALL 2 Square Feet per Linear Foot of Building Facade
 - Face Change Only (2,3 & 4):**
 - 2. ROOF 2 Square Feet per Linear Foot of Building Facade
 - 3. FREE-STANDING 2 Traffic Lanes - 0.75 Square Feet x Street Frontage
4 or more Traffic Lanes - 1.5 Square Feet x Street Frontage
 - 4. PROJECTING 0.5 Square Feet per each Linear Foot of Building Facade
- Existing Externally or Internally Illuminated - No Change in Electrical Service Non-Illuminated

(1 - 4) Area of Proposed Sign 6 Square Feet
(1,2,4) Building Facade 115 Linear Feet - Little Bookcliff Ave
(1 - 4) Street Frontage 395 Linear Feet
(2,3,4) Height to Top of Sign _____ Feet Clearance to Grade _____ Feet

Existing Signage/Type:	
<u>Individual flush mt. Letters</u>	<u>16.75</u> Sq. Ft.
<u>Freestanding</u>	<u>24</u> Sq. Ft.
	Sq. Ft.
Total Existing:	<u>40.75</u> Sq. Ft.

● FOR OFFICE USE ONLY ●	
Signage Allowed on Parcel: <u>LITTLE BOOKCLIFF</u>	
Building	<u>230</u> Sq. Ft.
Free-Standing	<u>296</u> Sq. Ft.
Total Allowed:	<u>296</u> Sq. Ft.

COMMENTS: _____

NOTE: No sign may exceed 300 square feet. A separate sign permit is required for each sign. Attach a sketch of proposed and existing signage including types, dimensions, lettering, abutting streets, alleys, easements, property lines, and locations. Roof signs shall be manufactured such that no guy wires, braces or supports shall be visible.

Sandra M. Helms 2/10/03 Wishu Aragon 2/11/03
Applicant's Signature Date Community Development Approval Date

(White: Community Development) (Canary: Applicant) (Pink: Code Enforcement)

1000 WELLINGTON AVE.

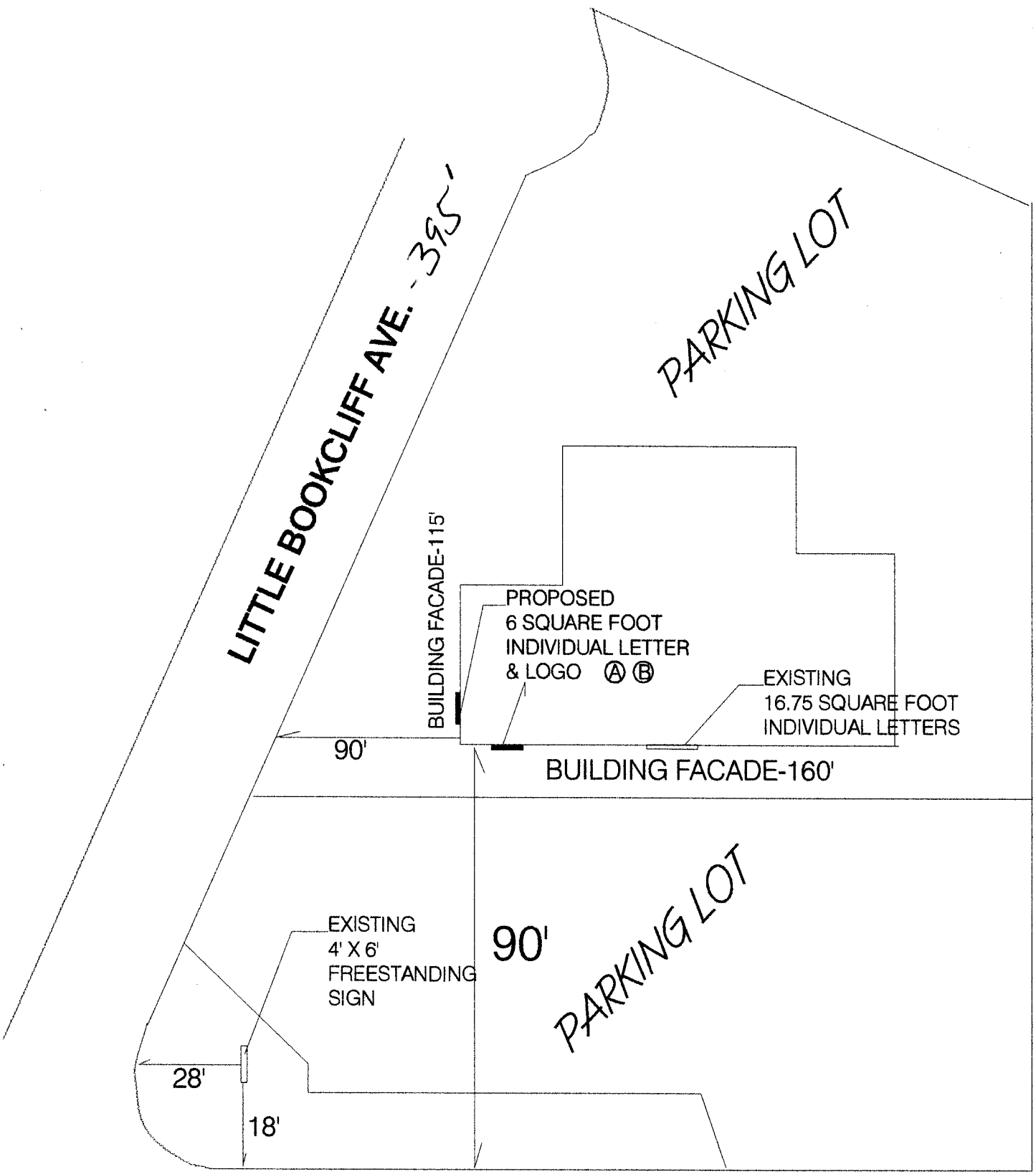

WELLINGTON AVE.- FRONTAGE 300'

7 1/2" x 39"

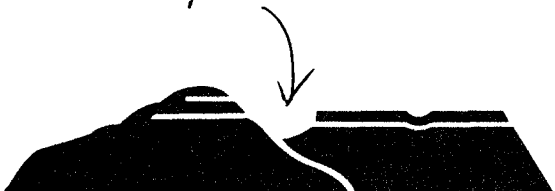

2 7

6" x 96"

Western Rockies Optical

4 7