



SIGN PERMIT

@

Community Development Department
250 North 5th Street
Grand Junction, CO 81501
(970) 244-1430

Permit No. _____
Date Submitted 5-27-03
FEE \$ 25.00
Tax Schedule 2915-124-24-018
Zone C-1

BUSINESS NAME M.C. TEACHERS CREDIT UNION CONTRACTOR ELDERADO SIGN
STREET ADDRESS 2302 NORTH AVE. LICENSE NO. 2030244
PROPERTY OWNER CREDIT UNION ADDRESS 3423 FRONT ST.
OWNER ADDRESS 2302 N. AVE. TELEPHONE NO. 523-6366

- 1. FLUSH WALL 2 Square Feet per Linear Foot of Building Facade
- Face Change Only (2,3 & 4):**
- 2. ROOF 2 Square Feet per Linear Foot of Building Facade
- * 3. FREE-STANDING 2 Traffic Lanes - 0.75 Square Feet x Street Frontage
4 or more Traffic Lanes - 1.5 Square Feet x Street Frontage
- 4. PROJECTING 0.5 Square Feet per each Linear Foot of Building Facade

Existing Externally or Internally Illuminated - No Change in Electrical Service Non-Illuminated

(1 - 4) Area of Proposed Sign 6 Square Feet
(1,2,4) Building Facade 125 Linear Feet
(1 - 4) Street Frontage 265 Linear Feet
(2,3,4) Height to Top of Sign 18' Feet Clearance to Grade 8' Feet

Existing Signage/Type:	
<u>FREESTANDING</u>	<u>56 1/2</u> Sq. Ft.
	Sq. Ft.
	Sq. Ft.
Total Existing:	Sq. Ft.

● FOR OFFICE USE ONLY ●	
Signage Allowed on Parcel:	<u>North AVE</u>
Building	<u>250</u> Sq. Ft.
Free-Standing	<u>397.5</u> Sq. Ft.
Total Allowed:	<u>300</u> Sq. Ft.

COMMENTS: * ADDING TIME & TEMP LED SIGN TO EXISTING FREESTANDING SIGN (6 ft)

NOTE: No sign may exceed 300 square feet. A separate sign permit is required for each sign. Attach a sketch of proposed and existing signage including types, dimensions, lettering, abutting streets, alleys, easements, property lines, and locations. Roof signs shall be manufactured such that no guy wires, braces or supports shall be visible.

[Signature] 5-27-03 [Signature] 5/27/03
Applicant's Signature Date Community Development Approval Date

(White: Community Development)

(Canary: Applicant)

(Pink: Code Enforcement)

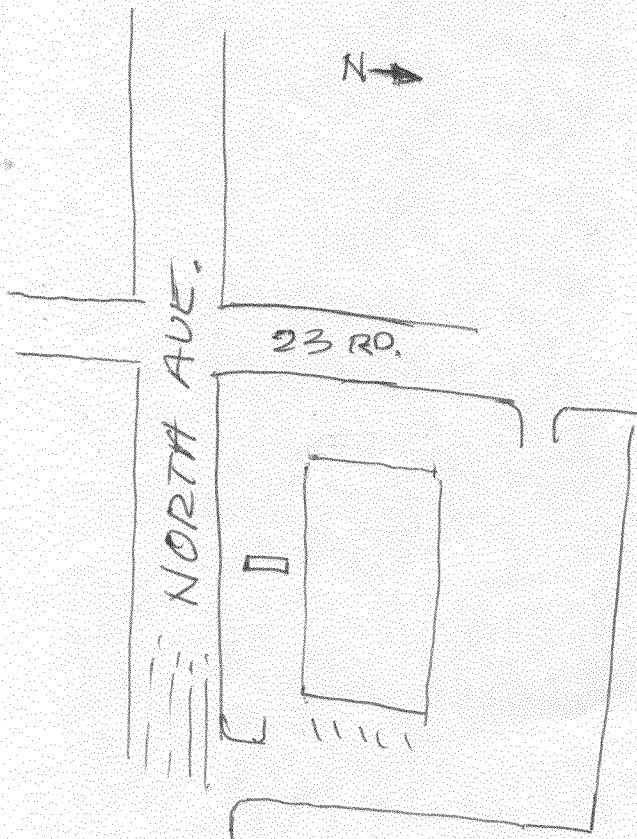

PROPOSED SIGN
 18" X 48" (6#)
 LED, TIME & TEMP

