



# SIGN PERMIT

(P) (A)

Community Development Department  
250 North 5th Street  
Grand Junction, CO 81501  
(970) 244-1430

Permit No. \_\_\_\_\_  
Date Submitted 8/31/04  
FEE \$ 25.00  
Tax Schedule 2945-143-26-003  
Zone B-2

BUSINESS NAME The Horse In Sport CONTRACTOR Bud's Signs  
STREET ADDRESS 215 Colorado LICENSE NO. 2040162  
PROPERTY OWNER Kay Hayashi ADDRESS 1055 ute  
OWNER ADDRESS \_\_\_\_\_ TELEPHONE NO. 245-7700

- 1. FLUSH WALL 2 Square Feet per Linear Foot of Building Facade
- Face Change Only (2,3 & 4):**
- 2. ROOF 2 Square Feet per Linear Foot of Building Facade
- 3. FREE-STANDING 2 Traffic Lanes - 0.75 Square Feet x Street Frontage  
4 or more Traffic Lanes - 1.5 Square Feet x Street Frontage
- 4. PROJECTING 0.5 Square Feet per each Linear Foot of Building Facade

Existing Externally or Internally Illuminated - No Change in Electrical Service  Non-Illuminated

(1 - 4) Area of Proposed Sign 16 Square Feet  
(1,2,4) Building Facade 25 Linear Feet  
(1 - 4) Street Frontage 150.25 Linear Feet  
(2,3,4) Height to Top of Sign 12 Feet Clearance to Grade 10 Feet

Existing Signage/Type:	
	0 Sq. Ft.
	Sq. Ft.
	Sq. Ft.
Total Existing:	Sq. Ft.

● FOR OFFICE USE ONLY ●	
Signage Allowed on Parcel:	<u>Colorado</u>
Building	<u>50</u> Sq. Ft.
Free-Standing	<u>18.75</u> Sq. Ft.
Total Allowed:	<u>50</u> Sq. Ft.

COMMENTS: \_\_\_\_\_

**NOTE:** No sign may exceed 300 square feet. A separate sign permit is required for each sign. Attach a sketch of proposed and existing signage including types, dimensions, lettering, abutting streets, alleys, easements, property lines, and locations. Roof signs shall be manufactured such that no guy wires, braces or supports shall be visible.

Eric Bennett 8-31-04 C. Faye Hall 9/1/04  
Applicant's Signature Date Community Development Approval Date

(White: Community Development) (Canary: Applicant) (Pink: Code Enforcement)



# SIGN PERMIT

(B)

Community Development Department  
250 North 5th Street  
Grand Junction, CO 81501  
(970) 244-1430

Permit No. \_\_\_\_\_  
Date Submitted 8/31/04  
FEE \$ 500  
Tax Schedule 2945-143-26-003  
Zone B-2

BUSINESS NAME The Horse and Sport  
STREET ADDRESS 215 Colorado  
PROPERTY OWNER Kay Hayashi  
OWNER ADDRESS \_\_\_\_\_

CONTRACTOR Buds Signs  
LICENSE NO. 2040162  
ADDRESS 1055 ute  
TELEPHONE NO. 245-7700

- 1. FLUSH WALL 2 Square Feet per Linear Foot of Building Facade
- Face Change Only (2,3 & 4):
- 2. ROOF 2 Square Feet per Linear Foot of Building Facade
- 3. FREE-STANDING 2 Traffic Lanes - 0.75 Square Feet x Street Frontage  
4 or more Traffic Lanes - 1.5 Square Feet x Street Frontage
- 4. PROJECTING 0.5 Square Feet per each Linear Foot of Building Facade

Existing Externally or Internally Illuminated - No Change in Electrical Service  Non-Illuminated

(1 - 4) Area of Proposed Sign 16 Square Feet  
(1,2,4) Building Facade 25 Linear Feet  
(1 - 4) Street Frontage 25750 Linear Feet  
(2,3,4) Height to Top of Sign 12 Feet Clearance to Grade 10 Feet

Existing Signage/Type:	
<u>Flush Wall</u>	<u>16</u> Sq. Ft.
	Sq. Ft.
	Sq. Ft.
Total Existing:	<u>16</u> Sq. Ft.

● FOR OFFICE USE ONLY ●	
Signage Allowed on Parcel:	<u>Colorado</u>
Building	<u>50</u> Sq. Ft.
Free-Standing	<u>18.75</u> Sq. Ft.
Total Allowed:	<u>50</u> Sq. Ft.

COMMENTS: \_\_\_\_\_

NOTE: No sign may exceed 300 square feet. A separate sign permit is required for each sign. Attach a sketch of proposed and existing signage including types, dimensions, lettering, abutting streets, alleys, easements, property lines, and locations. Roof signs shall be manufactured such that no guy wires, braces or supports shall be visible.

Eric Bernick 8-31-04 C. J. Hays Hall 9/1/04  
Applicant's Signature Date Community Development Approval Date

(White: Community Development) (Canary: Applicant) (Pink: Code Enforcement)

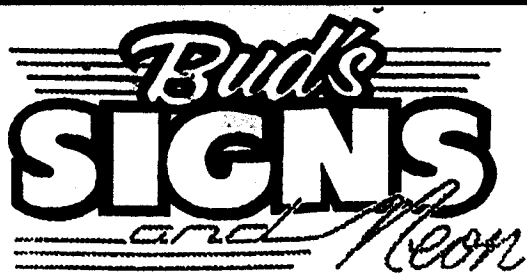

We Do Signs RIGHT!

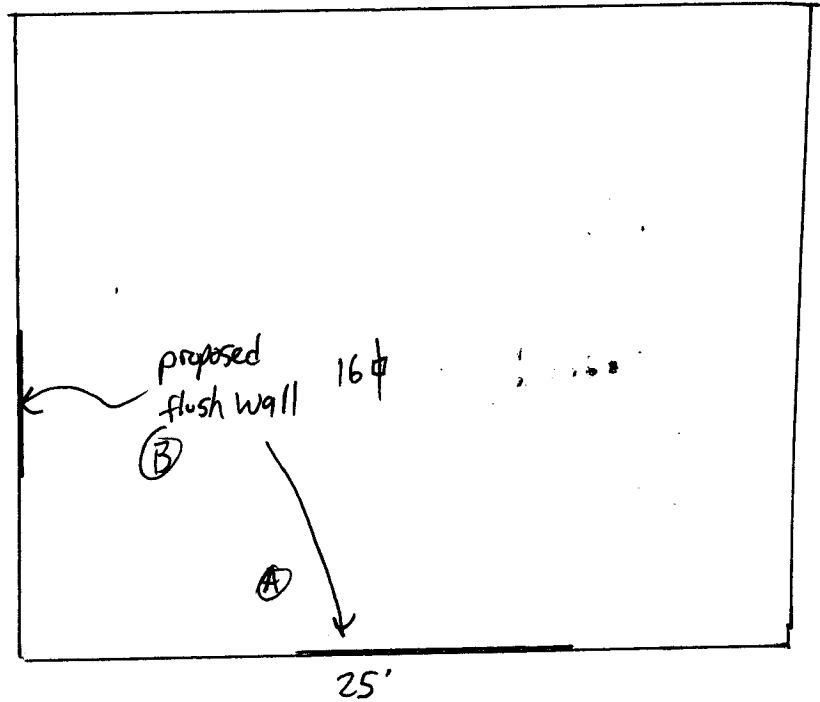

colorado

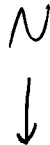

The Horse  
in Sport

2x8'

(A) + (B)

\*