



# SIGN PERMIT

@

Community Development Department  
250 North 5th Street  
Grand Junction, CO 81501  
(970) 244-1430

Permit No. \_\_\_\_\_  
Date Submitted 5-7-04  
FEE \$ 25.00  
Tax Schedule 2945-143-26-004  
Zone B-2

BUSINESS NAME VELO Junction  
STREET ADDRESS 251 Colorado Ave  
PROPERTY OWNER Raso Properties  
OWNER ADDRESS P.O. Box 2328

CONTRACTOR Bud's Signs  
LICENSE NO. 2040102  
ADDRESS 1055 UTL AVE  
TELEPHONE NO. 245-7700

- 1. FLUSH WALL 2 Square Feet per Linear Foot of Building Facade
- Face Change Only (2,3 & 4):
- 2. ROOF 2 Square Feet per Linear Foot of Building Facade
- 3. FREE-STANDING 2 Traffic Lanes - 0.75 Square Feet x Street Frontage  
4 or more Traffic Lanes - 1.5 Square Feet x Street Frontage
- 4. PROJECTING 0.5 Square Feet per each Linear Foot of Building Facade

Existing Externally or Internally Illuminated - No Change in Electrical Service  Non-Illuminated

(1 - 4) Area of Proposed Sign 32 Square Feet  
(1,2,4) Building Facade 38 Linear Feet  
(1 - 4) Street Frontage 48 Linear Feet  
(2,3,4) Height to Top of Sign 10 Feet Clearance to Grade 12 Feet

Existing Signage/Type:	
	Sq. Ft.
	Sq. Ft.
	Sq. Ft.
Total Existing:	<u>0</u> Sq. Ft.

● FOR OFFICE USE ONLY ●		
Signage Allowed on Parcel: <u>Colorado Ave</u>		
Building	<u>70</u>	Sq. Ft.
Free-Standing	<u>30</u>	Sq. Ft.
Total Allowed:	<u>70</u>	Sq. Ft.

COMMENTS: Powder Coates Aluminum Cut-out with Vinyl text.  
Overall Dimensions 50" H x 122" L

NOTE: No sign may exceed 300 square feet. A separate sign permit is required for each sign. Attach a sketch of proposed and existing signage including types, dimensions, lettering, abutting streets, alleys, easements, property lines, and locations. Roof signs shall be manufactured such that no guy wires, braces or supports shall be visible.

Eric Bennett 5-10-04 Mike Mason 5/11/04  
Applicant's Signature Date Community Development Approval Date

(White: Community Development) (Canary: Applicant) (Pink: Code Enforcement)

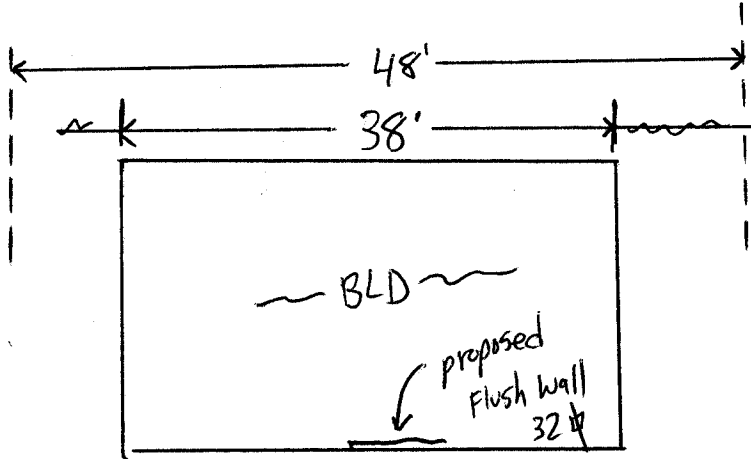

---

Colorado

N  
↓

