



SIGN PERMIT

@

Community Development Department
250 North 5th Street
Grand Junction, CO 81501
(970) 244-1430

Permit No. _____
Date Submitted 5-10-04
FEE \$ 25.00
Tax Schedule 2943-073-02-951
Zone PD

BUSINESS NAME CHURCH OF CHRIST
STREET ADDRESS 539 28 1/2 RD
PROPERTY OWNER _____
OWNER ADDRESS _____

CONTRACTOR ELDERADO SIGNS
LICENSE NO. 2040367
ADDRESS 3423 FRONT ST.
TELEPHONE NO. 523-7446

- 1. FLUSH WALL 2 Square Feet per Linear Foot of Building Facade
- Face Change Only (2,3 & 4):**
- 2. ROOF 2 Square Feet per Linear Foot of Building Facade
- 3. FREE-STANDING 2 Traffic Lanes - 0.75 Square Feet x Street Frontage
4 or more Traffic Lanes - 1.5 Square Feet x Street Frontage
- 4. PROJECTING 0.5 Square Feet per each Linear Foot of Building Facade

Existing Externally or Internally Illuminated - No Change in Electrical Service Non-Illuminated

(1 - 4) Area of Proposed Sign 291' 211' Square Feet
(1,2,4) Building Facade 75' Linear Feet
(1 - 4) Street Frontage 136' Linear Feet 119'
(2,3,4) Height to Top of Sign _____ Feet Clearance to Grade 10' Feet

Existing Signage/Type:	
<u>FREE STANDING</u>	<u>15</u> Sq. Ft.
	Sq. Ft.
	Sq. Ft.
Total Existing:	Sq. Ft.

● FOR OFFICE USE ONLY ●	
Signage Allowed on Parcel:	
Building	<u>150</u> Sq. Ft.
Free-Standing	<u>89.25</u> Sq. Ft.
Total Allowed:	<u>150</u> Sq. Ft.

COMMENTS: _____

NOTE: No sign may exceed 300 square feet. A separate sign permit is required for each sign. Attach a sketch of proposed and existing signage including types, dimensions, lettering, abutting streets, alleys, easements, property lines, and locations. Roof signs shall be manufactured such that no guy wires, braces or supports shall be visible.

[Signature] 5/10/04 Dayleen Henderson 5-10-04
Applicant's Signature Date Community Development Approval Date

(White: Community Development) (Canary: Applicant) (Pink: Code Enforcement)

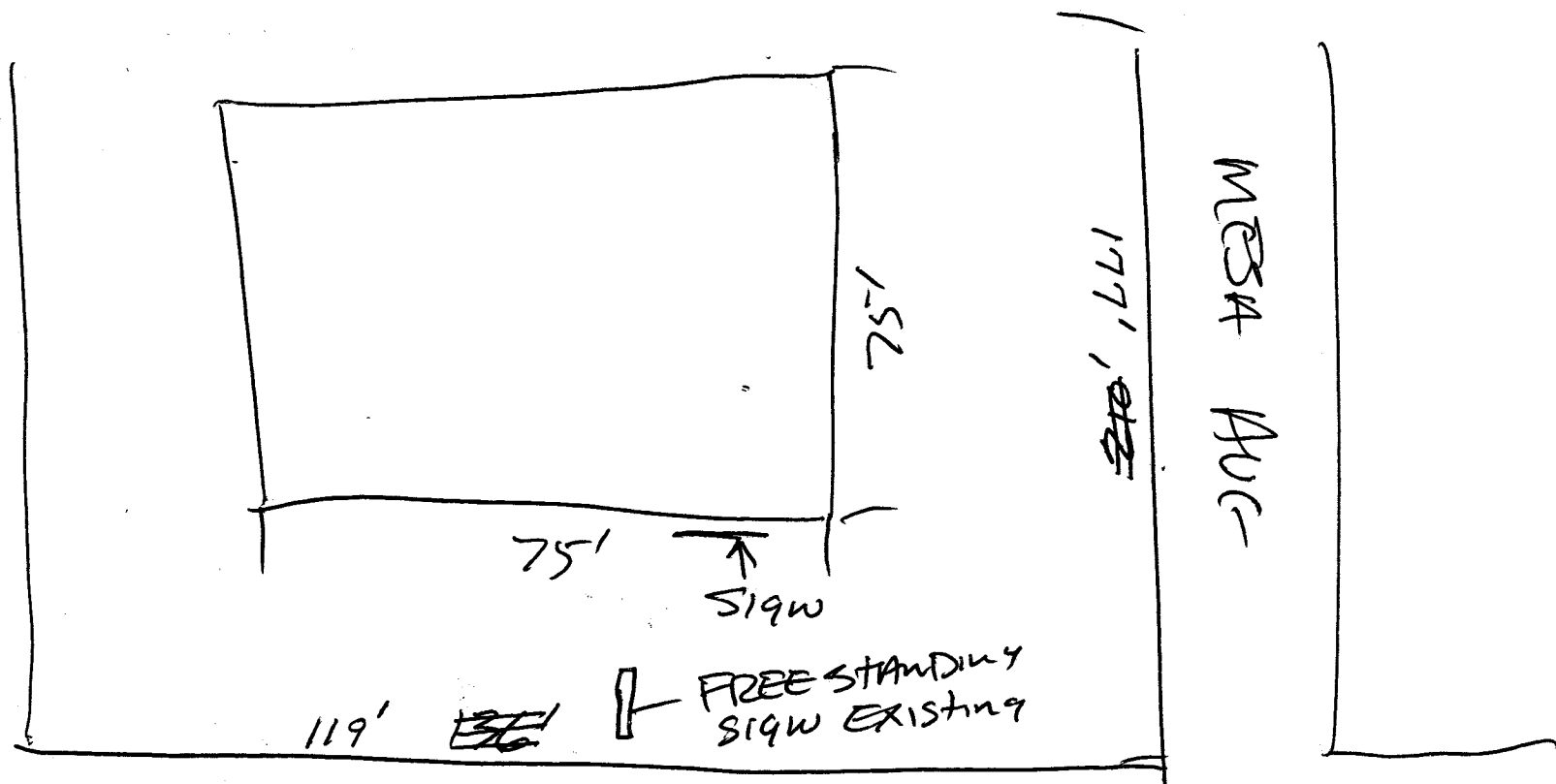

28 1/2 ROAD

3'x7' FACIA SIGN

CHURCH
OF
CHRIST