



# SIGN PERMIT

2

Community Development Department  
250 North 5th Street  
Grand Junction, CO 81501  
(970) 244-1430

Permit No. \_\_\_\_\_  
Date Submitted Nov 18, 2004  
FEE \$ 25.00  
Tax Schedule 2701-813-11-003  
Zone I-1

BUSINESS NAME DHL / Airborne CONTRACTOR Western neon sign co  
STREET ADDRESS 738 Scarlet Drive suite C LICENSE NO. 204 0561  
PROPERTY OWNER Aberle, Charles ADDRESS 3183 Hall Ave Grand Jet  
OWNER ADDRESS 14035 W 59th Pl Arvada Co, 80004-3722 TELEPHONE NO. 241-9661 (Home) 303 4045 (Bus)

- 1. FLUSH WALL 2 Square Feet per Linear Foot of Building Facade
- Face Change Only (2,3 & 4):
- 2. ROOF 2 Square Feet per Linear Foot of Building Facade
- 3. FREE-STANDING 2 Traffic Lanes - 0.75 Square Feet x Street Frontage  
4 or more Traffic Lanes - 1.5 Square Feet x Street Frontage
- 4. PROJECTING 0.5 Square Feet per each Linear Foot of Building Facade

Ray

Existing Externally or Internally Illuminated - No Change in Electrical Service  Non-Illuminated

(1 - 4) Area of Proposed Sign 12 Square Feet  
(1,2,4) Building Facade 168 Linear Feet - 95' Scarlet Longside of Bldg 168'  
(1 - 4) Street Frontage 175 Linear Feet Scarlet Dr.  
(2,3,4) Height to Top of Sign \_\_\_\_\_ Feet Clearance to Grade \_\_\_\_\_ Feet

#1  
#2

Existing Signage/Type:		
<u>Roof sign</u>	<u>60</u>	Sq. Ft.
<u>FW Radiant sign</u>	<u>16</u>	Sq. Ft.
		Sq. Ft.
Total Existing:	<u>76</u>	Sq. Ft.

● FOR OFFICE USE ONLY ●	
Signage Allowed on Parcel:	<u>Scarlet Dr</u>
Building	<u>190.00</u> Sq. Ft.
Free-Standing	<u>131.25</u> Sq. Ft.
Total Allowed:	<u>190.</u> Sq. Ft.

COMMENTS:

NOTE: No sign may exceed 300 square feet. A separate sign permit is required for each sign. Attach a sketch of proposed and existing signage including types, dimensions, lettering, abutting streets, alleys, easements, property lines, and locations. Roof signs shall be manufactured such that no guy wires, braces or supports shall be visible.

Ray McManis 11/18/04 Bobbi Paulson 11/18/04  
Applicant's Signature Date Community Development Approval Date

(White: Community Development) (Canary: Applicant) (Pink: Code Enforcement)

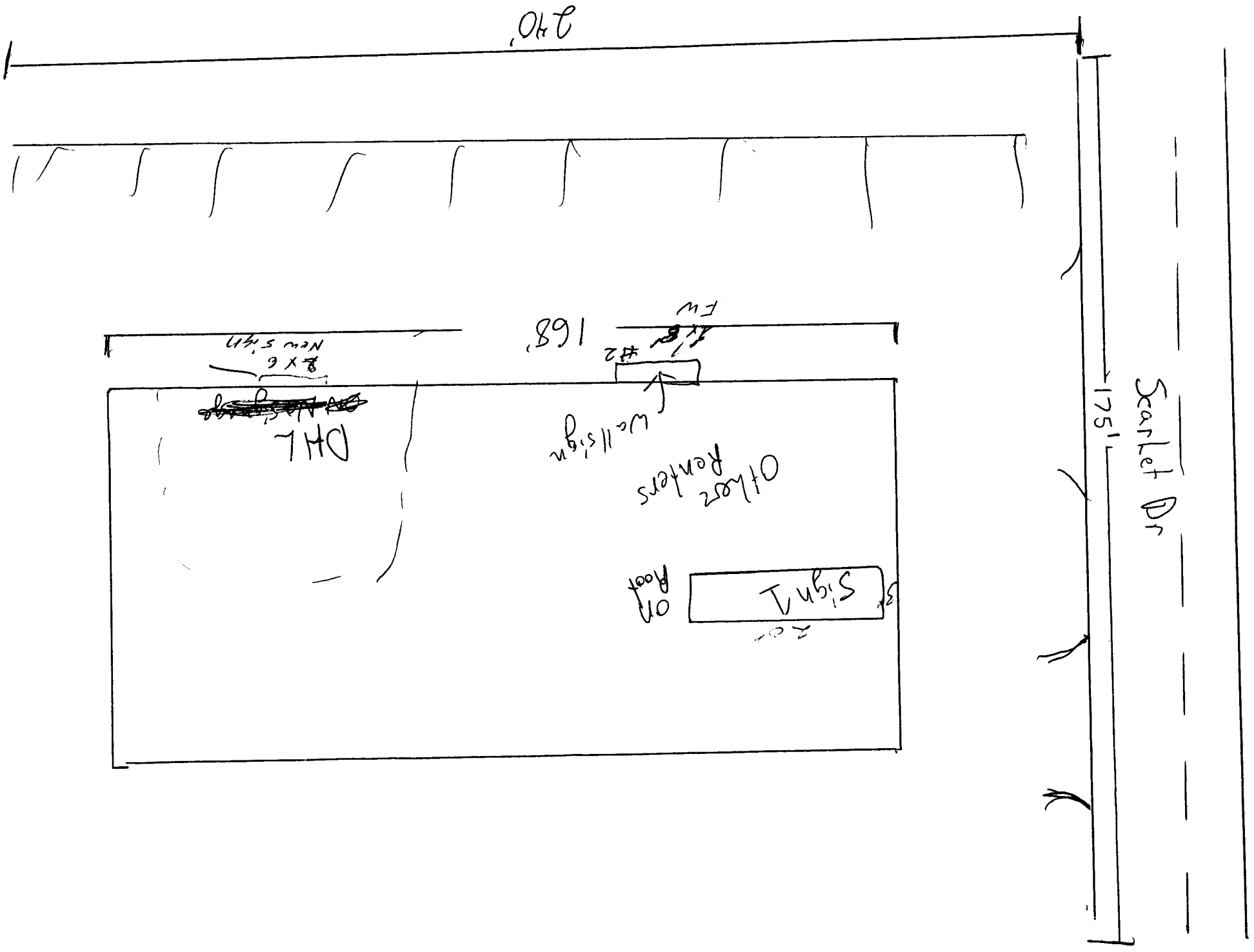

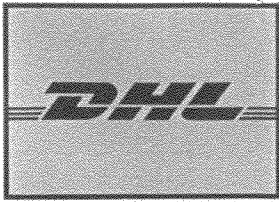

Design #  
C45166  
Sheet 1 of 1  
Client  
Address  
GRM  
GRAND JUNCTION, CO  
Account Rep. L. ANDERSON  
Designer C.RUST  
Date 10/26/04

*CR*

REMOVE AND JUNK EXISTING PLACECARD



EXISTING



PROPOSED

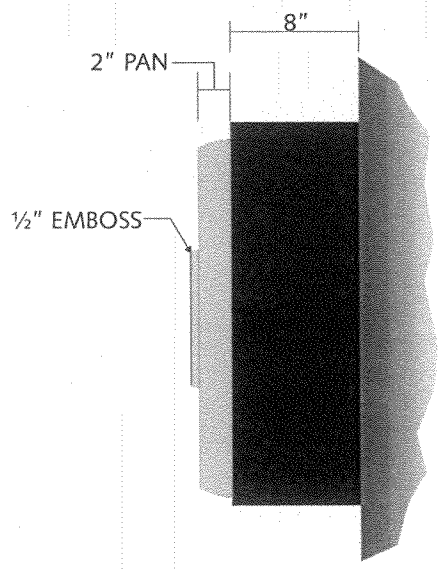
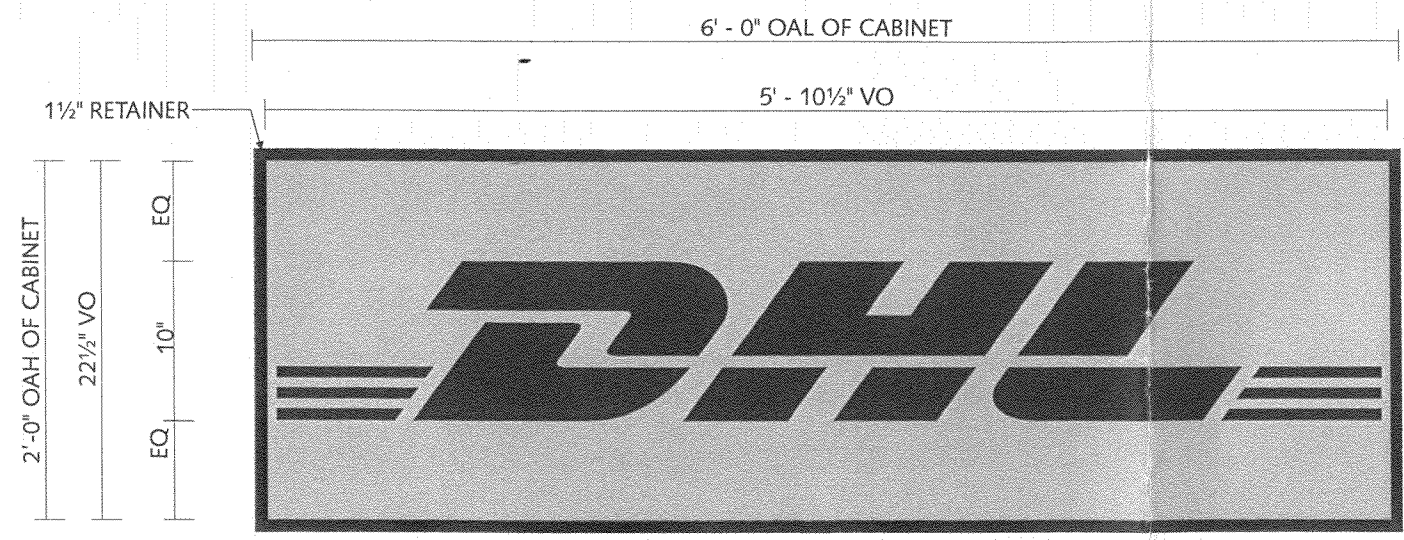

END VIEW (TYP.)

**A INTERNALLY ILLUMINATED S/F WALL SIGN W/PAN-FORMED & EMBOSSSED FACE**

SCALE: 1" = 1' - 0"

- MANUFACTURE AND INSTALL ONE INTERNALLY ILLUMINATED ALUMINUM WALL CABINET.
- CLEAR FORMED POLYCARBONATE FACE W/2ND SURFACE SCREEN PRINT W/ 3" FLANGE.
- FACE- PAN FORMED W/EMBOSSSED LOGO  
"DHL LOGO" - RED TO MATCH PMS 200  
BACKGROUND - YELLOW TO MATCH PMS 116
- CABINET AND RETAINERS TO BE PAINTED BLACK
- ILLUMINATION BY FLOURESCENT LAMPS (TYP.)

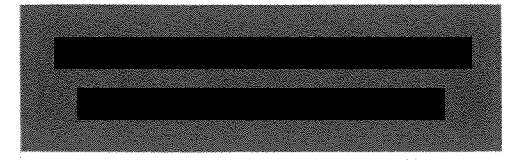

3201 Manor Way Dallas, TX 75235  
214-902-2000 Fax 214-902-2044  
12106 Yalliant San Antonio, TX 78216  
210-349-3804 Fax 210-349-8724  
2420 Vista Way Ste. 200H  
Oceanside, CA 92054  
760-967-7003 Fax 760-967-7033  
750 E. Hwy. 24 - Bldg. 2 Ste. 200  
Woodland Park, CO 80863  
719-687-2507 Fax 719-687-2506  
16740 Hedgcroft Ste. 400  
Houston, TX 78216  
281-931-9050 Fax 281-931-9011  
P.O. Box 43123 Louisville, KY 40253  
502-489-3660 Fax 502-254-3843