



SIGN PERMIT

①

Community Development Department
250 North 5th Street
Grand Junction, CO 81501
(970) 244-1430

Permit No. _____
Date Submitted 9-14-04
FEE \$ 25.00
Tax Schedule 2945-151-01-014
Zone C-1

BUSINESS NAME Mad Margaret's
STREET ADDRESS 807 N 1st
PROPERTY OWNER _____
OWNER ADDRESS _____

CONTRACTOR The Sign Gallery
LICENSE NO. 12041068
ADDRESS 1098 Independent A-109
TELEPHONE NO. 241-6400

- 1. FLUSH WALL 2 Square Feet per Linear Foot of Building Facade
- Face Change Only (2,3 & 4):
- 2. ROOF 2 Square Feet per Linear Foot of Building Facade
- 3. FREE-STANDING 2 Traffic Lanes - 0.75 Square Feet x Street Frontage
4 or more Traffic Lanes - 1.5 Square Feet x Street Frontage
- 4. PROJECTING 0.5 Square Feet per each Linear Foot of Building Facade

Existing Externally or Internally Illuminated - No Change in Electrical Service Non-Illuminated

(1 - 4) Area of Proposed Sign 37 Square Feet
(1,2,4) Building Facade 80 Linear Feet
(1 - 4) Street Frontage 80 Linear Feet
(2,3,4) Height to Top of Sign 16 Feet Clearance to Grade 14 Feet

Existing Signage/Type:	
	Sq. Ft.
	Sq. Ft.
	Sq. Ft.
Total Existing:	<u>0</u> Sq. Ft.

● FOR OFFICE USE ONLY ●		
Signage Allowed on Parcel:	<u>N 1st</u>	
Building	<u>160</u>	Sq. Ft.
Free-Standing	<u>120</u>	Sq. Ft.
Total Allowed:	<u>160</u>	Sq. Ft.

COMMENTS:

NOTE: No sign may exceed 300 square feet. A separate sign permit is required for each sign. Attach a sketch of proposed and existing signage including types, dimensions, lettering, abutting streets, alleys, easements, property lines, and locations. Roof signs shall be manufactured such that no guy wires, braces or supports shall be visible.

Larry L Bowler 9-13-04 Dayleen Henderson 9-14-04
Applicant's Signature Date Community Development Approval Date

(White: Community Development)

(Canary: Applicant)

(Pink: Code Enforcement)

807 N 1st

Sign to go above
Center Awning
Alum. covered plywood.

16'

Mad Margaret's

Mad Margaretia
807 N 1st

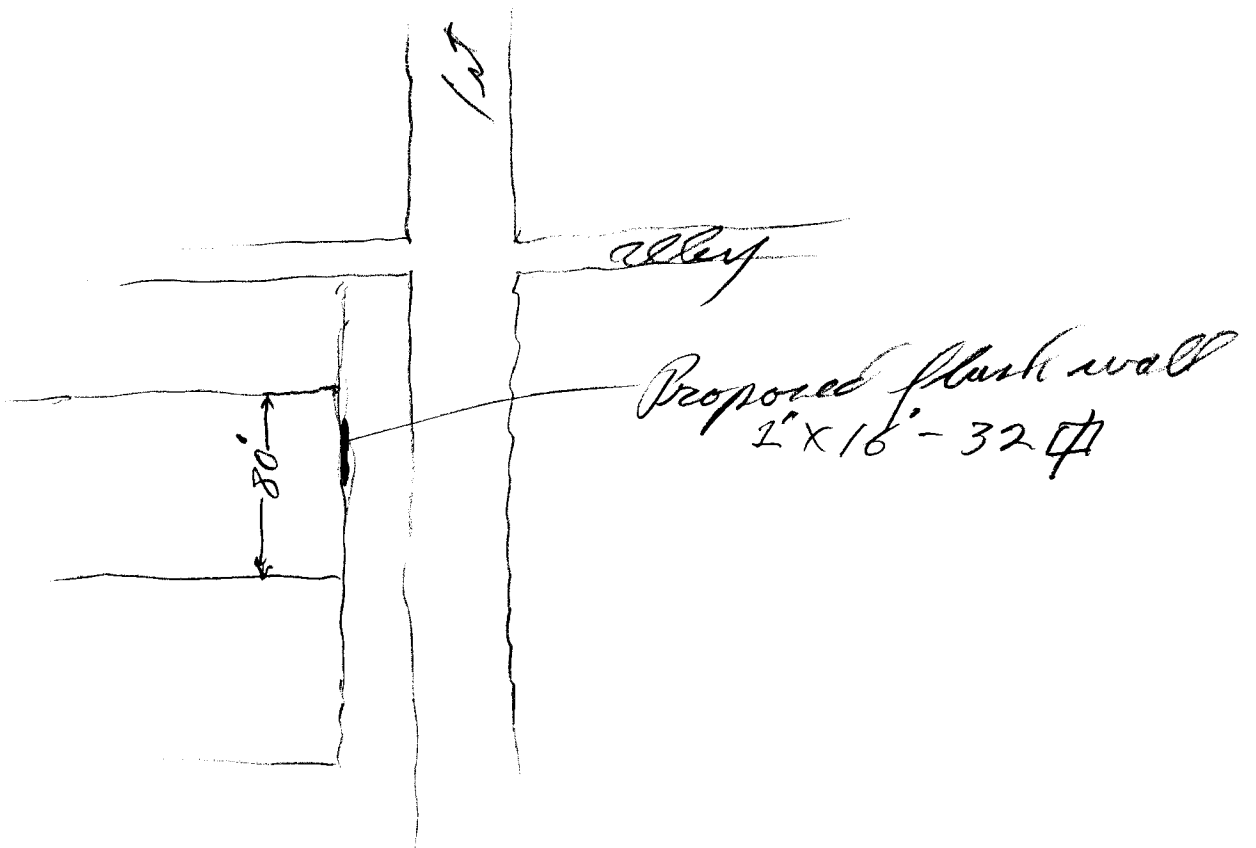

Proposed flash wall
2' x 16' - 32 #