



# SIGN PERMIT

ⓐ

Community Development Department  
250 North 5th Street  
Grand Junction, CO 81501  
(970) 244-1430

Permit No. \_\_\_\_\_  
Date Submitted 12/17/04  
FEE \$ 25.00  
Tax Schedule 2945-233-11-003  
Zone C-1

BUSINESS NAME Nexgen/MT. States Media Group CONTRACTOR Sourdough Signs  
STREET ADDRESS 1673 Hwy 50 South #B LICENSE NO. 2041015  
PROPERTY OWNER Sunburst Graphics & Printing ADDRESS 2223 H. Rd  
OWNER ADDRESS \_\_\_\_\_ TELEPHONE NO. 243-1383

- 1. FLUSH WALL 2 Square Feet per Linear Foot of Building Facade
- Face Change Only (2, 3 & 4):**
- 2. ROOF 2 Square Feet per Linear Foot of Building Facade
- 3. FREE-STANDING 2 Traffic Lanes - 0.75 Square Feet x Street Frontage  
4 or more Traffic Lanes - 1.5 Square Feet x Street Frontage
- 4. PROJECTING 0.5 Square Feet per each Linear Foot of Building Facade

Existing Externally or Internally Illuminated - No Change in Electrical Service  Non-Illuminated

(1 - 4) Area of Proposed Sign 10 11' x 30" x 48" Square Feet  
(1,2,4) Building Facade 80 Linear Feet - SANTA CLARA AVE.  
(1 - 4) Street Frontage 204 Linear Feet - " " "  
(2,3,4) Height to Top of Sign \_\_\_\_\_ Feet Clearance to Grade \_\_\_\_\_ Feet

Existing Signage/Type:		160
<u>Flush mt (A)</u>	<u>7</u> Sq. Ft.	
<u>Freestanding</u>	<u>45</u> Sq. Ft.	
	<u>Balance 108</u> Sq. Ft.	
Total Existing:		Sq. Ft.

● FOR OFFICE USE ONLY ●	
Signage Allowed on Parcel:	<u>Santa Clara Ave.</u>
Building	<u>160</u> Sq. Ft.
Free-Standing	<u>153</u> Sq. Ft.
Total Allowed:	<u>160</u> Sq. Ft.

COMMENTS: \_\_\_\_\_

**NOTE:** No sign may exceed 300 square feet. A separate sign permit is required for each sign. Attach a sketch of proposed and existing signage including types, dimensions, lettering, abutting streets, alleys, easements, property lines, and locations. Roof signs shall be manufactured such that no guy wires, braces or supports shall be visible.

Sandra M. Holloway  
Applicant's Signature \_\_\_\_\_ Date \_\_\_\_\_

Bobbie Paulson 12/17/04  
Community Development Approval \_\_\_\_\_ Date \_\_\_\_\_

(White: Community Development)

(Canary: Applicant)

(Pink: Code Enforcement)

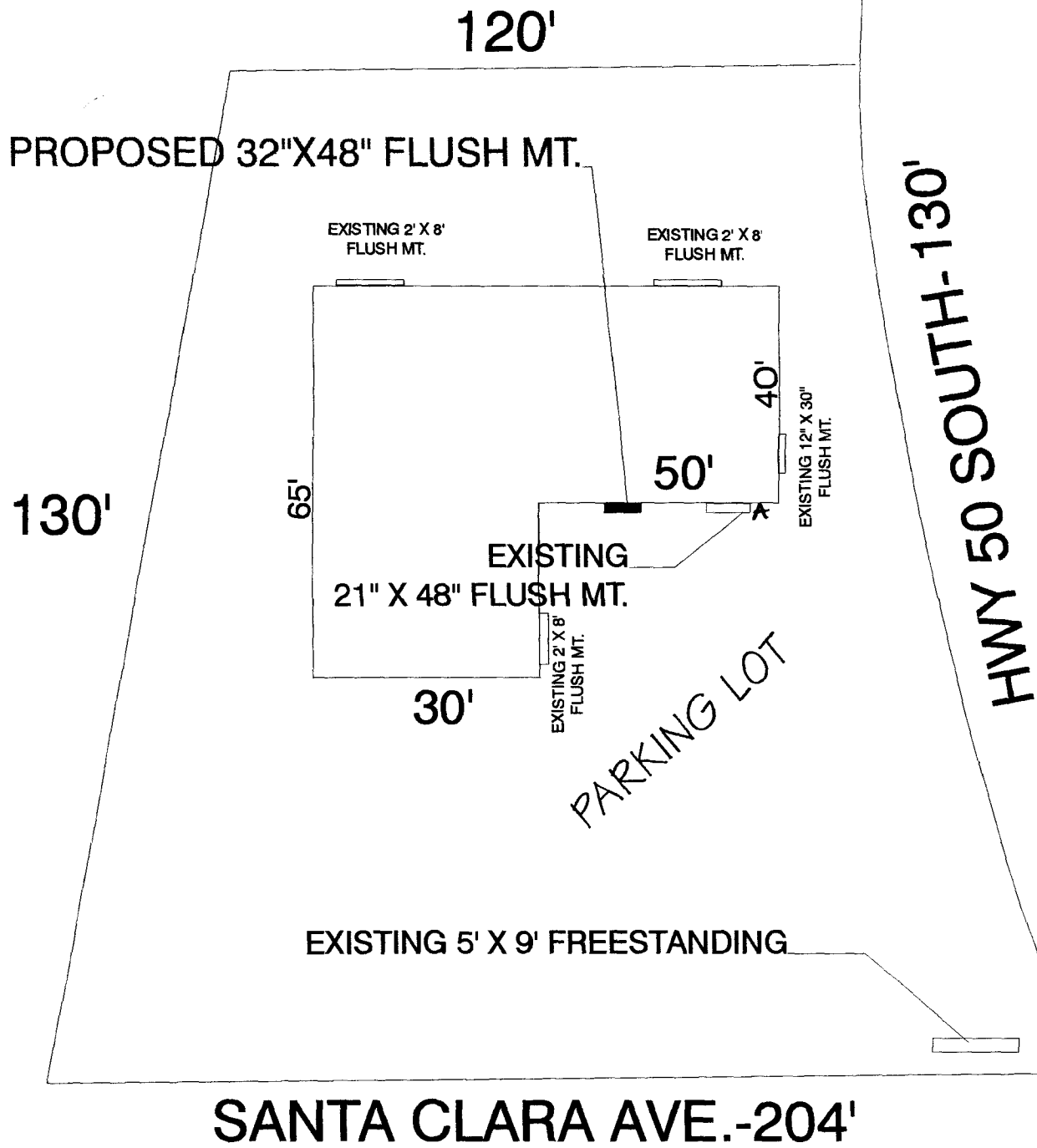

NEXGEN/MT. STATES MEDIA GROUP  
1673 HWY 50 SOUTH  
UNIT B

48"

silver

Red

32"

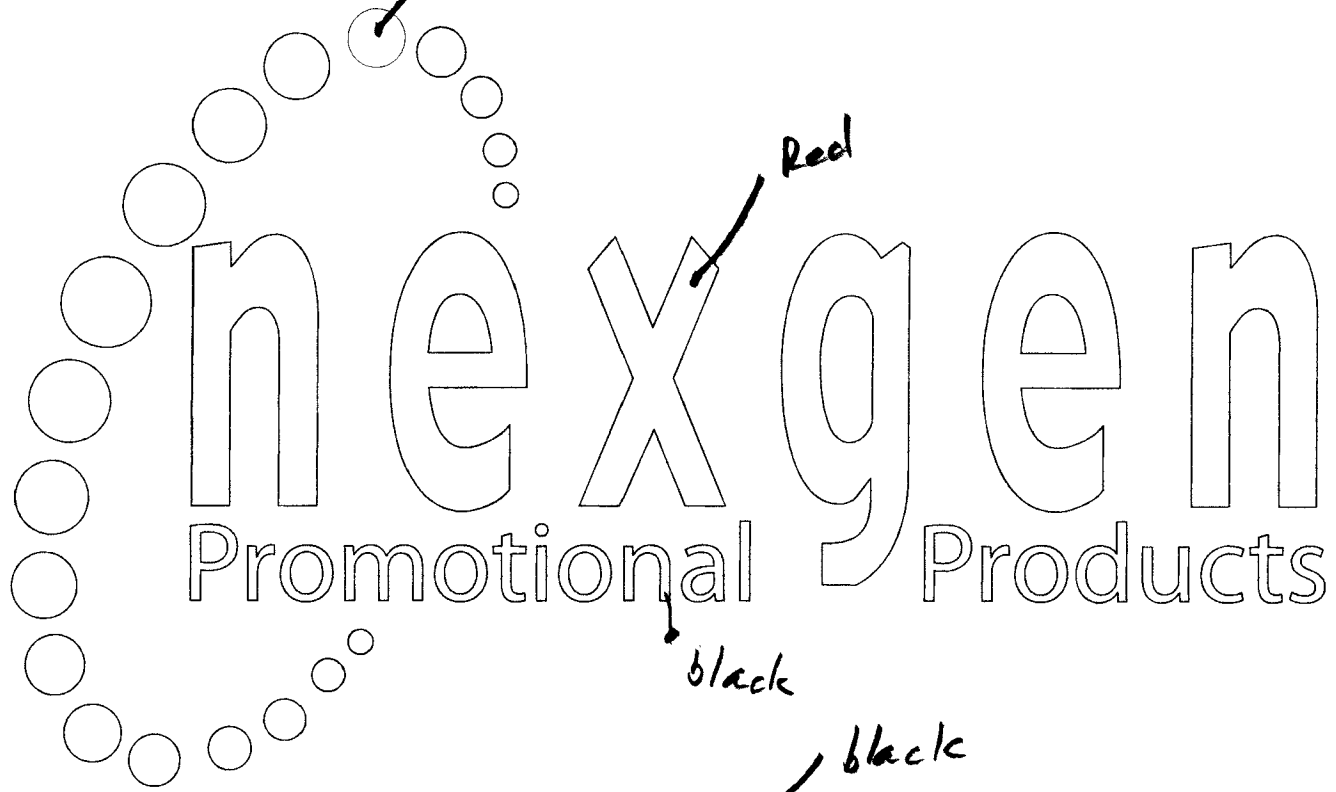

black

black

Mountain States Media Group

blue

32" x 48"

white

background