



# SIGN PERMIT

Community Development Department  
 250 North 5th Street  
 Grand Junction, CO 81501  
 (970) 244-1430

Permit No. \_\_\_\_\_  
 Date Submitted 8-20-04  
 FEE \$ 25.00  
 Tax Schedule 2945-033-12-004  
 Zone I-0

BUSINESS NAME Neighborhood Mortgage  
 STREET ADDRESS 2530 Forenight Circle  
 PROPERTY OWNER TCM Properties  
 OWNER ADDRESS \_\_\_\_\_

CONTRACTOR The Sign Gallery  
 LICENSE NO. 12041068  
 ADDRESS 1048 Independent A-109  
 TELEPHONE NO. 241-6400

- 1. FLUSH WALL 2 Square Feet per Linear Foot of Building Facade
- Face Change Only (2,3 & 4):
- 2. ROOF 2 Square Feet per Linear Foot of Building Facade
- 3. FREE-STANDING 2 Traffic Lanes - 0.75 Square Feet x Street Frontage  
4 or more Traffic Lanes - 1.5 Square Feet x Street Frontage
- 4. PROJECTING 0.5 Square Feet per each Linear Foot of Building Facade

Existing Externally or Internally Illuminated - No Change in Electrical Service  Non-Illuminated

(1 - 4) Area of Proposed Sign 17 Square Feet  
 (1,2,4) Building Facade 240 Linear Feet  
 (1 - 4) Street Frontage 202/175 Linear Feet  
 (2,3,4) Height to Top of Sign 10 Feet Clearance to Grade 8 Feet

Existing Signage/Type:	
<u>Flush wall</u>	<u>9</u> Sq. Ft.
	Sq. Ft.
	Sq. Ft.
Total Existing:	<u>9</u> Sq. Ft.

● FOR OFFICE USE ONLY ●		
Signage Allowed on Parcel:		
Building	<u>480</u>	Sq. Ft.
Free-Standing	<u>204</u>	Sq. Ft.
Total Allowed:	<u>480</u>	Sq. Ft.

COMMENTS: \_\_\_\_\_

**NOTE:** No sign may exceed 300 square feet. A separate sign permit is required for each sign. Attach a sketch of proposed and existing signage including types, dimensions, lettering, abutting streets, alleys, easements, property lines, and locations. Roof signs shall be manufactured such that no guy wires, braces or supports shall be visible.

Larry Z Bowler 8-20-04 W. Mike Magan 8/23/04  
 Applicant's Signature Date Community Development Approval Date

(White: Community Development) (Canary: Applicant) (Pink: Code Enforcement)

Neighborhood Mortgage  
8530 E Fairlight Circle

Proposed front  
walk - 24" x 100"  
17 ft

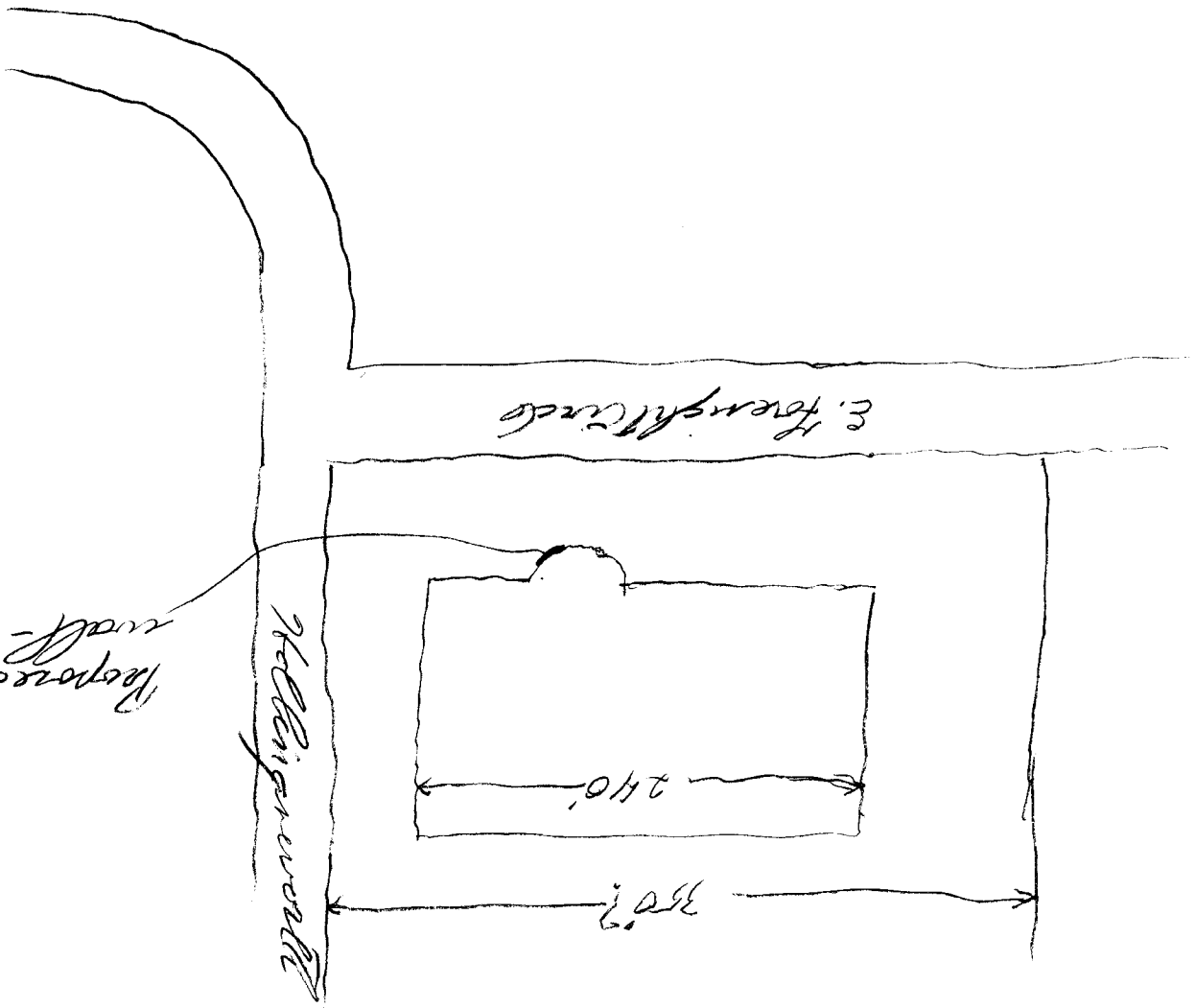

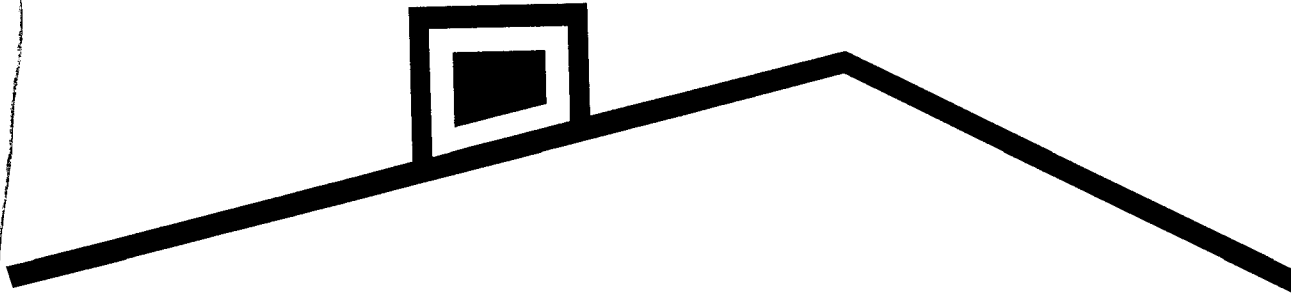

# NEIGHBORHOOD Mortgage

24"

100"

17¢