



Sign Permit

Community Development Department
250 North 5th Street
Grand Junction CO 81501
Phone: (970) 244-1430 FAX (970) 256-4031

Permit No.	_____
Date Submitted	12-7-05
Fee \$	25.00
Zone	G-1

TAX SCHEDULE	2945-133-17-014	CONTRACTOR	platinum sign
BUSINESS NAME	com cables	LICENSE NO.	2050601
STREET ADDRESS	213 S. 15 th ST	ADDRESS	2916 I-70 B
PROPERTY OWNER	Joseph J. Payne	TELEPHONE NO.	248-9677
OWNER ADDRESS	_____	CONTACT PERSON	Louis O'Connell

- 1. FLUSH WALL 2 Square Feet per Linear Foot of Building Façade
- Face change only on items 2, 3 & 4**
- 2. ROOF 2 Square Feet per Linear Foot of Building Façade
- 3. PROJECTING 0.5 Square Feet per each Linear Foot of Building Façade
- 4. FREE-STANDING 2 Traffic Lanes - 0.75 Square Feet x Street Frontage
4 or more Traffic Lanes - 1.5 Square Feet x Street Frontage

Existing Externally or Internally Illuminated - No Change in Electrical Service Non-Illuminated

(1-4) Area of Proposed Sign:	64	Square Feet	Building Façade Direction:	North South <u>East</u> West
(1-3) Building Façade:	113	Linear Feet	Name of Street:	S 15 th St
(4) Street Frontage:	125	Linear Feet	Clearance to Grade:	NA
(2-4) Height to Top of Sign:	_____	Feet		

EXISTING SIGNAGE/TYPE:	
Roof	32 Sq. Ft.
Roof	32 Sq. Ft.
_____	_____ Sq. Ft.
_____	_____ Sq. Ft.
Total Existing:	64 Sq. Ft.

FOR OFFICE USE ONLY	
Signage Allowed on Parcel:	
Building	226 Sq. Ft.
Free-Standing	93.75 Sq. Ft.
Total Allowed:	226 Sq. Ft.

COMMENTS: no guy wires, braces or secondary support shall be visible, as per code 4.2.6.5.0 in the zoning & development code book.

NOTE: No sign may exceed 300 square feet. A separate sign permit is required for each sign. Attach a sketch, to scale, of proposed and existing signage including types, dimensions and lettering. Attach a plot plan, to scale, showing: abutting streets, alleys, easements, driveways, encroachments, property lines, distances from existing buildings to proposed signs and required setbacks. Roof signs shall be manufactured such that no guy wires, braces or supports shall be visible.

I hereby attest that the information on this form and the attached sketches are true and accurate.

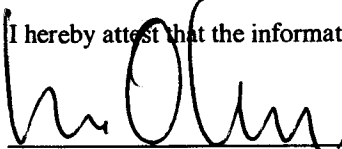
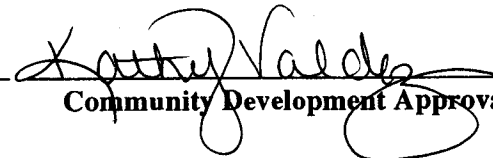

12-6-05

12-8-05

Applicant's Signature
Date
Community Development Approval
Date

(White: Community Development) (Yellow: Applicant) (Pink: Code Enforcement)

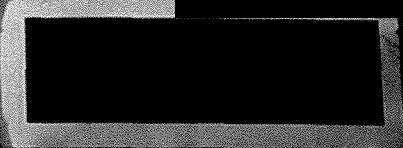
48 # - 2-3 x 8 sheets

MESA
AUTOMOTIVE
PAINT 245-2943



comCables.com

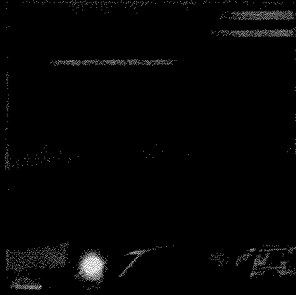

64 # 2 - 4 x 8 Sheets - total 16' in length

192"

48"

comCables

COMMERCIAL & RESIDENTIAL CABLING PRODUCTS

**Access Control ■ Audio ■ Data ■ Fire Alarm ■ Intercom
Paging ■ Security ■ Sound ■ Surveillance ■ Video ■ Voice**

now

enclosed w/ SOLID ALUM

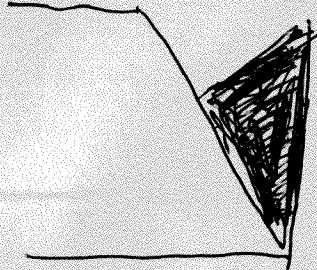
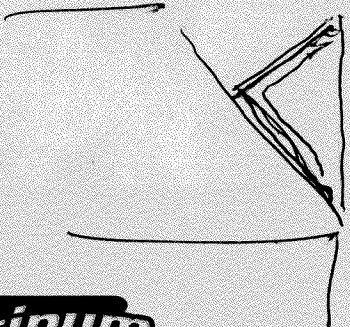

2916 Hwy. 6&24 Grand Junction, CO 81504 (970)248-9677

FABRICATION INSTALLATION MAINTENANCE NEON VINYL TRUCK LETTERING

City of Grand Junction GIS City Map ©

Parcels

 Address Label

Air Photos

 2002 Photos

 Highways

 Street Labels

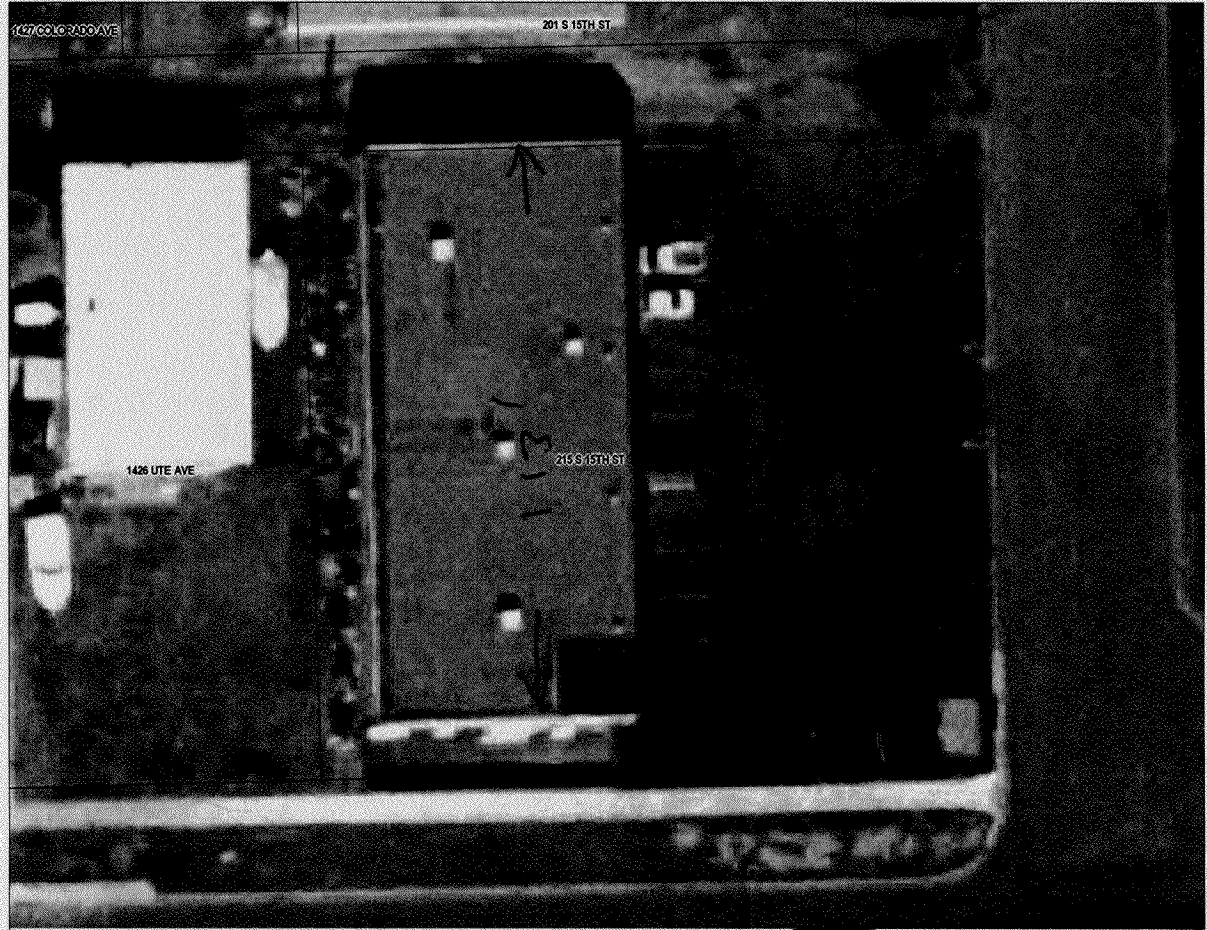

SCALE 1 : 452

