





# SIGN PERMIT

Community Development Department  
250 North 5th Street  
Grand Junction, CO 81501  
(970) 244-1430

Permit No. \_\_\_\_\_  
Date Submitted 1-26-05  
FEE \$ 5.00  
Tax Schedule 2945-113-19-005  
Zone C-1

BUSINESS NAME TROPICAL  
STREET ADDRESS 350 N. AVE.  
PROPERTY OWNER AMORA BLEY  
OWNER ADDRESS BOULDER, CO.

CONTRACTOR ELDERADO SIGNS  
LICENSE NO. 2040367  
ADDRESS 3423 FRONT ST.  
TELEPHONE NO. 523-6366

- 1. FLUSH WALL 2 Square Feet per Linear Foot of Building Facade
- Face Change Only (2,3 & 4):
- 2. ROOF 2 Square Feet per Linear Foot of Building Facade
- 3. FREE-STANDING 2 Traffic Lanes - 0.75 Square Feet x Street Frontage  
4 or more Traffic Lanes - 1.5 Square Feet x Street Frontage
- 4. PROJECTING 0.5 Square Feet per each Linear Foot of Building Facade

Existing Externally or Internally Illuminated - No Change in Electrical Service  Non-Illuminated

- (1 - 4) Area of Proposed Sign 40' Square Feet
- (1,2,4) Building Facade 40 Linear Feet
- (1 - 4) Street Frontage 0.75 Linear Feet
- (2,3,4) Height to Top of Sign 14 Feet Clearance to Grade 12 Feet

Existing Signage/Type:	
<u>FREE STANDING</u>	<del>98</del> Sq. Ft.
<u>FLUSH WALL (N. AVE)</u>	<del>30</del> Sq. Ft.
	Sq. Ft.
Total Existing:	<u>0</u> Sq. Ft.

● FOR OFFICE USE ONLY ●	
Signage Allowed on Parcel:	<u>4th St</u>
Building	<u>80</u> Sq. Ft.
Free-Standing	<u>56.25</u> Sq. Ft.
Total Allowed:	<u>80</u> Sq. Ft.

COMMENTS: THIS IS ON 4TH ST. SIDE & EXISTING FLUSH WALL ("FACE CHANGE ONLY")\*

NOTE: No sign may exceed 300 square feet. A separate sign permit is required for each sign. Attach a sketch of proposed and existing signage including types, dimensions, lettering, abutting streets, alleys, easements, property lines, and locations. Roof signs shall be manufactured such that no guy wires, braces or supports shall be visible.

[Signature] Applicant's Signature      1/25/05 Date      [Signature] Community Development Approval      1-26-05 Date

(White: Community Development)      (Canary: Applicant)      (Pink: Code Enforcement)

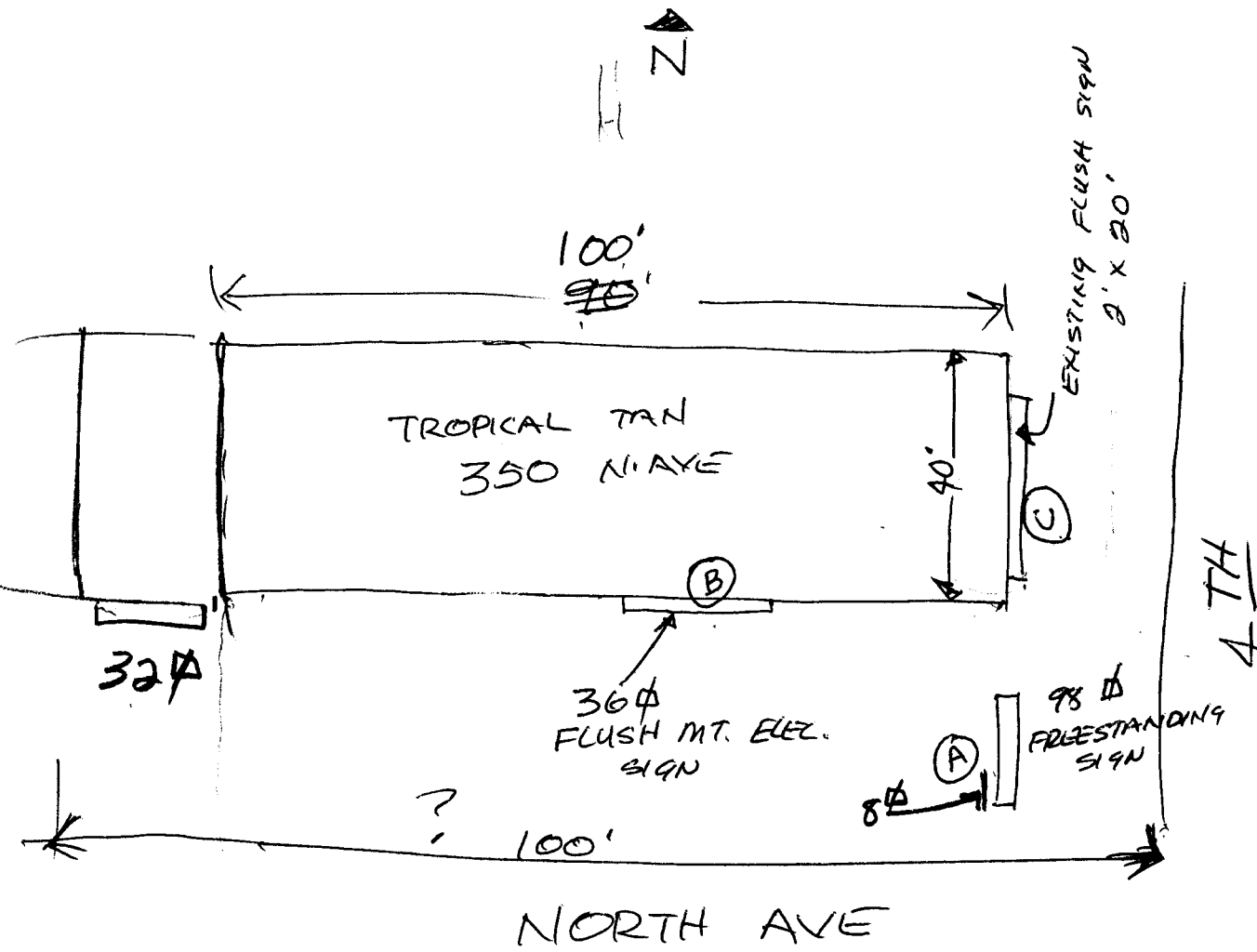

- (A) 98' . FREE STANDING
  - (B) 36' . FLUSH WALL N. AVE
  - (C) 4' . FLUSH WALL 4TH
- 174' TOTAL

(CRIME PREVENTION)  
32' ON FRONT  
8' ON F. STANDING SIGN

200'



ELDERADO SIGNS  
3423 FRONT ST.  
CLIFTON, CO. 523-6366  
GMM