



SIGN PERMIT

(a)

(A)

Community Development Department
250 North 5th Street
Grand Junction, CO 81501
(970) 244-1430

Permit No. _____
Date Submitted 8/25/05
FEE \$ 25.00
Tax Schedule 2945-111-20-007
Zone B-1

BUSINESS NAME Western Rockies Optical CONTRACTOR Soundough Signs
STREET ADDRESS 1000 Wellington Ave. LICENSE NO. 2050813
PROPERTY OWNER Western Rockies Investment Grp. ADDRESS 2223 H. Rd
OWNER ADDRESS _____ TELEPHONE NO. 243-7011

- 1. FLUSH WALL 2 Square Feet per Linear Foot of Building Facade
- Face Change Only (2,3 & 4):
- 2. ROOF 2 Square Feet per Linear Foot of Building Facade
- 3. FREE-STANDING 2 Traffic Lanes - 0.75 Square Feet x Street Frontage
4 or more Traffic Lanes - 1.5 Square Feet x Street Frontage
- 4. PROJECTING 0.5 Square Feet per each Linear Foot of Building Facade

Existing Externally or Internally Illuminated - No Change in Electrical Service Non-Illuminated

(1 - 4) Area of Proposed Sign 6 Square Feet
(1,2,4) Building Facade 160 Linear Feet Wellington
(1 - 4) Street Frontage 300 Linear Feet
(2,3,4) Height to Top of Sign _____ Feet Clearance to Grade _____ Feet

Existing Signage/Type:	
<u>Individual flush mt letters</u>	<u>16.75</u> Sq. Ft.
<u>Freestanding</u>	<u>24</u> Sq. Ft.
	Sq. Ft.
Total Existing:	<u>40.75</u> Sq. Ft.

● FOR OFFICE USE ONLY ●	
Signage Allowed on Parcel: <u>Wellington</u>	
Building	<u>300</u> Sq. Ft.
Free-Standing	<u>225</u> Sq. Ft.
Total Allowed:	<u>320</u> Sq. Ft.

COMMENTS: Moving logo + letters up to facade

NOTE: No sign may exceed 300 square feet. A separate sign permit is required for each sign. Attach a sketch of proposed and existing signage including types, dimensions, lettering, abutting streets, alleys, easements, property lines, and locations. Roof signs shall be manufactured such that no guy wires, braces or supports shall be visible.

Sandra M. Holloway 8/25/05 Cheryl Hall 8/25/05
Applicant's Signature Date Community Development Approval Date

(White: Community Development) (Canary: Applicant) (Pink: Code Enforcement)

(B)



SIGN PERMIT

Community Development Department
250 North 5th Street
Grand Junction, CO 81501
(970) 244-1430

Permit No. _____
Date Submitted 8/25/05
FEE \$ 5.00
Tax Schedule 2945-111-20-007
Zone B-1

BUSINESS NAME Western Rockies Optical CONTRACTOR Sourdough Signs
STREET ADDRESS 1000 Wellington Ave LICENSE NO. 2050813
PROPERTY OWNER Western Rockies Investment Grp ADDRESS 2223 1st Rd
OWNER ADDRESS _____ TELEPHONE NO. 243-1383

- 1. FLUSH WALL 2 Square Feet per Linear Foot of Building Facade
- Face Change Only (2,3 & 4):**
- 2. ROOF 2 Square Feet per Linear Foot of Building Facade
- 3. FREE-STANDING 2 Traffic Lanes - 0.75 Square Feet x Street Frontage
4 or more Traffic Lanes - 1.5 Square Feet x Street Frontage
- 4. PROJECTING 0.5 Square Feet per each Linear Foot of Building Facade

Existing Externally or Internally Illuminated - No Change in Electrical Service Non-Illuminated

(1 - 4) Area of Proposed Sign 6 Square Feet
(1,2,4) Building Facade 115 Linear Feet Little Book cliff Ave.
(1 - 4) Street Frontage 395 Linear Feet
(2,3,4) Height to Top of Sign _____ Feet Clearance to Grade _____ Feet

Existing Signage/Type:	
	Sq. Ft.
	Sq. Ft.
	Sq. Ft.
Total Existing:	<u>0</u> Sq. Ft.

● FOR OFFICE USE ONLY ●		
Signage Allowed on Parcel:		
Building	<u>230</u>	Sq. Ft.
Free-Standing	<u>2910</u>	Sq. Ft.
Total Allowed:	<u>2910</u>	Sq. Ft.

COMMENTS: mount logo + letters up to fascia

NOTE: No sign may exceed 300 square feet. A separate sign permit is required for each sign. Attach a sketch of proposed and existing signage including types, dimensions, lettering, abutting streets, alleys, easements, property lines, and locations. Roof signs shall be manufactured such that no guy wires, braces or supports shall be visible.

Sandra M. Hollaway 8/25/05 Clay Hall 8/26/05
Applicant's Signature Date Community Development Approval Date

(White: Community Development) (Canary: Applicant) (Pink: Code Enforcement)

1000 WELLINGTON AVE.

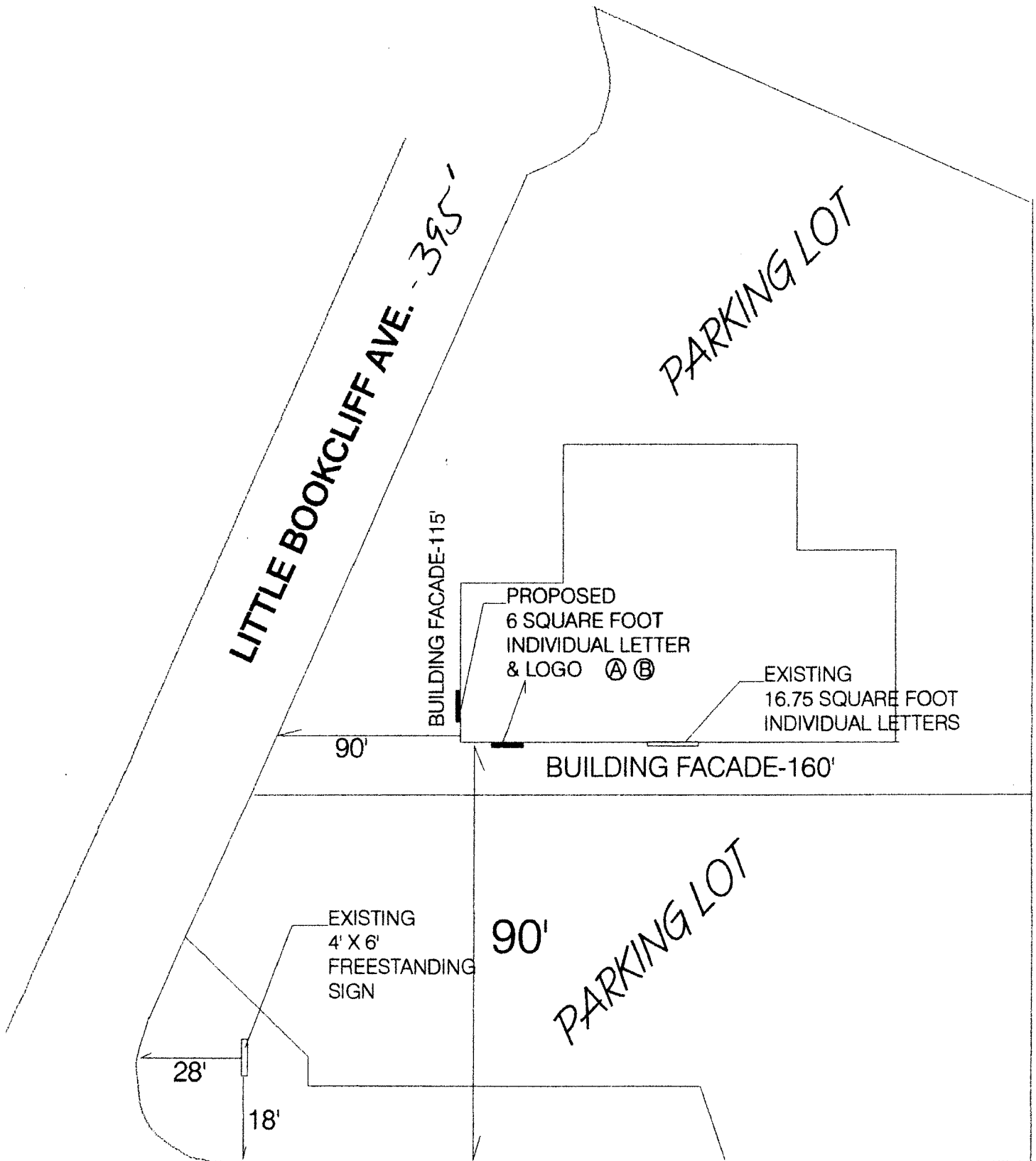

WELLINGTON AVE.- FRONTAGE 300'

(A) + (B)

7 1/2" x 39"

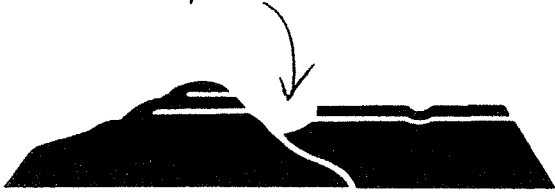

2 7

6" x 96"

Western Rockies Optical

4 7