

(A)



SIGN PERMIT

(C)

Community Development Department
250 North 5th Street
Grand Junction, CO 81501
(970) 244-1430

Permit No. _____
Date Submitted 3-22-05
FEE \$ 25.00
Tax Schedule 2945-123-25-011
Zone C-1

BUSINESS NAME Veterinary Emergency Center CONTRACTOR The Sign Gallery
STREET ADDRESS 1600 N. Ave. LICENSE NO. 12050856
PROPERTY OWNER Veterinary Emergency ADDRESS 1048 Independence A-109
OWNER ADDRESS 1600 N. Ave TELEPHONE NO. 241-6400

- 1. FLUSH WALL 2 Square Feet per Linear Foot of Building Facade
- Face Change Only (2,3 & 4):
- 2. ROOF 2 Square Feet per Linear Foot of Building Facade
- 3. FREE-STANDING 2 Traffic Lanes - 0.75 Square Feet x Street Frontage
4 or more Traffic Lanes - 1.5 Square Feet x Street Frontage
- 4. PROJECTING 0.5 Square Feet per each Linear Foot of Building Facade

Existing Externally or Internally Illuminated - No Change in Electrical Service Non-Illuminated

(1 - 4) Area of Proposed Sign 46.6 Square Feet
(1,2,4) Building Facade 75 Linear Feet
(1 - 4) Street Frontage 80 Linear Feet
(2,3,4) Height to Top of Sign 21-33 Feet Clearance to Grade 18 Feet

Existing Signage/Type:	
<u>Free-Standing</u>	<u>64</u> Sq. Ft.
	Sq. Ft.
	Sq. Ft.
Total Existing:	<u>64</u> Sq. Ft.

● FOR OFFICE USE ONLY ●		
Signage Allowed on Parcel: <u>North Ave</u>		
Building	<u>150</u>	Sq. Ft.
Free-Standing	<u>120</u>	Sq. Ft.
Total Allowed:	<u>150</u>	Sq. Ft.

COMMENTS: Replacing faces on an existing free-standing sign

NOTE: No sign may exceed 300 square feet. A separate sign permit is required for each sign. Attach a sketch of proposed and existing signage including types, dimensions, lettering, abutting streets, alleys, easements, property lines, and locations. Roof signs shall be manufactured such that no guy wires, braces or supports shall be visible.

Larry J. Bowler 3-18-05 Missi Magan 3/22/05
Applicant's Signature Date Community Development Approval Date

(White: Community Development) (Canary: Applicant) (Pink: Code Enforcement)

Ⓐ 1660 N Ave

40'



Veterinary Emergency Center

255-1911

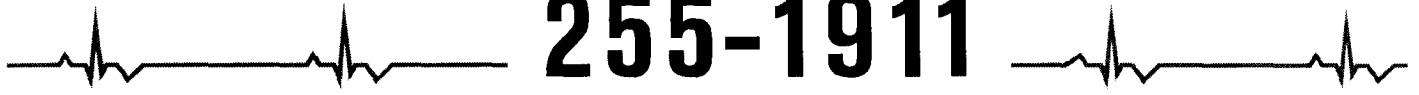

14'
46.671

(B)



SIGN PERMIT

Community Development Department
250 North 5th Street
Grand Junction, CO 81501
(970) 244-1430

Permit No. _____
Date Submitted 3-22-05
FEE \$ 5.00
Tax Schedule 2945-123-25-011
Zone C-1

BUSINESS NAME Veterinary Emergency
STREET ADDRESS 1660 N. Ave.
PROPERTY OWNER Veterinary Emergency
OWNER ADDRESS 1660 N. Ave.

CONTRACTOR The Sign Gallery
LICENSE NO. 2050836
ADDRESS 1048 Independent A-109
TELEPHONE NO. 241-6400

- 1. FLUSH WALL 2 Square Feet per Linear Foot of Building Facade
- Face Change Only (2,3 & 4):
- 2. ROOF 2 Square Feet per Linear Foot of Building Facade
- 3. FREE-STANDING 2 Traffic Lanes - 0.75 Square Feet x Street Frontage
4 or more Traffic Lanes - 1.5 Square Feet x Street Frontage
- 4. PROJECTING 0.5 Square Feet per each Linear Foot of Building Facade

Existing Externally or Internally Illuminated - No Change in Electrical Service Non-Illuminated

(1 - 4) Area of Proposed Sign 7 Square Feet
(1,2,4) Building Facade 75 Linear Feet
(1 - 4) Street Frontage 80 Linear Feet
(2,3,4) Height to Top of Sign 15 Feet Clearance to Grade 12 Feet

Existing Signage/Type:	
<u>Free-standing</u>	<u>64</u> Sq. Ft.
	Sq. Ft.
	Sq. Ft.
Total Existing:	<u>64</u> Sq. Ft.

● FOR OFFICE USE ONLY ●		
Signage Allowed on Parcel: <u>North Ave</u>		
Building	<u>150</u>	Sq. Ft.
Free-Standing	<u>120</u>	Sq. Ft.
Total Allowed:	<u>150</u>	Sq. Ft.

COMMENTS: _____

NOTE: No sign may exceed 300 square feet. A separate sign permit is required for each sign. Attach a sketch of proposed and existing signage including types, dimensions, lettering, abutting streets, alleys, easements, property lines, and locations. Roof signs shall be manufactured such that no guy wires, braces or supports shall be visible.

Larry Decker 3-18-05 Yvonne Magan 3-22-05
Applicant's Signature Date Community Development Approval Date

(White: Community Development)

(Canary: Applicant)

(Pink: Code Enforcement)



#1, 3

① National Emergency Center 166 N. Ave.



SIGN PERMIT

Community Development Department
 250 North 5th Street
 Grand Junction, CO 81501
 (970) 244-1430

Permit No. _____
 Date Submitted 3-22-05
 FEE \$ 5.00
 Tax Schedule 2945-123-25-011
 Zone C-1

BUSINESS NAME Veterinary Emergency
 STREET ADDRESS 1660 N Ave 1
 PROPERTY OWNER Veterinary Emergency
 OWNER ADDRESS 1660 N Ave 1

CONTRACTOR The Sign Gallery
 LICENSE NO. 1050356
 ADDRESS 1848 Independent A-109
 TELEPHONE NO. 241-6400

- 1. FLUSH WALL 2 Square Feet per Linear Foot of Building Facade
- Face Change Only (2,3 & 4):
- 2. ROOF 2 Square Feet per Linear Foot of Building Facade
- 3. FREE-STANDING 2 Traffic Lanes - 0.75 Square Feet x Street Frontage
4 or more Traffic Lanes - 1.5 Square Feet x Street Frontage
- 4. PROJECTING 0.5 Square Feet per each Linear Foot of Building Facade

Existing Externally or Internally Illuminated - No Change in Electrical Service Non-Illuminated

- (1 - 4) Area of Proposed Sign 30 Square Feet
- (1,2,4) Building Facade 75 Linear Feet
- (1 - 4) Street Frontage 80 Linear Feet
- (2,3,4) Height to Top of Sign 10 Feet Clearance to Grade 8.5 Feet

Existing Signage/Type:	
<u>Free-Standing</u>	<u>64</u> Sq. Ft.
	Sq. Ft.
	Sq. Ft.
Total Existing:	<u>64</u> Sq. Ft.

● FOR OFFICE USE ONLY ●		
Signage Allowed on Parcel: <u>North Ave</u>		
Building	<u>150</u>	Sq. Ft.
Free-Standing	<u>120</u>	Sq. Ft.
Total Allowed:	<u>150</u>	Sq. Ft.

COMMENTS: Sign consist of individual letters

NOTE: No sign may exceed 300 square feet. A separate sign permit is required for each sign. Attach a sketch of proposed and existing signage including types, dimensions, lettering, abutting streets, alleys, easements, property lines, and locations. Roof signs shall be manufactured such that no guy wires, braces or supports shall be visible.

Larry L Bon Li 3-18-05 Ulsha Magon 3/22/05
 Applicant's Signature Date Community Development Approval Date

(White: Community Development) (Canary: Applicant) (Pink: Code Enforcement)



1660 North Ave

VETERINARY EMERGENCY

18'

20'
30'

Veterinary Emergency Center
1660 N ave

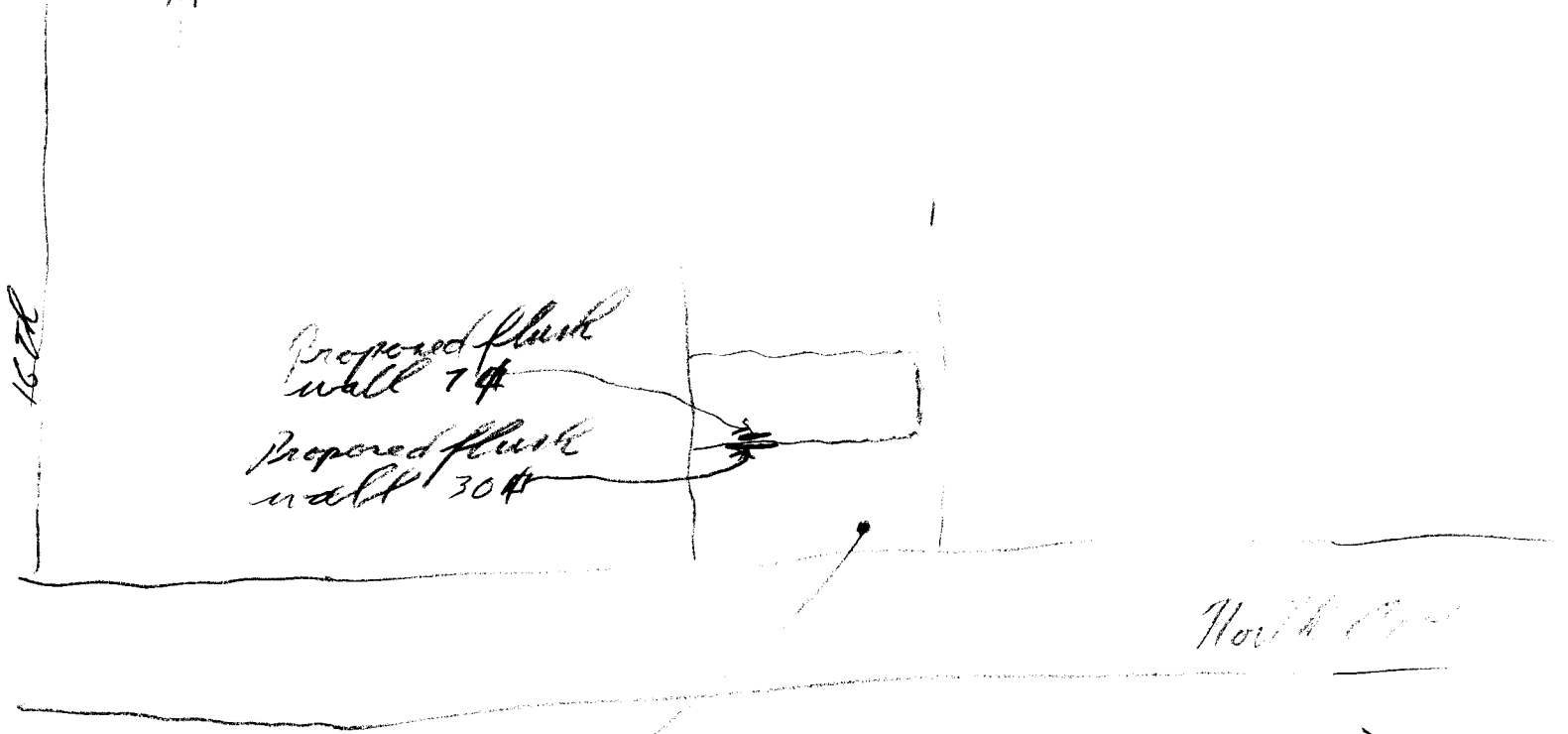

Existing Free-Standing - (Total 110.6 ft)
replacing facade - 46.6 ft

Replacing facade

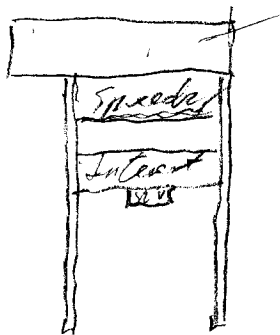

Existing Free-Standing sign