



SIGN PERMIT

Community Development Department
 250 North 5th Street
 Grand Junction, CO 81501
 (970) 244-1430

Permit No. _____
 Date Submitted 9-14-05
 FEE \$ 25.00
 Tax Schedule 2945-103-00-146
 Zone C-2

BUSINESS NAME B5 [redacted] [redacted] CONTRACTOR The Sign Gallery
 STREET ADDRESS [redacted] 1048 Independent Ave. LICENSE NO. 2050856
 PROPERTY OWNER Omega Realty ADDRESS 1048 Independent A-109
 OWNER ADDRESS 1048 Independent TELEPHONE NO. 241-6400

- 1. FLUSH WALL 2 Square Feet per Linear Foot of Building Facade
- Face Change Only (2,3 & 4):
- 2. ROOF 2 Square Feet per Linear Foot of Building Facade
- 3. FREE-STANDING 2 Traffic Lanes - 0.75 Square Feet x Street Frontage
4 or more Traffic Lanes - 1.5 Square Feet x Street Frontage
- 4. PROJECTING 0.5 Square Feet per each Linear Foot of Building Facade

Existing Externally or Internally Illuminated - No Change in Electrical Service Non-Illuminated

(1 - 4) Area of Proposed Sign 15 Square Feet
 (1,2,4) Building Facade 229 Linear Feet
 (1 - 4) Street Frontage 215 Linear Feet
 (2,3,4) Height to Top of Sign 19 1/2 Feet Clearance to Grade 17 Feet

Existing Signage/Type:	
<u>Flush Wall</u>	<u>75</u> Sq. Ft.
	Sq. Ft.
	Sq. Ft.
Total Existing:	<u>75</u> Sq. Ft.

● FOR OFFICE USE ONLY ●	
Signage Allowed on Parcel:	<u>25 1/2</u> Rd
Building	<u>458</u> Sq. Ft.
Free-Standing	<u>101</u> Sq. Ft.
Total Allowed:	<u>458</u> Sq. Ft.

COMMENTS: Replacing existing sign face.

NOTE: No sign may exceed 300 square feet. A separate sign permit is required for each sign. Attach a sketch of proposed and existing signage including types, dimensions, lettering, abutting streets, alleys, easements, property lines, and locations. Roof signs shall be manufactured such that no guy wires, braces or supports shall be visible.

Larry L Bowler 9-13-05 Michelle Aragon 9-15-05
 Applicant's Signature Date Community Development Approval Date

(White: Community Development) (Canary: Applicant) (Pink: Code Enforcement)

G S Roberson
529 25 1/2 Rd.

Proposed
flue pipe
30" x 6" - 15 ft
replacing the pipe of
an existing pipe.

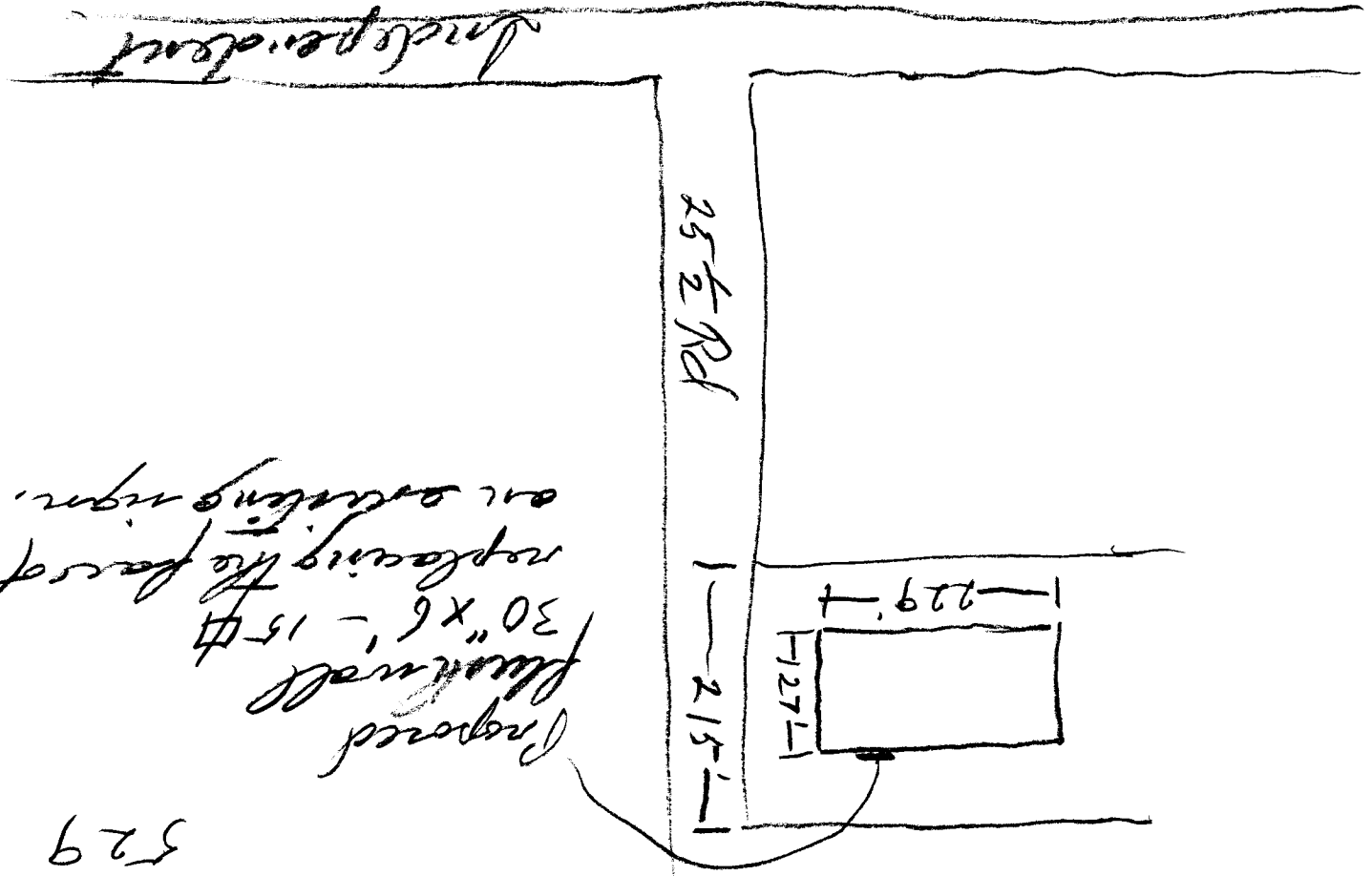

GS Rolzone
529 25 1/2 Rd.

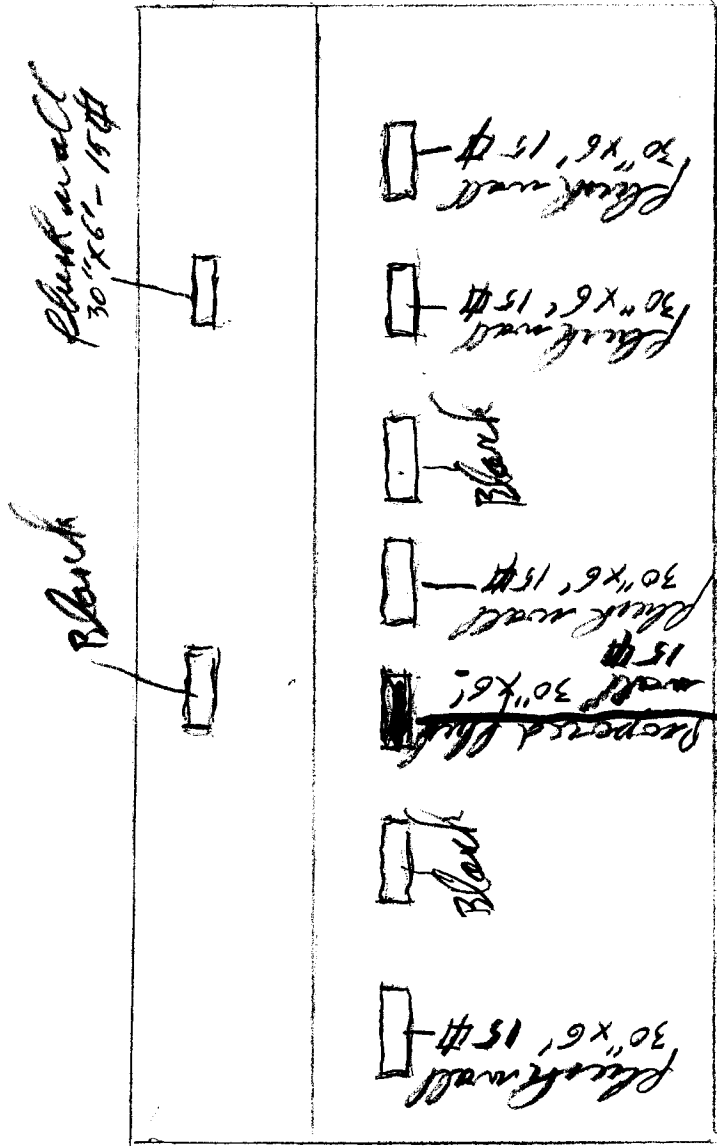

North face of building

529 25 1/2 Pdl.

GS ROBSON - ARCHITECTURE, INC.

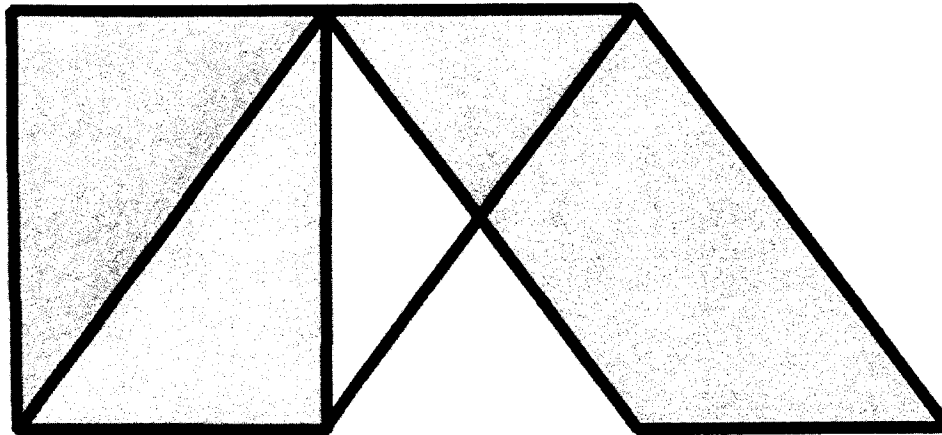

7 1/2"

6'