



# SIGN PERMIT

2

Community Development Department  
250 North 5th Street  
Grand Junction, CO 81501  
(970) 244-1430

Permit No. \_\_\_\_\_  
Date Submitted 2-4-05  
FEE \$ 25.00  
Tax Schedule 2945-102-41-002  
Zone C-2

BUSINESS NAME Building Blocks Pre-School CONTRACTOR ELDERADO SIGNS  
STREET ADDRESS 2531 W. PINEYAW LICENSE NO. ~~2040387~~ 2050295  
PROPERTY OWNER \_\_\_\_\_ ADDRESS 3423 FRONT ST.  
OWNER ADDRESS \_\_\_\_\_ TELEPHONE NO. 234-0511

- 1. FLUSH WALL 2 Square Feet per Linear Foot of Building Facade
- Face Change Only (2,3 & 4):
- 2. ROOF 2 Square Feet per Linear Foot of Building Facade
- 3. FREE-STANDING 2 Traffic Lanes - 0.75 Square Feet x Street Frontage  
4 or more Traffic Lanes - 1.5 Square Feet x Street Frontage
- 4. PROJECTING 0.5 Square Feet per each Linear Foot of Building Facade

Existing Externally or Internally Illuminated - No Change in Electrical Service  Non-Illuminated

(1 - 4) Area of Proposed Sign 18 Square Feet  
(1,2,4) Building Facade 54 Linear Feet  
(1 - 4) Street Frontage 120 Linear Feet  
(2,3,4) Height to Top of Sign 7 Feet Clearance to Grade 4 Feet

| Existing Signage/Type: |                  |
|------------------------|------------------|
| <u>Awning Sign</u>     | <u>6</u> Sq. Ft. |
| <u>FREE STANDING</u>   | <u>4</u> Sq. Ft. |
|                        | Sq. Ft.          |
| Total Existing:        | Sq. Ft.          |

| ● FOR OFFICE USE ONLY ●    |                    |
|----------------------------|--------------------|
| Signage Allowed on Parcel: |                    |
| Building                   | <u>108</u> Sq. Ft. |
| Free-Standing              | <u>90</u> Sq. Ft.  |
| Total Allowed:             | <u>108</u> Sq. Ft. |

COMMENTS: \_\_\_\_\_

NOTE: No sign may exceed 300 square feet. A separate sign permit is required for each sign. Attach a sketch of proposed and existing signage including types, dimensions, lettering, abutting streets, alleys, easements, property lines, and locations. Roof signs shall be manufactured such that no guy wires, braces or supports shall be visible.

[Signature] 2/4/05 Danley Henderson 2-7-05  
Applicant's Signature Date Community Development Approval Date

(White: Community Development) (Canary: Applicant) (Pink: Code Enforcement)

3x6, 18 1/2



PRE-SCHOOL

BUILDING BLOCKS

2531 W. Piñon

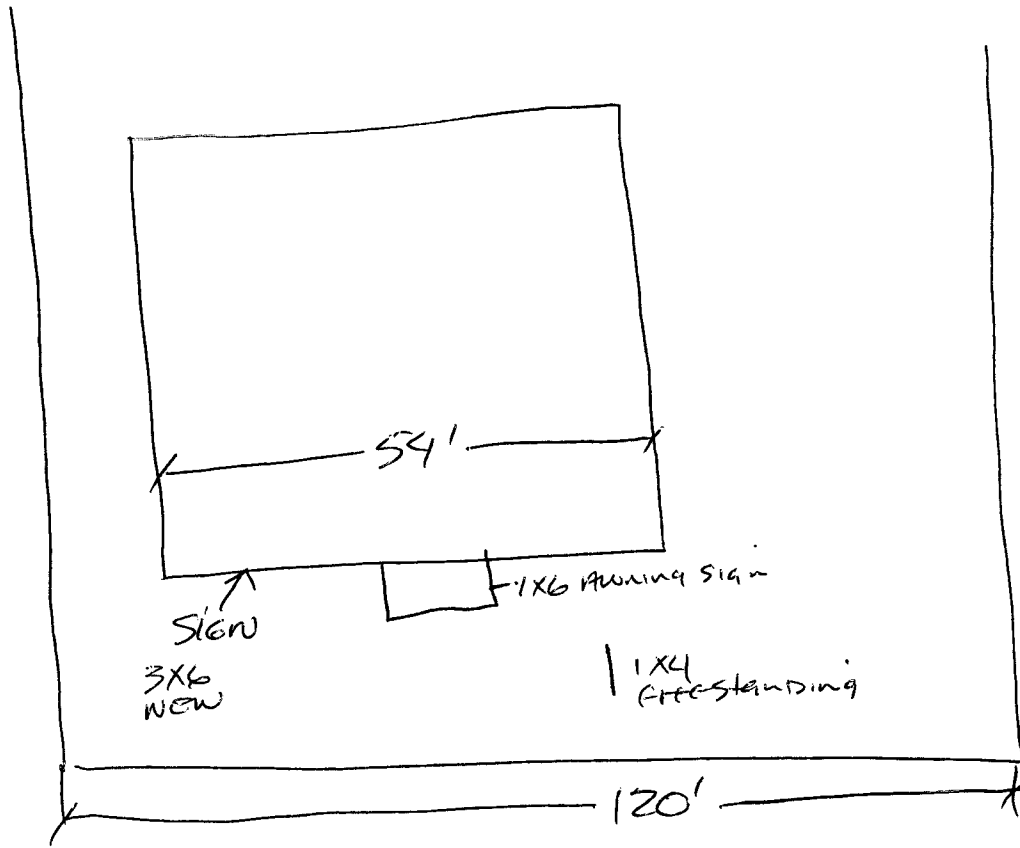

54' Building  
120' Street Frontage

---

WEST PINYON

---