



# SIGN PERMIT

2

Community Development Department  
250 North 5th Street  
Grand Junction, CO 81501  
(970) 244-1430

Permit No. \_\_\_\_\_  
Date Submitted 6-29-05  
FEE \$ 25.00  
Tax Schedule 2945-091-02-018  
Zone C-2

BUSINESS NAME Express All-Stars CONTRACTOR Bud's Signs  
STREET ADDRESS 2487 Industrial Blvd. LICENSE NO. 2050128  
PROPERTY OWNER SAME ADDRESS 1055 Ute Ave.  
OWNER ADDRESS SAME TELEPHONE NO. 245-7700

- 1. FLUSH WALL 2 Square Feet per Linear Foot of Building Facade
- Face Change Only (2,3 & 4):
- 2. ROOF 2 Square Feet per Linear Foot of Building Facade
- 3. FREE-STANDING 2 Traffic Lanes - 0.75 Square Feet x Street Frontage  
4 or more Traffic Lanes - 1.5 Square Feet x Street Frontage
- 4. PROJECTING 0.5 Square Feet per each Linear Foot of Building Facade

Existing Externally or Internally Illuminated - No Change in Electrical Service  Non-Illuminated

(1 - 4) Area of Proposed Sign 32 Square Feet  
(1,2,4) Building Facade 246 Linear Feet  
(1 - 4) Street Frontage 136 Linear Feet  
(2,3,4) Height to Top of Sign 12 Feet Clearance to Grade 8 Feet

Existing Signage/Type:	
<u>F/W 1 @ 16 #</u>	Sq. Ft.
<u>1 @ 24 #</u>	<u>30</u> Sq. Ft.
<u>F/S 32 #</u>	<u>32</u> Sq. Ft.
Total Existing:	<u>62</u> Sq. Ft.

● FOR OFFICE USE ONLY ●	
Signage Allowed on Parcel: <u>West Mesa Ct.</u>	
Building	<u>492</u> Sq. Ft.
Free-Standing	<u>102</u> Sq. Ft.
Total Allowed:	<u>492</u> Sq. Ft.

COMMENTS: \_\_\_\_\_

**NOTE:** No sign may exceed 300 square feet. A separate sign permit is required for each sign. Attach a sketch of proposed and existing signage including types, dimensions, lettering, abutting streets, alleys, easements, property lines, and locations. Roof signs shall be manufactured such that no guy wires, braces or supports shall be visible.

Zoelel Kochera 6/29/05 Gayleen Henderson 6-30-05  
Applicant's Signature Date Community Development Approval Date

(White: Community Development) (Canary: Applicant) (Pink: Code Enforcement)

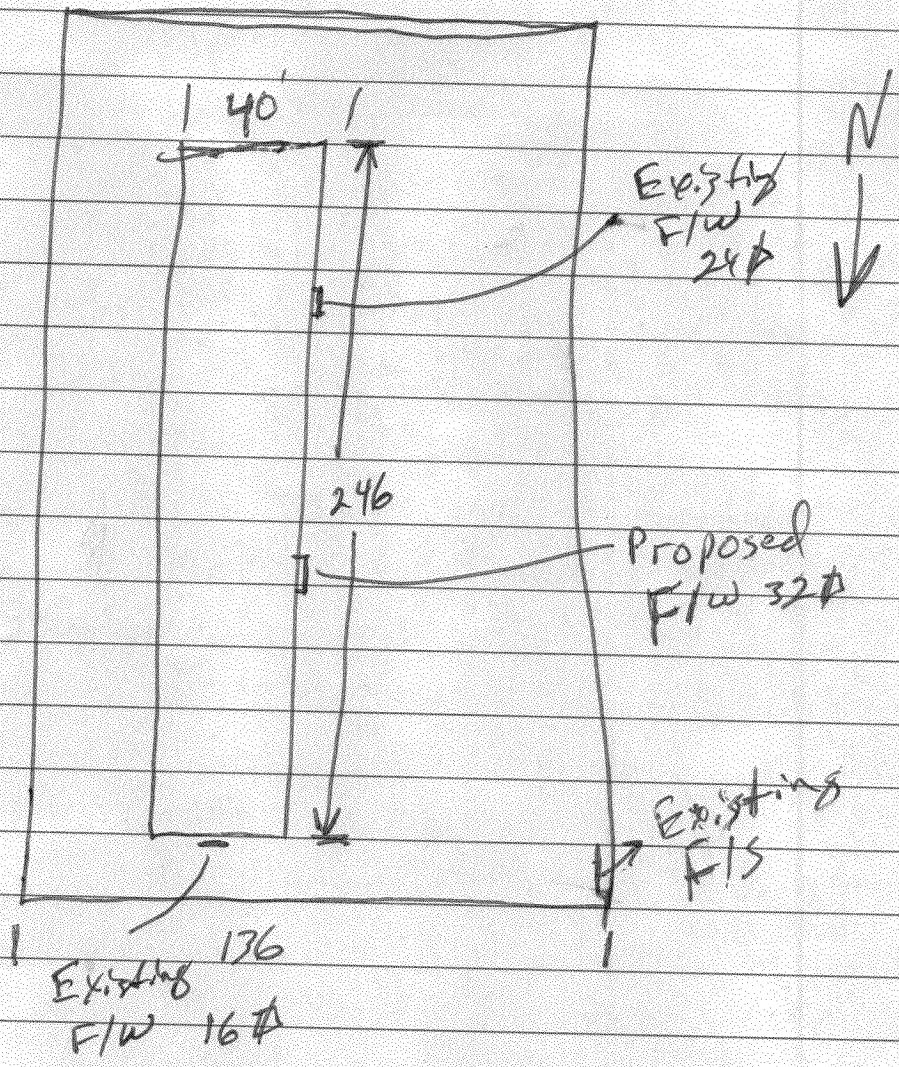

Cheer & Dance Studio

