



# SIGN CLEARANCE

Community Development Department  
250 North 5<sup>th</sup> Street  
Grand Junction CO 81501  
(970) 244-1430

Clearance No. None  
Date Submitted 1-9-03  
Fee \$ 25.00  
Zone RSF-4

*COPY*

TAX SCHEDULE 2701-351-60-951 CONTRACTOR Bud's Signs  
BUSINESS NAME Holy Family Catholic Church LICENSE NO. 2020157  
STREET ADDRESS 786 26 1/2 Road ADDRESS 1055 vte  
PROPERTY OWNER Bishop of Pueblo TELEPHONE NO. 245-7700  
OWNER ADDRESS \_\_\_\_\_ CONTACT PERSON Eric

- 1. FLUSH WALL 2 Square Feet per Linear Foot of Building Facade
- 2. ROOF 2 Square Feet per Linear Foot of Building Facade
- 3. FREE-STANDING 2 Traffic Lanes - 0.75 Square Feet x Street Frontage  
4 or more Traffic Lanes - 1.5 Square Feet x Street Frontage
- 4. PROJECTING 0.5 Square Feet per each Linear Foot of Building Facade
- 5. OFF-PREMISE See #3 Spacing Requirements; Not > 300 Square Feet or < 15 Square Feet

Externally Illuminated       Internally Illuminated       Non-Illuminated

(1 - 5) Area of Proposed Sign: 22.75 Square Feet  
(1,2,4) Building Façade: 300 Linear Feet  
(1 - 4) Street Frontage: 600 Linear Feet  
(2 - 5) Height to Top of Sign: 6' Feet      Clearance to Grade: 3' Feet  
(5) Distance from all Existing Off-Premise Signs within 600 Feet: \_\_\_\_\_ Feet

EXISTING SIGNAGE/TYPE:	
_____	<u>0</u> Sq. Ft.
_____	_____ Sq. Ft.
_____	_____ Sq. Ft.
_____	_____ Sq. Ft.
Total Existing:	_____ Sq. Ft.

**● FOR OFFICE USE ONLY ●**

Signage Allowed on Parcel:

Building 1000 Sq. Ft.  
Free-Standing 450 Sq. Ft.  
Total Allowed: 300 Sq. Ft.

COMMENTS: \_\_\_\_\_

**NOTE:** No sign may exceed 300 square feet. A separate sign clearance is required for each sign. Attach a sketch, to scale, of proposed and existing signage including types, dimensions and lettering. Attach a plot plan, to scale, showing: abutting streets, alleys, easements, driveways, encroachments, property lines, distances from existing buildings to proposed signs and required setbacks. A SEPARATE PERMIT FROM THE BUILDING DEPARTMENT IS ALSO REQUIRED.

I hereby attest that the information on this form and the attached sketches are true and accurate.

Eric Benoit      1-9-03      Mark Hagan      1/9/03  
Applicant's Signature      Date      Community Development Approval      Date

(White: Community Development)      (Canary: Applicant)      (Pink: Building Dept)      (Goldenrod: Code Enforcement)

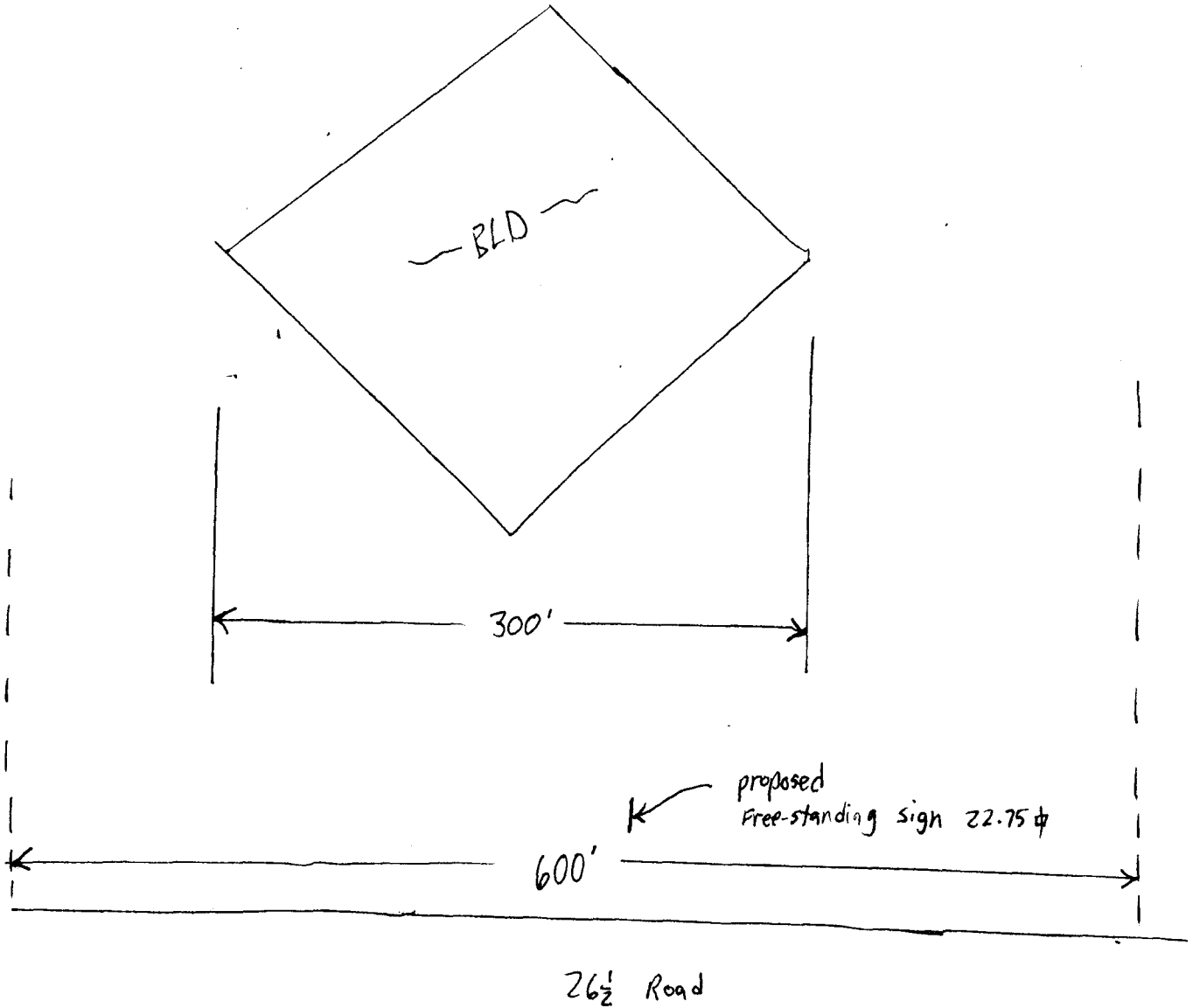

← N

22.75¢

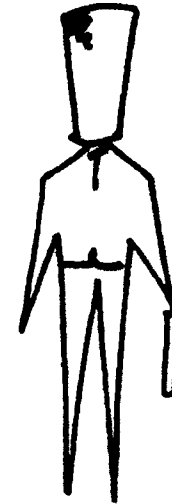
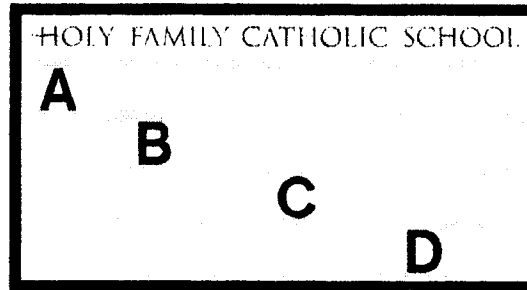

- 3'-6" X 6'-6" DOUBLE SIDED ILLUMINATED MARQUE
- 4 LINES OF 6" CHANGABLE LETTERS
- LOCKABLE SIGN FACE COVER
- BACKLIT SCHOOL LOGO ON WEST FACING END



DESIGN PROPERTY OF  
*Bud's*  
**SIGNS**  
*and Neon*  
970-245-7700