



# Sign Permit

Community Development Department  
250 North 5<sup>th</sup> Street  
Grand Junction CO 81501  
Phone: (970) 244-1430 FAX (970) 256-4031

Permit No.	_____
Date Submitted	<u>7-25-06</u>
Fee \$	<u>25<sup>00</sup></u>
Zone	<u>I-1</u>

TAX SCHEDULE <u>2701-313-08-001</u>	CONTRACTOR <u>The Sign Gallery</u>
BUSINESS NAME <u>Transwest Truck</u>	LICENSE NO. <u>2050856</u>
STREET ADDRESS <u>2236 Sanford</u>	ADDRESS <u>1048 Independent R 109</u>
PROPERTY OWNER <u>GEP Investments Inc.</u>	TELEPHONE NO. <u>241-6480</u>
OWNER ADDRESS _____	CONTACT PERSON <u>Ferry</u>

<input type="checkbox"/> 1. FLUSH WALL	2 Square Feet per Linear Foot of Building Façade
<b>Face change only on items 2, 3 &amp; 4</b>	
<input type="checkbox"/> 2. ROOF	2 Square Feet per Linear Foot of Building Façade
<input type="checkbox"/> 3. PROJECTING	0.5 Square Feet per each Linear Foot of Building Façade
<input checked="" type="checkbox"/> 4. FREE-STANDING	2 Traffic Lanes - 0.75 Square Feet x Street Frontage 4 or more Traffic Lanes - 1.5 Square Feet x Street Frontage

Existing Externally or Internally Illuminated - No Change in Electrical Service       Non-Illuminated

(1-4) Area of Proposed Sign: <u>250</u> Square Feet	Building Façade Direction: <u>North</u> South East West
(1-3) Building Façade: <u>244 310</u> Linear Feet	Name of Street: <u>I-70</u>
(4) Street Frontage: <u>834.8</u> Linear Feet	Clearance to Grade: <u>26</u> Feet
(2-4) Height to Top of Sign: <u>40</u> Feet	

<b>EXISTING SIGNAGE/TYPE:</b>	
<u>flush wall</u>	<u>159.5</u> Sq. Ft.
<u>Free-standing Existing</u>	<u>250</u> Sq. Ft.
<u>sign can to be replaced</u>	_____ Sq. Ft.
<b>Total Existing:</b>	<u>409.5</u> Sq. Ft.

<b>FOR OFFICE USE ONLY</b>	
Signage Allowed on Parcel:	
Building	<u>480</u> <sup>300</sup> Sq. Ft.
Free-Standing	<u>1251</u> <sup>300</sup> Sq. Ft.
<b>Total Allowed:</b>	<u>1251</u> Sq. Ft.

COMMENTS: Replacing the sign can on an existing free-standing sign - Need to get a permit from COOT

**NOTE:** No sign may exceed 300 square feet. A separate sign permit is required for each sign. Attach a sketch, to scale, of proposed and existing signage including types, dimensions and lettering. Attach a plot plan, to scale, showing: abutting streets, alleys, easements, driveways, encroachments, property lines, distances from existing buildings to proposed signs and required setbacks. Roof signs shall be manufactured such that no guy wires, braces or supports shall be visible.

I hereby attest that the information on this form and the attached sketches are true and accurate.

<u>Larry L Bowler</u>	<u>7-24-06</u>	<u>Wisha Pragn</u>	<u>7-25-06</u>
Applicant's Signature	Date	Community Development Approval	Date

(White: Community Development)

(Yellow: Applicant)

(Pink: Code Enforcement)

Tramway Tracks  
2236 Sanford

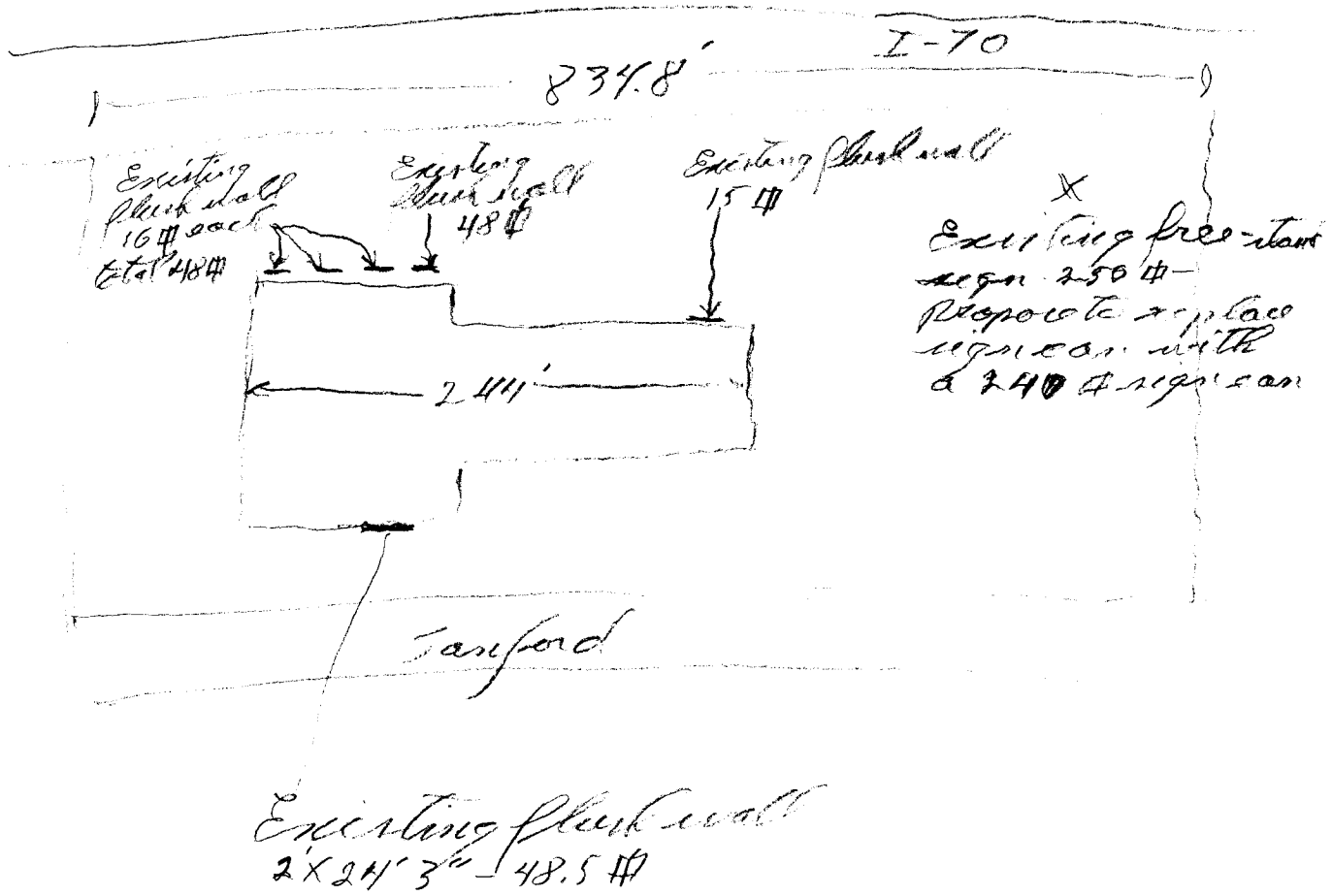

Frederick Traylor  
2236 Sanford

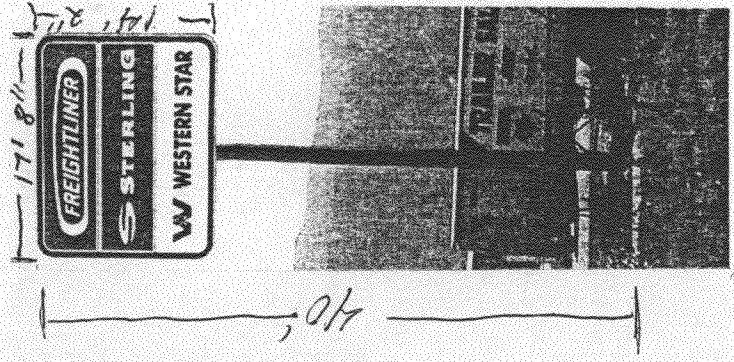

Propose to replace existing  
sign can (250 $\Phi$ ) with a  
new (200 $\Phi$ ) sign concerning  
the existing pole.