



Public Works and Planning Department
 250 North 5th Street, Grand Junction CO 81501
 Tel: (970) 244-1430 FAX (970) 256-4031

Sign Permit

For Signs that DO NOT Require
 a Building Permit

A

M

Date Submitted 5-20-08
 Fee \$ 25.00
 Zone C-1

TAX SCHEDULE NO. 2945-124-00-022 CONTRACTOR The Sign Gallery
 BUSINESS NAME Comfort Dental units 101+102 LICENSE NO. 2071255
 STREET ADDRESS 2650 North Ave ADDRESS 1048 Independent R-109
 PROPERTY OWNER Red Cliff Point TELEPHONE 241-8400
 OWNER ADDRESS _____ CONTACT PERSON Larry

1. FLUSH WALL 2 Square Feet per Linear Foot of Building Façade
 2. ROOF 2 Square Feet per Linear Foot of Building Façade
 3. PROJECTING 0.5 Square Feet per each Linear Foot of Building Façade
 4. FREE-STANDING 2 Traffic Lanes - 0.75 Square Feet x Street Frontage
 4 or more Traffic Lanes - 1.5 Square Feet x Street Frontage

Existing Externally or Internally Illuminated – No Change in Electrical Service Non-Illuminated

(1-4) Area of Proposed Sign: 60 Square Feet
 (1-3) Building Façade: 225 Linear Feet Building Façade Direction: North South East West
 (4) Street Frontage: 281 Linear Feet Name of Street: North Ave
 (2-4) Height to Top of Sign: 15 Feet Clearance to Grade: 12 Feet

EXISTING SIGNAGE TYPE & SQUARE FOOTAGE:

| | | |
|----------------------|------------|---------|
| <u>Flush wall</u> | <u>126</u> | Sq. Ft. |
| <u>Free-standing</u> | <u>187</u> | Sq. Ft. |
| _____ | _____ | Sq. Ft. |
| Total Existing: | <u>313</u> | Sq. Ft. |

FOR OFFICE USE ONLY

| | |
|----------------------------|----------------------|
| Signage Allowed on Parcel: | <u>North Ave.</u> |
| Building | <u>450</u> Sq. Ft. |
| Free-Standing | <u>421.5</u> Sq. Ft. |
| Total Allowed: | <u>450</u> Sq. Ft. |

COMMENTS: Propose to reletter an existing sign

NOTE: No sign may exceed 300 square feet. A separate sign permit is required for each sign. Attach a sketch, to scale, of proposed and existing signage including types, dimensions and lettering. Attach a plot plan, to scale, showing: abutting streets, alleys, easements, driveways, encroachments, property lines, distances from existing buildings to proposed signs and required setbacks. Roof signs shall be manufactured such that no guy wires, braces or supports shall be visible.

I hereby attest that the information on this form and the attached sketches are true and accurate.

Larry R Bowler 5-19-08 Gayle Henderson 5-20-08
 Applicant's Signature Date Planning Approval Date

(White: Planning) (Yellow: Neighborhood Services) (Pink: Applicant)



Public Works and Planning Department
250 North 5th Street, Grand Junction CO 81501
Tel: (970) 244-1430 FAX (970) 256-4031

Sign Permit

For Signs that DO NOT Require
a Building Permit

(B)

Date Submitted 5-20-08
Fee \$ 5.00
Zone C-1

TAX SCHEDULE NO. 2945-124-00-022 CONTRACTOR The Sign Gallery
BUSINESS NAME Comfort Dental ^{units} LICENSE NO. 12071255
STREET ADDRESS 2650 North Ave ADDRESS 1048 Independent #109
PROPERTY OWNER Red Cliff Point TELEPHONE 241-6400
OWNER ADDRESS _____ CONTACT PERSON Perry

1. FLUSH WALL 2 Square Feet per Linear Foot of Building Façade
 2. ROOF 2 Square Feet per Linear Foot of Building Façade
 3. PROJECTING 0.5 Square Feet per each Linear Foot of Building Façade
 4. FREE-STANDING 2 Traffic Lanes - 0.75 Square Feet x Street Frontage
4 or more Traffic Lanes - 1.5 Square Feet x Street Frontage

Existing Externally or Internally Illuminated – No Change in Electrical Service Non-Illuminated

(1-4) Area of Proposed Sign: 54.4 Square Feet
(1-3) Building Façade: 440 Linear Feet Building Façade Direction: North South East West
(4) Street Frontage: 797 Linear Feet Name of Street: 28 Rd
(2-4) Height to Top of Sign: 15 Feet Clearance to Grade: 8 Feet

EXISTING SIGNAGE TYPE & SQUARE FOOTAGE:

| | | |
|----------------------|------------|---------|
| <u>Flush Wall</u> | <u>168</u> | Sq. Ft. |
| <u>Free-standing</u> | <u>133</u> | Sq. Ft. |
| _____ | _____ | Sq. Ft. |
| Total Existing: | <u>301</u> | Sq. Ft. |

FOR OFFICE USE ONLY

| | |
|----------------------------|--------------------|
| Signage Allowed on Parcel: | <u>28 Rd</u> |
| Building | <u>880</u> Sq. Ft. |
| Free-Standing | <u>300</u> Sq. Ft. |
| Total Allowed: | <u>880</u> Sq. Ft. |

COMMENTS: Propose to reletter an existing sign face.

NOTE: No sign may exceed 300 square feet. A separate sign permit is required for each sign. Attach a sketch, to scale, of proposed and existing signage including types, dimensions and lettering. Attach a plot plan, to scale, showing: abutting streets, alleys, easements, driveways, encroachments, property lines, distances from existing buildings to proposed signs and required setbacks. Roof signs shall be manufactured such that no guy wires, braces or supports shall be visible.

I hereby attest that the information on this form and the attached sketches are true and accurate.

Larry R Bowler 5-19-08 Daylen Henderson 5-20-08
Applicant's Signature Date Planning Approval Date

(White: Planning) (Yellow: Neighborhood Services) (Pink: Applicant)

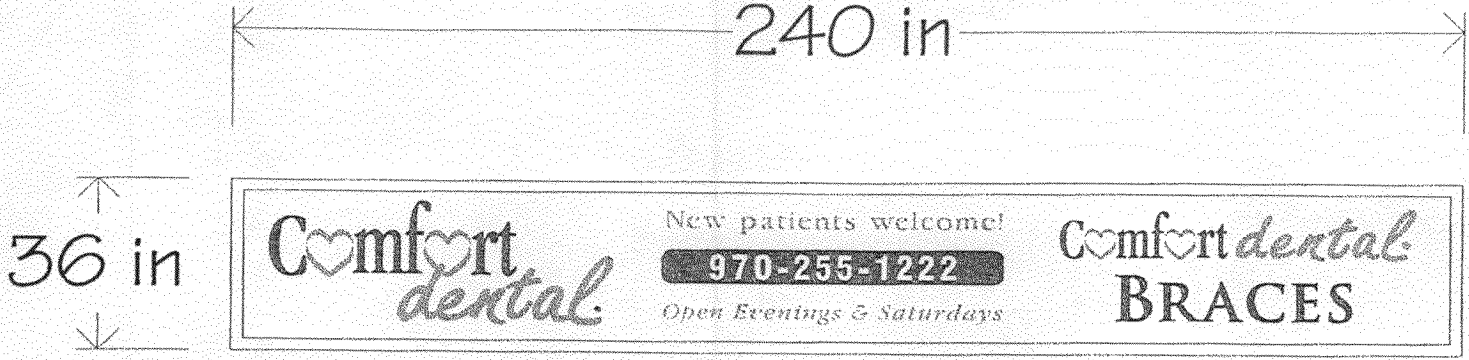

Front sign -- Grand Junction -- Proposed Adding Braces

(A) 60 ft



Side sign -- Grand Junction
Proposed adding Braces

54.4 ft

(B)

Comfort Dental
2650 North Ave

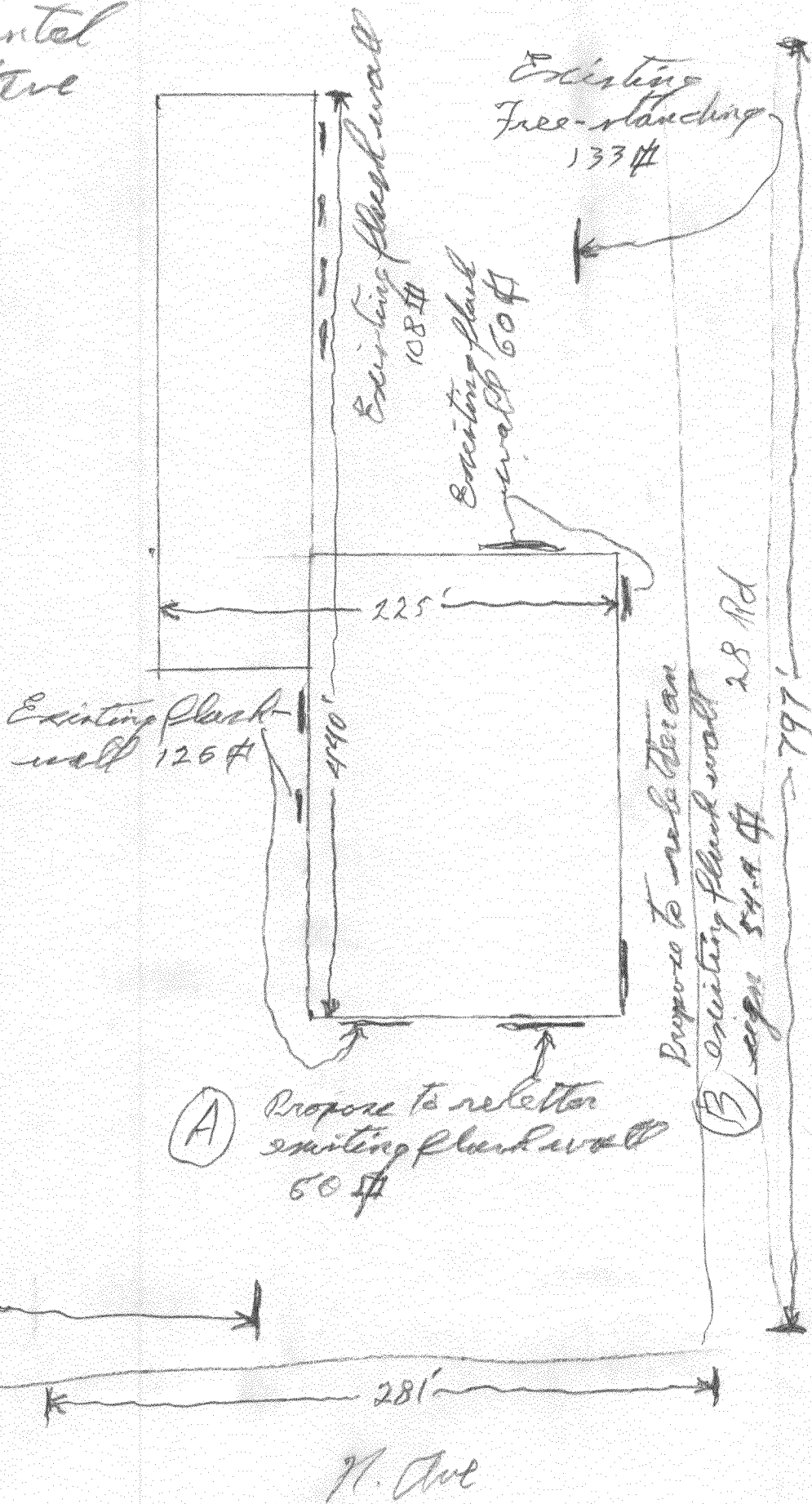

Existing
Free-standing
187 ft

(A) Propose to reletter
existing plank wall
60 ft

Propose to reletter
(B) existing plank wall
28 ft

N. Ave