



Public Works and Planning Department  
250 North 5<sup>th</sup> Street, Grand Junction CO 81501  
Tel: (970) 244-1430 FAX (970) 256-4031

# Sign Permit

For Signs that DO NOT Require  
a Building Permit

Date Submitted 9/23/09  
Fee \$ 25.00  
Zone C-1

TAX SCHEDULE NO. 2945-142-01-008 CONTRACTOR The Sign Gallery  
BUSINESS NAME Pro Tire LICENSE NO. 2198506  
STREET ADDRESS 1018 N 1st ADDRESS 1048 Independent A-109  
PROPERTY OWNER Elder Family Trust TELEPHONE 241-6400  
OWNER ADDRESS \_\_\_\_\_ CONTACT PERSON Larry

- 1. FLUSH WALL 2 Square Feet per Linear Foot of Building Façade
- 2. ROOF 2 Square Feet per Linear Foot of Building Façade
- 3. PROJECTING 0.5 Square Feet per each Linear Foot of Building Façade
- 4. FREE-STANDING 2 Traffic Lanes - 0.75 Square Feet x Street Frontage  
4 or more Traffic Lanes - 1.5 Square Feet x Street Frontage

Existing Externally or Internally Illuminated - No Change in Electrical Service  Non-Illuminated

(1-4) Area of Proposed Sign: 72 Square Feet  
(1-3) Building Façade: 80 Linear Feet Building Façade Direction: North South East West  
(4) Street Frontage: 125 Linear Feet Name of Street: 1st  
(2-4) Height to Top of Sign: 15' Feet Clearance to Grade: 11 Feet

EXISTING SIGNAGE TYPE & SQUARE FOOTAGE	
<u>Free-standing</u>	<u>172</u> Sq. Ft.
<u>Flush wall</u>	<u>72</u> Sq. Ft.
<u>← this permit</u>	<u>32</u> Sq. Ft.
<b>Total Existing:</b>	<b>176</b> Sq. Ft.

FOR OFFICE USE ONLY			
Signage Allowed on Parcel:			
<u>2x72</u>	Building	<u>144</u>	Sq. Ft.
<u>1.5x80</u>	Free-Standing	<u>187</u>	Sq. Ft.
Total Allowed:		<u>187</u>	Sq. Ft.
		<u>-176</u>	

COMMENTS: Replacing an existing sign face 11 left after this permit

**NOTE:** No sign may exceed 300 square feet. A separate sign permit is required for each sign. Attach a sketch, to scale, of proposed and existing signage including types, dimensions and lettering. Attach a plot plan, to scale, showing: abutting streets, alleys, easements, driveways, encroachments, property lines, distances from existing buildings to proposed signs and required setbacks. Roof signs shall be manufactured such that no guy wires, braces or supports shall be visible.

I hereby attest that the information on this form and the attached sketches are true and accurate.

Larry & Bowler 9-22-09 LR C-MoKee 9/24/09  
Applicant's Signature Date Planning Approval Date

1018 N 1st

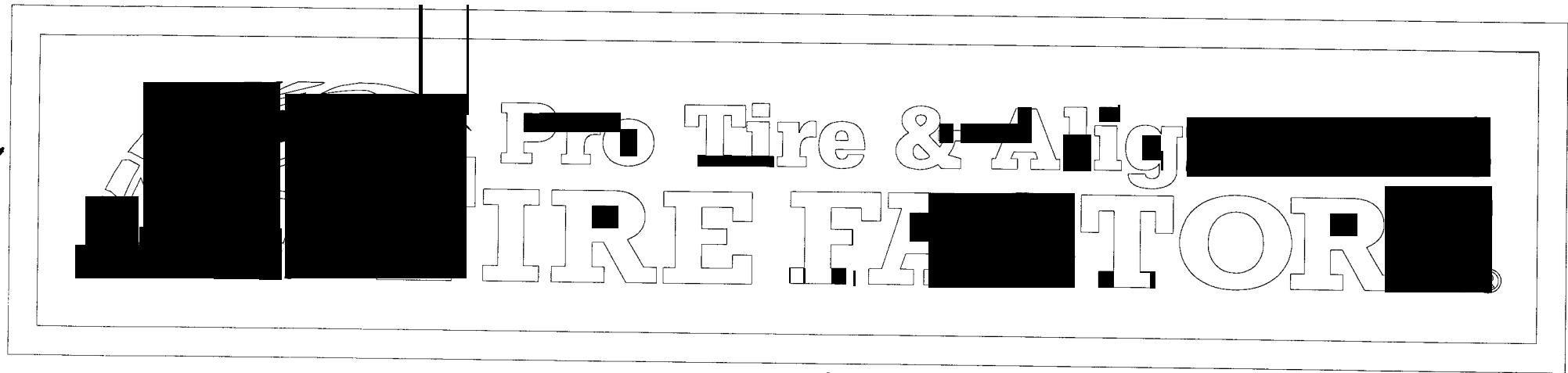

18'

# City of Grand Junction GIS City Map ©

1018 N 1st

*Existing reader looped  
4x8' - 32 ft*

**Parcels**

□ Address Label

**Air Photos**

■ 2008 Photos

— Highways

— Street Labels

**City Limits**

■ Grand Junction

■ Fruita

■ Palisade

■ Mesa County

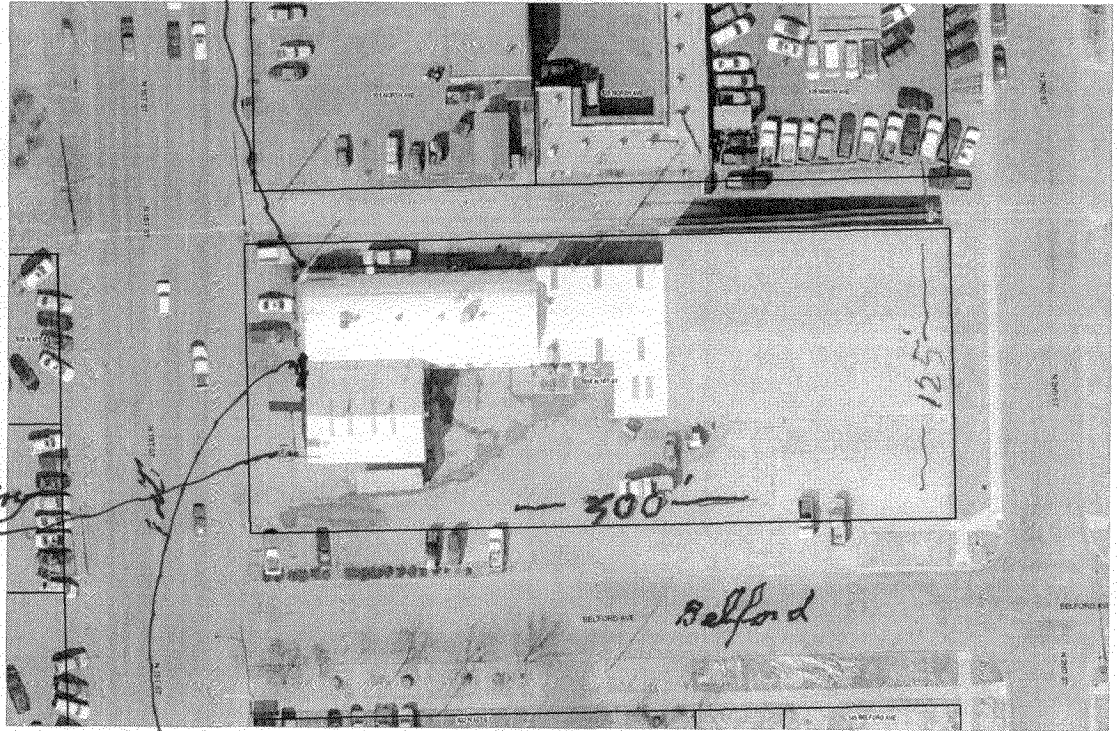

*Existing sign standing  
72 ft*

SCALE 1 : 981



N



*Proposed to replace face on  
existing sign. 4x2.18' - 72 ft*