



Public Works and Planning Department  
250 North 5<sup>th</sup> Street, Grand Junction CO 81501  
Tel: (970) 244-1430 FAX (970) 256-4031

(A)

# Sign Permit

For Signs that DO NOT Require  
a Building Permit

Date Submitted 1-30-09  
Fee \$ 25.00  
Zone B-1

XI

TAX SCHEDULE NO. 2945-122-00-109 CONTRACTOR THE SIGN SMITH  
BUSINESS NAME CITY WASH N CLEAN LICENSE NO. 2081139 2090934  
STREET ADDRESS 1910 N. 12TH, STE D ADDRESS 570 E. CRETE CIR #3  
PROPERTY OWNER \_\_\_\_\_ TELEPHONE 970-244-9197  
OWNER ADDRESS \_\_\_\_\_ CONTACT PERSON ERLIE

- 1. FLUSH WALL 2 Square Feet per Linear Foot of Building Façade
- 2. ROOF 2 Square Feet per Linear Foot of Building Façade
- 3. PROJECTING 0.5 Square Feet per each Linear Foot of Building Façade
- 4. FREE-STANDING 2 Traffic Lanes - 0.75 Square Feet x Street Frontage  
4 or more Traffic Lanes - 1.5 Square Feet x Street Frontage

Existing Externally or Internally Illuminated - No Change in Electrical Service  Non-Illuminated

(1-4) Area of Proposed Sign: 30 Square Feet  
(1-3) Building Façade: 193 Linear Feet Building Façade Direction: North South East West  
(4) Street Frontage: 170 Linear Feet Name of Street: 12TH STREET  
(2-4) Height to Top of Sign: \_\_\_\_\_ Feet Clearance to Grade: 10 Feet

**EXISTING SIGNAGE TYPE & SQUARE FOOTAGE:**

<u>2'x8', 2'x6', 2'x8' FLUSH WALL</u>	<u>44</u>	Sq. Ft.
<u>3'x10' FLUSH WALL</u>	<u>30</u>	Sq. Ft.
<u>FREE STANDING</u>	<u>90</u>	Sq. Ft.
<b>Total Existing:</b>	<b><u>164</u></b>	<b>Sq. Ft.</b>

**FOR OFFICE USE ONLY**

Signage Allowed on Parcel:

Building	<u>386</u>	Sq. Ft.
Free-Standing	<u>255</u>	Sq. Ft.
<b>Total Allowed:</b>	<b><u>386</u></b>	<b>Sq. Ft.</b>

COMMENTS: \_\_\_\_\_

**NOTE:** No sign may exceed 300 square feet. A separate sign permit is required for each sign. Attach a sketch, to scale, of proposed and existing signage including types, dimensions and lettering. Attach a plot plan, to scale, showing: abutting streets, alleys, easements, driveways, encroachments, property lines, distances from existing buildings to proposed signs and required setbacks. Roof signs shall be manufactured such that no guy wires, braces or supports shall be visible.

I hereby attest that the information on this form and the attached sketches are true and accurate.

[Signature] 01/26/09 Gayleen Henderson 1-30-09  
Applicant's Signature Date Planning Approval Date

Pinion Avenue



12th Street

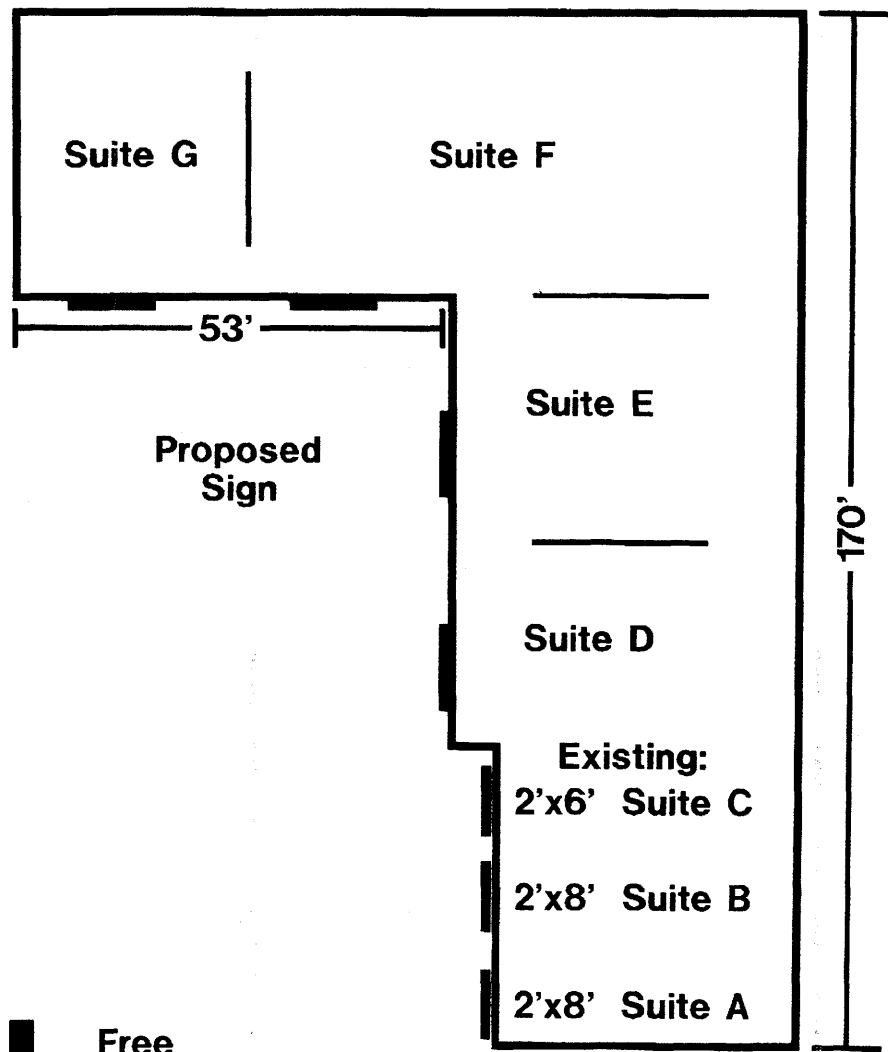
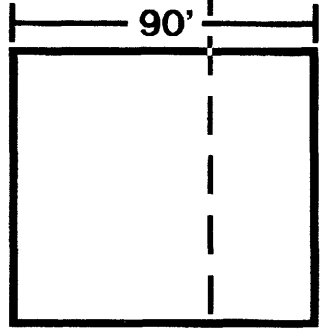

Orchard Avenue

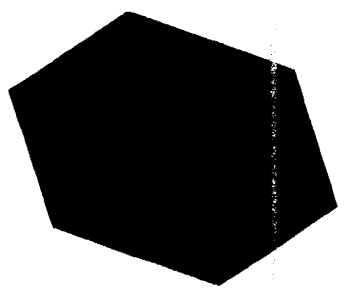

SUITE D

10'

3'



**CitiWash & Clean  
LAUNDROMAT**

3'

*Grand  
Junction* **Chiropractic  
Center, P.C.**

*Dr. Terry Sweet • Dr. Mark Leistico • Dr. Arthur Kuersten*

SUITE F

10'